

# LED LITE™

## Energy Saving LED

## 3W LED Self-Test Non Maintained Emergency Downlight



### LTDL3NMST

- Self-test Function (BS5266 compliant)
- Manual test button
- Ceiling Recessed Mounting
- Compact design
- Pre-wired for easy installation
- Long-Life LiFePO4 Battery

The LTDL3NMST emergency downlight is designed mainly for commercial, retail, and open areas applications. It has a low profile design and it is a non-maintained yet high output LED (emergency downlight). It comes with self test function, manual test button and green LED indicator. Ideal for use in corridors, stairwells and other places that require a smart, discrete emergency unit.

### Specifications:

- Input Voltage: 220-240V/AC
- Power: 3W
- Light Output: 120Lm
- Test method: Self-test
- CCT: 5500K
- CRI >85
- IP Rating: IP20
- Protection Class: Class II
- Housing: PC Body  
White Aluminium Trim
- Ceiling Recessed Mounting
- Cut-out: Ø34mm
- Battery: LiFePO4 3.2V 1500mAh
- Warranty: 3 years

### Dimensions(mm):

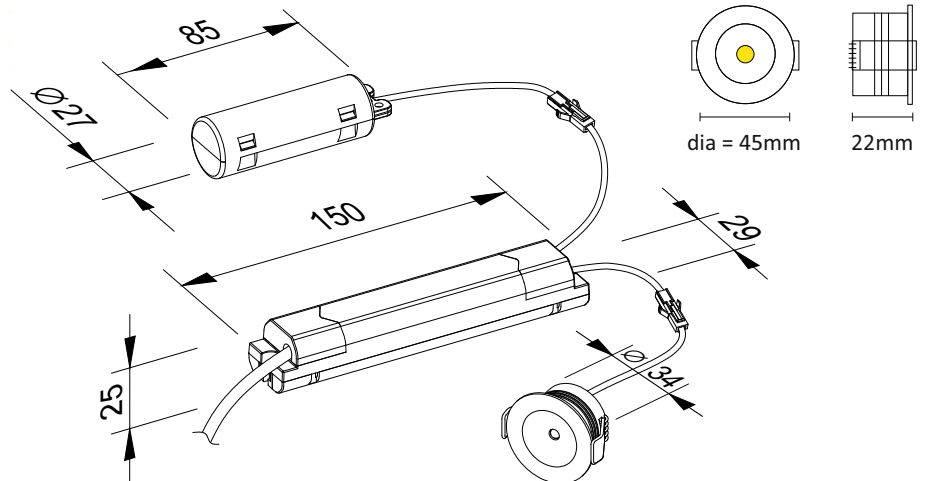

- Power **3W**
- Input Voltage **AC: 220-240V**
- Lumen Output **120lm**
- Battery **LiFePo4 3.2V/1.5Ah**
- Frequency **50-60Hz**
- Working temp. **-20°C / +40°C**
- IP Rating **IP20**
- Emergency **Min. 3Hours**
- Cut-Out **Ø 34mm**

