



## Dimmable Kinetic Wireless Switch

Installation Instruction



Read instructions carefully before installation

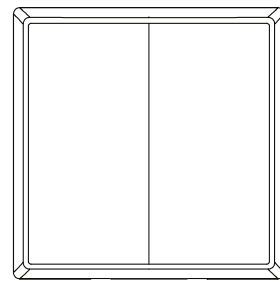

## Dimmable Kinetic Wireless Switch



### Component diagrams

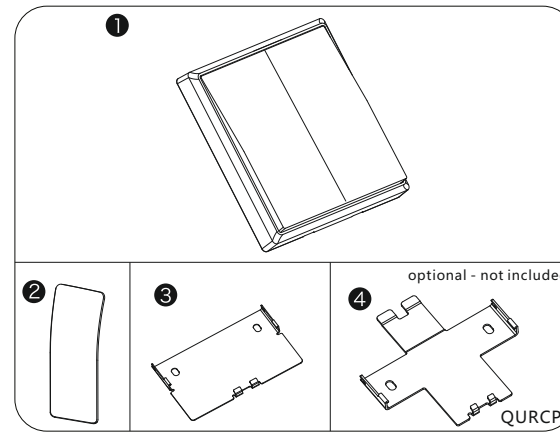

- 1 Switch plate (2 gang switch shown)
- 2 double sided adhesive tape
- 3 Wall fixing plate
- 4 Cross shaped box fixing plate -QURCP (optional only- **not included**)

### Specifications

#### Kinetic Wireless Switch Technical Parameters:

Power supply: Micro energy acquisition and self generating (no battery required)  
Control distance\*: 160m (outdoor), 30m (indoor)  
Control method: pairing with Dimmable Quinetic Controller QUR301  
Guaranteed 3 Years  
May be used in bathrooms  
For outdoor use mount in an IP rated enclosure  
Permanently fixed or placed on wall using self adhesive 3M tape (supplied)

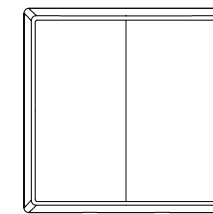

Every Quinetic product has passed the strict quality inspection before it leaves the factory. Quinetic provides 3 years warranty if installed & used in accordance with these instructions. Within the 3 years warranty period, Quinetic will be responsible for the repair, free replacement of parts or entire product.

\* Distance comes from Quinetic laboratory test result. The actual distance in practical use might vary due to environmental difference.

### Dimmable Kinetic switch operation:

The dimmable Quinetic switch must be paired with the dimmable Quinetic controller QUR301 (see controller instructions for more details about pairing). Pressing the switch quickly will turn the light ON/OFF. Keep the switch pressed to dim the light to the desired level. While the switch is pressed the lights will go down from 100%-0% and they will go up 0-100%.

### Installation Methods

Pair the switch before mounting to ensure correct operation.

### Three installation methods for wireless kinetic energy switch:

#### 1 Adhesive installation method:

- 1-1 Applicable environment: glass, marble, ceramic tile and other smooth surface
- 1-2 Choose the installation position: clean the surface to ensure no oil/water etc.
- 1-3 Take the double sided adhesive tape (included), paste the tape on the bottom of switch in accordance with the mark on the bottom (See diagram 1-1A-01)

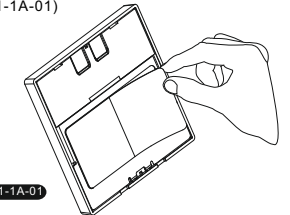

diagram 1-1A-01

- 1-4 Place the switch in position required. The glue will be dry after 24 hours depending on conditions.

#### 2 Plate installation method:

- 2-1 Applicable environment: flat wall such as normal lime wall, painted wall, etc...

**Step 1:** Remove the outer frame from the switch. (refer to diagram 2-2A)

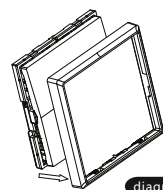

diagram 2-2A

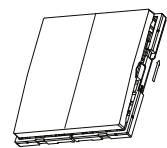

diagram 2-2B

**Step 2:** Remove the fixing plate by pushing it 5mm upwards then pull it out. (refer to diagram 2-2B)

- 2-2 Screw the plate to the wall using appropriate fixings, the screws should be in the middle of the mounting holes. (refer to diagram 2-2C)

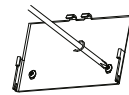

diagram 2-2C

- 2-3 Align the switch with the fixing plate, push back then up to fix in place. (refer to diagram 2-2D)

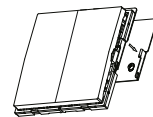

diagram 2-2D

- 2-4 Clip the outer frame onto the switch with the product logo at the bottom. (refer to diagram 2-2E)

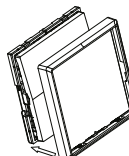

diagram 2-2E

#### 3 Box plate installation method

- 3-1 The Quinetic switch can be installed onto existing single wall boxes using the cross shaped fixing plate QURCP (**not included**).
- 3-2 Follow the plate installation method to remove the outer frame and plate.
- 3-3 Connect the QURCP plate to the box using appropriate screws. Do not over tighten screws, this may cause the plate to buckle. Do not use torque greater than 18kgf. (refer to diagram 2-3A)

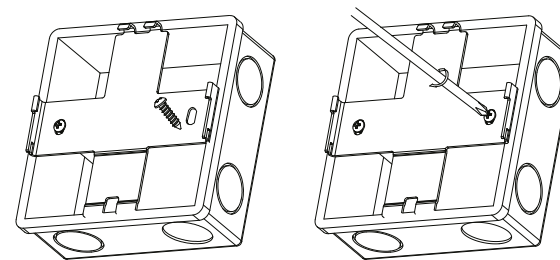

diagram 2-3A

- 3-4 Align the switch with the fixing plate, push back then up to fix in place. (refer to diagram 2-2D)
- 3-5 Clip the outer frame onto the switch with the product logo at the bottom. (refer to diagram 2-2E, 2-3B)

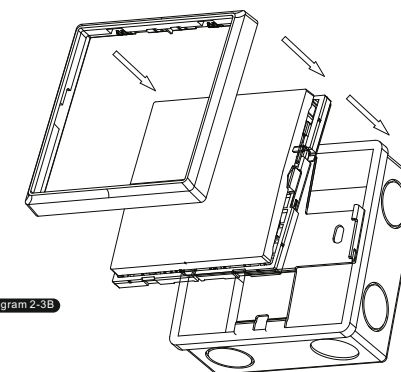

diagram 2-3B

### Kinetic Wireless Switch Dimensions

