

QR301 MOSFET Dimming Controller Instructions 80*60mm

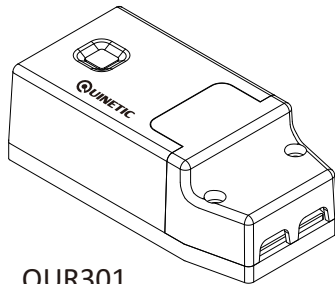

Controller for Dimming Quinetic Wireless Switch

Installation Instructions



QR301

Read all instructions before installation

Specifications

Controller for Quinetic Dimming Wireless Switch
Technical Specifications:

Product Code: QR301
Voltage range: 200-240V 50/60Hz
Working environment temperature: -20°C - 55°C
Control distance*: 110m outdoor, 30m indoor
Capacity: Up to 10 switches can be paired with one controller

Control method: pairing with Dimming Quinetic Wireless Switch (see instructions)

Integrated push-in terminals for quicker installation

Control Load: 1.0A
Maximum Load: 100W LED & 200W other loads**

*Distance comes from Quinetic laboratory test results. The actual distance in practical use might vary due to environmental difference.

**Maximum load rating may vary depending on manufacturers specifications.

Wireless receiving controller installation

1. Ensure that the power is turned off before installation.
2. The wireless receiver/controller line input should be connected using live and neutral cable from mains.
3. Output lines should be connected to load using cable rating suitable for 200-240V depending on voltage at site. (see diagram below).
4. Use the double-sided adhesive tape or screw to fix the wireless receiving controller.

Wiring Instructions

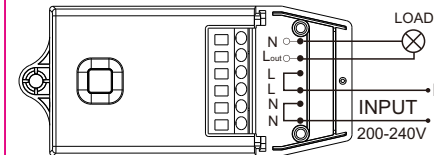

L: Live In
N: Neutral Line
Lout: Live Out

Wireless receiving controller code pairing method

Dimming Wireless Quinetic energy switch and dimming wireless receiving controller can be paired with any combination: a controller can be controlled by a maximum of 10 separate switches, a switch can pair an unlimited number of controllers.

The range of a switch may also be extended by using a second controller and putting it into "Bridging Mode". In order to extend the distance, the second controller must be paired with the switch and located between the switch and the controller that is out of range. The Bridging Mode can be enabled on the second controller by following the pairing steps below (Code Pairing Steps No.7). Once the second receiver is in Bridging Mode and paired with the switch it will forward the signal from the switch to the controller situated outside of controlling range.

The controller is preset in "Dimming Mode". Please see the instructions below on how to exit or enter again the "Dimming mode".

Code pairing steps:

1. Press the function button for 3 seconds and the indicator light begins to flash slowly. Then release the button and enter the single pairing state.
2. Press the wireless kinetic energy switch and the indicator light on the controller will go out, which means that the pairing is successful.
3. If you need to add more switches to the same controller, repeat the above process; each controller can store up to 10 switches, pairing in formation.
4. Single, double and triple switches follow the same pairing method.

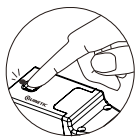

Press for 3 seconds to enter program mode

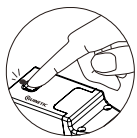

Press for 10 seconds to enter/exit Dimming mode

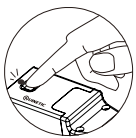

Press for 15 seconds to clear memory

5. The controller is preset in "Dimming Mode". The indicator light flashes twice every 2 seconds. To exit the Dimming mode press the button on the dimming controller for 10 seconds. The indicator light flashing changes from fast to still light. Release the button at this moment. The controller will exit the dimming mode and the indicator light will stop flashing.
6. To enter Dimming Mode again use the same steps presented above. After releasing the button the indicator light will flash twice every 2 seconds.
7. In order to put the controller in to Bridging mode press the function button for 7 seconds. The indicator light will pulse continuously to indicated a successful "bridge". The bridging mode can be toggled off using the same pairing steps.
8. If the controller indicator light continues to pulse the controller will still function normally even if used with a single switch. If the controller is in the dimming mode and the bridging mode at the same time, the indicator light flashes 3 times every 2 seconds.
9. To clear the controller stored pairing information press function button for 15 seconds until the indicator light goes out - the pairing information will be deleted.

Precautions:

1. The wiring must be done in accordance with the method of installation illustrated.
2. Please note the maximum loading of an individual controller. Exceeding this maximum will result in damaging the controller.
3. The controller has a non-replaceable internal fuse.
4. Do not short-circuit, it may cause permanent damage to the receiving controller.
5. The controller will remain "OFF" after a power cut until reactivated by a switch, saving energy, reducing fire risk and protecting your appliances.
6. Damage caused by incorrect installation and operation are not covered under warranty.

Troubleshooting:

1. If pairing does not work first check if the indicator is lit. Re-pair in case the pair is lost after power failure.
2. If the receiver does not respond check the LED indicator. If this does not light check the power supply.
3. If the lamps are not dimming please make sure the Dimming Mode is activated (see step 5 and 6 in Code pairing steps section).
4. The dimming range varies for LED lamps as there are different LED dimmable driver solutions.

Dimensions:

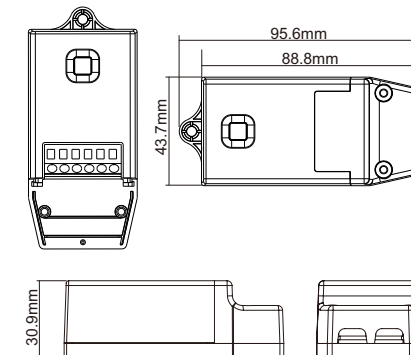

*Please note: For more pairing information visit www.tlc-direct.co.uk