

Spannungsprüfer
Combi Check 1.2
Master Check 3.2



- D Bedienungsanleitung
- GB Operating instructions
- F Mode d'emploi
- NL Gebruiksaanwijzing
- I Istruzioni per l'uso
- E Instrucciones de manejo
- S Bruksanvisning
- DK Brugsanvisning
- FIN Käyttöohje
- N Bruksanvisning

STEINEL®

Zuschaltbare Prüfspitzenbeleuchtung

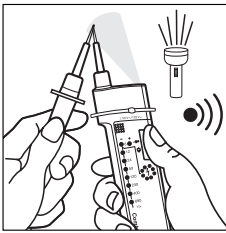

(nur Combi Check 1.2)

Die Prüfspitzenbeleuchtung kann manuell durch Drücken der Taste und einmaliges Kurzschließen der Prüfspitzen eingeschaltet werden. Die Beleuchtung bleibt nur für die Dauer der Tastenbetätigung eingeschaltet.

CE Konformitätserklärung

Das Produkt erfüllt die Niederspannungsrichtlinie

73/23/EWG und die EMV-Richtlinie 89/336/EWG.

Funktionsgarantie

Dieses STEINEL-Produkt ist mit größter Sorgfalt hergestellt, funktions- und sicherheitsgeprüft nach geltenden Vorschriften und anschließend einer Stichprobenkontrolle unterzogen.

Die Garantifrist beträgt 36 Monate und beginnt mit dem Tag des Verkaufs an den Verbraucher. Wir beseitigen Mängel, die auf Material- oder Fabrikationsfehlern beruhen, die Garantieleistung erfolgt durch Instandsetzung oder Austausch mangelhafter Teile nach unserer Wahl.

Eine Garantieleistung entfällt für Schäden an Verschleißteilen, für Schäden und Mängel, die durch unsachgemäße Behandlung oder Wartung auftreten sowie für Bruch bei Sturz.

Weitergehende Folgeschäden an fremden Gegenständen sind ausgeschlossen. Die Garantie wird nur gewährt, wenn das unzerlegte Gerät mit Kassenbono oder Rechnung (Kaufdatum und Händlerstempel), gut verpackt, an die zutreffende Servicestation eingeschickt oder in den ersten 6 Monaten dem Händler übergeben wird.

Reparaturservice:
Nach Ablauf der Garantiezeit oder Mängeln ohne Garantieanspruch repariert unser Werksservice. Bitte das Produkt gut verpackt an die nächste Servicestation senden.

**FUNKTIONS-
36 Monate
GARANTIE**

GB Instructions for Use

Dear Customer

Congratulations on purchasing your new STEINEL Voltage Tester and thank you for the confidence you have shown in us. You have chosen a high-quality product that has been manufactured, tested and packed with the greatest care. The step voltage tester is capable of the following functions:

- DC and AC voltage indication
- Polarity indication
- Continuity testing with pushbutton

- Voltage detection > 50 V AC / 120 V DC even without batteries
- Automatic battery monitoring
- Single-hand operation for testing socket outlets using clip connector for test probes
- Phase testing (Combi Check 1.2 only)
- Visual and acoustic indicator (Combi Check 1.2 only)
- Selectable test probe light (Combi Check 1.2 only)

Description

Combi Check 1.2

- ① Test probe guard
- ② Test probes
- ③ Voltage indicator, LED
- ④ Pushbutton
- ⑤ Clip connector
- ⑥ LED's for indicating
 - a) DC and AC voltage
 - b) polarity
 - c) continuity testing
 - d) phase testing (Combi Check 1.2 only)
- ⑦ Battery compartment
- ⑧ Acoustic indicator, buzzer (Combi Check 1.2 only)
- ⑨ Test probe light (Combi Check 1.2 only)

Master Check 3.2

- ① Test probe guard
- ② Test probes
- ③ Voltage indicator, LED
- ④ Pushbutton
- ⑤ Clip connector
- ⑥ LED's for indicating
 - a) DC and AC voltage
 - b) polarity
 - c) continuity testing
- ⑦ Battery compartment

GB Safety Instructions

- The voltage tester must only be used within the specified rated voltage range. The provisions contained in DIN VDE 0105 Part 100 and EN 50110-1 regarding the use of voltage testers stipulate that just before testing for isolation from supply, the voltage tester must be checked for proper working order. If the indicator fails to operate during this check, the voltage tester must not be used.
- Indication that the upper limit for extra-low voltages (ELV) has been exceeded only serves as a warning to the user and not as a measurement reading.
- Due to the high input resistance, the capacitive and inductive voltages may be indicated.
- When testing, hold the voltage tester by its handles only. Do not touch the test electrodes. Only perform 2-pole voltage tests.
- Before using the voltage tester in places where noise levels are high, first check whether the acoustic test signal is audible.
- The LEDs start to glow at 80-85 % of designated voltage.
- Reliable indication is only assured over a temperature range of -10 °C to +55 °C.
- The voltage tester must be checked for proper working order shortly before and after testing for isolation from supply. If this check reveals any failure of the tester to indicate one or more steps or if the voltage tester fails to show that it is ready for operation, it must not be used.
- The voltage tester and its accessories must not be dismantled by unauthorized persons.
- The tester must be stored in a dry and clean place.
- The tester must not be used in wet conditions (e.g. condensation or rain) (IP 50).
- Within its maximum ON duration, the device may be exposed for up to 30 seconds to the maximum rated voltage of the indicated range.
- Indicator legibility may be impaired in adverse light conditions, e.g. in sunlight.
- **WARNING:** Voltage tester must not be used with the battery compartment open.

Technical Specifications

Dimensions:	(L x W x H) 230 x 55 x 34 mm
Rated voltage range:	Combi Check 1.2: 6-690 V AC/DC Master Check 3.2: 6-400 V AC/DC
Frequency range:	0-100 Hz; AC display from $f > 2$ Hz
Voltage surge proof:	Combi Check 1.2: 6 kV Master Check 3.2: 4 kV
Input resistance:	≥ 300 kOhm
Input current:	Combi Check 1.2: $I_s < 2.5$ mA at 690 V Master Check 3.2: $I_s < 2.5$ mA at 400 V
Continuity testing:	Continuity < 500 kOhm
Single-pole phase testing:	Continuity at voltages (Combi Check 1.2 only) > 90 V AC (acoustic signal)
Temperature range:	-10 °C to +55 °C
Battery life:	approx. 1500 operations
Battery type:	2 x micro 1.5 V AAA Alkaline (do not use rechargeable batteries)
Enclosure:	IP 50
Approval:	to EN 61243-3 = VDE 0682 Part 401
Weight:	135 g

Battery and Function Test

Battery installation:

Open the battery compartment using a screwdriver or a coin. With the rear side of the unit facing up, turn the catch clockwise through 45° to unlock. Now pull the battery compartment out as far as the stop. Install batteries as indicated (do not use rechargeable batteries). To close the battery compartment, push the battery compartment as far as it will go into the housing and lock the compartment in place by turning the catch anticlockwise through 45°.

WARNING: Voltage tester must not be used with the battery compartment open.

Function test/battery test

With the test probes shorted and pushbutton pressed the entire LED step display must come on briefly, leaving only the +6 V step indicator on. An acoustic signal will also sound. If the +6 V step indicator flashes during this test, change the batteries at the next opportunity possible. The LED step display will flash while conducting further voltage/continuity checks to remind you that the batteries need changing.

Voltage testing

- ① Apply the test probes to the potential points you wish to test.
 - For DC voltage testing, the test probe on the display handle represents the positive pole, and the small test probe the negative pole.
 - The positive and the negative diode of the 6 V voltage step will light up simultaneously for AC voltage.
 - The entire LED step display will briefly light up at the start of each voltage test.
- ② The level of voltage present is indicated by the LED's lighting up as far as the step level of voltage present. An acoustic indication is also given for Combi Check 1.2.

Continuity testing

- ① Before conducting a continuity test in electrical systems, first switch off external voltage sources and, where applicable, discharge capacitors.
- ② Short the test probes and keep button pressed.
- ③ Contact the test object with the test probes. Contact the test object

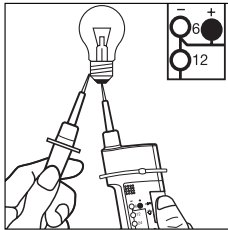

with the test probes. If contact resistance is < 500 kOhms, the +6 V diode will light up. An acoustic indication is also given for Combi Check 1.2. Impressed external voltages will be indicated despite the continuity test, and will not harm the tester.

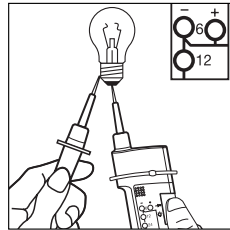

Semiconductor testing

When the button is pressed during polarity-dependent continuity testing, the internal test voltage source is switched to the test probes.

The display handle represents the positive pole, and the small handle the negative pole. If continuity is given, the +6 V diode illuminates. An acoustic indication is also given for Combi Check 1.2.

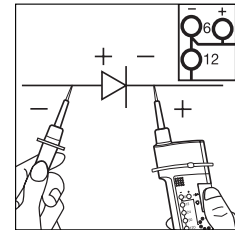
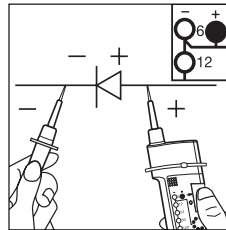

Phase testing

(Combi Check 1.2 only)

WARNING: Phase testing cannot be performed in unfavourable locations, e.g. on ladders with wooden rungs or in rooms with insulated floor coverings and in AC voltage systems not properly bonded to earth.

- To perform the phase test, contact the small test probe with the phase (> 90 V AC) of the AC voltage system and touch the phase tester contact on the indicator handle with your thumb. The 6 V step indicator (+ and -) will light up upon phase contact and an acoustic signal is also given.

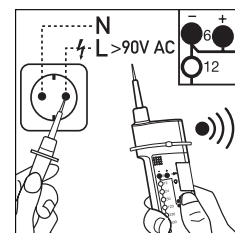
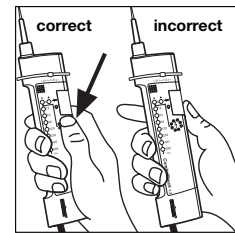

Selectable test probe light

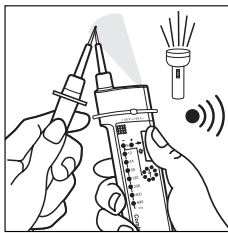

(Combi Check 1.2 only)

The test probe light can be switched on manually by pressing the button and briefly shorting the test probes. The light only remains on while the button is pressed.

CE Declaration of Conformity

This product complies with Low Voltage Directive

73/23/EEC and EMC Directive 89/336/EEC.

Functional Warranty

This STEINEL product has been manufactured with great care, and its operation and safety have been tested in conformity with the current regulations. Production is also submitted to final random-sample testing.

The warranty period is 36 months, starting on the date of sale to the user. We undertake to remedy faults caused by material or manufacturing defects. This warranty undertaking shall be performed by the repair or replacement of the defective parts, at our own discretion.

This warranty shall not cover damage to wearing parts or damage and faults caused by incorrect operation or maintenance. Breakage due to a fall is also not covered.

Further consequential damage to external items is excluded.

Claims under warranty shall only be accepted if the product is sent fully assembled and well packed complete with sales slip or invoice (date of purchase and dealer's stamp) to the appropriate Service Centre or handed in to the dealer within the first 6 months.

Repair Service:
Our Customer Service Department will repair faults not covered by warranty or after the warranty period. Please send the product well packed to your nearest Service Centre.

**FUNCTIONAL
36 month
WARRANTY**

F Mode d'emploi

Cher client,

Nous vous remercions de la confiance que vous avez témoignée à STEINEL en achetant ce testeur de tension. Vous avez choisi un article de très grande qualité, fabriqué, testé et conditionné avec le plus grand soin. Le testeur de tension vous offre les fonctions suivantes:

- affichage de tensions continues et alternatives,
- affichage de la polarité,
- test de continuité avec poussoir,

- détection de tensions > 50 V C.A./ 120 V C.C. même sans piles,
- contrôle automatique des piles,
- utilisation d'une seule main pour les tests de prises de courant par enclenchement des pointes de test,
- test de phase (uniquement Combi Check 1.2),
- affichage visuel et signal acoustique (uniquement Combi Check 1.2),
- éclairage débrayable des pointes de test (uniquement Combi Check 1.2).

Description de l'appareil

Combi Check 1.2

- ① Protection des pointes de test
- ② Pointes de test
- ③ Témoin de tension, DEL
- ④ Poussoir
- ⑤ Cran
- ⑥ Diodes pour l'affichage de:
 - a) tensions continues et alternatives
 - b) polarité
 - c) test de continuité
 - d) test de phase (uniquement Combi Check 1.2)
- ⑦ Compartiment à piles
- ⑧ Avertisseur sonore pour signal acoustique (uniquement Combi Check 1.2)
- ⑨ Éclairage des pointes de test (uniquement Combi Check 1.2)

Master Check 3.2

- ① Protection des pointes de test
- ② Pointes de test
- ③ Témoin de tension, DEL
- ④ Poussoir
- ⑤ Cran
- ⑥ Diodes pour l'affichage de:
 - a) tensions continues et alternatives
 - b) polarité
 - c) test de continuité
- ⑦ Compartiment à piles