

TECHAIR

PORTABLE AIR CONDITIONER

OPERATING INSTRUCTIONS

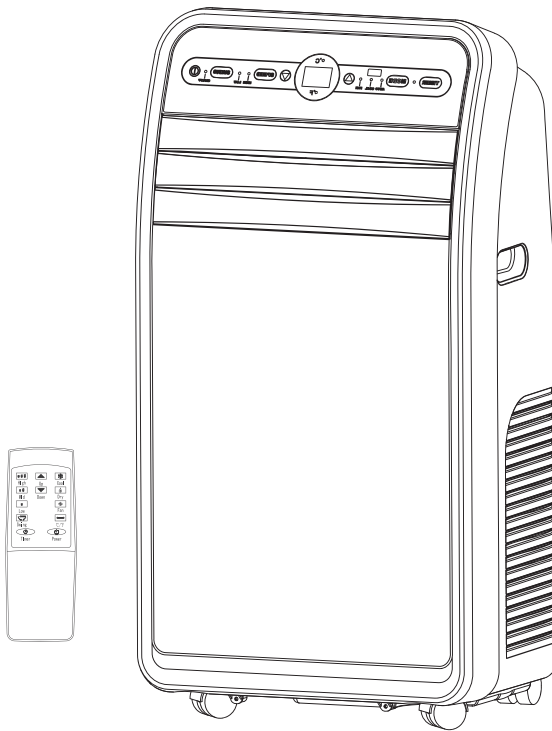

AC12000N



USER MANUAL

Thank you for choosing this TechAir portable air conditioner. Please read the Manual carefully before operation. In case of any issues please contact your distributor or the manufacturer.

CONTENT

Important Safety Tips	
Precautions	3
Product Introduction	
Main Parts and Components	4
Control Panel and Remote Controller	5
Product Operation	
Placement and Installation	6
Operation Method	8
Cleaning and Maintenance	
Drainage Method	9
Maintenance	9
Common Failures and Diagnosis	
Intelligent Error Detection	10
Fuse Parameters	10
Troubleshooting	10

AC12000N Portable Air Conditioner – 12,000 BTU

Please read this information carefully before operating the appliance and retain for future reference.

BEFORE INITIATION

To avoid damage, place the unit in an upright position for at least 24 hours before initiation.

Make sure that the air outlet and air inlet are never blocked.

Only operate the unit on a horizontal surface to ensure no water leaks out.

INTENDED USE

This appliance is designed for:

- Indoor household or light industrial use only
- Operation in dry indoor environments

It is not intended for outdoor use.

The appliance must be installed, operated, and stored in a room with a minimum floor area of 12 m².

Improper use may result in injury, damage, or voiding of the warranty.



GENERAL OPERATING PRECAUTIONS

- Place the unit on even, level ground and ensure it is vertically installed to allow normal compressor operation.
- Maintain a minimum clearance of 50 cm from surrounding objects.
- Keep all ventilation openings, air inlets, and outlets clear.
- Keep away from direct sunlight and heat sources.
- Do not use near flammable liquids or in solvent-laden environments.
- Avoid using aerosols, flammable sprays, or other flammable substances near the appliance.
- Do not insert fingers or hard objects into the air outlet or inlet.
- Prevent water or liquids from entering the appliance.
- Ducts connected to the appliance must not contain potential ignition sources.
- When operating, the fan may continue running even if the compressor stops due to low temperature. This is normal.

ELECTRICAL SAFETY

- Ensure the mains voltage matches the rating label.
- Connect only to a properly installed UK wall socket.
- Check the power cord regularly. Do not use if the cord, plug, or appliance is damaged.
- If the power cord is damaged, it must be replaced by the manufacturer or a qualified technician.
- If an extension lead is needed, it must be fully unwound and rated minimum 16A / 250V.
- Turn off the appliance before unplugging.
- Always unplug before removing, replacing, or servicing parts.
- Do not handle the plug with wet hands.
- Do not immerse the appliance or power cord in water.

UK PLUG INFORMATION

This appliance is fitted with a BS 1363 3-pin plug with a 3A BS1362 fuse.
Replacement must be carried out by a qualified person.

REFRIGERANT SAFETY – R290 (PROPANE)

- WARNING – Risk of Fire

This 12,000 BTU appliance contains approximately 215 g of R290 refrigerant (Propane), which is highly flammable.

SAFETY REQUIREMENTS

- Do not pierce or perforate any part of the refrigerant circuit.
- Do not burn the appliance.
- Refrigerant gas may be odourless.
- Do not use near open flames, sparks, or other ignition sources.
- Do not smoke near the appliance.
- Ensure adequate room ventilation during operation and storage.
- Store in a well-ventilated area free from continuous ignition sources.

If refrigerant leakage is suspected:

1. Switch off the appliance immediately.
2. Disconnect from the mains supply.
3. Ventilate the room thoroughly.
4. Contact a qualified service technician.

Servicing of refrigerant systems must be performed only by certified personnel in accordance with UK regulations and EN 60335-2-40.

USE OF ACCESSORIES

Use only accessories supplied or approved by the manufacturer.

Use of non-approved components may cause damage, reduced performance, or safety risk.

CHILD & VULNERABLE PERSON SAFETY

- This appliance may be used by children aged 8+ only under supervision or after instruction in safe use.
- Children must not play with the appliance.
- Cleaning and maintenance must not be carried out by children without supervision.
- Keep packaging materials away from children – risk of suffocation.

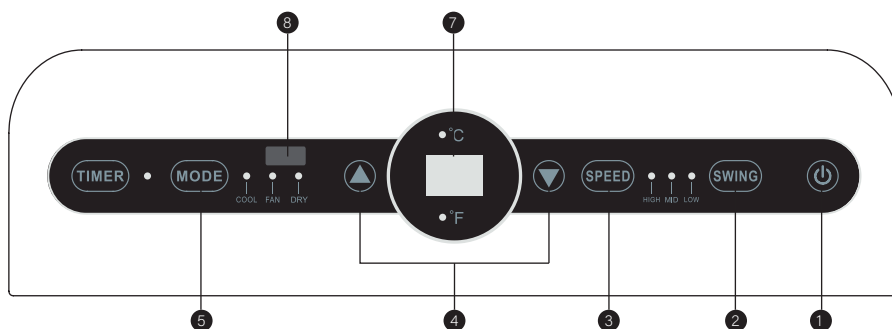

CONTROL PANEL AND REMOTE CONTROLLER

1. Power Button

Press the button to turn ON/OFF the A/C.

2. Swing Button

Press this button at any time after turning on the A/C to swing the air louvres automatically.

3. Speed Button

Press the button to choose high/mid/low fan speed.

4. Temperature / time adjusting Button

Press the button at cooling mode to increase/reduce the setting temperature; press it at timing mode to adjust timing ON/OFF time; press Up and Down button simultaneously to switch Fahrenheit and Centigrade degree temperature.

5. Mode Button

Press the button to choose COOL (Air Conditioning), FAN (Forced Air), DRY (Dehumidification).

6. Timer Button

Press the button at standby mode to set ON time. Press this button at ON mode to set OFF time.

7. Temperature / time display window

This window displays the adjusted temperature and time.

8. Remote controller receiving window

This window is used to receive the signal from the remote controller.

9. °C/°F switching Button

Press the button to switch between °C and °F on the remote control.

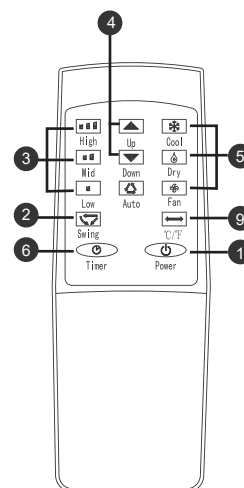



PLACEMENT AND INSTALLATION

PLACEMENT

- Place the A/C on dry level surface, and keep it at least 50 cm's away from any objects/ surfaces to ensure optimum ventilation.

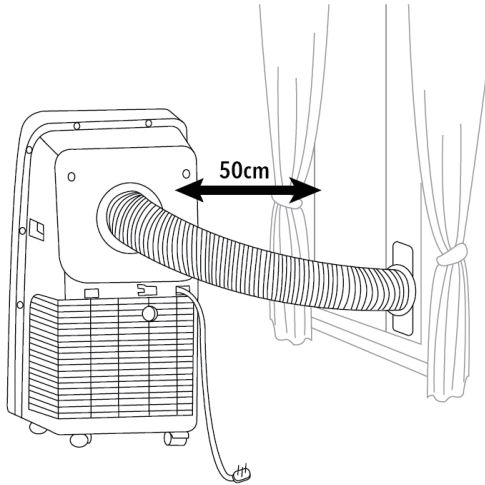

INSTALLATION

- To connect the exhaust duct assembly into the rear of the A/C align and twist anti-clockwise to secure into position.

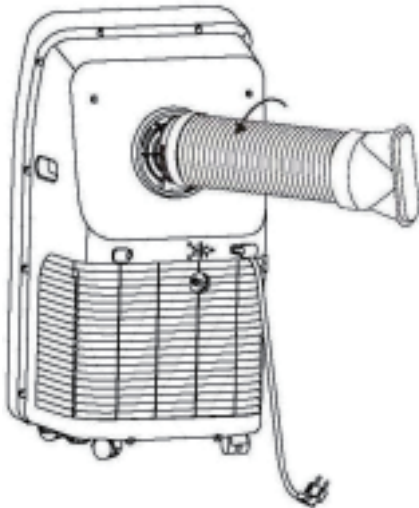



- Insert the air exhaust hose into the window sealing plate, adjust opening width of window so that the window can match with the sealing plate properly; length of the sealing plate is adjustable.
- If your window cannot accommodate this type of installation, ensure that the exhaust duct is vented to an area outside the room being cooled and is securely positioned.

Note: The air expelled from the duct will be warm. If the duct outlet is not directed outside, ensure that the warm air is discharged into a suitable area to prevent it from re-entering the room.

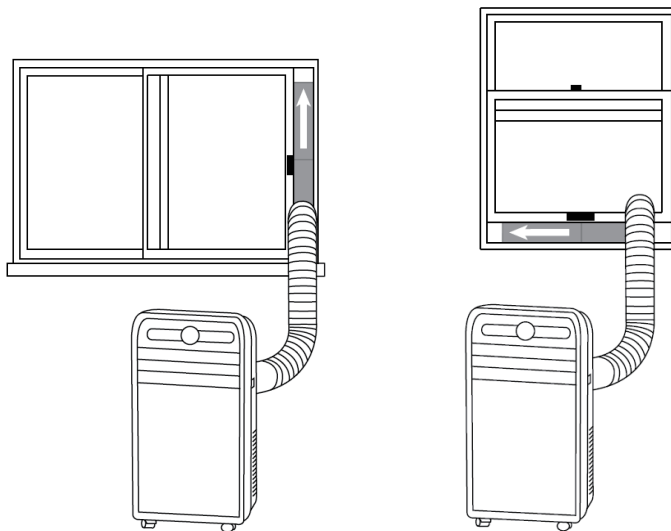

INCORRECT INSTALLATION

- It's important to keep the exhaust duct smooth. Incorrect installation will affect the performance of the A/C.
- Prevent the exhaust duct from bending / kinking above 90°, restricted exhaust **air flow will impair performance and may cause failure.**
- Ensure air can flow smoothly through the duct.

WARNING:

The exhaust duct is designed especially for this model. Don't replace or lengthen it; otherwise it could result in failure or poor performance.

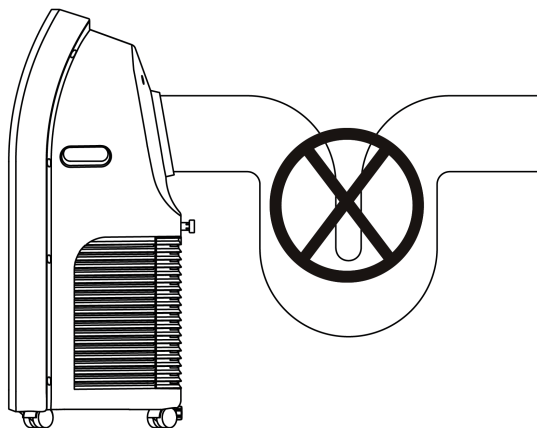



OPERATION METHOD

COOLING MODE (COOL)

Please read the manual carefully before operating the machine:

- When the A/C enters cooling mode automatically, or COOL mode is selected after power ON, the cooling indicator lamp lights up.
- Press Up/Down key to adjust setting temperature.
- Press Speed key to choose High/Mid/Low speed.

FAN MODE (FAN)

- When pressing mode key or choosing FAN mode by pressing the remote controller, the fan indicator lamp lights up.
- Press Speed key to choose High/Mid/Low fan speed.
- Temperature can't be set, it will operate at the room temperature.

DEHUMIDIFICATION MODE (DRY)

- When pressing mode key or choosing DRY mode by **pressing the remote controller, the dehumidification indicator lamp lights up.**
- **Remove the dehumidification water plug, insert the water drainage pipe (supplied).** Please the other end of the drainage pipe in a collection vessel or direct into a drain, ensure the drain or vessel is below the level or the outlet drain on the A/C. As shown on the **figure to the right.**
- **In dehumidification mode, if the room temperature is $\geq 17^{\circ}\text{C}$ the compressor will switch on.** If the room temperature is $\leq 16^{\circ}\text{C}$ the compressor will switch off. Once the room temperature achieves $\geq 17^{\circ}\text{C}$ the compressor will switch on.
- **In dehumidification mode, the fan is defaulted to run at low speed, and air speed can't be adjusted.**
- The temperature can't be set when using the dehumidify function. Remove the exit pipe plug otherwise it will cause a decrease in performance and appear "FL" water full alarm.

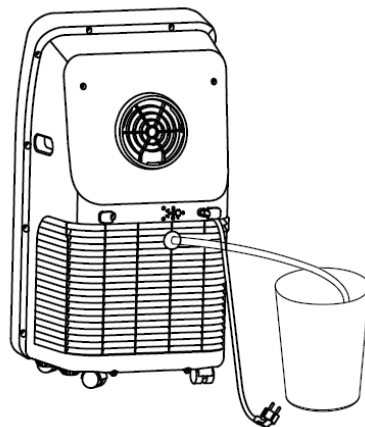

TIMER MODE

- Whilst the unit is in standby mode, press the Timer button to set the ON time. Press the UP or DOWN key to adjust the delay before the A/C switches on. Note the units displayed are in hours (1-24hrs) and only allows to set the switch on time. The timer indicator will illuminate.
- Whilst the unit is ON, press the Timer button to set the OFF time. Press the UP or DOWN key to adjust the delay before the A/C switches off. Note the units displayed are in hours (1-24hrs) and only allows to set the switch on time. The timer indicator will illuminate.



CLEAN AND MAINTENANCE

DRAINAGE METHOD

This product is equipped with automatic water vaporization system. The condenser is cooled with the circulating of condensing water, so as to improve cooling efficiency and save energy.

- If the internal vessel is full of water, the display screen will display "FL", and the compressor stops working automatically. After power off, unscrew the water cover, pull out the water plug to drain off water, and it will become normal after being restarted.

MAINTENANCE

Notice: in order to avoid electric shock, please turn off the A/C and unplug before maintenance or repair.

CLEANING

- Unplug before cleaning.
- Wipe with soft semi-dry cloth. Don't use chemical cleaners.

FILTER SCREEN

- Wash the filter screen once every two weeks. If it is blocked by dust, efficiency of the A/C will be reduced.
- Take out the air inlet grille and pull out the filter screen at both sides according to the direction shown in the following figures.
- Put the filter screen into the warm water (about 40°C) added with neutral detergent, dry the filter after cleaning in the shade, avoid direct sunlight.

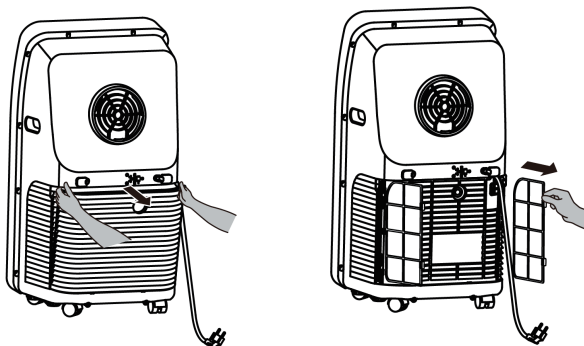

SEASONAL CLEANING

If the A/C will not be used for a long time:

- Pull out the water plug to drain.
- Run the A/C in fan mode for 2H until its dry inside.
- Turn off the A/C and unplug.
- Wash the filter screen and reassemble it.
- Dismantle the exhaust duct and store it properly.
- Cover the A/C with a plastic bag and place it in a dry place.

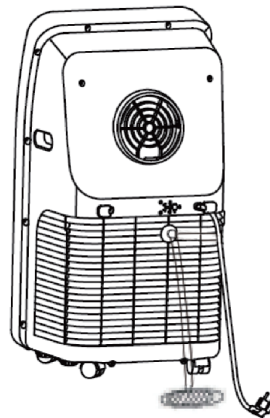



COMMON FAILURES AND DIAGNOSIS

INTELLIGENT ERROR DETECTION

Error-detecting code	Multi-functional defection
E1	Error of the coils temperature sensor.
E2	Error of indoor temperature sensor.
E4	Anti-freezing protection: temperature of the coil is too low and whole A/C is off. When temperature exceeds 8°C, the protection is released and previous working state is recovered.

FUSE PARAMETERS Specification: ø5×20mm - Voltage: 250V AC - Current: 3.15A

TROUBLE SHOOTING

Trouble	Cause	Solution
The A/C doesn't work.	Not plugged in.	Plug the unit in.
	The display panel displays "FL".	Restart the A/C after the power off and draining, normal function should return.
	Time off function is started.	The A/C can be restarted 3 minutes after being turned off.
The A/C starts frequently.	Direct sunlight.	Remove/ limit direct sunlight or re-position the A/C.
	Doors and windows keep opening; there are lots of people or a heat source in the room.	Close door and windows, remove heat source.
	Filter screen is very dirty.	Clean or replace it.
	Air inlet or outlet is blocked.	Remove blockage.
The A/C is making a loud noise.	The A/C is placed unevenly.	Place it on a even and firm ground, avoid shaking.
The compressor doesn't work.	Its delay protection has started.	Wait for 3 minutes, turn it back on after temperature decreases.

Notice: When there is any abnormal performance to the A/C, turn the unit off and unplug, then contact a qualified professional person, the distributor or the manufacturer.

The above technical parameters are subject to change without notice.



Disposal (UK WEEE Regulations)

This appliance must not be disposed of with household waste.
Dispose through authorised UK WEEE collection or recycling facilities in accordance with local regulations.
Proper disposal helps protect the environment and public health.

WARRANTY

- 24-month warranty from date of purchase.
- Proof of purchase required.
- Covers defects in materials and workmanship under normal domestic use.
- Excludes misuse, accidental damage, wear parts, and unauthorised repair or modification.

Warranty service does not extend the original warranty period.

For assistance, contact your retailer or authorised service provider.

UK REGULATORY COMPLIANCE

This appliance complies with applicable UK legislation, including:

- Electrical Equipment (Safety) Regulations
- Electromagnetic Compatibility Regulations
- The Restriction of Hazardous Substances (RoHS) Regulations
- EN 60335-2-40 (Safety of household air-conditioners)
- UKCA marking requirements

⚠ In the event of malfunction, do not open the housing. Repairs must be carried out by a qualified technician only.



TECHAIR

PORTABLE AIR CONDITIONER