

**BR15A**

**Built-under Larder Fridge**

**Instruction manual**

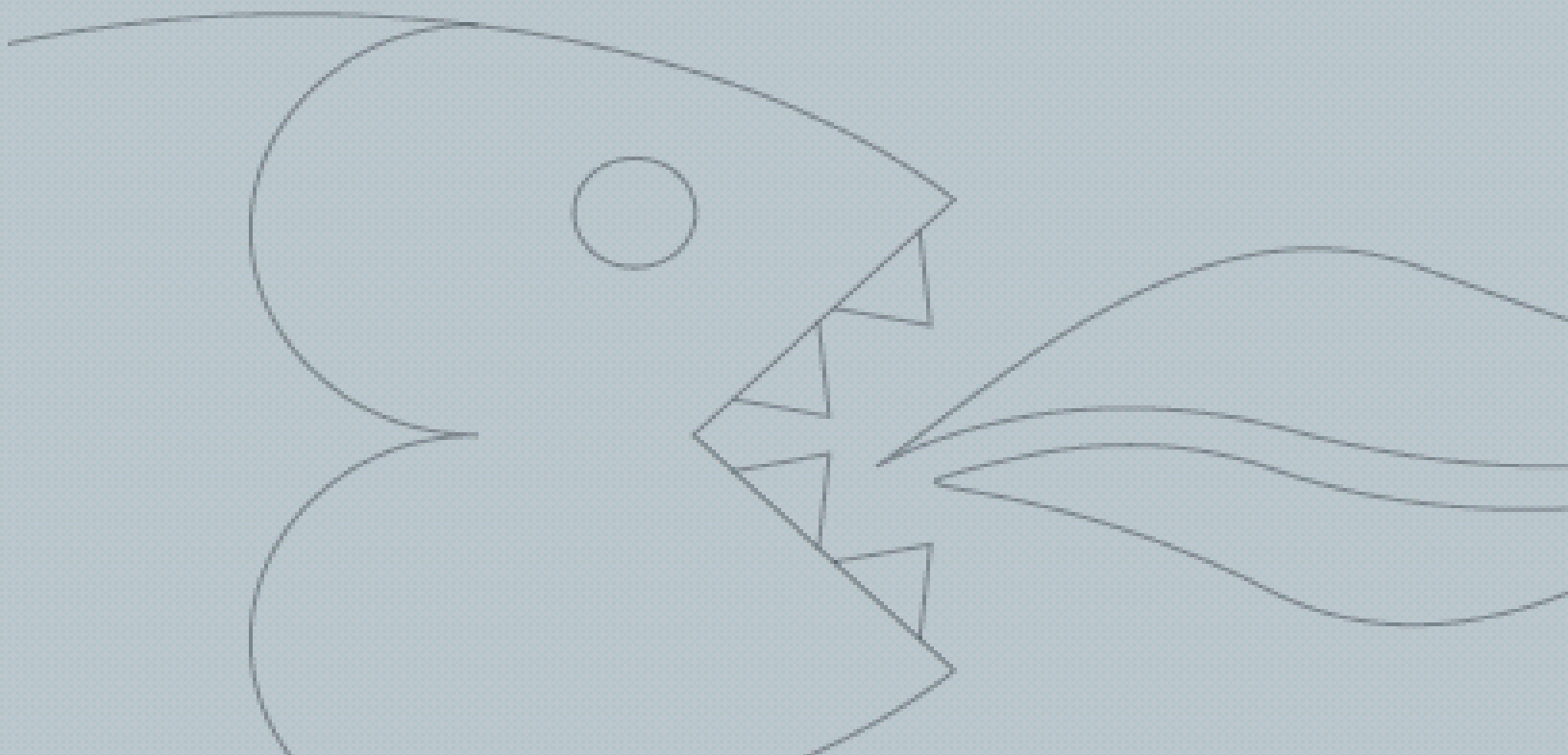

User Manual for your  
**BR15A**  
**BUILT-UNDER LARDER**  
**FRIDGE**



***NOTE: This User Instruction Manual contains important information, including safety & installation points, which will enable you to get the most out of your appliance. Please keep it in a safe place so that it is easily available for future reference.***

# CONTENTS

<b>YOUR APPLIANCE'S SPECIFICATIONS .....</b>	<b>3</b>
--	----------

<b>SAFETY INFORMATION / ENVIRONMENTAL NOTE ..</b>	<b>4</b>
---	----------

<b>USING YOUR FRIDGE.....</b>	<b>5-12</b>
<b>YOUR BR15A FRIDGE .....</b>	<b>5</b>
<b>BEFORE USING YOUR FRIDGE.....</b>	<b>6</b>
<b>USING YOUR FRIDGE.....</b>	<b>7-10</b>
<b>CLEANING AND MAINTENANCE.....</b>	<b>11-12</b>
<b>DEFROSTING .....</b>	<b>13</b>

<b>TIPS FOR SAVING ENERGY .....</b>	<b>13</b>
<b>INSTALLING YOUR FRIDGE.....</b>	<b>14</b>
<b>FITTING THE DÉCOR DOOR .....</b>	<b>16</b>
<b>LEVELLING YOUR FRIDGE TO YOUR FLOOR .....</b>	<b>17</b>
<b>HOW TO REVERSE THE DOOR SWING .....</b>	<b>18</b>

<b><i>TROUBLESHOOTING .....</i></b>	<b><i>19</i></b>
-------------------------------------	------------------

<b>CONDITIONS OF GUARANTEE.....</b>	<b>20</b>
<b>CONTACT DETAILS.....</b>	<b>21</b>

## Specifications of your BR15A Built-under fridge

***Congratulations on purchasing a Baumatic BR15A built-under fridge!***

**Your Fridge has:**

- ***Gross capacity: 144 litres***
- ***Net capacity: 143 litres***
- ***Energy efficiency class: A***
- ***Star rating: \*\*\*\****
- ***Adjustable thermostat***
- ***Automatic fridge defrost***
- ***3 Safety glass shelves***
- ***Egg rack***
- ***Salad crisper***
- ***Reversible door***
- ***Adjustable feet***
- ***1 Bottle rack***
- ***1 Dairy compartment***
- ***1 Half length utility rack***

***Dimensions mm (H x W x D)***  
***818-898 x 596 x 545***

To fully enjoy using your appliance long into the future, please firstly familiarise yourself with the specifications, safety advice and operational instructions included in this manual.

**NOTE:**

When you install your Fridge, it is important to bear in mind its climatic rating.

In order to find out the climatic rating of your appliance, check the data rating tag inside your refrigerator. It indicates the ambient temperature range within which your appliance will function.

## Important Safety Information: Please Read this before installing & using.

### ELECTRICAL SAFETY

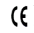
 This appliance complies with Directives 89/368/EEC, 73/23/EEC and following changes.

- **NOTE** - This appliance must be grounded. In the event of a malfunction or breakdown, grounding will reduce the risk of electric shock by providing a path of least resistance of electrical current. You will be able to tell if it is because a non-grounded appliance will give off an electrical discharge. **Manufacturer declines all responsibility for any damage due to non-grounding of appliance.**
- DURING THE GUARANTEE PERIOD ONLY BAUMATIC SERVICE ENGINEERS OR AN AUTHORISED AGENT OF BAUMATIC SHOULD CARRY OUT REPAIRS ON THIS UNIT.
- DO NOT USE IF THE SUPPLY CORD IS DAMAGED. NEVER TAKE RISKS WITH FIRE!
- **ENSURE YOU CONNECT THIS APPLIANCE TO A SUPPLY RATED AT 220-240V (or 200-230V) and 50HZ.**
- **NOTE:** the supporting structure is constructed in panels of treated sheet steel, electrostatically enamelled to resist ill-treatment and to give long-lasting beauty and shine.

 Do not attempt to alter the specifications of this appliance. Doing so could damage the machine, cause injury & invalidate your warranty. **DO NOT USE ADAPTERS/SHUNTS.**

 Do not allow children to play with, near or inside this appliance.

 Do not pull on the power supply cable to free the plug from the wall!

 Do not attempt to use your appliance outdoors or any place where it is likely to come into contact with the elements.

 Do not pull out or insert the plug with wet hands.

 Before any cleaning or maintenance work, ensure that the appliance has been disconnected from the power supply.

 Never allow the back coils of the Appliance to come into contact with any wall surface. **ALWAYS ENSURE THAT THE SPACE INTO WHICH YOU ARE PLACING YOUR APPLIANCE IS FREE OF STORED ITEMS SUCH AS PAPERS OR OTHER FLAMMABLE MATERIALS.**

 NEVER block the VENTILATION OPENINGS OF THE APPLIANCE EITHER INSIDE OR ON ITS EXTERIOR. IT IS VITAL TO KEEP YOUR APPLIANCE WELL VENTILATED SO THAT THERE IS PROPER AIR FLOW BETWEEN THE BOTTOM OF THE UNIT AND THE PLINTH / KICK PLATE ON WHICH IT IS SITTING.

 WARNING – DO NOT DAMAGE THE REFRIGERANT CIRCUIT. AT THE END OF THE FUNCTIONAL LIFE OF THE EQUIPMENT (WHICH USES COOLING GAS R600a [ISOBUTANE]) AND INFLAMMABLE GAS INSIDE THE INSULATING FOAM, IT MUST BE PLACED IN SAFETY BEFORE SENDING IT FOR PROPER WASTE DISPOSAL.

**PLEASE OBSERVE ALL INSTALLATION ADVICE IN THIS MANUAL FOR SAFE USAGE OF YOUR APPLIANCE.**

**Note:** Before discarding an old refrigerator/freezer, switch off and disconnect it from the power supply. Cut off and render any plug useless. Ensure that the door cannot jam (removing it is best), regardless of whether or not it can be pushed open from inside. **AN OLD FRIDGE/FREEZER CAN BE A DEADLY PLAYTHING FOR CHILDREN!**

### CONFORMITY TO W.E.E.E. DIRECTIVE

This appliance is marked according to the European directive 2002/96/EC on Waste electrical and Electronic Equipment (WEEE). By ensuring this product is disposed of correctly, you will help prevent potential negative consequences for the environment and human health, which could otherwise be caused by inappropriate waste handling of this product.

The symbol  on the product, or on the documents accompanying the product, indicates that this appliance may not be treated as household waste. Instead it shall be handed over to the applicable collection point for the recycling of electrical and electronic equipment.

Disposal must be carried out in accordance with local environmental regulations for waste disposal. For more detailed information about treatment, recovery and recycling of this product, please contact your local city office, your household waste disposal service or the shop where you purchased the product.

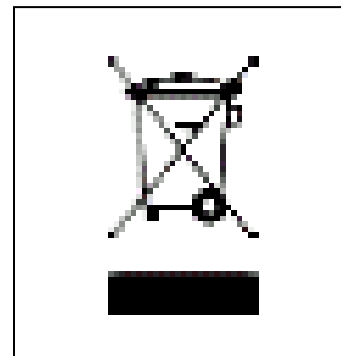

# Your BR15A Built-under Larder-Fridge:

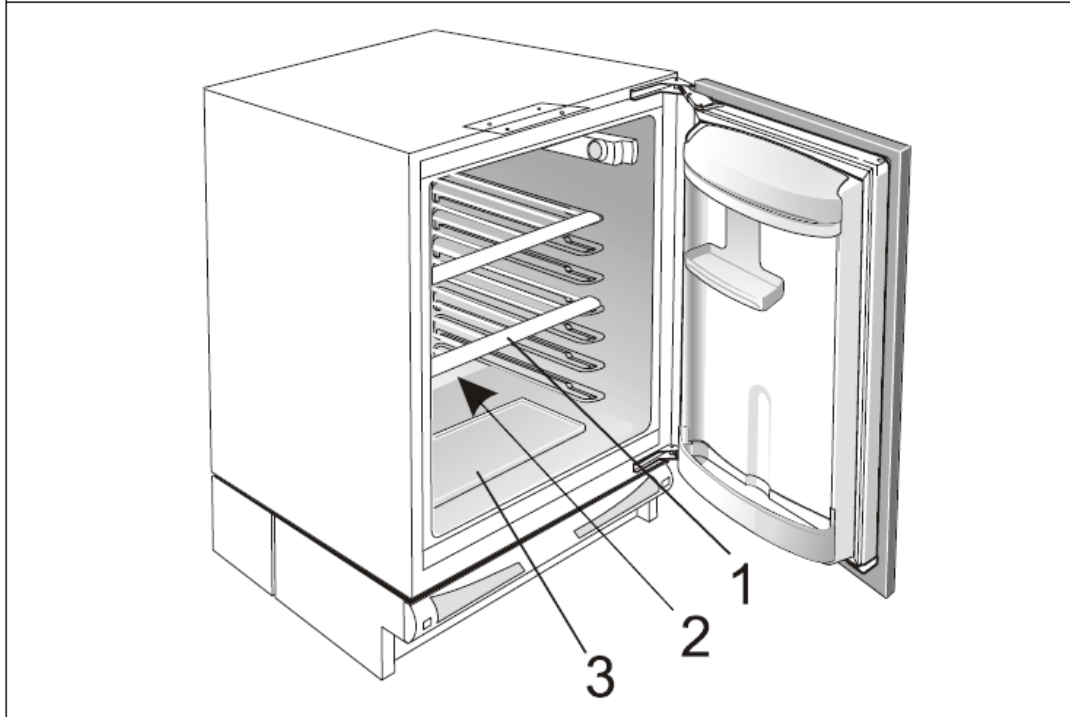

## KEY

**A**

**1 SHELF:** The shelves may be placed in any of the guide slots within the interior of the appliance. They are protected from sliding out.

To remove a shelf, simply lift the front of the shelf and carefully pull it out of the grooves. Quickly perishable food should be stored at the back (the coldest part of your refrigerator).

### **2 DEFROST WATER OUTLET**

The interior of the fridge is cooled with the cooling plate at the rear wall. Beneath this, there is a channel and an outlet for defrosted water. It is important that this channel is never clogged.

Use a plastic straw to clear away any dirt.

### **3 CRISPER TRAY & SERVING TRAY**

The crisper tray at the bottom of your refrigerator is covered by the serving tray. This cover protects fruit and vegetables stored within from drying out.

Note that the door liner holds various shelves containing holders for storing eggs, cheese, butter and yoghurt, as well as smaller packages, tubes, cans, etc. The lower shelf is used for storing bottles.

**THE LIGHT COMES ON WHEN THE DOOR IS OPENED.**

**NOTE: BEFORE Using your BR15A FRIDGE:**

## **UPON DELIVERY:**

When your Fridge has been delivered, you will need to wait approximately **8 hours** before turning it on. The fluid of the compressor installed in the appliance will need time to settle. **PLEASE DO NOT PLUG IN ANY EARLIER THAN THIS!**

.....  
**NOTE:**

THERE CAN BE AN ODOUR WHEN YOU FIRST SWITCH ON THE APPLIANCE. IT WILL VANISH WHEN THE UNIT STARTS COOLING.

*We recommend that you have the Fridge delivered near to where you plan to install it so that this fluid can settle.*

## **SITUATING YOUR FRIDGE**

**CAUTION: DO NOT PLACE THE APPLIANCE NEAR HEAT SOURCES AND FOLLOW THE INSTALLATION ADVICE SHOWN ON PAGE 14.**

***FOR FULL INSTALLATION ADVICE, PLEASE SEE PAGE 14***

**MAKE A NOTE OF THE LOCATION FOR YOUR NEW FRIDGE. MAKE SURE THAT IT WILL FIT PROPERLY SO THAT:**

- 1) The doors can open freely and completely.**
- 2) You can access your food conveniently.**
- 3) There is sufficient space at the back for the cooling coils to give off heat safely & that they do not touch the plug (see SAFETY SECTION).**

*NOTE: You can reverse the swing of the door to customise the unit to your location. Please see page 17 for details.*

## USING your Baumatic BR15A FRIDGE

### **YOU SWITCH ON YOUR APPLIANCE by PLUGGING IT IN &**

#### **SETTING THE THERMOSTAT**

inside the Fridge at  
the upper right-  
hand side:

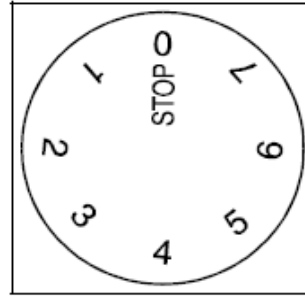

*Your Fridge's thermostat automatically regulates the inside temperature of the compartments. By rotating the thermostat knob from a low to a higher number position, colder temperatures can be obtained.*

### **Refrigerator Thermostat setting**

**Note:** Turning the knob setting towards 7 will make all the compartments of your fridge colder. Because the interior temperature may dip below 0°C, you should not leave your fridge on this setting for long periods.

**Settings 3-5:** Use these mid-settings for longer storage of food in the fridge = mid-coldness. Settings below this will give a milder coldness to the interior of the fridge.

**0:** This setting will make the fridge **STOP** (the cool system is deactivated), although the light will still function.

**REMINDER:** *On the maximum setting, your fridge will work harder to maintain this low temperature. So, after you reach this temperature, you should turn the knob to a milder setting (depending on long or short-term storage intentions).*



## USING your Baumatic BR15A FRIDGE

**Reminder:** Allow the unit time to settle after delivery. If your plug and power socket are now behind the fridge and you still need to move the unit into place, be especially careful. Remember to leave a safe distance between the back of the fridge and the wall or rear of the unit cabinet.

- **You switch your fridge OFF by turning the thermostat knob to position '0'.**

**NOTE:** When you first switch on the appliance, allow 24 hours for it to cool down to the desired temperature. During this time, DO NOT open the door often or place a lot of food inside the unit.

**WARNING!** If the appliance is switched off then switched back on again after a short period, the compressor will start up again after approximately half-an-hour. This is part of the normal operation of the appliance.

## ARRANGING FOOD IN YOUR FRIDGE

- *To reduce humidity and the consequent increase of frost, NEVER place liquids in unsealed containers in the refrigerator. Frost tends to concentrate in the coldest parts of the evaporator. In time, the unit will need more frequent defrosting if too much humidity develops inside it.*
- *Make sure that you arrange food in such a way that the door can close completely. Be especially wary of protruding items between shelves and the inside of the door, such as bottles.*
- *NEVER place warm food inside the refrigerator. Warm food must be allowed to cool at room temperature. It should then be arranged to ensure adequate air circulation in the refrigerator compartment.*
- *DO NOT ALLOW anything to touch the refrigerator's back wall as it will cause frost. Also, packaging, especially paper, can stick to it and spoil.*
- *Crispy / delicate foods should be stored in the coldest parts of the fridge.*
- *DO NOT open the refrigerator door too often or leave it open for long spells of time.*
- *ARRANGE meat and cleaned fish (wrapped in packages or sheets of plastic) which you will then use within 1-2 days.*
- *You can put fruits and vegetables into the crisper without packing them.*
- *Use the egg holders provided in the door space to store your eggs.*
- *Unpleasant odours within may mean your fridge needs cleaning or that food has spoiled.*
- *If you are planning on being away from your refrigerator for a few days (such as going on holiday), make sure that you remove quickly perishable articles of food from your fridge before you go and dispose of them.*

## NOTES ON USING YOUR FRIDGE

**ALWAYS Cover and wrap foods, especially if they are PUNGENT.**

- **DO NOT place paper or plastic on the shelves which would block the flow of air through the grids.**

**NOTE:** At the maximum cold setting, with a high outside (ambient) temperature and well-stocked (full or nearly full) compartments, the Fridge's operation may be continuous, leading to the formation of some frost on the evaporator.

Should this happen, the knob must be turned to a less cold position to allow automatic defrosting.

**This will also allow lower energy consumption.**

**REMINDER:** *You should regulate the temperature of your Fridge bearing the following in mind:*

- **Ambient temperature**
- **How often the doors are opened and closed**
- **Quantity of food stored in the compartments**
- **Moisture content of what you place in your fridge**
- **The location of your appliance**

### **IN CASE OF A BLACKOUT (GENERAL POWER FAILURE)**

In case of Power Failure, find out how long the electricity will be off. If the failure is not going to be for any longer than 12 hours, leave the food in the freezer and keep the door closed.

If the POWER FAILURE is going to last longer than 12 hours and some food defrosts, consume the latter as soon as possible.

**LONG ABSENCES (holidays, etc.):** In the case of long absences, the appliance must be switched off, emptied out completely, dried and the doors left open to prevent the formation of mould and unpleasant odours.

## CLEANING / MAINTENANCE

NOTE: Before attempting to clean your appliance, UNPLUG IT and make sure you do the following:

WE RECOMMEND THAT YOU CLEAN AND MAINTAIN YOUR REFRIGERATOR ONCE A MONTH.

- ✓ Pay particular attention to the sealing rubber bars of the doors. These need to be kept clean for hygienic reasons as well as to allow the door to close properly.
- ✓ Leave the door open during cleaning.
- ✓ In order to collect the defrosted water, take out the bottom drawer and soak up the water using a sponge as shown in the figure pictured below.
- ✓ Clean the inside of your Fridge using a solution of soda bicarbonate in warm water (1 tablespoon Bicarbonate to 2 litres of water).
- ✓ Clean the condenser (back of unit) with a broom once a year.

**NEVER USE SOLVENTS TO CLEAN THE INSIDE OF YOUR FRIDGE-FREEZER.**

**MAINTENANCE** FROM TIME TO TIME, YOU WILL NEED TO REPLACE THE INTERNAL BULB. REMEMBER TO UNPLUG YOU APPLIANCE FIRST

**Find the lamp housing in the top right of the refrigerator's interior.**  
**Gently move the transparent lamp cover plate from the lamp cradle.**  
**Unscrew the bulb and replace with a new one, maximum (10W).**

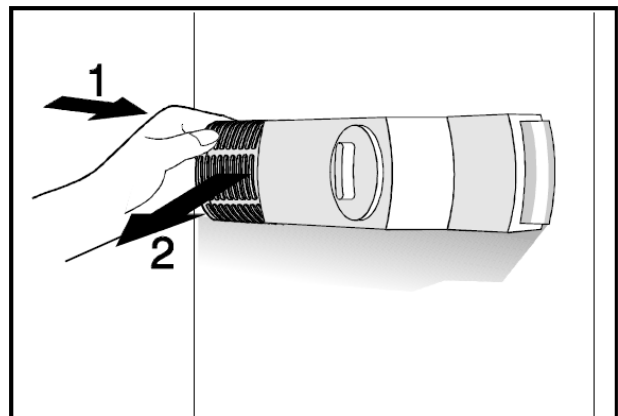

## HOW TO CLEAN THE CONDENSER –

**The condenser consists of the coil structure at the back of the refrigerator. Over time, it may gather a large amount of dust.**

**(SEE NEXT PAGE FOR INSTRUCTIONS ON CLEANING)**

**Your appliance is equipped with a sound alarm which will sound to indicate that it is time to clear this dust from the condenser structure at the back of your appliance.**

- **Disconnect the appliance from the power supply.**
  - **If the air opening in the bottom rail of the fridge is obstructed, remove the items responsible.**
    - **If dirty or dusty, you should clean or vacuum it (see the figure below).**

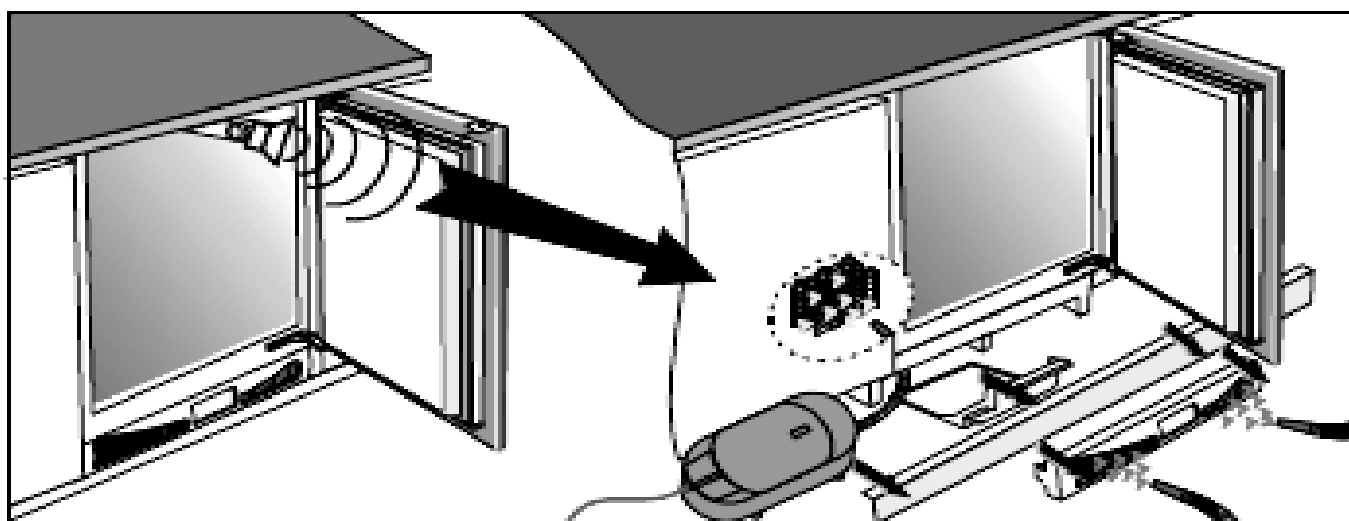

### **To remove Dust from the Condenser**

1. **Remove the bottom board of the unit cabinet.**
2. **Push a finger through the opening in the bottom rail and release the fastener.**
3. **Pull the rail towards you and remove it.**
4. **Pull the condenser dish out.**
5. **Use the vacuum cleaner to clean the dust from the condenser.**
6. **Replace the condenser dish and the bottom rail in the opposite order to taking them out.**

## DEFROSTING

Defrosting occurs fully automatically in the refrigerator compartment during normal operation. The defrosted water collected by the evaporating tray evaporates automatically.

**NOTE:** The evaporating tray & water drain hole should be cleaned periodically with a plastic straw to prevent water from collecting on the bottom of the refrigerator instead of flowing out.

## TIPS FOR ENERGY SAVINGS

- ✓ Try not to open the door too often, especially when the weather is wet and hot. Once you open the door, be sure to close it as soon as possible.
- ✓ Use higher thermostat settings only if essential and not for constant, long-term use.
- ✓ Before loading the appliance with packages of fresh foods, ensure they are cooled to an ambient temperature (except in the case of soup).
- ✓ Ice and frost layering will increase energy consumption, so defrost & clean the appliance as soon as the layer is 3-5mm thick in your icebox.
- ✓ If the door seal (gasket) is damaged, the energy consumption will be much higher. To keep the sealing in good condition, be sure not to spill oils or fats on it. A damaged seal will need to be replaced. Make sure that if you have reversed the door, you fluff out the crushed side of the seal with a hairdryer before reinserting it.
- ✓ The condenser at the back of the appliance must always be clean and free of excessive dust.

## INSTALLING YOUR BR15A REFRIGERATOR

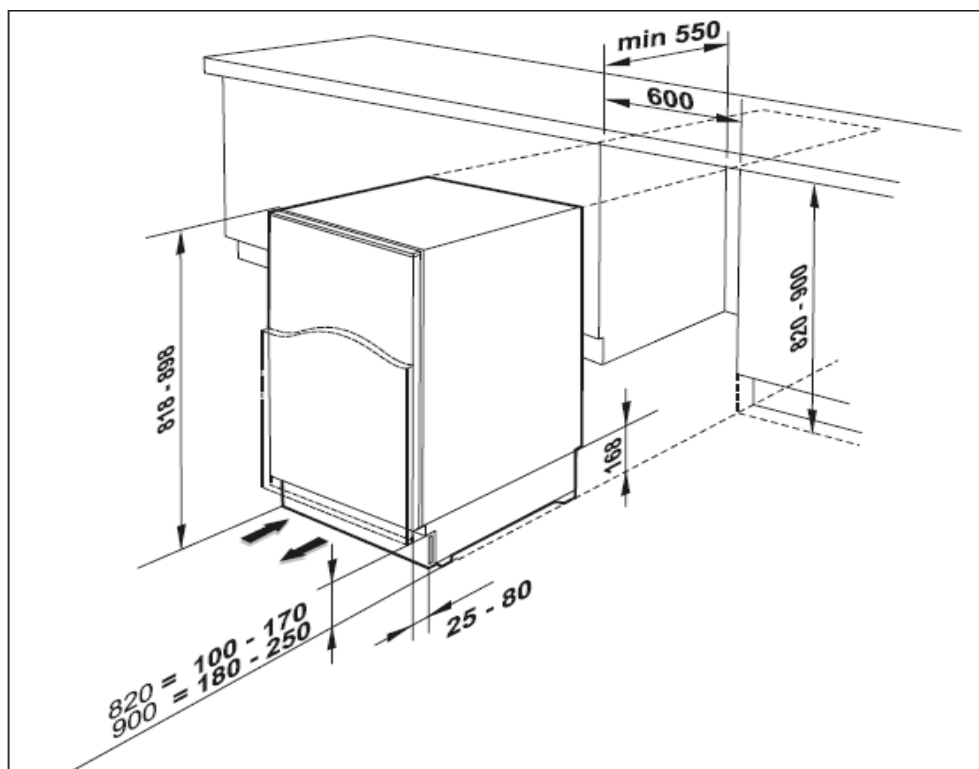

**NOTE – YOU NEED THE SPACES SHOWN AT LEFT TO INSTALL YOUR APPLIANCE.**

**Ensure there is sufficient space behind the cooling coils at the back of your Fridge**

1) Ensure that you are going to be placing your fridge away from heat sources and in a well-ventilated position. This should be at least 3 cm

away from electric stoves and 30 cm from oil or coal stoves. Do not place the appliance in the path of direct sunlight.

2) After removing the rear wall of the cabinet, push the appliance into the kitchen unit's space and allow at least 4mm free space on both sides between the appliance and the side walls of the kitchen unit (Fig.1, at right). Allow 38mm space between back of the fridge and the wall.

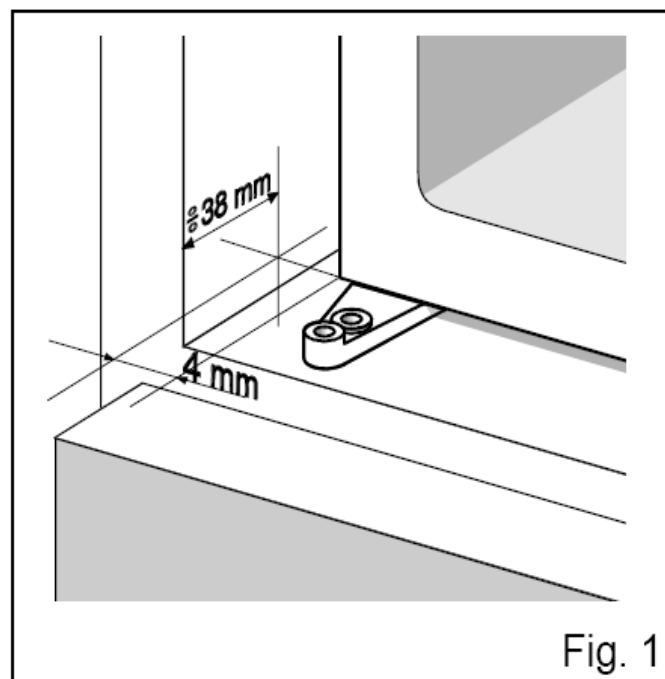
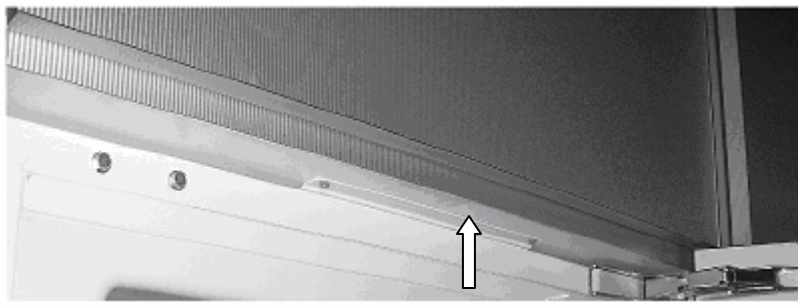

Fig. 1

## **INSTALLING YOUR APPLIANCE- CONTINUED**

### **Fitting Bar**

Install the Fitting Bar (shown in the picture below) so that it attaches to the top of the appliance and underneath the top of the cabinetry, indicated by the arrow:



\*Please be aware that the Fitting Bar is not attached to the appliance and needs to be secured during installation.



# Fitting the Décor Door

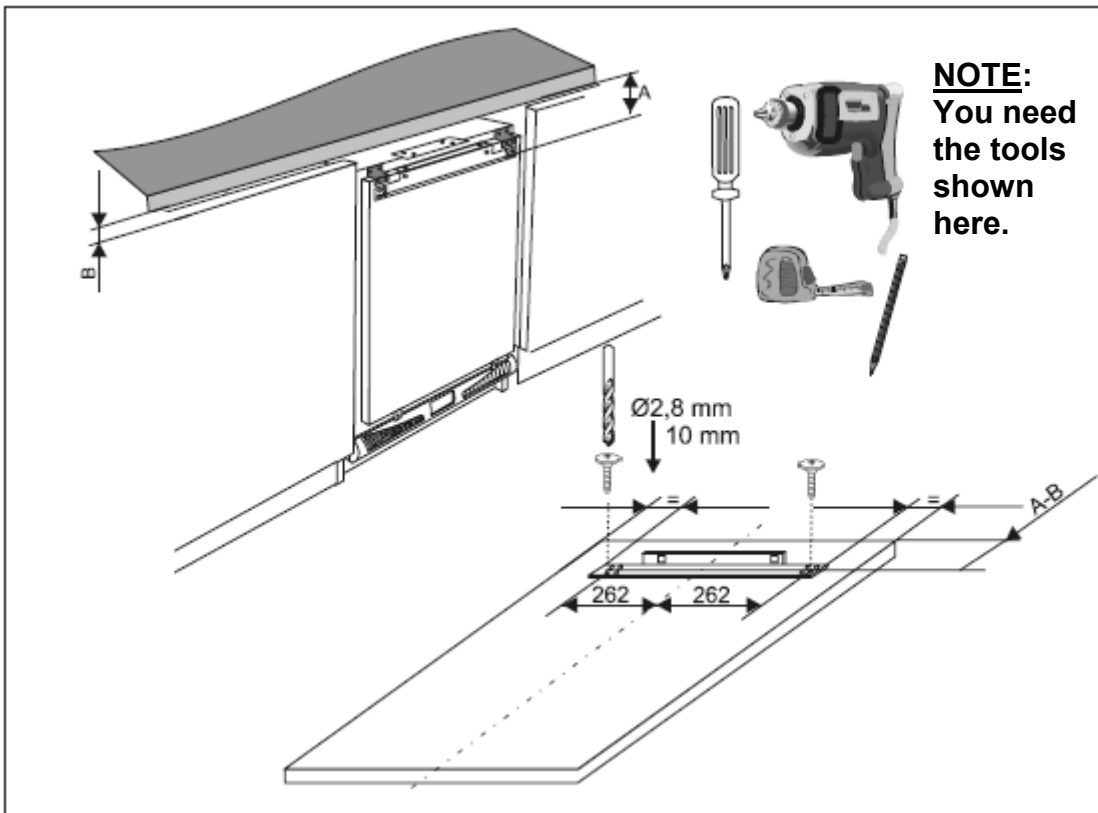

1) Using a 2.8mm diameter bit, make holes sufficient to attach the rail as shown on the left. NOTE – door area **below** the rail must reach to just below appliance.

2) Fix the hanging rail onto the inside of the décor door using two 10mm screws, centering it so that 262mm of its width is on either side of the imaginary vertical middle line of the décor door.

3) Clasp the eyelet holes in the rail on the inside of the décor door over the bolts protruding from the top edge of the refrigerator door. Secure these using the nut caps provided, as shown in the above illustration. Make sure that you have the décor door attached levelly before proceeding to the lower fastenings as shown on right.

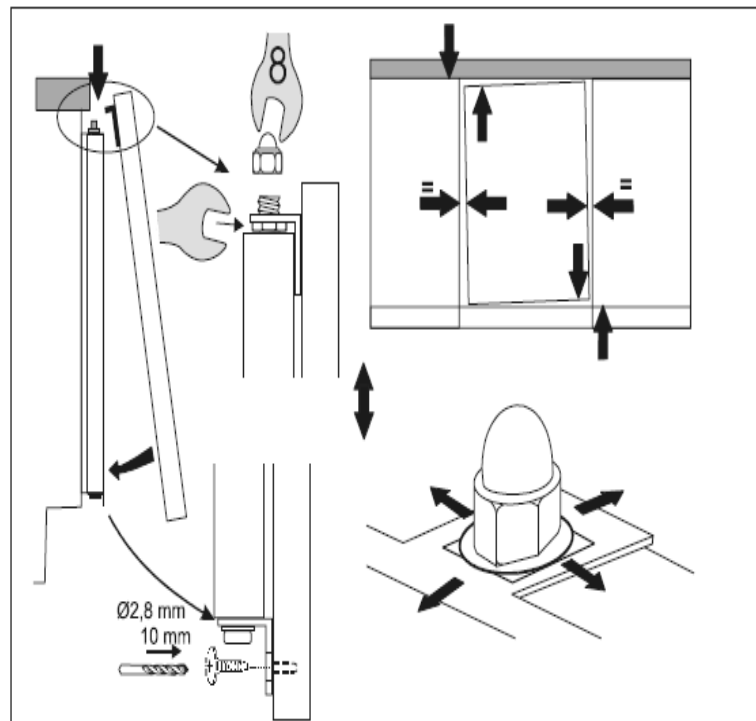

## Fastening your Refrigerator to under the Worktop

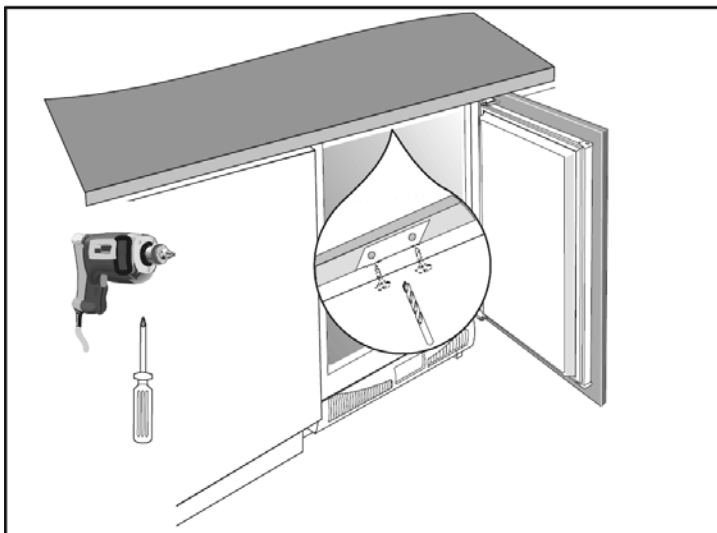

Drill two holes and attach your fridge to the underside of your worktop as shown in figure at left.

## Adjusting the feet to level your Appliance

Adjust the feet (see picture at right) until your Fridge sits levelly on your floor. You can level your unit using these adjustable feet to compensate for dips and rises in your floor surface.

**NOTE:** You can adjust the height from 82 to 90 cm. The height MUST be adjusted before the appliance is built into the unit space designated for it.

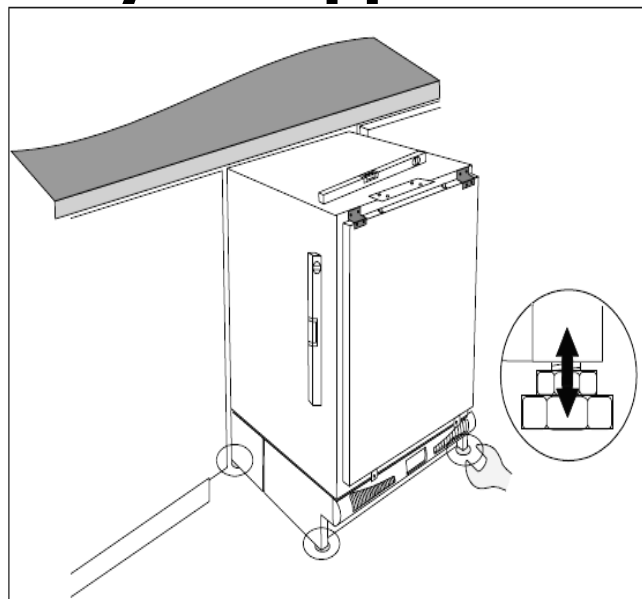

**DO NOT MOVE THE FRIDGE WHEN THE FEET ARE EXTENDED HIGH!**

## Adjusting the base

Place the plinth fascia over the area indicated with arrows and push into place

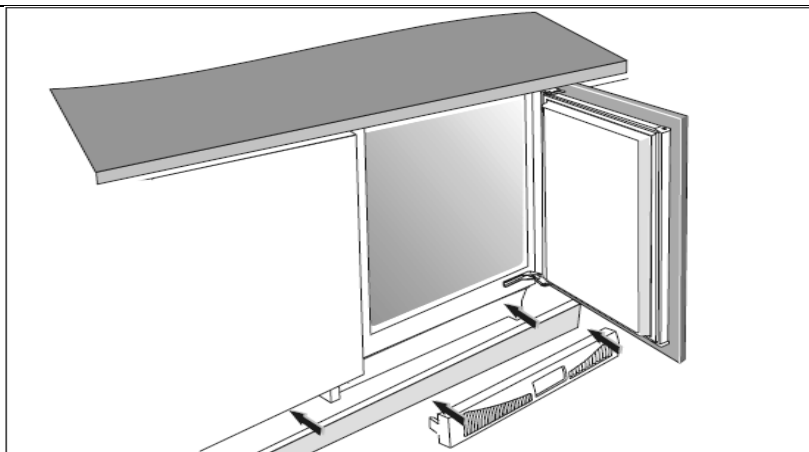

# Reversing the swing of the Door

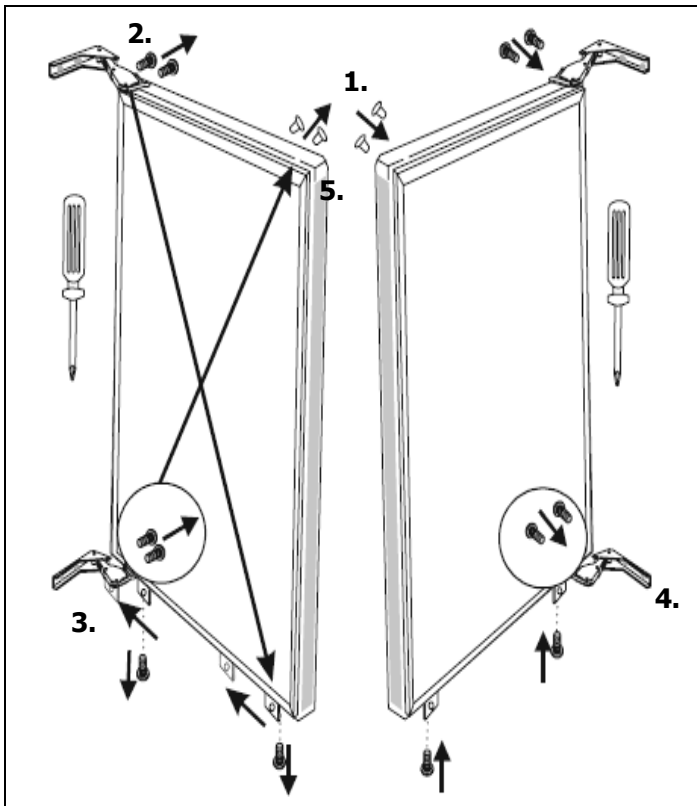

**Figure 1 – View of doors**

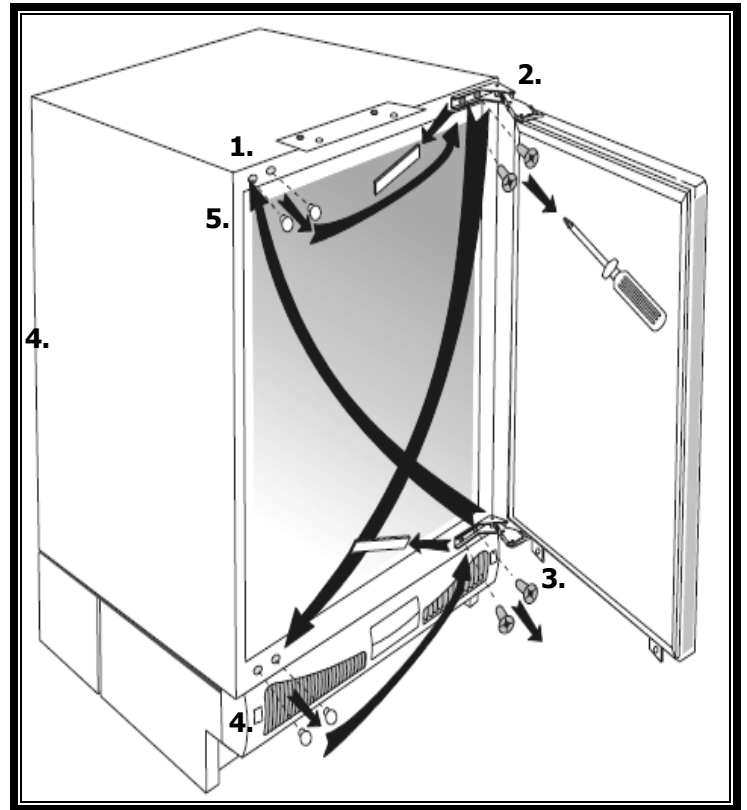

**Figure 2 - View of doorway**

**NOTE:** All numbered references apply to both pictures for your convenience.

- 1) On the hinge-less side of the fridge's door, remove the caps (1) that cover the hinge bracket holes. Keep these in a safe place nearby.
- 2) Remove the upper hinge (2) using a star-head screwdriver to remove the screws.
- 3) Detach and remove the lower hinge (3) by doing the same as you had to the top hinge.
- 4) Flip the top hinge and bring it over and down to the bottom corner that is diagonally opposed to it (4). Screw it in.
- 5) Flip the bottom hinge and bring it over and up to the top corner that is diagonally opposed to it (5). Screw it in.

- 6) Attach the door to the doorway, ensuring that all the holes where the hinges had formerly been screwed into are now covered with the caps you

## Troubleshooting

*Trace a problem using the table below instead of having to call for help.*

PROBLEM	WHAT TO DO
<b>YOUR FRIDGE DOES NOT APPEAR TO BE WORKING / NO APPARENT POWER</b>	<b>CHECK THAT THE PLUG IS WELL-INSERTED INTO THE POWER SOCKET</b>
	<b>CHECK THAT THERE IS POWER FROM THE MAINS – THERE MAY BE A BLACKOUT OR YOUR FUSES MAY HAVE BLOWN.</b>
	<b>CHECK THAT THE ELECTRONIC THERMOSTAT (REGULATOR FOUND ON THE INSIDE WALL OF THE FRIDGE-FREEZER NEAR THE TOP) IS IN THE RECOMMENDED FUNCTIONING POSITION AND NOT '0' (OFF).</b>
	<b>CHECK THAT THE SOCKET IS SUFFICIENT AND NO ADAPTER OR EXTENSION LEADS HAVE BEEN USED.</b>
	<b>CHECK THAT THE POWER SUPPLY VOLTAGE CORRESPONDS TO THE APPLIANCE.</b>
<b>YOUR FRIDGE APPEARS TO BE PERFORMING POORLY</b>	<b>YOU HAVE OVERLOADED THE APPLIANCE OR FOOD HAS BEEN PACKED TOO TIGHTLY. TAKE OUT AND CONSUME FOOD; LOOK FOR OUT-OF-DATE FOOD THAT CAN BE DISPOSED OF.</b>
	<b>THE THERMOSTAT SETTING IS SET TOO LOW. SET IT HIGHER.</b>
	<b>ENSURE THAT THE DOOR HAS BEEN CLOSED PROPERLY. FOR INSTANCE, THERE MAY BE A PROBLEM INSIDE THE UNIT, KEEPING THE DOOR OPEN OR ANOTHER FAULT, SUCH AS A BROKEN OR MISSING DOOR SEAL.</b>
	<b>ENSURE THAT THERE IS NO DUST ON THE CONDENSER.</b>
	<b>ENSURE THAT THERE IS ENOUGH ROOM AT THE REAR AND SIDES OF THE UNIT.</b>
<b>THERE IS A NOISE</b>	<b>THE COOLING GAS WHICH CIRCULATES MAY MAKE A SLIGHT NOISE (BUBBLING SOUND) EVEN WHEN THE COMPRESSOR IS NOT RUNNING. THIS IS NORMAL. IF THESE SOUNDS CHANGE, ENSURE: YOUR UNIT IS WELL LEVELLED / NOTHING IS TOUCHING THE REAR OF THE UNIT / NO MATERIAL ON THE APPLIANCE IS VIBRATING. NOTE: A SOUND LIKE FLOWING WATER IS PERFECTLY NATURAL AS IT INDICATES THAT THE REFRIGERANT IS FLOWING. THIS IS NOT A MALFUNCTION.</b>

***ADDITIONAL NOTE: SHOULD THE CABINET'S SIDE PANEL HEAT UP, THIS IS NORMAL. IT WILL DO THIS IN SUMMER WITH A HIGH AMBIENT TEMPERATURE OR IF THE DOOR HAS BEEN OPENED AND CLOSED FREQUENTLY. IT IS THE RESULT OF HEAT'S DISSIPATING FROM INSIDE THE CABINET AND IS NOT DETRIMENTAL TO YOUR REFRIGERATOR IN ANY WAY.***

|

|

|

## Baumatic Ltd. Conditions of guarantee

Dear Customer,

Your new Baumatic appliance comes complete with a free 12 month guarantee covering both parts and labour costs resulting from defective materials or workmanship.

Baumatic also gives you the opportunity to automatically extend the guarantee period for a further 12 months at no extra cost, giving an initial guarantee period of 24 months. The extended guarantee period applies to England, Scotland, Wales and Northern Ireland only.

To qualify for your full 24 months guarantee you **must** register your appliance within 28 days of purchase to be covered under this guarantee. This can be done online via: [www.baumatic.co.uk](http://www.baumatic.co.uk) or through returning the guarantee card which can be found in each new Baumatic appliance.

\* In addition, your appliance is covered by a 5 year parts warranty. Baumatic Ltd will provide free of charge the parts required to repair the appliance, only if they are fitted by a Baumatic engineer, for any defect that arises due to faulty materials or workmanship within a period of 5 years from the original purchase date.

\* An additional 1 to 3 year insurance scheme for labour is available should you wish to extend the warranty period.

Should any person other than an authorised representative of Baumatic Ltd interfere with the appliance, the policy is negated and Baumatic Ltd will be under no further liability.

The guarantee covers the appliance for normal domestic use only, unless otherwise stated.

Any claims made under the terms of the guarantee must be supported by the original invoice/bill of sale issued at the time of purchase.

This guarantee is transferable only with the written consent of Baumatic Ltd.

If the appliance fails and is considered either not repairable or uneconomical to repair between 12 months (2 years if registered) and five years, a free of charge replacement will not be offered.

The guarantee for any replacement will only be for the remainder of the guarantee on the original product purchased.

The guarantee does not cover:

- Sinks and taps
- Failure to comply with the manufacturers instructions for use.
- The replacement of cosmetic components of accessories
- Accidental damage or wilful abuse.
- Subsequent loss or damage owing to the failure of the appliance or electrical supply
- Incorrect installation
- Losses caused by Acts of God, civil war, failure to obtain spare parts, strikes or lockouts
- Filters, fuses, light bulbs, external hoses, damage to bodywork, paintwork, plastic items, covers, baskets, trays, shelves, burner bases, burner caps, decals, corrosion, rubber seals.

In the course of the work carried out it may be necessary to remove the appliance from it operating position. Whilst all reasonable care will be taken, Baumatic Ltd cannot accept responsibility for damage sustained to any property whatsoever in this process.

This guarantee is in addition to and does not diminish your statutory or legal rights.

### Contacting Baumatic Ltd

Sales	Service	Spares	Technical/Advice
TEL: 0118 933 6900	TEL: 0118 933 6911	TEL: 0118 933 6922	0118 933 6933
FAX: 0118 931 0035	FAX: 0118 986 9124	FAX: 0118 933 6942	0118 933 6942

**For ROI (Republic of Ireland)**, please contact one of the numbers below:

TEL: 01 - 6266798	FAX: 01 - 6266634
-------------------	-------------------

Thanks you for buying Baumatic.

\* Applies to UK, Scotland, Wales & Northern Ireland only (Republic of Ireland has 1 year labour & 1 year parts warranty only)



*You will be mine ...*

**Headquarters**

Baumatic Ltd.  
Baumatic Buildings,  
6 Bennet Road,  
Reading,  
Berkshire  
RG2 0QX, United Kingdom

Sales Telephone  
+44 118 933 6900

Sales Fax  
+44 118 931 0035

Service Telephone  
+44 118 933 6911

Service Fax  
+44 118 986 9124

Spares Telephone  
+44 118 933 6922

Technical / Advice Telephone  
+44 118 933 6933

**E-mail:**

[sales@baumatic.co.uk](mailto:sales@baumatic.co.uk)

[technical@baumatic.co.uk](mailto:technical@baumatic.co.uk)

Http (Internet site):  
[www.baumatic.com](http://www.baumatic.com)

