

MEGACHEF3M
60 cm Extra large
capacity multifunction
oven

Instruction manual

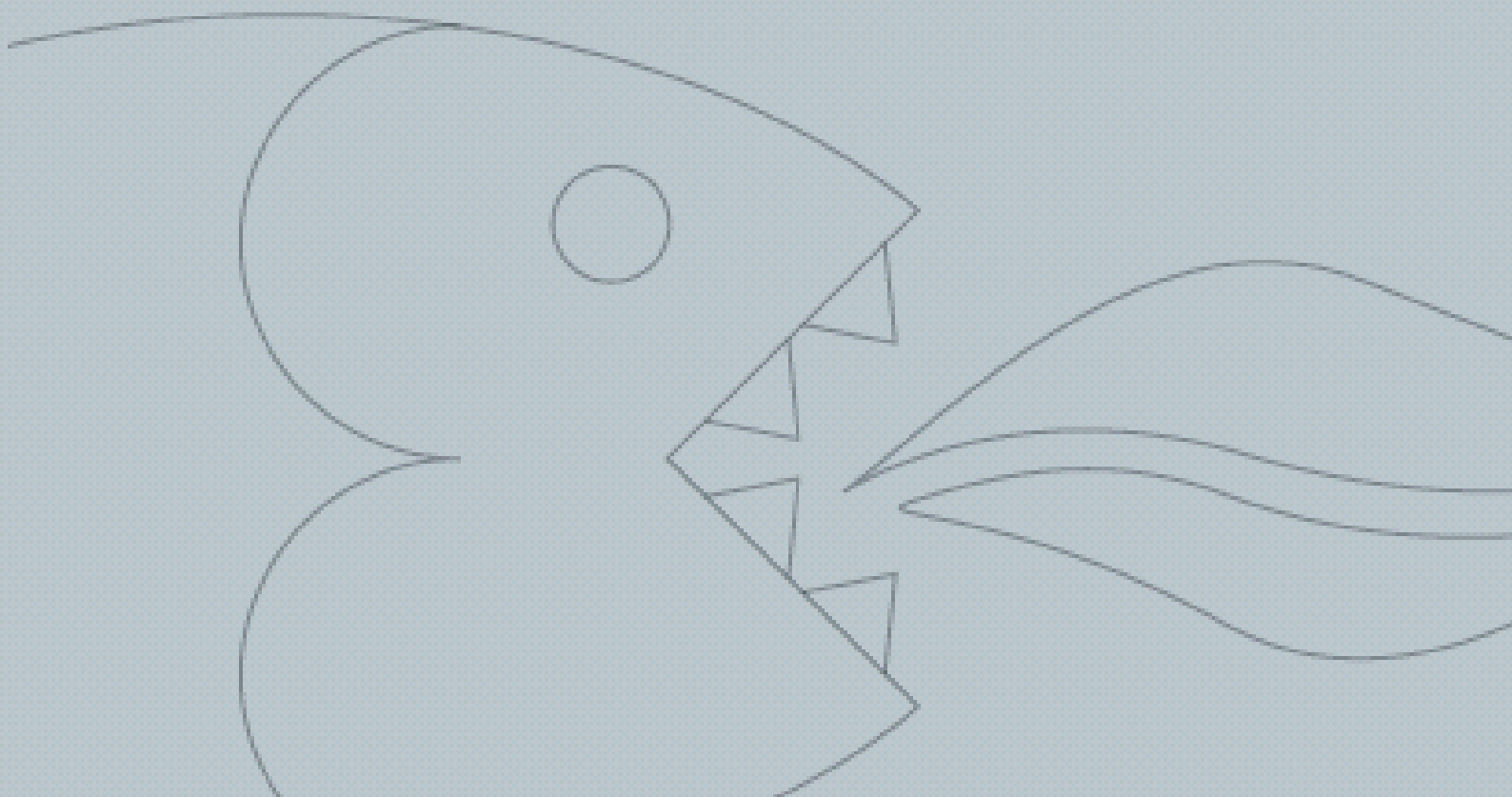

BUILT IN OVEN MEGACHEF 3



Baumatic®

1. TECHNICAL DATA

MODELS	MEGACHEF 3
Voltage	230V
Current	16 A
Sole heating element	1000 W
upper heating element	1000 W
Circular heating element	2300 W
Traditional grill	2100
Maximum power	3400 W
Dimensions	596 x 596 x600

2. PRELIMINARY REMARKS

Please read this booklet thoroughly before you install and use this appliance. It is important that you understand all the control functions before commencing to cook with this oven.

Warnings

- This oven is intended to be used only for baking purposes, therefore improper uses are not admitted.
- This oven must be used only by adult persons in good physical conditions. Please ensure that children are kept under close supervision at all times.
- Avoid the contact with inner surfaces and the door of the oven, as they can reach high temperatures during baking and remain hot also after appliance had been turned off.
- Cleaning operations must be carried out only when the equipment get cold.
- Use always the suited handle for opening the door of the oven.
- The appliance must be disconnected from the mains before executing cleaning operations.
- In the event of malfunctions of the oven and if no explanations are found in the present manual, please turn off the appliance and call the technical service.
- Repairs may only be carried out by authorized specialist.
- Packaging materials used are environmentally friendly and can be recycled. Please discard of all packaging material with due regard for the environment.
- Monthly execute cleaning and maintenance operations.
- Keep this instruction manual save for persons not trained to oven use.

3. DECLARATION OF CONFORMITY

In the parts destined to come into contact with foodstuffs, this appliance is in accordance with the requirements of the EC directive 89/109 transposed in the Italian Legislative Decree N° 108 of 25/01/92.

CE Appliance conforming to the European directives 89/336/EEC, 93/68/EEC, 73/23/EEC and subsequent revisions.

The manufacturer declares that the oven is built using certified materials and requires to install this appliance according to the standards in force. This appliance must be used by trained person only for household purpose.

4. INSTALLATION

The installation must be carried out by qualified personnel according to:

- Safety standards in force.
- Local electricity supply company advises.

Electric connections

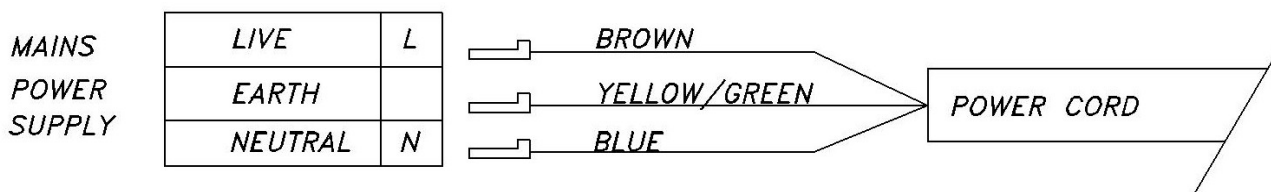

- Check the details given on the rating plate situated on the oven making sure that the rated mains voltage and power available are suitable for its operation.
- Before making the electric connections, check the efficiency of the earthing system. Earthing of the oven is compulsory by law. The manufacturer will accept no liability for any personal injury or damage to property deriving from failure to comply with this requirement.
- If you prefer to make a fixed connection to the mains, insert an all-pole circuit breaker with a breaking gap of at least 3 mm between the cook top and the mains.
- To connect the oven power cord, loosen and remove the cover on the terminal block in order to access the contacts inside. Make the connection, blocking the cord in place with the cable clamp provided and then close the terminal block cover again immediately.
- If you have to change the cord, the earthing (yellow / green) conductor must always be 10 mm longer than the line conductors.
- If damaged, the cable must be replaced with one supplied by the technical assistance service.

Fixing the oven to the unit

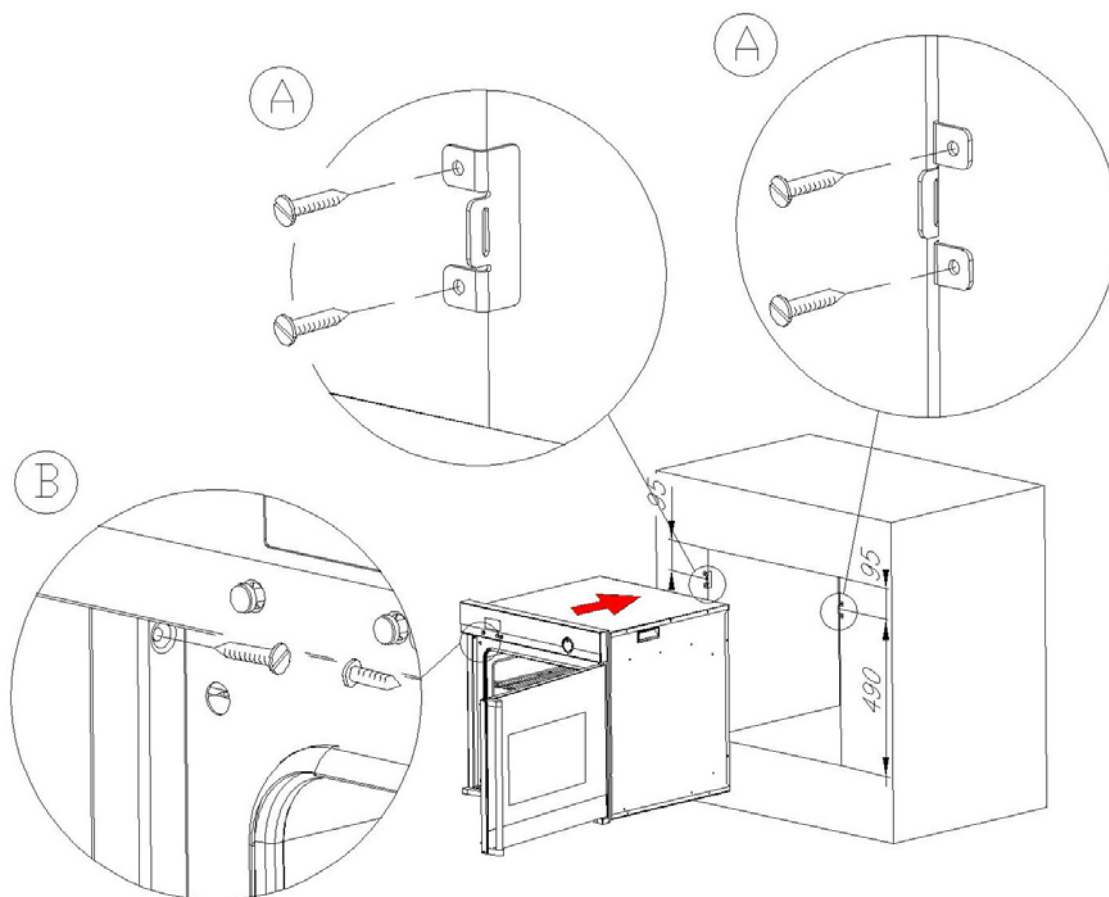

- Mark on the piece of furniture the measure for the positioning of the blocking supports.
- Fix to the piece of furniture the blocking supports.
- Place the oven on the piece of kitchen furniture so to be installed.
- The holes of the blocking screws are: top right and top left the frontal frame of the oven.
- Fix the oven with the screws.

5. DESCRIPTION OF BUTTONS

Command button

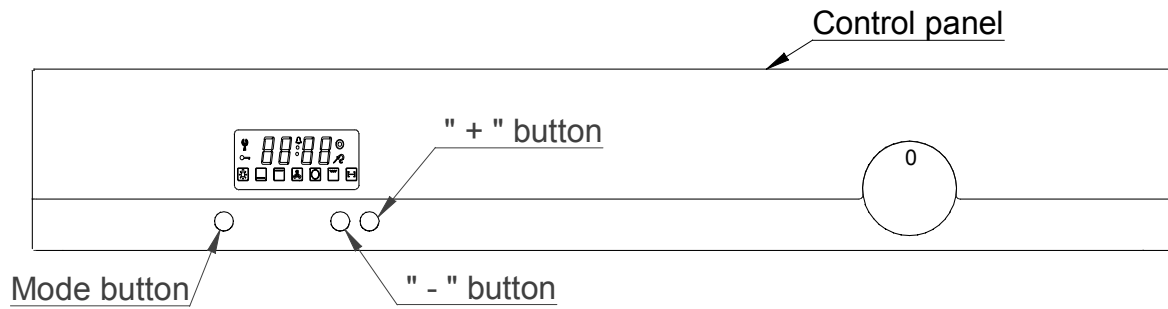

Mode button : this button takes you through the input menu

Repeated activation of this button causes the possible operating functions of the timer to appear in the display one after the other. Each stage allows inputs which will improve cooking performance. Any menu stage called up without any further input or significant display will disappear again after 4 seconds.

Repeated pressing of mode button:

- Minute minder;
- duration ;
- end ;
- child lock ;
- time ;
- Language .

Keeping Mode button pressed (10 seconds):
Minute minder (temporarily).

„-“ button e „+“ button .





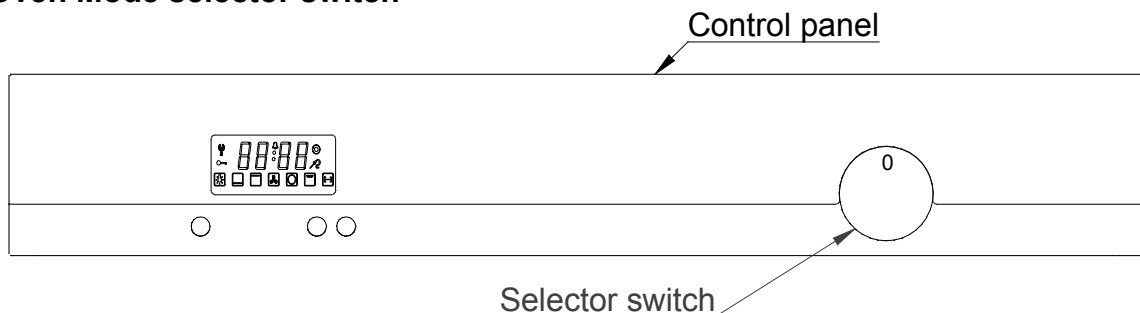

By pressing these button is possible to set temperature value or cooking time.

All inputs valid after 4 seconds.

Oven Mode selector switch



The oven cooking mode are activated by the selector knob. When turned off, the knob lays on the same plane of the control panel. Through the pressure the knob gets outer. Turning the knob round you choose one cooking mode between the thirteen provided. (see the following table).

								
-	0							
Oven light	1	•						
Cooking	2	•	•	•				
Hot air	3	•	•	•	•			
Grill motor	4	•					•	•
Grill	5	•					•	
Fan grill	6	•			•		•	
Super grill	7	•		•			•	
Fan	8	•			•	•		
Pizza level	9	•	•		•	•		
Browning	10	•		•				
Slow simmer	1 1	•	•					
Defrost level	1 2	•			•			
Poultry grill	1 3	•		•			•	•

Display

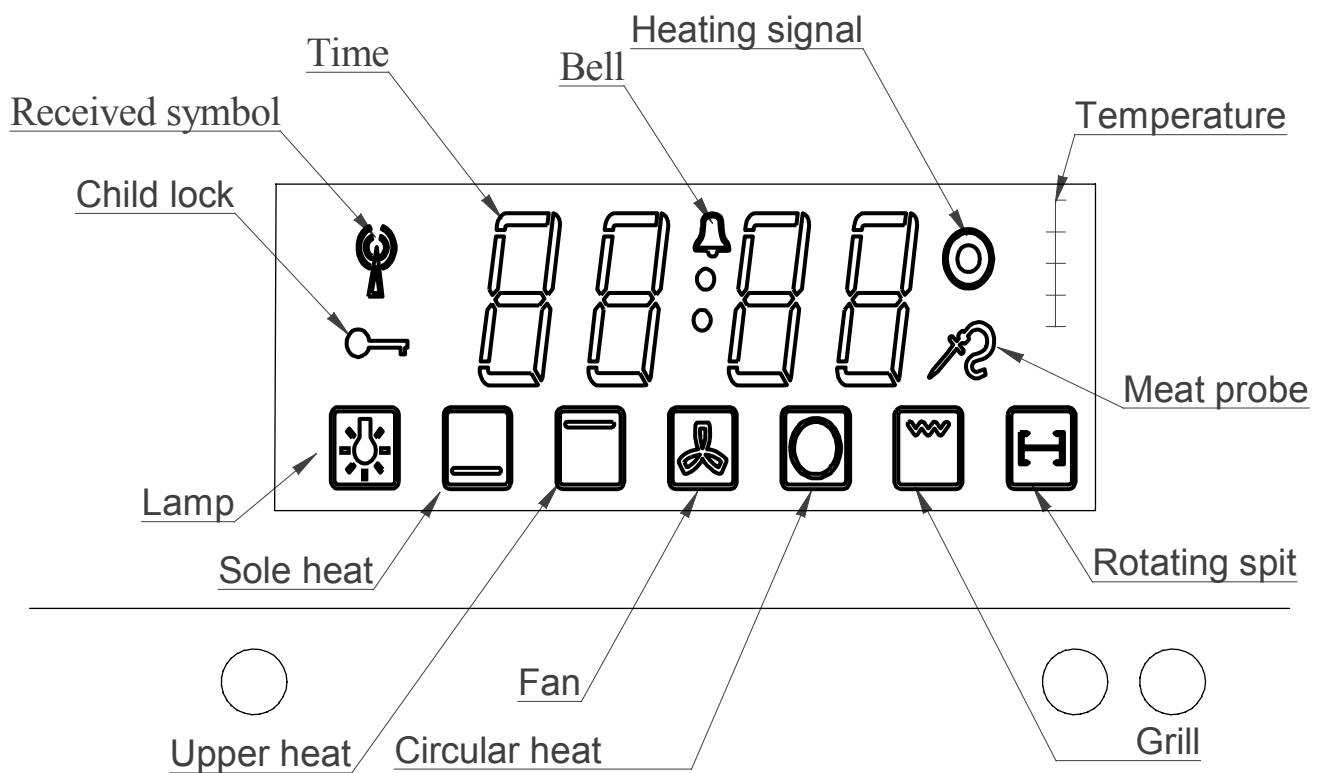

When you choose one cooking mode, the symbols in the bottom row illustrate the basic functions or heating methods activated.

The bell symbol shows that minute minder has been activated. The alarm gives an acoustic signal at the end of each automatic function. Pressing the “-” or “+” button turns the alarm off – otherwise it will continue to sound for about 120s.

On the upper right side of the display the current temperature is shown by a scale of four bars, corresponding to the 25 – 50 75 100 % of the preset temperature.

The heating symbol activates when one cooking mode is turned on and disappears as the set temperature is reached.

6. TIME AND ALARM SET

After the first connection of the oven to the mains supply, the display shows the preset language. You can change the language by pressing the “-“ o “+“ button.

This may be confirmed using the mode button or is accepted automatically after 10 seconds.

After that the numbers on the display flash meaning that time is not set. In the lower side appears one advising message.

Pressing the “-“ o “+“ button You can set the time in order to use the cooking mode.

Language and time can also be changed at any time in line with the Menu.

7. MODE SETTINGS

Turning on the oven

To select an oven operating mode the selector knob should be turned to the desired position. Immediately the heating modes currently active or the basic functions, along with a typical function description detailing the operating mode, will light up in the display.

4 seconds after selection of the operating mode the suggested temperature recommended by the manufacturer.

It is possible change the temperature set in any time by pressing " - " or " + " buttons.

Turning off the oven

To stop the program that is currently running the selector knob should be returned to its starting position. 0.

Note! A safety cut out comes into operation automatically after 6 hours if no operation are selected

Residual heat

When the selector knob is turned to 0 position, the display will show the inner temperature of the oven and mind the residual heat to the user. This message will disappear as the oven get cold.

Setting cooking time

Minute minder / alarm clock

This function is available att all times, independent of the mode set, and can therefore be activated in any operating mode, including when the oven is switched off.

You can set the function by repeatedly pressing of mode button. The minute minder time can be selected within the range of 0.00 to 90.00 (min/sec). When a time is the bell symbol appears in the display. Time starts to run down immediately after programming.

If you have set a minute minder alarm, it can be deleted by accessing the minute minder function and pressing the “-“ button as many times as necessary until 0.00 appears, or, simpler, by pressing the button “+” and “-“ at the same time.

An alarm will sound when the minute minder time has elapsed – this can be stopped by pressing one of the two “-“ and “+” selector buttons.

Duration (hrs/min)

Once selected the operating mode by the selector knob, it is possible to set the duration of cooking.

Keep pressing the mode button until the program **DURATION** appears in the display. Select the desired duration using the " - " e " + " buttons (setting range: 0.00 to 23.59 hrs./min.).

If you have set an operation period (duration), it can be deleted by accessing duration function and pressing the “-“ button as many times as necessary until 0.00 appears, or, simpler, by pressing the button “+” and “-“ at the same time.

When the time has run down an alarm will be heard – this can be stopped by pressing one of the two “-“ and “+” buttons. The display will ask if continue to cook or switch off. To end the program turn the selector knob to the OFF position.

To carry on cooking at the previous temperature press the “+” button. Cooking will now continue but without any limit set. Obviously a new duration can now be set if desired.

End of operating period

Once selected the operating mode by the selector knob, it is possible to set the end of operating period of cooking.

Keep pressing the mode button until the program **END** appears in the display. Select the desired finishing time using the “-“ “e” “+” buttons (setting range: 0.00 to 23.59 hrs./min.). The clock will calculate the running time and show it in the display.

When the time has run down an alarm will be heard – this can be stopped by pressing one of the two “-“ and “+” buttons. The display will ask if continue to cook or switch off. To end the program turn the selector knob to the OFF position.

To carry on cooking at the previous temperature press the “+” button. Cooking will now continue but without any limit set. Obviously a new duration can now be set if desired.

Preselected operation

Once selected the operating mode by the selector knob, it is possible to set the end of operating period of cooking.

Keep pressing the mode button until the program **DURATION** appears in the display. Select the desired duration using the “-“ “e” “+” buttons (setting range: 0.00 to 23.59 hrs./min.). The clock will calculate the running time (duration) and show it in the display. Again using the mode button select the **END** program and set the desired end time using the “-“ “e” “+” buttons .

The display will show the calculated time. After start up you can read the remaining cooking time in the display.

When the time has run down an alarm will be heard – this can be stopped by pressing one of the two “-“ and “+” buttons. The display will ask if continue to cook or switch off. To end the program turn the selector knob to the OFF position.

To carry on cooking at the previous temperature press the “+” button. Cooking will now continue but without any limit set. Obviously a new duration can now be set if desired.

8. MEAT PROBE

When the meat probe is inserted the appropriate symbols lights up in the display. This indicates that the oven controller has recognized the probe.

Select the desired cooking mode with the knob. The display shows the preset cooking temperature of 60°C. It is now possible, if you wish, to change the suggested probe temperature using the “-“ and “+” buttons. The cooking temperature now can be set.

When the temperature is reached an alarm will sound. Here too is it possible to extend the cooking time. However to continue cooking the temperature must be entered.

9. CHILD PROOF LOCK

If the selector knob is in the 0/OFF position a child lock can be activated which will bar all buttons and prevent the oven from being turned on. If the selector knob is moved the electricity supply remains cut off. Only the “minute minder” function can be operated when the child lock is active. (no switching function).

To set, press the mode selector button repeatedly until “**BLOCK**” appears in the display. You can now switch the child lock feature on or off with the “+” or “-“ buttons. When the lock is active the display will show the key symbol.

If the mode selector knob is set for oven operation the child lock cannot be turned on.

10. FAULT ANALYSIS

- If the probe is not working the display will show “ **PROBE FAULT**”

Other automatic fault displays are:

- **01 Service** = Short circuit PT sensor
- **02 Service** = Probe break PT sensor
- **11 Service** = EEPROM - fault

11. CORRECTING A PROGRAM SETTING

The oven temperature can be altered at any time using the “-” and “+” buttons.

Modes can be changed at any time with the mode knob. If this is done the duration and end times are retained and will only be deleted when the OFF mode is selected. Any minute minder value entered will be retained when the oven is turned off.

The time of day **cannot** be entered or altered while there is a program running.

If the meat probe is removed during a program operation the current temperature program will stop.

12. CLEANING AND MAINTENANCE

Thoroughly clean the oven before operating it for the first time and after every use, thus avoiding baking in of residues. After residues have baked in several times, they are then difficult to remove.

Cleaning operations must be carried out only when the equipment get cold.

Outer parts of the oven should only be cleaned with warm soapy water using either a sponge or soft cloth. No abrasive cleaners should be used.

Cleaning the upper part of the oven

The upper part can be cleaned by loosening the screw of the clamp which fixes the heating element to the top of the oven. Rotate down the element and clean the top of the oven. Then replace the heating element on his correct position and fix again the clamp with the screw.

Replacing the lamp

The oven must always be disconnected from the mains when you're going to replace a oven part. With a tool remove the lamp cover and replace the lamp. At the end of this operation place the cover again on its center.

13. ACCESSORIES

The oven is equipped with both an iron pan grill and a glass one in order to realize a cooking on different levels.

14. TECHNICAL SERVICE

The appliance must always be disconnected from the mains when being repaired.

If you cannot find any reason for the malfunction:

turn off the appliance and do not manhandle it. Call in the technical support service.

The appliance comes with a guarantee certificate that entitles you to use the technical support service.

The guarantee must be duly completed, kept in a safe place, and exhibited to the authorized technician in case of need, together with the fiscally valid document issued by the retailer at the time of purchase (delivery bill, invoice, cash register receipt, etc.) indicating the name of the retailer, the date of delivery, details for identifying the product and the purchase price.

REVERSING SIDE DOOR OF THE MEGACHEF

TECHNICAL SERVICE INSTRUCTIONS

NOTE: This operation must be only carried out by suitably qualified personnel. We do not recommend that the customer completes the door reversal process.

2. Preliminary remarks

This section explains how to reverse the hinge of the door for a side opening oven and applies to the following models:

- MEGACHEF1SS
- MEGACHEF2SS
- MEGACHEF3M

3. Warnings

- Please read this information thoroughly before commencing the door reversal procedure.
- The following procedure must be only carried out by a suitably qualified person.
- **YOU MUST** disconnect the oven from the mains supply before attempting the door reversal procedure.
- Once it has been completed, you should ensure that the oven is re-assembled correctly and check the electrical connections.

4. Operating instructions

Installation and repairs must only be completed by an experienced engineer.

Attention: In order to reverse the door it is necessary to remove the covers of the oven. If the appliance is already installed, loosen the screws which fix the oven to the cabinet and carefully remove the oven from the housing unit.

A-Loosen the screws and remove the upper cover of the oven

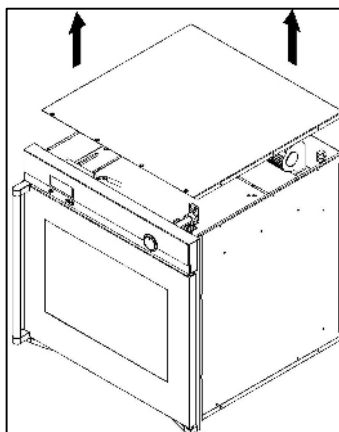

B- Loosen the screws that fix the command panel. They can be found in the following positions: -

- On the side SS profiles of the oven
- On the basement of the control panel (the part with the slits for the air cooling)

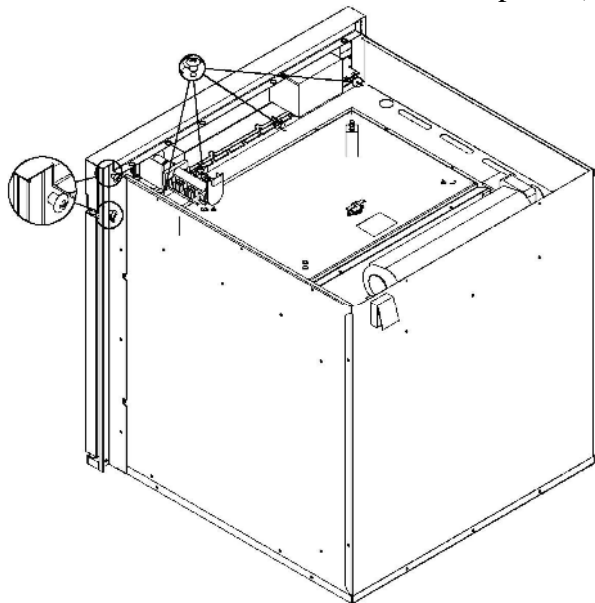

C- Rotate the control panel as shown. **IMPORTANT: One hinge is not present so YOU MUST support the door with one hand whilst completing this section of the procedure.**

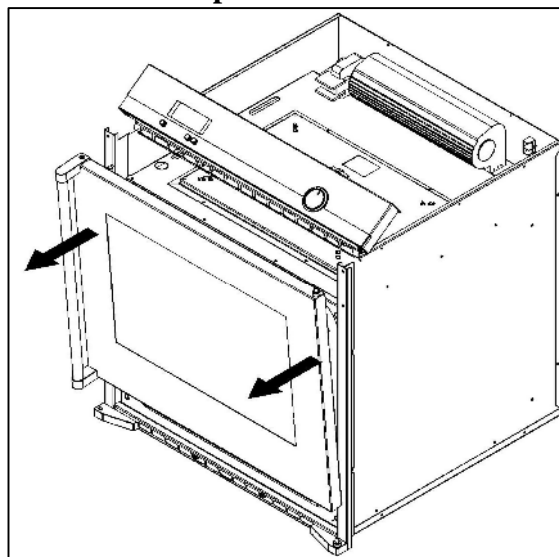
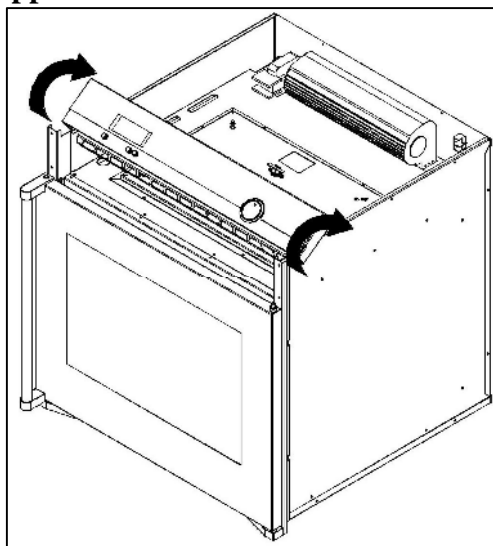

Extract the door and lean it in a safe place.

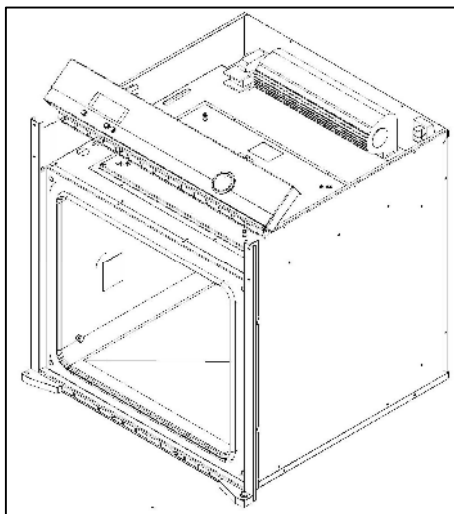

Note: if the serial number of the model is LATER than 0626000 the operation described at step D-E-F are not required as the oven is already assembled with the locking assemblies on each side

D- Loosen the screws of the rear cover. Before removing it, you should disconnect the wiring to the switch box

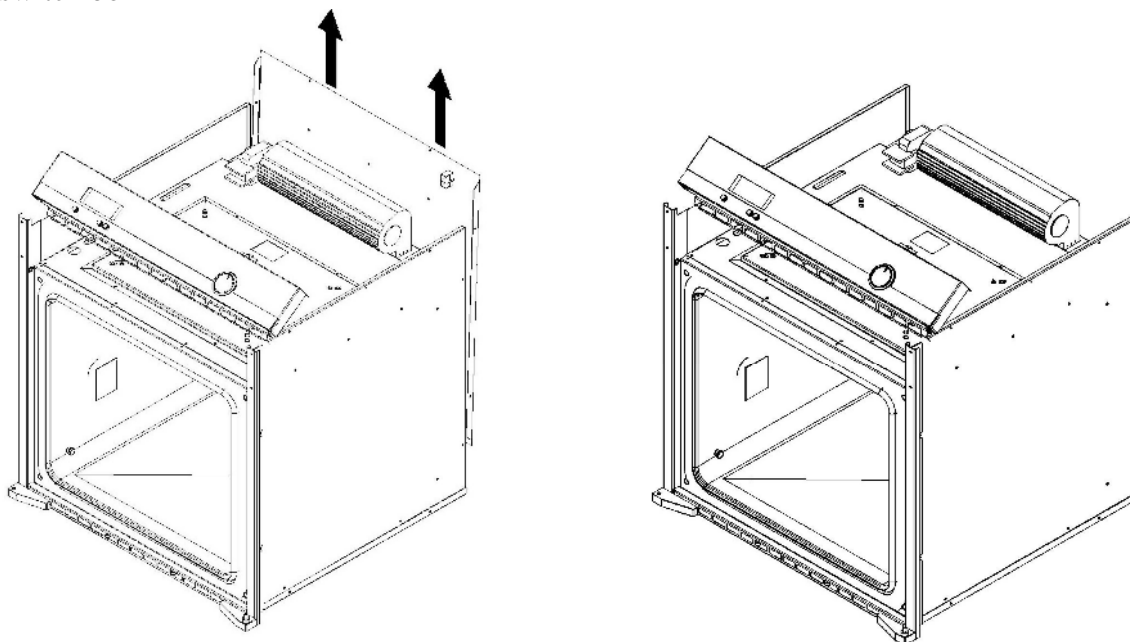

E- Following the pictures below, loosen the screws and remove the side covers. **IMPORTANT:** you should only loosen the screws indicated in the diagram below.

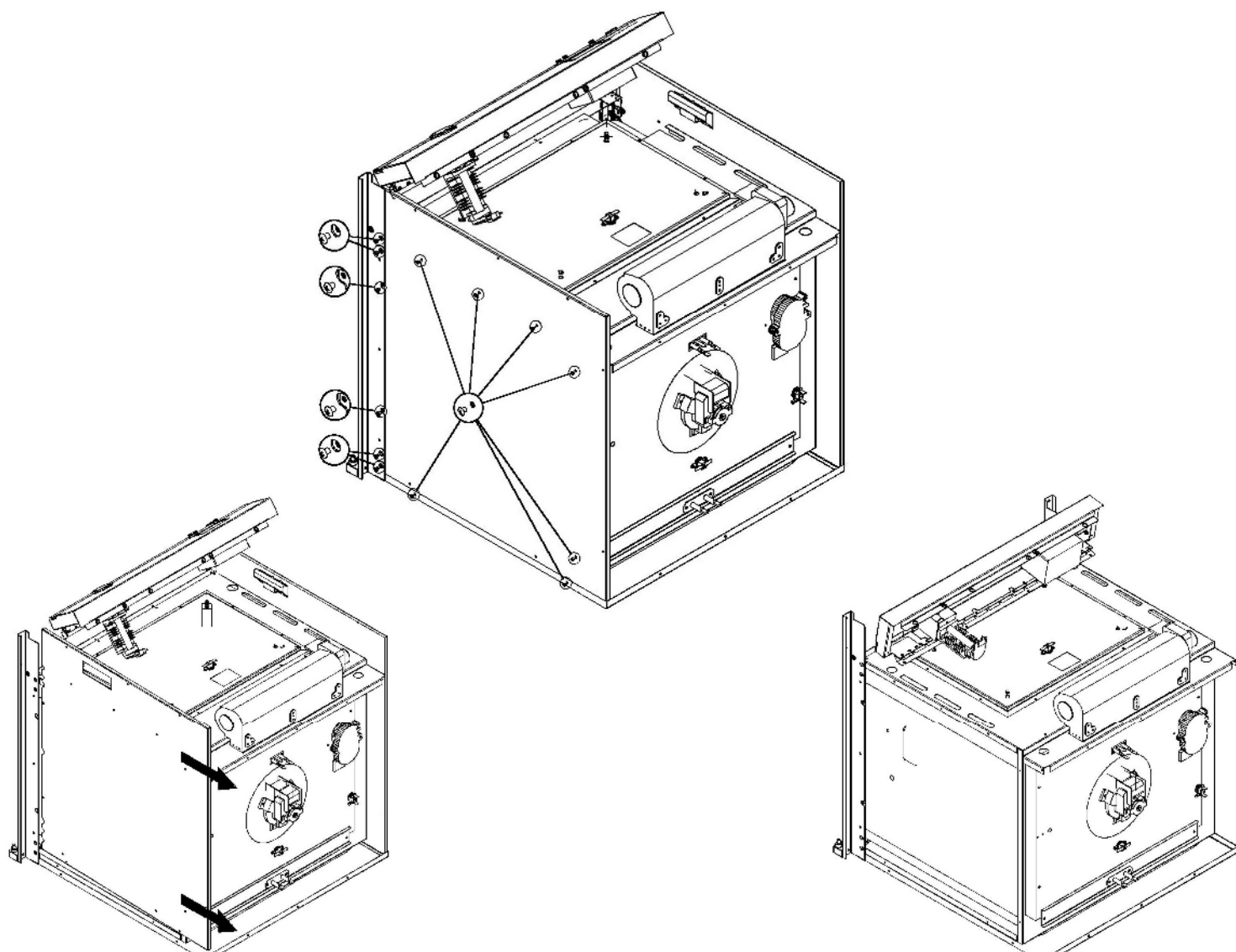

It is necessary to carry out the operations described in the exact order given below, to allow access to the rear part of the door frame.

The door has two pivots which go to the locking assemblies. They are placed behind the door frame. On the opposite side of the frame there are two plates which cover the holes.

F- Loosen the screws which fix the locking assemblies and the cover plates to the stainless steel sides and reverse the position of all of these parts.

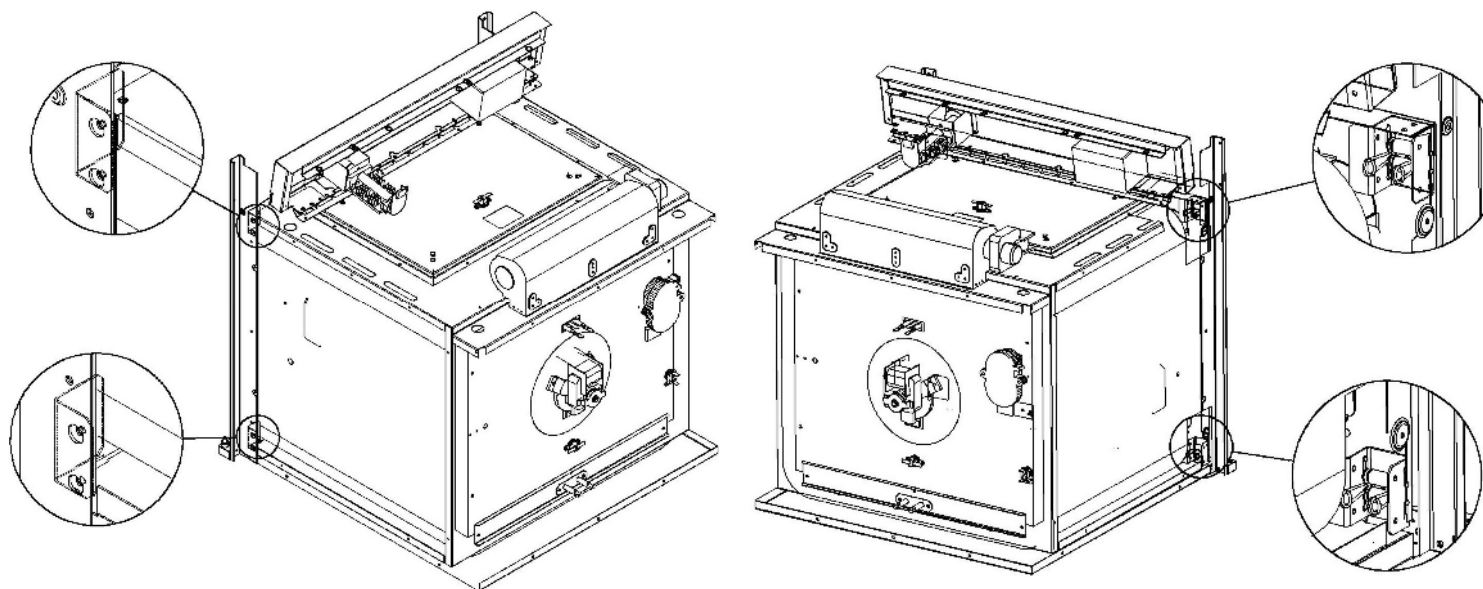

IMPORTANT: Do not damage the oven insulating material when completing this section of the door reversal process.

G- Reverse the positions of the pivot and the cylindrical insert on the lower holders

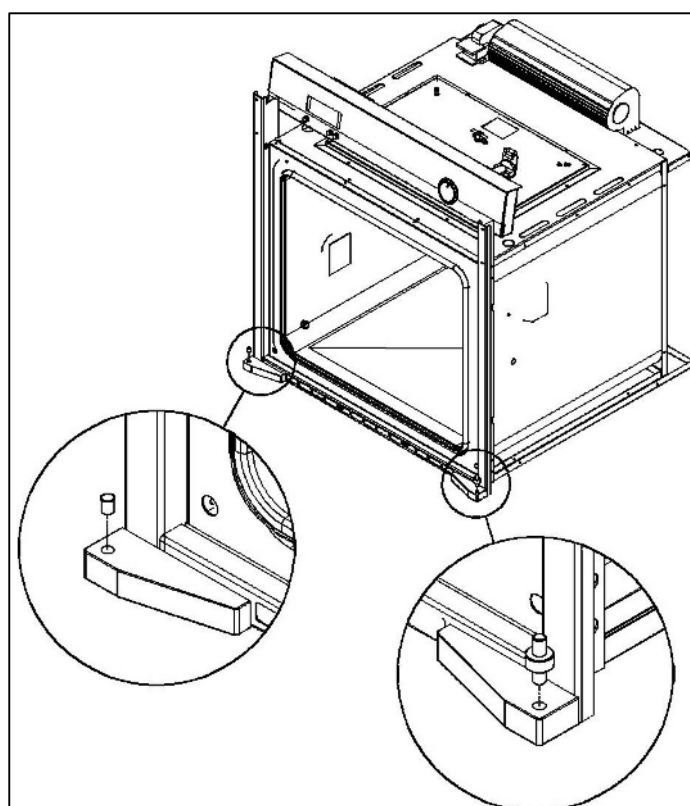

H- On the oven door, unscrew the handle and reverse its position. You should do the same with the locking pivots as well.

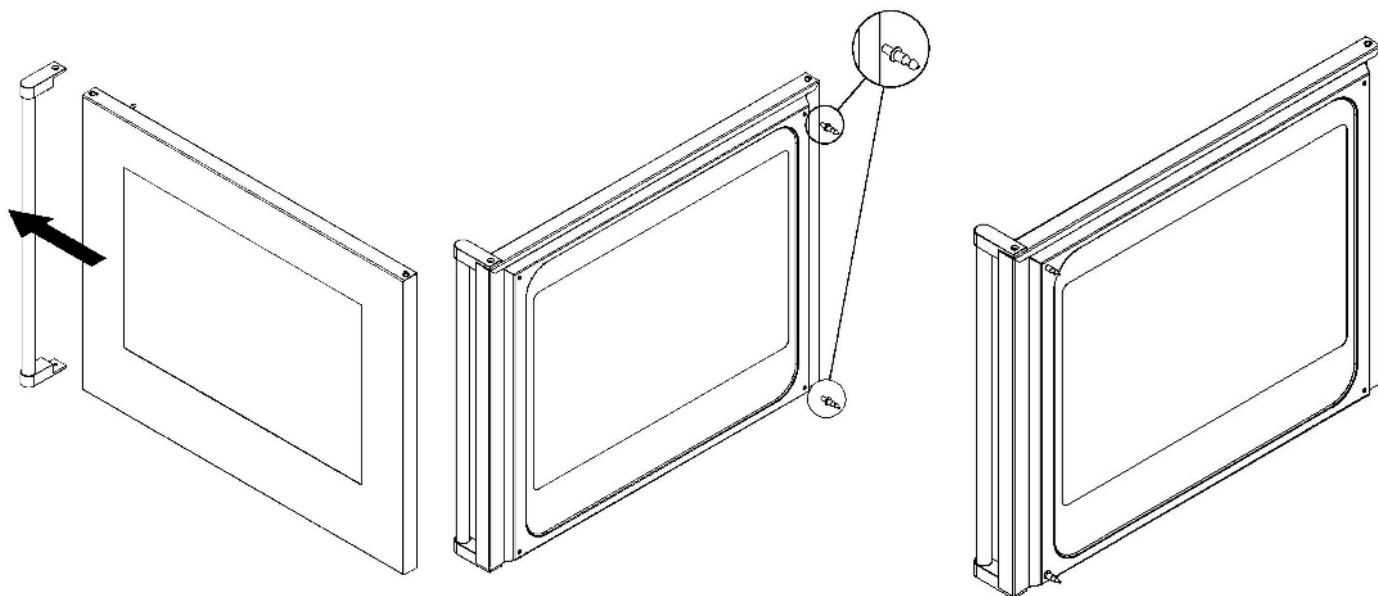

Once all of these steps have been completed, you should re-assemble all of the components.

It is particularly important to ensure that no wiring has been damaged during the door reversal operation.

Ensure that all of the electrical components and the LED programmer work properly before re-assembling the covers of the oven.

Baumatic Ltd. Conditions of guarantee

Dear Customer,

Your new Baumatic appliance comes complete with a free 12 month guarantee covering both parts and labour costs resulting from defective materials or workmanship.

Baumatic also gives you the opportunity to automatically extend the guarantee period for a further 12 months at no extra cost, giving an initial guarantee period of 24 months. The extended guarantee period applies to England, Scotland, Wales and Northern Ireland only.

To qualify for your full 24 months guarantee you **must** register your appliance within 28 days of purchase to be covered under this guarantee. This can be done online via: www.baumatic.co.uk or through returning the guarantee card which can be found in each new Baumatic appliance.

* In addition, your appliance is covered by a 5 year parts warranty. Baumatic Ltd will provide free of charge the parts required to repair the appliance, only if they are fitted by a Baumatic engineer, for any defect that arises due to faulty materials or workmanship within a period of 5 years from the original purchase date.

* An additional 1 to 3 year insurance scheme for labour is available should you wish to extend the warranty period.

Should any person other than an authorised representative of Baumatic Ltd interfere with the appliance, the policy is negated and Baumatic Ltd will be under no further liability.

The guarantee covers the appliance for normal domestic use only, unless otherwise stated.

Any claims made under the terms of the guarantee must be supported by the original invoice/bill of sale issued at the time of purchase.

This guarantee is transferable only with the written consent of Baumatic Ltd.

If the appliance fails and is considered either not repairable or uneconomical to repair between 12 months (2 years if registered) and five years, a free of charge replacement will not be offered.

The guarantee for any replacement will only be for the remainder of the guarantee on the original product purchased.

The guarantee does not cover:

- Sinks and taps
- Failure to comply with the manufacturers instructions for use.
- The replacement of cosmetic components of accessories
- Accidental damage or wilful abuse.
- Subsequent loss or damage owing to the failure of the appliance or electrical supply
- Incorrect installation
- Losses caused by Acts of God, civil war, failure to obtain spare parts, strikes or lockouts
- Filters, fuses, light bulbs, external hoses, damage to bodywork, paintwork, plastic items, covers, baskets, trays, shelves, burner bases, burner caps, decals, corrosion, rubber seals.

In the course of the work carried out it may be necessary to remove the appliance from its operating position. Whilst all reasonable care will be taken, Baumatic Ltd cannot accept responsibility for damage sustained to any property whatsoever in this process.

This guarantee is in addition to and does not diminish your statutory or legal rights.

Contacting Baumatic Ltd

Sales	Service	Spares	Technical/Advice
TEL: 0118 933 6900	TEL: 0118 933 6911	TEL: 0118 933 6922	0118 933 6933
FAX: 0118 931 0035	FAX: 0118 986 9124	FAX: 0118 933 6942	0118 933 6942

For ROI (Republic of Ireland), please contact one of the numbers below:

TEL: 01 - 6266798	FAX: 01 - 6266634
-------------------	-------------------

Thanks you for buying Baumatic.

* Applies to UK, Scotland, Wales & Northern Ireland only (Republic of Ireland has 1 year labour & 1 year parts warranty only)



www.baumatic.com