

**B25SE**  
**Side by side frost free**  
**fridge freezer**

**INSTRUCTION MANUAL**

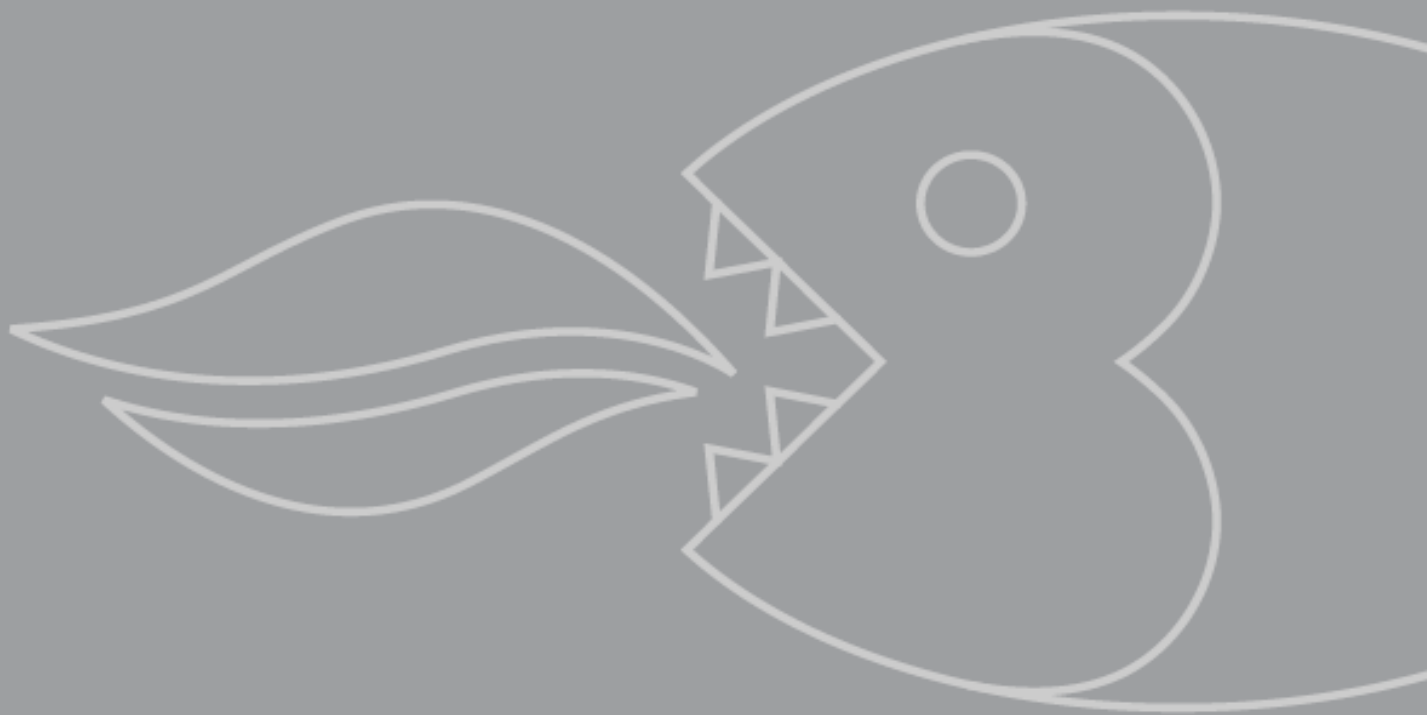

# USER MANUAL FOR YOUR BAUMATIC

## B25SE

545 Litre side by side  
frost free fridge freezer



***NOTE: This User Instruction Manual contains important information, including safety & installation points, which will enable you to get the most out of your appliance. Please keep it in a safe place so that it is easily available for future reference, for you or any person not familiar with the operation of the appliance.***

JW 06/07/12

# Contents

<b>Environmental note</b>	4
<b>Important safety information</b>	5-6
<b>Specifications of your fridge freezer</b>	7-10
Description of the appliance	8
Fridge section (including door)	8
Freezer section (including door)	8
<b>Using your Baumatic fridge freezer</b>	12-17
Before switching on	11
During first use	11
Control panel	12
Switching on the appliance	12
Setting the temperature manually (freezer section)	12
Setting the temperature manually (fridge section)	13
Switching on fast freeze mode	13
Switching on rapid cooling mode	14
Switching on holiday mode	14
Switching on energy saving mode	15
Returning the appliance to normal operation	15
Switching on the control panel lock	15
<b>Using the ice/water dispenser</b>	<b>16-19</b>
<b>Arranging and storing food in the fridge section</b>	20
<b>The **** freezer section</b>	21
Freezing fresh food	22
Tips on freezing	23
Storing commercially frozen food	24
Defrosting frozen food	24
Normal operating noises	24
Important user information	24
<b>Saving energy when using your fridge-freezer</b>	<b>24-25</b>
<b>Cleaning and maintenance</b>	26-29
General cleaning	26-28
The defrost drain hole	28
Defrosting the  freezer section	29
Replacing the light bulb	29
<b>Installation</b>	30-36
Electrical connection	30
Positioning	31
Installation preparation	32
Removing the fridge and freezer doors	33-34
Installing the decorative plinth	35
Connecting the water inlet hose	36
<b>Troubleshooting</b>	37-39
<b>Baumatic consumables</b>	40
<b>Technical data</b>	41
<b>Contact details</b>	42

## Environmental note

**Note:** Before discarding an old appliance, switch off and disconnect it from the power supply. Cut off and render any plug useless. Cut the cable off directly behind the appliance to prevent misuse. This should be undertaken by a competent person. Disable the door lock to make sure that children cannot get stuck inside the appliance.

This appliance is marked according to the European directive 2002/96/EC on Waste electrical and Electronic Equipment (WEEE). By ensuring this product is disposed of correctly, you will help prevent potential negative consequences for the environment and human health, which could otherwise be caused by inappropriate waste handling of this product.

The symbol  on the product, or on the documents accompanying the product, indicates that this appliance may not be treated as household waste. Instead it shall be handed over to the applicable collection point for the recycling of electrical and electronic equipment.

Disposal must be carried out in accordance with local environmental regulations for waste disposal.

For more detailed information about treatment, recovery and recycling of this product, please contact your local city office, your household waste disposal service or the shop where you purchased the product.



- The packaging materials that Baumatic uses are environmentally friendly and can be recycled.
- Please discard all packaging material with due regard for the environment.

## Important safety information



Your safety is of the utmost importance to Baumatic. Please make sure that you read this instruction booklet **before** attempting to install or use the appliance. If you are unsure of any of the information contained in this booklet, please contact the Baumatic Advice Line.

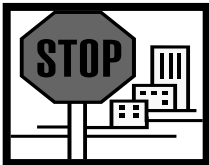

**IMPORTANT: Any installation work must be carried out by a qualified electrician or competent person.**

### Use of the appliance

- Your appliance is only designed to be used in the home. It is suitable for storing food that needs to be chilled and refrigerated. If it is used for any other purpose or it is not used correctly, then Baumatic Ltd. will accept no liability for any damage that is caused.
- Altering the specification of the appliance must not be attempted for reasons of safety.



### Before using your appliance

- Check the appliance for any signs of transport damage. If you notice any damage, then you should not connect your appliance to your mains supply and should contact your retailer.

### Refrigerant

- Your appliance contains R600a refrigerant, which is a natural gas that does not contain CFCs that can damage the environment. However it is a flammable substance, therefore care should be taken:
  - During the transportation and installation of the appliance, make sure that the refrigeration pipe-work does not get damaged.
  - If it does become damaged then sources of ignition and open flames should be avoided. Also the room that the appliance is situated in should be thoroughly ventilated.

- Do not place any objects on top of the appliance, as this may damage the table top.



## Child safety

- Packaging material should be kept away from children.
- Children should not be allowed to touch the controls or play with the appliance.



## General safety

- Do not pull on the power supply cable to remove the plug from your mains supply socket.
- Do not pull out or insert the plug with wet hands.
- Do not attempt to use your appliance outdoors or any place where it is likely to come into contact with the elements.

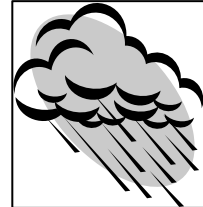

- Before cleaning the appliance or performing maintenance work, ensure that the appliance has been disconnected from your mains supply.
- Never allow the back coils of the appliance to come into contact with the wall surface.
- Always ensure that the location where you are installing your appliance is free of stored items such as papers and other flammable materials.
- Never block the ventilation openings of the appliance, either on the inside or its exterior.

- It is vital to keep your appliance well ventilated, so that there is proper air flow between the bottom of the unit and the plinth/kick plate which it is sitting on.



- Do not place electrical devices inside of the appliance, such as mixers or ice cream makers.
- Do not store aerosol cans with a flammable propellant in this appliance.

## Service

You should not attempt to repair the appliance yourself, as this could cause injury or a more serious malfunction. If you require a service call then please contact the Baumatic Customer Care Department.

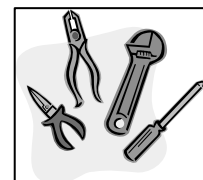

# Specifications of your fridge freezer

## Dimensions of your appliance

- Height: 1760 mm
- Width: 902 mm
- Depth: 750 mm (Including doors and handles)

## Energy efficiency class

- Energy class: A+

## Cubic capacities

- Total gross/net capacity: 545/515 litres
- Gross capacity (fridge/freezer): 347/198 litres
- Net capacity (fridge/freezer): 340/175 litres

## Specifications of the appliance

- Frost free fridge and freezer
- Star rating \*\*\*\* (freezer door racks \*\*)
- Multi airflow cooling system
- Electronic temperature control
- Digital control panel
- Adjustable thermostat
- Fast cooling switch
- Fast Freeze switch
- Fast freeze indicator light
- Door open warning indicator
- Temperature rise warning indicator
- Automatic motor-driven ice maker
- Water dispenser
- Adjustable feet
  
- 3 Adjustable fridge safety glass shelves
- 1 Salad crisper shelf (Safety glass)
- 4 Bottle racks
- 2 Salad crispers
- Butter and cheese compartment
- Egg rack
  
- 3 Freezer safety glass shelves
- 2 Transparent freezer drawers
- 4 Freezer door racks

**IMPORTANT:** When you install your appliance it is important to bear in mind its climatic rating.

In order to find out the climatic rating of your appliance, you should check the rating plate. The rating plate is located inside of the fridge section, on the left side. You will need to open the door of the fridge section and you may need to remove one of the middle safety glass shelves. The rating plate will indicate the ambient temperature range that your appliance will function correctly within.

## Description of the appliance

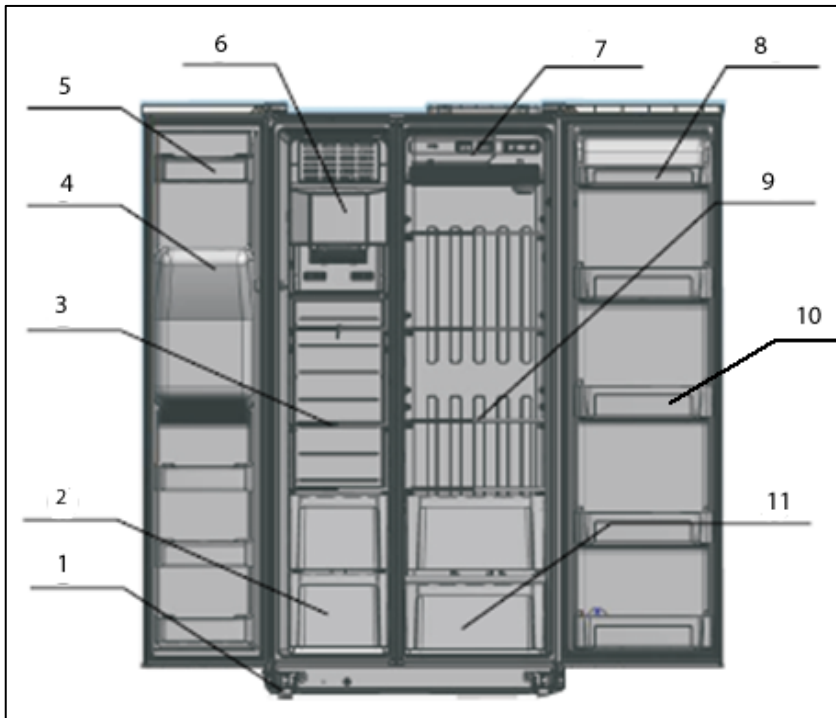

- |   |  |
|---|--|
| <b>1)</b> Bottom beam/decorative plinth | <b>7)</b> Fridge light                         |
| <b>2)</b> Freezer drawer (x2)           | <b>8)</b> Butter/cheese compartment            |
| <b>3)</b> Freezer shelf (x3)            | <b>9)</b> Adjustable safety glass shelves (x3) |
| <b>4)</b> Ice dispenser                 | <b>10)</b> Bottle racks (x 4)                  |
| <b>5)</b> Freezer door rack (x4)        | <b>11)</b> Salad crisper drawer (x2)           |
| <b>6)</b> Ice maker                     | <b>12)</b> Digital control panel               |
|   | <b>13)</b> Ice/water dispenser                 |



## Description of product features (fridge)

### Safety glass shelves

- The shelves may be placed in any of the guide slots within the interior of the appliance. They are protected from sliding out.

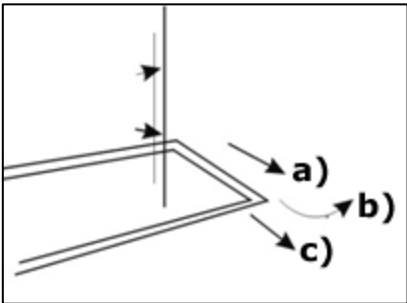

- To remove a shelf: Take off all of the items that are stored on the shelf that you want to remove. Pull the shelf forwards **(a)**, then lift the front of the shelf **(b)** towards 90° and carefully pull it out of the grooves **(c)**.

- The upper shelves should be used to store pasta, canned food, milk etc.
- The lower shelf should be used to store cooked meats and sausage etc.

### Salad crispers

- These drawers are suitable for storing fruits, salad and vegetables. They are designed to keep the contents fresh for as long as possible.
- Care should be taken when storing tropical fruit (bananas and pineapples etc) and tomatoes. As these types of items can easily deteriorate at a lower temperature.

### Butter and cheese compartment

- This rack should be used to store eggs, butter, cheese, yogurts etc.

### Bottle racks

- These racks should be used for storing reasonably sized bottles. These racks can also be used to store smaller cans, packages and tubes, etc.
- ***IMPORTANT: IT IS IMPORTANT THAT NONE OF THE SHELVES THAT SIT IN THE DOOR ARE OVERLOADED, AS THIS WILL DRASTICALLY REDUCE THEIR WORKING LIFE.***

## Description of the product features (freezer)

### Safety glass shelves

- The shelves may be placed in any of the guide slots within the interior of the appliance. They are protected from sliding out.

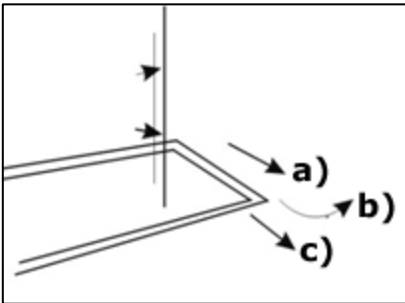

- To remove a shelf: Take off all of the items that are stored on the shelf that you want to remove. Pull the shelf forwards **(a)**, then lift the front of the shelf **(b)** towards 90° and carefully pull it out of the grooves **(c)**.

### Freezer door racks

- The door storage sections are rated as 2 star, they should be used for the short term storage of frozen items or ice cream.
- The freezer door racks should be used to store frozen food (they are not suitable for freezing fresh food).
- ***IMPORTANT: IT IS IMPORTANT THAT NONE OF THE SHELVES THAT SIT IN THE DOOR ARE OVERLOADED, AS THIS WILL DRASTICALLY REDUCE THEIR WORKING LIFE.***

### Freezer drawers

- These drawers are suitable for storing wrapped fish, meat and poultry.

## Using your Baumatic fridge freezer

### Before switching on

- Remove all packaging materials before using the fridge freezer. This includes the foam base and all adhesive tape holding the refrigerator accessories in place both inside and outside the appliance.
- Make sure that it has been installed by a suitably qualified person, as per the information contained in Baumatic's installation instructions.
- After delivery, wait for eight hours before connecting the appliance to your mains supply. This means that any refrigerant gasses that may have been disturbed during the transportation process are allowed to settle.
- The outside of the appliance and the removable accessories contained within it, should be cleaned with a solution of liquid detergent and water.
- The interior of the appliance should be cleaned with a solution of sodium bicarbonate dissolved in lukewarm water. The interior and accessories should be thoroughly dried, after the cleaning process has been completed.
- There can be an odour when you first switch on the appliance. It will lessen as the appliance starts to cool.

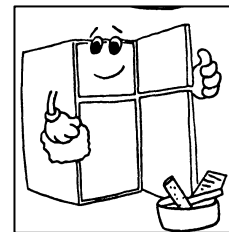

### During first use

- When you first switch on the appliance, the compressor may run continuously for approximately 24 hours or until the fridge freezer reaches a cool enough temperature.
- During this period of time, you should try not to open the door frequently or place a large amount of food within the appliance.
- If the unit is switched off or unplugged, you must allow at least 5 minutes before reconnecting it to your mains supply.
- If there is a power cut, the appliance will remember the temperature settings that were set previously.

## Control panel

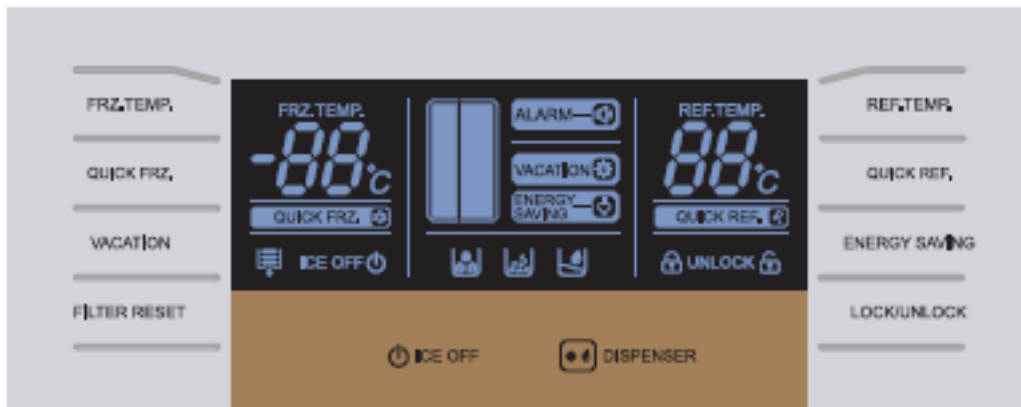

The control panel is located outside the refrigerator, above the ice dispenser. It is used to control the fridge and freezer.

### Switching on the appliance

- You switch on your appliance by connecting it to your mains supply.
- When first turned on the appliance will automatically set the fridge to 5°C, and the freezer to -18°C. You can set the temperature in the fridge and freezer sections manually at any time.
- **NOTE:** You can manually turn off the fridge section of the fridge-freezer by pressing and holding the 'REF TEMP' button for 3 seconds. Press and hold the 'REF TEMP' button for 3 seconds to turn the fridge section back on. The fridge will automatically turn on to the temperature that was previously set.
- **IMPORTANT:** The ambient temperature of the room, the temperature of food and the amount of food that has been placed in the fridge freezer and how often the door is opened, will all affect the temperature being maintained by the appliance.

### Manually setting the fridge temperature.

- Press the 'REF TEMP' button once and the refrigerator icon will start to flash. Then press the 'REF TEMP' button again to adjust the temperature of the refrigerator.
- The temperature will change 1°C each time the 'REF TEMP' button is pressed and will scroll through a range of 2°C - 8°C.

*The chosen temperature will take effect after 5 seconds.*

## Manually setting the freezer temperature.

- Press the 'FRZ TEMP' button once and the freezer icon will start to flash. Then press the 'FRZ TEMP' button again to adjust the temperature of the refrigerator.
- The temperature will change 1°C each time the 'FRZ TEMP' button is pressed and will scroll through a range of -16°C – -24°C

*The chosen temperature will take effect after 5 seconds.*

## Switching on fast freeze mode

*This setting should be used before and whilst you are freezing fresh food, it will ensure that a powerful supply of cold air enters the freezer section.*

- Press the 'QUICK FRZ' button on the control panel. The 'QUICK FRZ' indicator will flash
- Press the 'LOCK/UNLOCK' button to confirm and the fast freeze mode will turn on.
- Press the 'QUICK FRZ' button again and you will be able to scroll through the fast freeze time options which cycles through 6hrs-8hrs-12hrs-24hrs-48hrs-(None). You can choose to cancel the fast freeze option by scrolling once past 48 hours.
- Select the amount of time you wish the fast freeze mode to be operational and then press the 'LOCK/UNLOCK' button to confirm. 6 hours will be the first/default amount of time and selected.
- The fast freeze mode will operate for the length of time set before automatically returning to normal operation.
- You can manually return the appliance to normal operation by scrolling through the time options and selecting no time, which comes one scroll past 48 hours.



***IMPORTANT: This mode should only be used prior to and when freezing fresh food. You should not run the appliance in fast freeze mode for prolonged periods.***

## Switching on rapid cooling mode

*This setting should be used if you want to chill something quickly, it will ensure that a powerful supply of cold air enters the fridge section.*

- Press the 'QUICK REF' button on the display. The 'QUICK REF' indicator will flash.
- Press the 'LOCK/UNLOCK' button to confirm, and the rapid cooling mode will turn on.
- You can manually return the appliance to normal operation by unlocking the control panel and pressing the QUICK REF button once. The QUICK REF indicator will turn off.



***IMPORTANT: You should not run the appliance in rapid cooling mode for prolonged periods. After the food is sufficiently chilled you should return the appliance to normal operation.***

## Switching on holiday mode

*This setting should be used if you are going on holiday. It will increase the temperature slightly to  $-15^{\circ}$  in the freezer sections to save energy, and it will **turn off the fridge**. If you use the use vacation mode you should empty the fridge of all perishables.*

- Press the 'VACATION' button on the display to turn holiday mode on and off. When it is on the 'VACATION' symbol will be illuminated.



***IMPORTANT: You should not run the appliance in holiday mode if you want to freeze fresh food in the freezer section. Before attempting to freeze fresh food you should return the appliance to normal operation and use the fast freeze mode (see page 13).***

## Switching on energy saving mode

*This setting should be used if you wish to save energy when using your appliance. It will increase the temperature slightly in the fridge and freezer sections to save energy.*

- Press the 'ENERGY SAVING' button on the display to turn energy saving mode on and off. When it is on the energy saving symbol will be illuminated. The fridge will be set to 7°C and the freezer to -15°C



***IMPORTANT: You should not run the appliance in energy saving mode if you want to freeze fresh food in the freezer section. Before attempting to freeze fresh food you should return the appliance to normal operation and use the fast freeze mode.***

## Returning the appliance to normal operation

- If you wish to cancel rapid cooling mode, holiday mode or energy saving mode you have to press the relevant button once. Please ensure that the corresponding indicator turns off, confirming that the function has been stopped.
- If you wish to cancel fast freeze mode, press that fast freeze button and scroll through the time length options until you scroll once past 48 hours. Ensure that the fast freeze indicator turns off, confirming that the function has been stopped.
- **IMPORTANT:** If you have fast freeze and rapid cooling modes active simultaneously, then you will need to cancel them separately.

## Child Lock function

*This setting locks the display control panel. None of the buttons except the ice-water selector key and the filter reset key will work while it is in locked mode, preventing accidental misuse.*

- The Child lock function will automatically activate after 60 seconds of inactivity and the lock icon will turn on.
- Press the 'LOCK/UNLOCK' button for 3 seconds to manually activate or deactivate the child lock function.
- When locked, the lock icon will flash and beep if any other buttons are pressed to indicate that the control panel is locked.

## Using the ice/water dispenser

### Before first use



You should not attempt to dispense ice for **6 hours** after the appliance is first connected to your mains supply.

- Once the fridge and freezer sections have cooled sufficiently place a cup against the PUSH pad in the dispenser and pour out a couple of glasses of water/ice.
- **IMPORTANT:** *These first couple of glasses of water/ice should not be consumed and should be poured down the sink. This is to flush the system of potential impurities.*
- **Note:** *When used for the first time, it may take a short time for the water tank to fill, therefore you may need to hold down the push pad for 2-3 minutes for the water to circulate.*

### Using the dispenser

- The dispenser can produce chilled water, crushed ice and cubed ice, as indicated on the control panel.

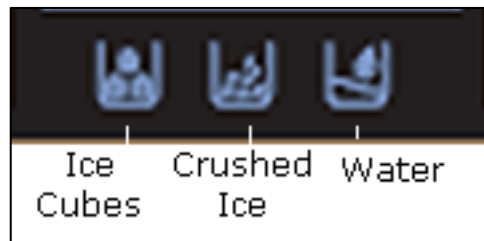

- Press the 'DISPENSER' button to select what you want the dispenser to produce. The options it will scroll through are ice cubes, crushed ice, or water.
- Place a cup against the pad in the dispenser and push it, after a few seconds it will dispense water or crushed/cubed ice. What comes out of the dispenser will depend on what option you selected before pushing the pad.
- You should place your cup/glass directly underneath the water/ice chute and not rest it on the base of the dispenser. Otherwise water/ice can spill or splash.



- When the dispenser is producing ice, you should remove the cup/glass from the dispenser chute when it is half full, otherwise you may get ice overflowing or the dispenser outlet could become blocked.

***IMPORTANT: To protect the motor, the dispenser will automatically shut off after 1 minute of continuous use. Releasing the pad and waiting a moment will reset the motor and you can continue to use the dispenser.***

- Shortly after ice has come out, you will hear a snapping sound which is a shut off valve operating; this stops further ice from being dispensed.

### **The ice maker**

- Ice cubes will be stored in the ice cube storage case.
- If the ice storage case becomes full, then the automatic ice making operation will stop.
- It is normal for there to be banging sounds, whilst the ice is being deposited into the ice cube storage case.
- If you use the dispenser several times in quick succession, then the ice cube storage case may empty. You will then need to wait approximately 2 hours for the ice maker to refill it.

### **Dispenser and ice maker warnings**

- Avoid using fragile cups or crystal glasses if you are dispensing cubed ice, as damage could be caused to them.
- To prevent a bad odour then you should regularly remove the ice from the ice cube storage case.
- If you have not dispensed ice for a period of time, then clear all of the ice out of the ice cube storage case and let the appliance produce fresh ice.
- ***DO NOT USE ICE THAT HAS BEEN STORED IN THE ICE CUBE STORAGE CASE FOR A LONG TIME.***
- ***IMPORTANT: If you find that the ice is discoloured, do not use the ice.***
  - Remove all of the ice in the ice cube storage case.
  - Let fresh ice form.
  - If the ice is still discoloured then change the water filter.

- If the ice is **STILL** discoloured after changing the water filter, then contact the Baumatic Customer Care Department.
- If there is a power cut you should remove all ice from the ice cube storage case. If you leave the ice in the storage case, then it will melt and water will flow into the main section of the freezer.
- **DO NOT** insert your fingers or any tools into the dispenser outlet.
- If ice cubes do not dispense, then pull out the ice cube storage case and separate any ice cubes that may have got stuck together. Then try to dispense ice again.

### Locking the ice maker



- Before cleaning the ice cube storage case or if you do not want the ice maker to produce ice, press the **ICE OFF** button.
- You should then remove all ice from the ice cube storage case.
- To reactivate the ice maker you should press the **ICE OFF** button again.

### Removing the ice cube storage case

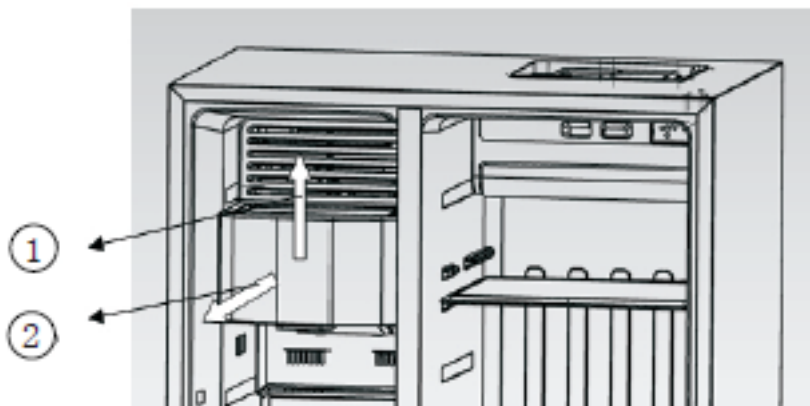

**IMPORTANT:** You should press the Ice Off button before removing the storage case.

- The ice cube storage case can be removed for periodic cleaning or to discard ice cubes.

- Lift the ice maker up (1) and then pull the storage case (2) to remove it from the freezer.
- To put the ice maker back into position, locate it into the side grooves of the cabinet and push it back into place.

### Water filter change icon



- the water filter needs to be replaced approximately every 6 months. The **WATER FILTER** icon will come on to show when the filter needs to be replaced.
- After changing the water filter (see below for details), unlock the control panel and press the **FILTER RESET** button for 3 seconds or until water filter icon switches off.
- If you change the water filter before the **FILTER CHANGE** icon comes on, then you should still press the **FILTER RESET** button to reset the countdown.

### Replacing the water filter

- **IMPORTANT:** Before commencing this process, please disconnect your appliance from the mains supply.

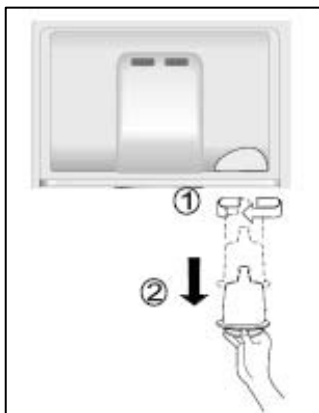

- Open the fridge door and look in the top right hand corner to locate the water filter.
- Carefully unscrew the water filter by turning it left (1) and remove it from the appliance (2).
- **You may want to remove the top safety glass shelf for easier access to the water filter.**

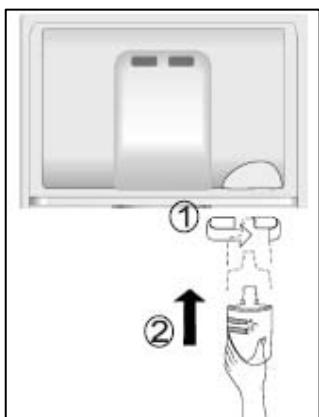

- Replace with a new filter. Insert the filter into the correct position and turn it right to fix it into place.
- A replacement water filter is available from the Baumatic Spares Department.
- The water filter should be replaced approximately every 6 months or when the water filter icon lights.

## Arranging and storing food in the fridge section

- Warm food or evaporating liquids should not be stored in your refrigerator, as this will increase the humidity inside of the appliance.
- All foods should be wrapped or covered, this is particularly important if the food has a strong flavour. You should use polythene bags or sheets, aluminium foil, wax paper. Liquids should be stored in covered containers or bottles.
- To maximise the space inside of the fridge section, any excessive packaging on the food should be removed.
- Quickly perishable food should be stored at the back of the refrigerator, which is the coldest part of the appliance.
- No food items should be allowed to come into contact with the back wall of the refrigerator.
- Make sure that you arrange food in such a way that the door can close completely. Particular attention should be given to bottles that may protrude when placed on shelves inside the main section of the refrigerator.
- Some organic solutions, such as the oils in lemon/orange peel and acid in butter, can cause damage to the plastic parts contained inside of the refrigerator.
- Do not open the refrigerator door too often or leave the door open for long periods of time, as this will increase the temperature inside of the appliance.
- **Meat** should be wrapped in polythene bags and then placed on the glass shelf above the salad crisper drawer. (**Meat should only be stored in this manner for one or two days at the most**).
- **Cold dishes/cooked food** should be covered and can be placed on any shelf.
- **Salad and vegetables** should be cleaned thoroughly and placed in the salad crisper drawers.
- **Fruit** should be cleaned thoroughly and placed in the fruit drawer.

- ***Cheese and butter*** should be placed in airtight containers, or they can be wrapped in aluminium foil or polythene bags. As much air as possible should be removed from the bags.
- ***Milk bottles*** should have a cap on them and be stored on the bottle shelves that sit in the door.
- ***Garlic, potatoes, onions and bananas should only be stored in a refrigerator IF they are stored in airtight containers.***

## The \*\*\*\* freezer section

The freezer section is suitable for storing and freezing food.

- The freezer section temperature must have already reached -18 degrees centigrade (or lower) before you attempt to store food that is already frozen or freezing fresh food.
- The freezer section is only able to freeze a certain quantity of fresh food at one time. The maximum amount of fresh food (in kilograms) that can be frozen in a 24 hour period is 10 kg.
- Warm food should be allowed to cool down before you attempt to freeze it. If you place warm food in the freezer section, then the increased humidity will cause quicker ice formation and increase the amount of power that the appliance uses.
- The guidance of the food manufacturer should be followed, in regard to the maximum storage time.
- Thawed foods must not be frozen for a second time.

## Freezing fresh food



- To freeze the maximum quantity of fresh food specified above, you should set the freezer to fast freeze mode (see page 13), 24 hours *prior to attempting freezing*.
- To freeze smaller quantities of fresh food, you should set the freezer to fast freeze mode a few hours prior to attempting freezing.



- Fresh food should be packed into airtight containers or packaging. This will help to make sure that the food doesn't dry out or lose its flavour. It will also ensure that flavour does not transfer from other foods.



- Do not allow fresh food to touch items that are already frozen.
- After 24 hours you should check that the fresh food is satisfactorily frozen. If it is then you should return the appliance to normal temperature settings.

## Tips on freezing

- Freezer bags, polythene wraps, aluminium foil (extra thick) and special cans for frozen foods are suitable packaging for storing frozen goods in.

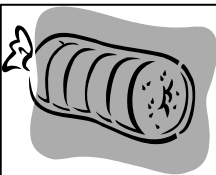

- Tape, rubber bands or plastic clips are suitable for sealing bags and wrappings.
- Before sealing a suitable bag, you should compress the air out of it, as this will help the food to freeze more easily.



- Flat packages freeze more easily.
- If you are freezing liquid, then do not fill the container to the brim. Liquids will expand when being frozen.

- ***Do not place bottles (glass or tin) containing liquids (especially sparkling liquids) into the freezer as this could cause the bottle to burst during freezing.***

## **Storing commercially frozen food**

- The storage time and recommended temperature for storing commercially frozen foods are indicated on the packaging.
- Always follow the manufacturer's instructions for storage and use of frozen food.
- When shopping, be careful to choose food which is adequately packed and is provided with complete storage instructions. It should have been stored in a freezer where the temperature does not rise above -18°C.
- Do not buy packages of food that are covered with frost. This could indicate that the package has thawed at least once before.
- Take care that your frozen food packages do not start to thaw before you place them in your freezer. This will shorten the length of time that you can safely store the food for.

## **Defrosting frozen food**

- Partially thawed or defrosted foods should be used as soon as possible.
- Cold air preserves the food but it does not destroy the micro organisms which rapidly activate themselves after defrosting and make foods perishable.
- Partial defrosting reduces the nutritional value of food, especially fruits, vegetables and readymade meals.

## **Normal operating noises**

### **Ice cracking noise**

- Can be heard during the automatic defrosting process.
- Can be caused by expansion and contraction within the icebox.
- Can be caused by ice dropping from the ice maker into the ice storage box

### **Short cracking noise**

- Can be heard when the thermostat turns the compressor on and off.
- Can be caused by the dispenser water supply valve closing.

## Compressor noise

- There will be an operating noise when the compressor is running.
- After installation, the compressor may be noisier for a short period of time.
- A similar noise can be caused by the ice dispenser motor.

## Bubbling and burbling sound

- This noise is emitted as the coolant flows through the pipework within the fridge.

## Water flowing sound

- This is caused by water flowing into the evaporating tray during the defrosting process and can be heard whilst the fridge is defrosting.
- Can be caused by the water/ice dispenser.

## Important user information



***IMPORTANT: Care should be taken to make sure that the airflow duct vents on the rear interior wall of the fridge and freezer sections are not blocked.***



***IMPORTANT: If your mains power supply fails, then the food inside of the freezer section will be preserved for a 5 hour period. After 5 hours the food should be removed from the freezer section and consumed as quickly as possible.***

## Saving energy when using your fridge-freezer

### Installing:

- Install the appliance in a cool position. If it is placed in direct sunlight or next to an oven or other heat source, the energy consumption can increase substantially.
- Ensure the appliance is installed with the correct ventilation requirements. Restricting ventilation can increase the energy consumption by 15%.



## **Cleaning and Maintenance:**

- Occasionally clean the condenser coils (if present) at the back of the appliance to maintain a high performance level.
- Clean the door gasket with warm water or a neutral detergent that leaves no residue. A tight-sealing door gasket is critical to the efficiency of your appliance.

## **Usage:**

- Do not open the door repeatedly or more frequently than you have to.
- Do not set the thermostat too low. A change of just one degree can effect the energy consumption by 5%. Use a thermometer to check the temperature.
- The freezer compartment should operate at -15 to -18 degrees Celsius. The refrigerator should operate at around 3 to 4 degrees Celsius.
- Allow food to sufficiently cool before putting it in the appliance (but don't let it sit at room temperature for too long).
- In the freezer compartment, food packages should be scattered and never grouped or stacked together until they are completely frozen.
- If you are going away for a long period of time, turn off the appliance, empty and clean it and leave the door ajar.
- If you have a second appliance that is not used, make sure that it is stored with the power off and the door left ajar until it is actually required.

## **Disposing:**

- If you're going to throw out your old fridge, see if there's a chlorofluorocarbons (CFCs) recycler in your area. The government department which looks after the environment in your area may be able to help you.

## Cleaning and maintenance

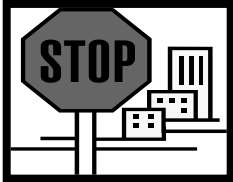

**WARNING: PLEASE ENSURE THAT YOUR APPLIANCE IS DISCONNECTED FROM YOUR MAINS SUPPLY BEFORE ATTEMPTING TO CLEAN IT.**

- Do not clean the appliance by pouring water onto it or spraying water over it.

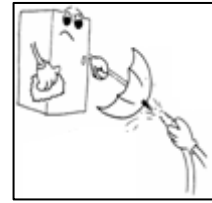

- The refrigerator and freezer section should be cleaned periodically, using a solution of bicarbonate of soda and lukewarm water.

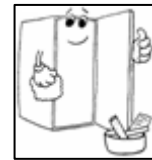

- Clean the accessories separately with soap and water. Do not clean them in a dishwasher.

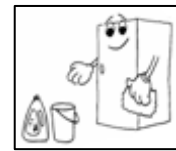

- Do not use abrasive products, detergents or soaps.



- After washing the appliance, wipe over the area that you have cleaned with a damp cloth and then dry it thoroughly.

- When cleaning is complete, dry your hands and then reconnect the plug to your mains supply.

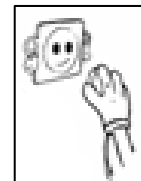

**IMPORTANT:** Before attempting any of the cleaning steps shown below, you should remove all items from the shelves and sections that you are cleaning.

### Fridge and freezer door sections

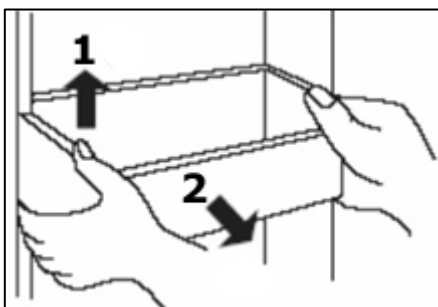

- To remove a door shelf: Take off all of the items that are stored on the shelf that you want to remove. Pull the shelf upwards **(1)** and then carefully pull it away from the inside of the door **(2)**.

## Fridge and freezer shelves

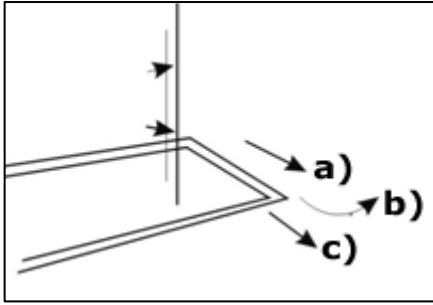

- To remove a shelf: Take off all of the items that are stored on the shelf that you want to remove. Pull the shelf forwards **(a)**, then lift the front of the shelf **(b)** towards 90° and carefully pull it out of the grooves **(c)**.

## Salad crisper drawers

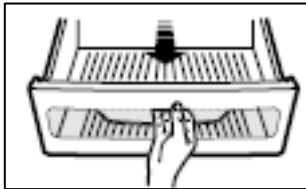

- To remove a drawer, lift up a little and pull forward.

## Interior parts

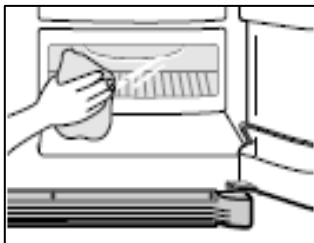

- Use a cloth that has been wetted with water and mild (neutral) detergent and wipe over the interior parts of the appliance.

## Door seal

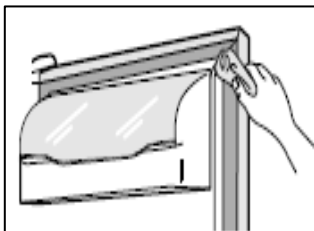

- Use a cloth that has been wetted with water and mild (neutral) detergent and wipe around the door seal.

## Rear grill

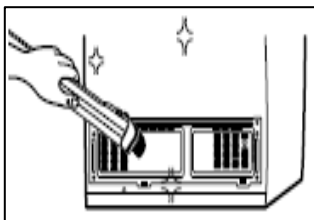

- At least once a year, remove any dust that has gathered on the grill at the rear of the appliance, using a vacuum cleaner.

## Dispenser shelf

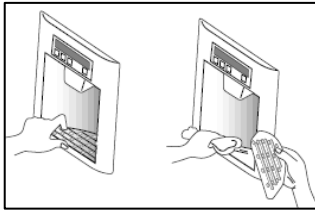

- Take out the spillage grill and use a cloth to remove water from and clean this area.

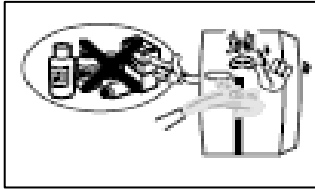

**DO NOT USE ANY FORM OF ASOLINE (PETROL) OR BENZENE (BENZOL) THINNERS ON ANY AREA OF THE APPLIANCE. AS THESE CHEMICALS CAN DAMAGE THE SURFACES.**

## The defrost drain hole

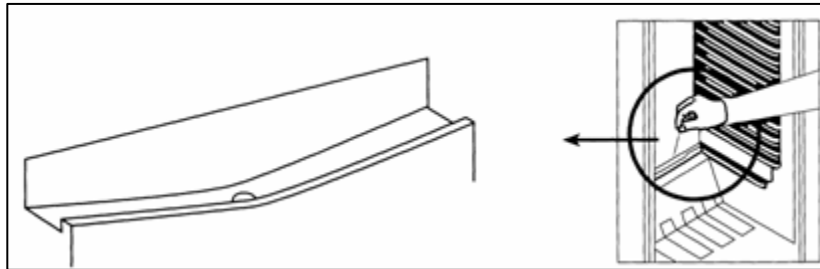

- Defrosting occurs automatically in the fridge section during operation. The defrost water is collected by the evaporating tray and evaporates automatically.
- The drain hole should be cleaned periodically with the drain hole cleaner. This will prevent water from collecting in the bottom of the refrigerator, instead of flowing down the defrost drainage channel and drain hole.
- **IMPORTANT:** Please note that the drain hole cleaner should not be left in position permanently. Otherwise this may prevent the defrost water from entering the drain hole.
- You can also pour a small amount of water down the drain hole to clean the defrost drainage channel.
- You should be careful to make sure that food packages do not touch the rear wall of the appliance, as this can interrupt the automatic defrosting process and deflect water into the base of your refrigerator.

- Use a solution of bicarbonate of soda and lukewarm water to clean the evaporating tray.
- **IMPORTANT:** *It is normal to get some ice droplets forming on the back wall of the appliance. The formation of ice droplets does not indicate an appliance fault.*

## Defrosting the freezer section

Your appliance is frost free, so you should not need to manually defrost the freezer section.

However, if for example the door is left open for a prolonged period of time or the door gasket is not sealing correctly, then you could get ice building in the freezer section. If this occurs, then you should follow the steps below.

- The day before you defrost, you should activate fast freeze mode; this will make sure that the food contained in the section is frozen properly.
- Whilst defrosting the appliance, the food should be removed from the section and wrapped in several layers of paper and stored in a cool place. The foods rise in temperature will shorten its storage life and therefore the food should be used within a relatively short period of time.
- **DO NOT PLACE FOOD BACK IN THE FREEZER SECTION THAT HAS STARTED TO THAW.**
- Turn the appliance off by turning off the power supply to the fridge freezer.
- Remove the drawers and shelves from the freezer section and leave the door to the freezer section open. You can place a bowl of warm water inside the freezer section to speed up the defrost process.
- You can use a sponge to mop up the defrost water that will run into the bottom of the freezer section.
- **IMPORTANT:** *You should place some old towels on the flooring that is immediately in front of the appliance. In case any defrost water comes out of the freezer section and onto the floor.*
- Once all the ice that has built up has melted, then the inside of the freezer section should be dried thoroughly. Failure to do this will result in immediate ice build when the appliance is turned back on.

- With dry hands, reconnect your appliance to your mains supply. You should activate fast freeze for a 24 hour period, before returning it to the normal temperature setting of at least -18°C
- You should not attempt to freeze fresh food inside the freezer section until this 24 hour time period has elapsed.
- ***Do not defrost the appliance with other electrical devices (e.g. hair dryer). Do not use sharp metal objects to remove the ice on the freezer, as this could cause damage to the refrigerant system.***

## The light bulb

***WARNING: This product is fitted with durable LED bulbs which last for approximately 10,000 hours. Therefore, there is no need to change the bulb unless it is faulty or damaged. If a bulb does need replacing, do not change the fuse or LED lamp on your own. Please call the Baumatic Customer Care Department to arrange an engineer visit.***

## Installation

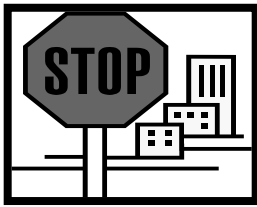

***IMPORTANT: Before installation and usage read all the instructions and make sure that the voltage (V) and the frequency (Hz) indicated on the rating plate are exactly the same as the voltage and frequency in your home. The rating plate can be found behind the salad crisper drawers.***

The manufacturer declines all responsibility in the event of the installer failing to observe all the accident prevention regulations in force, which are necessary for normal use and the regular operation of the electric system.

## Electrical connection



***YOUR FRIDGE FREEZER IS INTENDED FOR FITTED AND PERMANENT INSTALLATION.***

We recommend that the appliance is connected by a qualified electrician, who is a member of the N.I.C.E.I.C. and who will comply with the I.E.E. and local regulations.

- Your refrigerator comes supplied with a 13 amp plug fitted. If in future you need to change the fuse in this plug, then a 13 amp ASTA approved (BS 1362) fuse **must** be used.
- The refrigerator should not share a multi-purpose socket with other electrical appliances.
- The wiring in the mains lead is coloured as follows:

<b>Brown</b>	Live
<b>Blue</b>	Neutral
<b>Green and yellow</b>	Earth

- As the colours of the wires in the appliance's mains lead may not correspond with the coloured markings identifying the terminals in your spur box, please proceed as follows:

The **brown wire** must be connected to the terminal marked "L" (live), or coloured **red**.

The **blue wire** must be connected to the terminal marked "N" (neutral), or coloured **black**. The **green and yellow wire** must be connected to the terminal marked "E" (earth), or by the earth symbol, or coloured **green and yellow**.

- When the connection is completed, no stray strands or cut wire should be present. The cord clamp must be secured over the outer sheath.

## Positioning

- It is advisable that your appliance is only installed in a location where the ambient temperature of the room, corresponds with the climate classification that is stated on the rating plate of your appliance. Your appliance may not function correctly if the ambient temperature falls outside of the following ranges.

<b><i>Climate classification</i></b>	<b><i>Appropriate ambient temperature</i></b>
SN	+10 to +32 degrees centigrade
N	+16 to +32 degrees centigrade
ST	+18 to +38 degrees centigrade
T	+18 to +43 degrees centigrade

- Positioning the appliance requires two persons in order to avoid injuries or damage to the appliance.

- Your appliance should not be located in direct sunlight or exposed to continuous heat or extremes of temperature (e.g. next to a radiator or boiler). If this is not feasible, then you should install an insulation plate between the appliance and the adjacent heat source.
- You should check whether there is an electrical socket available, which will be accessible after your appliance is installed.
- Place the appliance flatly and firmly on a solid base. The appliance is fitted with adjustable feet on the front side, which can be used to level the appliance.
- The rear side of the appliance is fitted with wheels which facilitate the positioning of the appliance into its final location.
- Anything positioned above the appliance must be at least 30 cm away to allow sufficient cooling of the condenser. You must allow a 5 cm gap either side of the appliance and a 10 cm gap to the rear.
- If you are placing another cooling appliance next door to this product, then there must be a gap of at least 5 cm between the appliances. This will help to prevent condensation from forming.
- Be sure to leave enough space for the opening of the door, to avoid damage to the appliance or personal injury.

## Installation preparation



***IMPORTANT: A minimum of two people should complete all of the installation steps given in this manual.***

- Check that the appliance will easily pass through all doorways en-route to its final position.
- Appliance dimensions: 1760 mm (h) x 902 mm (w) x 750 mm (d) (including door handles).
- If your appliance will not fit through a doorway, then it is possible to remove the fridge and freezer doors by following the process on the following pages.



## Removing the fridge and freezer doors

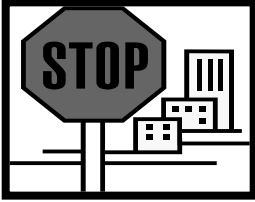

***WARNING: PLEASE ENSURE THAT YOUR APPLIANCE IS DISCONNECTED FROM YOUR MAINS SUPPLY BEFORE ATTEMPTING TO REMOVE EITHER OF THE DOORS.***

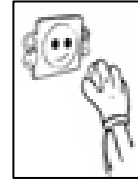

- Remove the hinge cover that sits on the top of the appliance.

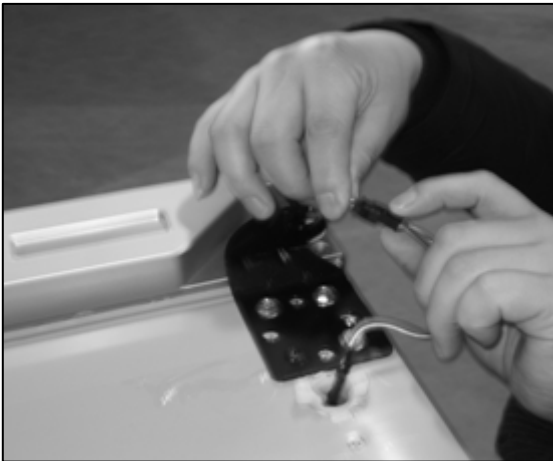

- Disconnect the electrical connection point that sits underneath the hinge cover.

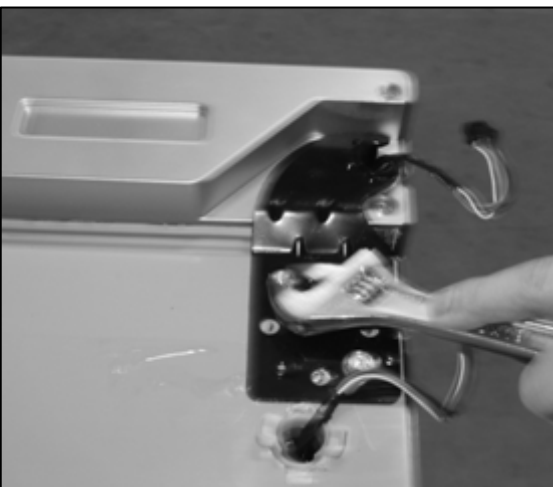

- Undo the three bolts that hold the upper hinge in place.



- **IMPORTANT:** One person should support the door before attempting this next step. Lift up the front of the hinge and remove it from the appliance.



- Whilst still supporting the door, slowly lift it upwards to disengage it from the lower hinge. Once the door has been lifted clear of the lower hinge, pull it away from the main chassis of the appliance.

- **IMPORTANT:** The door should be lent carefully against a wall, so that the inner or outer surfaces cannot be accidentally damaged.
- Repeat the same process for the other door and then carefully position the appliance where you want to locate it.
- Each door should be reassembled by following the door removal process in reverse.
- **IMPORTANT:** You should ensure when refitting the doors that:-
  - a) The doors sit properly on the lower hinges.
  - b) The upper hinges are correctly positioned.
  - c) The bolts that hold the upper hinges in position are fully tightened.
  - d) The electrical connection points are reconnected.
  - e) The hinge covers are refitted.

## Installing the decorative plinth

- A decorative cover for the base of the appliance can be installed if you wish however it is not essential. The plinth is for decorative purposes only and will not affect the refrigerator's performance.
- The plinth should be installed using the 3 screws as shown in the diagram below:

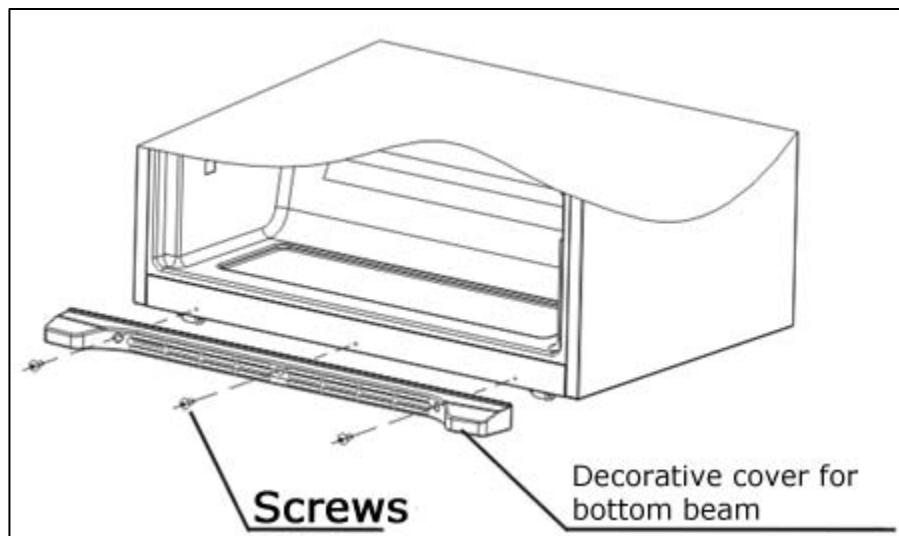

## The water inlet hose and water filter

- The water pressure should be 2.06 - 6.89 bar / 30-100 psi to allow the icemaker to operate correctly.
- Care should be taken to make sure that the water inlet does not come into contact with any hot surfaces.
- The water filter only filters the water; it does not eliminate bacteria or microbes.
- The water filter life will depend on how often you dispense water and ice. We recommend that the water filter is replaced at least every 6 months.
- **IMPORTANT:** *The water inlet MUST be connected to your cold water supply.*

## Connecting the water inlet hose and water filter

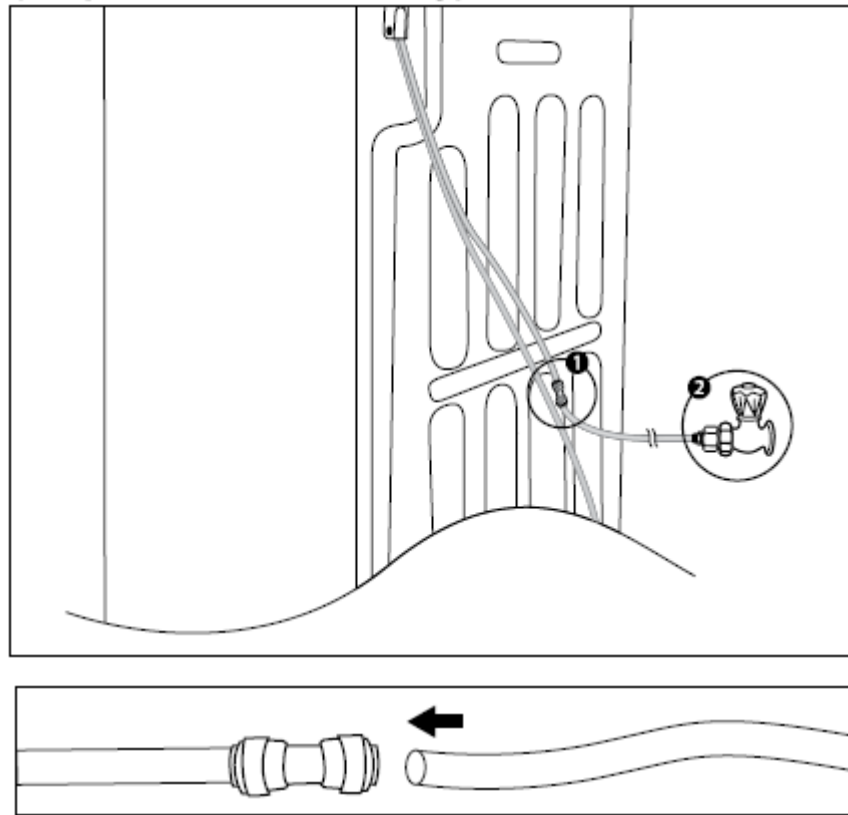

1) Connection the water inlet hose to the connector on the rear of the appliance.

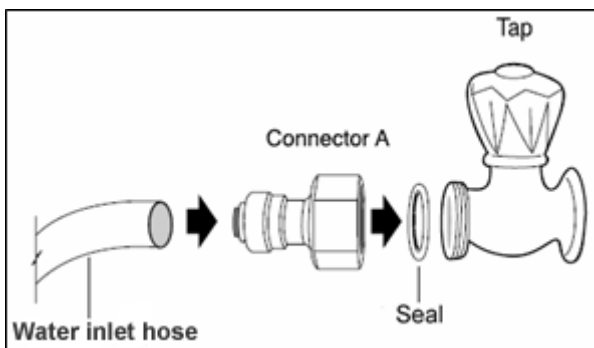

2) Place the seal inside of connector A and then screw connector A securely onto your cold water mains supply. Push the water inlet hose firmly onto connector A.

- Ensure that the water tap which the inlet hose is connected to is fully open.
- Select the water dispensing option and run it for 2 – 3 minutes, this supplies water to the water tank and will eventually dispense water.

**IMPORTANT-** The running of water through the inlet hose and filter must be done, to make sure that any impurities from the manufacturing process are washed out.

- Check thoroughly for any leaks.

**IMPORTANT-** If there are any signs of water leaks, you should follow the installation procedure stage by stage again.

## Troubleshooting



**IMPORTANT:** If your fridge freezer appears not to be operating properly, before contacting the Baumatic Customer Care Department, please refer to the checklist below.



***My fridge freezer does not appear to be working/there is no power to my appliance.***

- Check that the plug is fully inserted into the power socket.
- Check that there is power to your mains supply (e.g. that there hasn't been a power cut or that the fuse hasn't blown).
- Check that your mains supply voltage, corresponds to the voltage stated on the rating plate of your appliance.



***My fridge freezer appears to be performing poorly.***

- Check that the appliance isn't overloaded and that food hasn't been packed too tightly into it.
- Either the fridge or freezer temperature is not set to a low enough temperature. You should set the fridge and/or freezer temperature to a lower temperature.
- Ensure that the doors are closing properly and that the doors have not been opened for a prolonged period in error.
- Ensure that there is adequate ventilation for your appliance.



***My fridge freezer is noisy.***

- The refrigerant gas that circulates the pipe-work of the appliance may make a slight noise, even if the compressor is not running.
- If the noise worsens or the appliance gets louder than normal; check that it is levelled off correctly, that nothing is touching the rear of the fridge freezer and that nothing placed inside the appliance is rattling.



***Ice has formed on the inner back wall of my fridge***

- Check that food has not been pushed too far back inside the appliance, so that it is in contact with the inner back wall.
- ***IMPORTANT:*** *It is normal to get some ice droplets forming on the back wall of the appliance. The formation of ice droplets does not indicate an appliance fault.*



***There is water in the base of the fridge or leaking out of my fridge.***

- Follow the "The defrost drain hole" section on page **28**.



***The interior light is not working.***

- The interior light of the fridge is made up of LED lights and should be long lasting. Please contact the Customer Service Department.



***IMPORTANT: If your appliance appears not to be operating correctly, then you should disconnect it from your mains supply and then contact Baumatic Customer Care on telephone number (0118) 933 6911.***

***DO NOT ATTEMPT TO REPAIR THE APPLIANCE YOURSELF.***

Please note that if an engineer is asked to attend whilst the product is under guarantee and finds that the problem is not the result of an appliance fault, then you may be liable for the cost of the call out charge.

***The appliance must be accessible for the engineer to perform any necessary repair. If your appliance is installed in such a way that an engineer is concerned that damage will be caused to the appliance or your kitchen, then he will not complete a repair.***

***This includes situations where appliances have been tiled in, sealed in with sealant, have wooden obstructions placed in front of the appliance, like plinths. Or any installation other than the one specified by Baumatic Ltd. has been completed.***

Please refer to the conditions of guarantee that appear on the warranty card that you receive with the appliance.

***IMPORTANT: Baumatic Ltd. operates a policy of continuous improvement and reserves the right to adjust and modify its products without prior notification.***

## Baumatic consumables

- **BC001** Degreaser for Dishwashers (200g)
- **BC002** Descaler for Washing Machines and Dishwashers (200g)
- **BC003** Ceramic Hob Cleaner (250ml)
- **BC004** Oven Cleaner (250ml)
- **BC005** Stainless Steel Cleaner and Protector (250ml)
- **BC007** E-Cloth – General Purpose Cloth
- **BC008** Microwave Cover

To order a Baumatic consumable product please call 0123 5437 244 and quote the product code. You can also order online from [eshop.baumatic.co.uk](http://eshop.baumatic.co.uk)



## Technical Data

Manufacturer	BAUMATIC LTD
Model Number	B25SE
Product Category	7 – Refrigerator-Freezer
Energy Efficiency Class <b>(1)</b>	A+
Annual Energy Consumption <b>(2)</b>	427 kWh
Storage Volume of Fridge Compartment	340 litres
Storage Volume of Freezer Compartment	175 litres
Star Rating	4 (2 for door racks)
Frost Free Compartments	Fridge and Freezer
Temperature Rise Time	5 hours
Freezing Capacity	10kg/24hr
Climate Class <b>(3)</b>	N, ST
Noise Level	47 dB
Installation Type	Freestanding

**(1)** On a scale from A+++ (highest efficiency) to G (lowest efficiency).

**(2)** Annual energy consumption based on standard test results for 24 hours. The actual energy consumption will depend on how the appliance is used and where it is located.

**(3)** This appliance is intended to be used at an ambient temperature between "16°C" (lowest temperature) and "38°C" (highest temperature).



***United Kingdom***

Baumatic Ltd.,  
Baumatic Buildings,  
6 Bennet Road,  
Reading, Berkshire  
RG2 0QX  
United Kingdom

**Sales Telephone**

(0118) 933 6900

**Sales Fax**

(0118) 931 0035

**Customer Care Telephone**

(0118) 933 6911

**Customer Care Fax**

(0118) 986 9124

**Spares Telephone**

(01235) 437244

**Advice Line Telephone**

(0118) 933 6933

**E-mail:**

sales@baumatic.co.uk  
customercare@baumatic.co.uk  
spares@baumatic.co.uk  
technical@baumatic.co.uk

**Website:**

www.baumatic.co.uk

**Facebook:**

[www.facebook.com/baumatic.uk](http://www.facebook.com/baumatic.uk)

***Republic of Ireland***

**Service Telephone**

1-890 812 724

**Spares Telephone**

091 756 771

***Czech Republic***

Baumatic CR spol s.r.o.  
Lípová 665  
460 01 Liberec 4  
Czech Republic

+420 483 577 200  
www.baumatic.cz

***Slovakia***

Baumatic Slovakia, s.r.o.  
Panenská 34  
811 03 Bratislava - Staré Mesto  
Slovakia

+421 255 640 618  
www.baumatic.sk

***Germany***

Baumatic GmbH  
Bachstr.10-12  
D-32 257 Bünde  
Deutschland

+49 (0) 5223 99408 0  
www.baumatic.de

***Italy***

Baumatic Italia S.R.L.  
Via Galvani N.3  
35011 Campodarsego (PD)

+3904 9920 2297  
www.baumatic.it

***Holland***

Baumatic Benelux B.V.  
Dukdalfweg 15d  
1332 BH ALMERE  
Nederland

+31(0)36 549 1553  
www.baumatic.nl



