

Receiver Cassette - Model No. RX9913

 T9910/010/A

Display

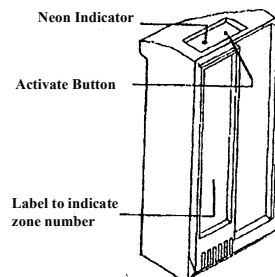

General Description

The RX9913 can only be used in RPX, EVX and EVS heaters and with a master heater fitted with the Mains Signalling Transmitter (Part No. RX9912).

They operate by receiving a high frequency signal from the master heater transmitter (RX9912). During set up receivers are dedicated to only one transmitter so that they cannot be activated by signals from any other transmitter unit.

Installation

The RX9913 is rated at 230V.

1. Using a narrow bladed screwdriver, carefully release the cover from the slot adjacent to the controls on the heater
2. Insert the receiver fully so that it clicks into position
3. Turn the control knob on the heater to the PROG position

INSTALLER PLEASE NOTE:

Please mark clearly on the receiver label the number of the zone allocated, if used in a multi zone application.

Operating Instructions Dedicating to a zone:

Firstly read the **Mains Signalling Transmitter** user instructions for operating with the receiver, following the steps listed under single or multi zone programming.

1. When the master programmer starts to flash the EMET message and required zone number, press the small button (A) for 10 seconds until the indicator neon (B) flashes
2. Release and press again, neon indicator will be **ON** continuously.

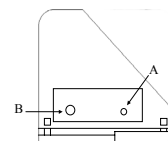

Setting comfort and setback temperatures:

For heaters fitted with receivers, set the temperature controls in the normal way (refer to heater instructions).

Manual Override:

Turn the control button on the slave heater to the required position (comfort, setback, frost protection or off).
To cancel override and return to programmed operation, turn back to the PROG position.

Locking the receiver:

An extra screw is supplied to lock the receiver in place. Lock by piercing the prominent spur on the side of the heater casing until the screw enters a matching hole in the receiver.

General Cleaning

WARNING

BEFORE UNDERTAKING CLEANING WORK ON THE CONTROLLER OR APPLIANCE IMMEDIATELY DISCONNECT THE ELECTRICITY SUPPLY BY SWITCHING OFF AT THE ADJACENT DOUBLE POLE SWITCH.

The outside of the appliance should be wiped over with a soft damp cloth and then dried. Do not use detergents or abrasives.

After Sales Service

Your Dimplex Control is guaranteed for one year from date of purchase. We undertake to exchange or repair free of charge within this period, any part found to be defective.

Should you require after sales service, please get in touch with the supplier through whom you purchased the appliance, or your nearest Service Agent.

Please do not initially return a faulty appliance or part of an appliance to us as this may result in transit damage and/or delay in providing service. Let us know your difficulty quoting the model number and series of the appliance. We will then take the appropriate action.

421AA0794.A NR/BLA 49/99