



aperta

APWIFIDS | WI-FI DOOR STATION



**esp**[®]

www.espuk.com





aperta

System Overview



Kit contains:

- Wifi door station
- 12vDC (500mA) power supply
- 10DB Wifi Antenna
- Micro SD card (pre-installed)
- Hex key
- Reset pin tool
- LAN terminal
- Wire connectors
- Screws and rawl plugs

Optional accessories:

EVBP5BB
Lock power supply



EV-EXIT
Push to release



EV-EBG
Emergency release



EV-ML-250/500XT
Electro-magnetic lock



ENTERD
Electric lock





Connections

It is recommended the door station is programmed prior to installation.

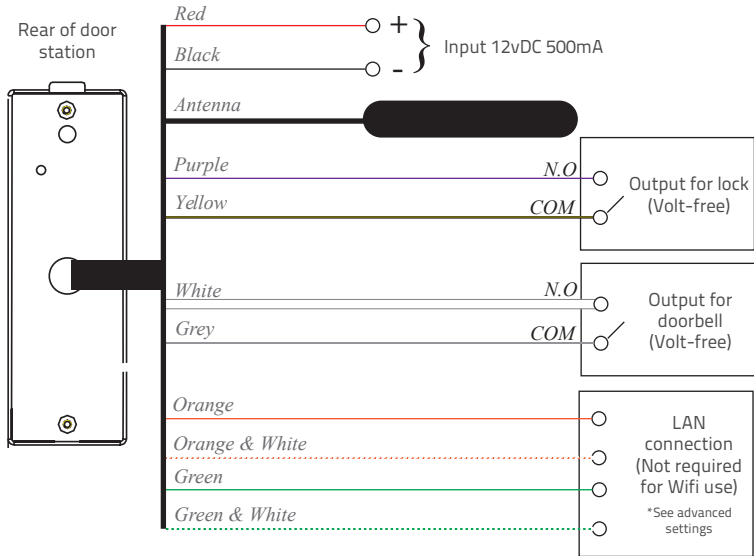



aperta

Installation

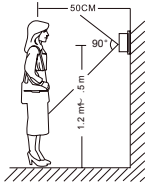

Site the door station 1.5 meters from the ground, or to suit application.

Position camera in the direction of where a visitor will stand during operation.

Avoid areas of high sunlight and noise levels.

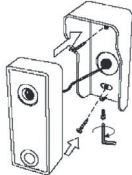

Surface mount the sunshield of the door station and connect the system cabling.

Mount the camera to the sunshield by fixing with the supplied hex screw.



All system connections are to be made inside the building, this includes the siting of the antenna.





aperta

System set up

Please ensure the following;

1. The user's smart-phone is connected to the Wi-Fi network.
2. The Door Station is within the network's Wi-Fi range.
3. The network's key/password is available.

Whilst the door station is powered, the rear tamper switch will be active. Ensure the tamper switch is surpressed during setup.

If the tamper alert is activated the alarm will sound for 60 seconds, or bypassed by powering down for 10 seconds

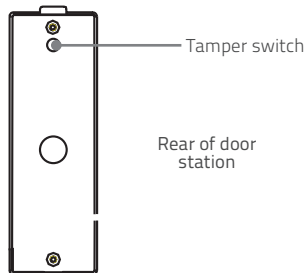



aperta

Step One:

Connect the Antenna and power supply to the door station. Apply power.
The Micro SD card is pre-installed and is not accessible.

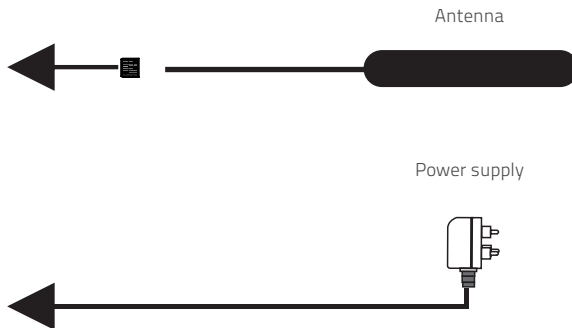
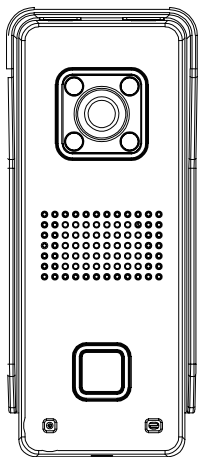



aperta 

Step Two:

After 60 seconds of the power applied. The door station will sound a registration tone every 5 seconds.

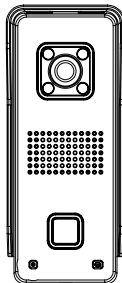

If the **registration tone is not heard**;

Press and hold the Reset button on the rear of the door station for 5 seconds using the supplied reset pin tool.

A 'ching' tone alerts the reset has been successful.

After 60 seconds the registration tone will sound every 5 seconds.

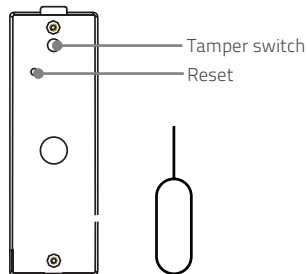



aperta

Step Three:

Download the required APP by searching for **ESP Aperta** on the APP market.

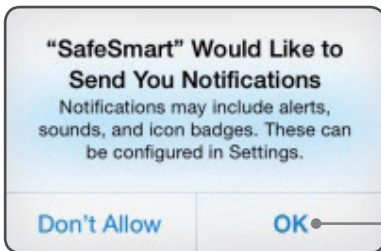

Once installed open the APP and allow any notifications to be enabled;





Step Four:

Follow the on screen instructions to register an account;

1. Input your email
2. Input your ID password

Please remember your ID

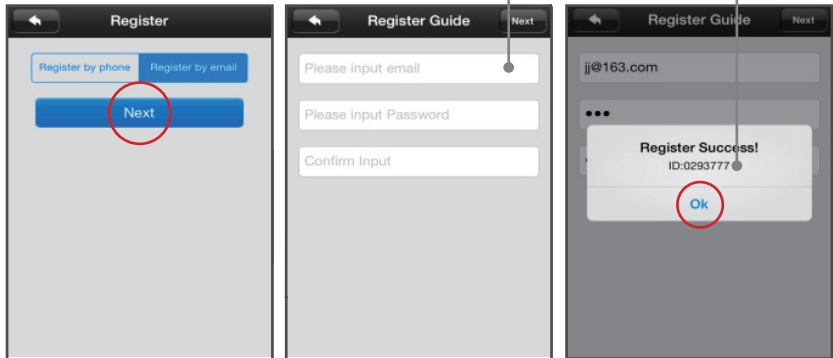



aperta

Step Five:

Login to the APP

In the Device list
Select the 'Tool' symbol

Select
'Set Wi-Fi By QR code'

Check the network selected
is correct

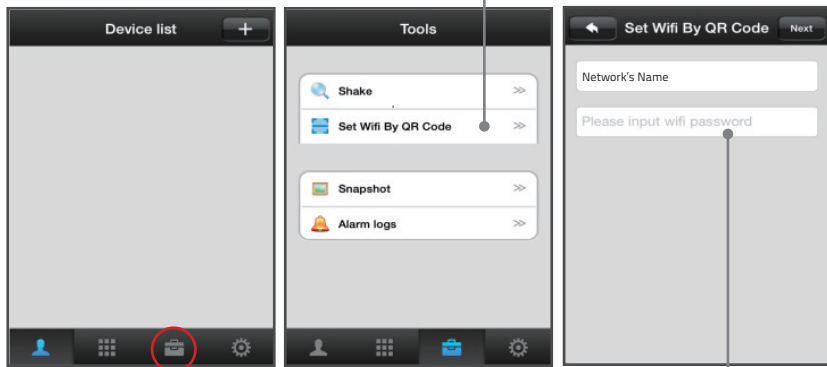

Input your wifi password, then
tap 'Next'.





aperta ▶

Step Six:

The APP produces a QR code.
Present the QR code to the Door
station lens (Appox. 15cm)

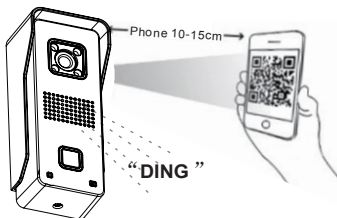

When the door station
confirmation tone is heard select
'Heard' on the APP screen;

After you hear the
sound 'DING'

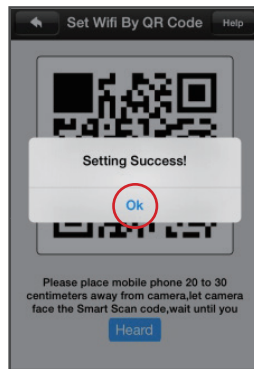



aperta

Step Seven:

1. After 60 seconds refresh the Device List by sliding down on the screen and the Door Station ID will appear.
2. Select the green plus symbol.

3. Input **default password: 123** and select **Save**.

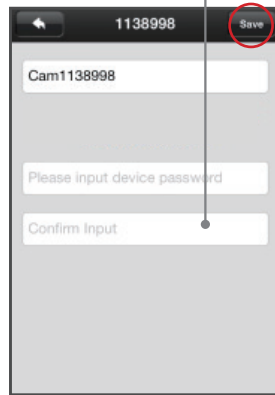
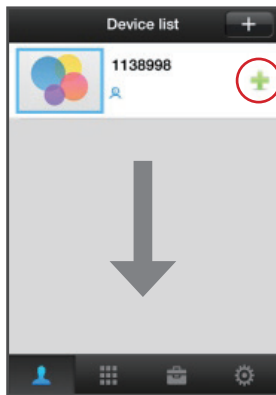



aperta

Step Eight:

Review APP alarm settings by tapping on the the Door Station ID on the device list,

Select Alarm settings and
ensure enable 'Alarm Push'

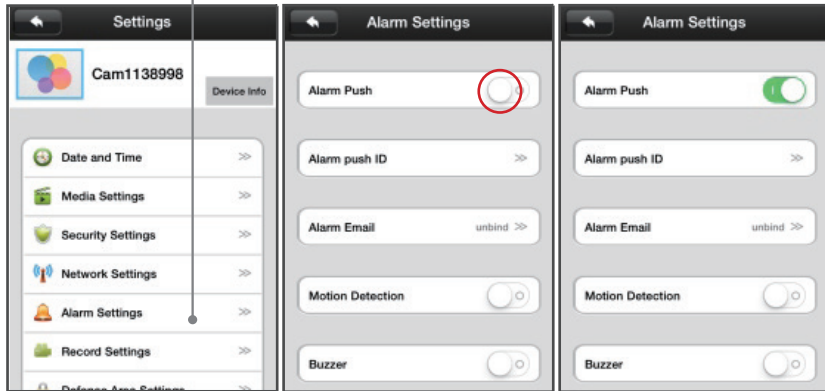



aperta

Step Nine:

Press the call button on the Door Station to test alerts

Android APP Operation



IOS APP Operation

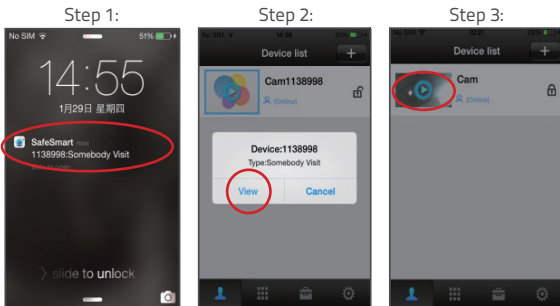

If test is successful; retest Door Station in installation position before fixing.





aperta 

APP Operation

During a Connection



Lock release
Press and hold for 3
seconds to activate
doorstation lock output



Disable
audio

Image
snapshot

End call

Reserved for future
function





Adding a new user

Install the APP on the new user's smart phone and register an account;

Select '+'



Select 'Manual'

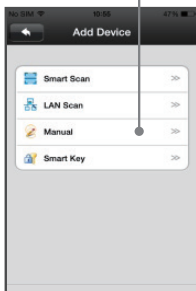

Enter the door station's ID and select 'save'

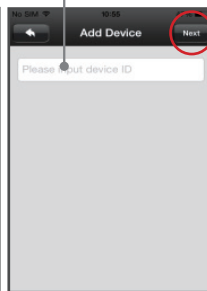

Enter the password and select 'save'

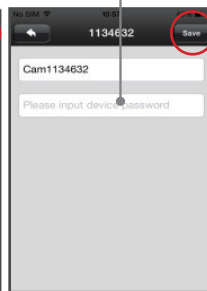



Notes on Best Performance

Network Connection

Wi-Fi devices rely on a strong and stable signal from the network. Performance and reliability of Wi-Fi devices can become unpredictable if the signal strength is not sufficient for whatever the reason.

If Wi-Fi signal is a possible issue, one solution is the numerous Wi-Fi signal enhancing devices on the market to improve a network's performance.

Another solution is to use the LAN connection facility where applicable.

In addition, network connection for all devices (Wi-Fi or LAN) is limited by the bandwidth allowance of the network, ensure that the bandwidth is suitable for the number of devices which are being supported.

Please note; APWIFIDS requires the network to use 2.4GHZ Wi-Fi signal band.

APP Connection

Viewing from a mobile phone relies on a strong Wi-Fi signal or ensure a strong 3G or 4G signal is available.

For IOS it is recommended that the APP is left running in the background in order to benefit from the best performance.

For Android, the APP must be left running in the background to receive any service from the Door Station.

ESP are unable to guarantee that every device will be compatible with any ESP product and software supplied. Specific models of phone, tablet or other device, the hardware it contains, the service provider, the types of data services offered and specific phone / device plan will all affect the performance of PC / mobile device for remote viewing.





Support Guide

Setup

If there are any issues encountered in the setup steps 1-9;

- Check the correct APP has been installed
- Check the Door Station has sufficient power. Power OFF door station for 10 seconds and reapply power , then default the Door Station as instructed in Step 2, and re-attempt setup.

If issues persist; refer to the notes on best performance before re-attempting setup.

Specification

Image sensor	1/4" colour CMOS Sensor
Compression	H. 264
Resolution	HD: 1280*720; SD: 640*360; LD 320*180
Memory	8GB Memory inside.
Lens	Fixed 2.1mm 110° / 3.6mm 60°
Sensitivity	0Lux (IR ON) / 0.5Lux (normal)
IR LED	4 x Φ4
Night vision distance	Max. 2 meters
IR-CUT	Included
Wifi antenna	10DB
Size	L55 x W40 x H129mm
Power supply	DC 12V 500mA <12W
Max. current of relay's	<3A
Working Humidity	10% ~ 80% no condensation
IP level	IP65





aperta

LAN Connection

Rear of door station

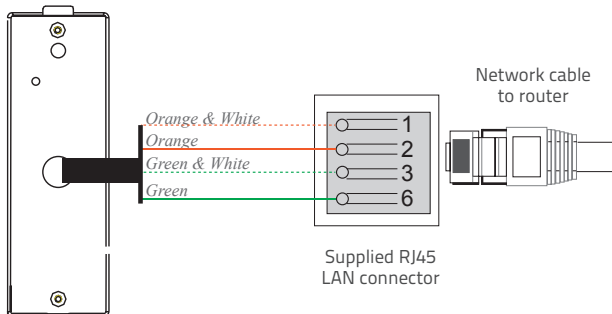

LAN setup

1. Slide down to refresh and find device
2. Click to add device

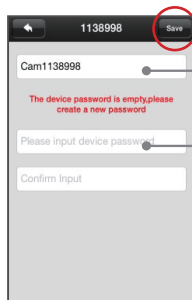
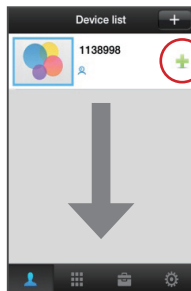

3. Input your device name
4. Input your device password, then tap 'Save'.

Page 19





CE

Elite Security Products

Unit 7, Target Park,
Shawbank Road, Lakeside,
Redditch B98 8YN



Telephone: 01527 51 51 50

Fax: 01527 51 51 43

Email: info@espuk.com

www.espuk.com

E&OE - Errors and omissions excepted.L16

