

General

Our products are designed to comply with the recommended codes and practice, and is to be installed and serviced by competent persons in accordance with the relevant regulations.

Contents

The Smart PIR is supplied with required batteries, mounting bracket and mount pack.

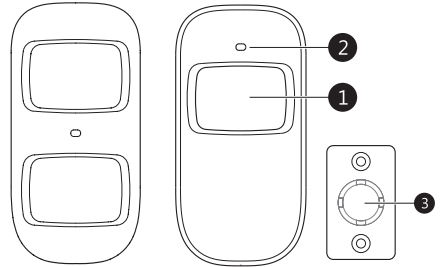

1. Detection window
2. LED indicator
3. Bracket

First Use

Find the screw on the bottom of the PIR.
Undo the screw and open the front part of the casing.

- Insert the batteries, with the correct polarity.
- Once the batteries are inserted, the detectors will start its self-test procedure for 30 seconds.
- After self detection has completed, complete configuration.

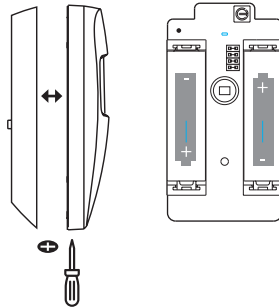

Installation

Fix the bracket on the wall, with screws and attach the detector to the bracket. Adjust the bracket to change the detection distance and angle. It is recommended to mount the detector 2m from the ground.

Avoid mounting the detector close to windows, AC units, heater(s), refrigerator(s), oven(s), sunshine, and places where there are severe changes in temperature, or where the air stream flows frequently.

If two detectors are installed in the same detection area, adjust the location to avoid interference, and false alarms.

PIR detectors are more sensitive to horizontal movements, than vertical.
ECSPPET includes Pet immunity up to ≤ 25 kgs

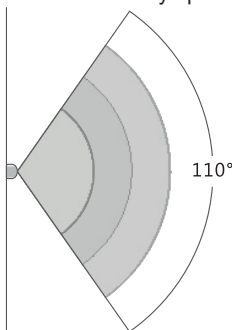

Top view

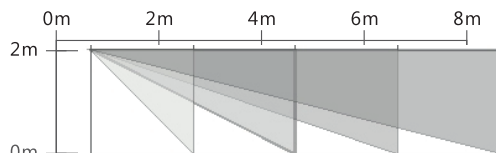

Side view

Mode Setting

Testing Mode

Once the self-testing is complete, long press the test button. The sensor switches to testing mode, and scans once every 10 seconds. After 3 minutes, the LED blinks twice, and the sensor switches to working mode.

Working mode / Stand-by mode

In working mode, if the sensor is triggered more than twice within 3 minutes, it will switch to standby mode to save power. If no movement is detected within the next 3 minutes, the sensor will switch to working mode.

Register the detector in the alarm system

Switch to connection mode on the control panel. Press the test button of the sensor twice. The control panel beeps once; the motion detector is registered. If you hear two beeps, the detector has already been connected.

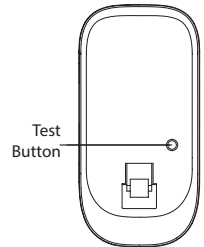

To check if the registration is complete, arm the system and trigger the sensor again. If the siren rings out, the registration is successful.

PCB Layout

Infrared Sensor: Detects the infrared rays released by human body motion. Do not touch the surface, keep the surface clean.

Tamper Switch: When the alarm system is armed, the tamper switch will trigger the alarm if the case is opened.

Jumper setup: Function Reserved

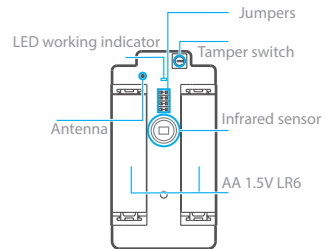

LED Indication

- Flashes Continuously: Self-Testing
- Flashes Once: An intruder is detected
- Flashes Twice: Self-testing is complete; entering operating mode
- Flashes 3 times every 3 second: Under-voltage indications, the batteries must be replaced (the user will be informed that the batteries are low).

Guidance

>Smart alarm accessories are specified at a maximum of 80 meters Line of Sight (LoS) in open air. For every obstacle the signal strength is reduced.

> Battery life depends on working and environmental factors.

For more product information please visit the ESP website
For pairing instructions, please refer to the main Hub Manual.



Elite Security Products
Redditch B98 8YN



Telephone : 01527 51 51 50

Fax: 01527 51 51 43

Email : info@espuk.com

Web : www.espuk.com

E&OE - Errors and omissions excepted.G21