

INSTRUCTIONS AND GUARANTEE



COMBIVAC™
MULTI-PURPOSE WET & DRY
VACUUM AND BLOWER SYSTEM



PLEASE READ THESE INSTRUCTIONS CAREFULLY BEFORE USE

RETAIN FOR FUTURE REFERENCE

SAFETY RULES

PLEASE READ BEFORE USE

- Do not leave appliance unattended when plugged in. Unplug from outlet when not in use and before servicing and cleaning.
 - To avoid electric shock, do not expose to rain. Store Indoors.
 - Never pick up inflammable or combustible liquids such as petrol or other volatile substances. Do not vacuum boat bilges since flammable liquids or fumes may be present.
 - Never use in the presence of explosive liquids, vapours or explosive dust - such as coal or grain.
 - Never pick up asbestos or asbestos dust.
 - Do not pick up anything that is burning or smouldering - such as cigarette ends, hot coals, matches or similar.
 - Do not allow the cleaner to be used by children.
 - Only use the product as detailed in these instructions.
 - Use only manufacturers recommended attachments and consumables.
 - Never modify the cleaner in any way - this is dangerous and will invalidate the guarantee.
 - Do not use cleaner without the filter in place.
 - If motor sound becomes higher pitched always check for the following:
 - 1) Blocked hose or accessory.
 - 2) Blocked filter.
 - 3) Full container.
 - Never try to move the cleaner by pulling with the mains lead.
 - Always check that the filter is clear and not blocked. Keep all openings clear of any blockages.
 - If the motor sound becomes a higher pitched noise then the container needs to be emptied immediately.
 - When lifting the unit always hold it with both hands under the rim of the container. Beware of excess weight.
 - Always switch the unit off before changing between vacuum and blower functions.
-

INTRODUCTION

Thank you for purchasing an Earlex CombiVac™. The uses for this product around the home, garage, workshop and garden are numerous and we hope you will find the product is in constant use. This cleaner can be used for picking up all kinds of dry material such as dust, brick dust nails, broken glass, leaves, litter, wood shavings etc. In wet mode it can pick up various types of liquid spills and help to unblock sinks. In blow mode it can be used for jobs such as collecting leaves into piles, dusting out the garage or workshop.

Due to the heavy duty nature of a wet & dry cleaner the motor may sound louder than your normal cleaner. In order to be able to pick up liquids, a special by-pass motor is fitted so that the liquid can be deposited into the recovery tank without going through the motor.

Before leaving our factory each unit has been checked to ensure that it meets our high safety, quality and performance standards.

COMPONENTS

The following components are included in the kit (as illustrated below)

WD0001	Recovery Tank	WD0036	Crevice Tool
WD0026	Extension Tubes x 2	WD0037	Floor Head
WD0029	Paper Filter	WD0045	Castors x 4
WD0030	Foam Filter	WD0048	Hose
WD0032	Rubber Band	WD0082	Motor Housing Assembly
WD0035	Hose Inlet		

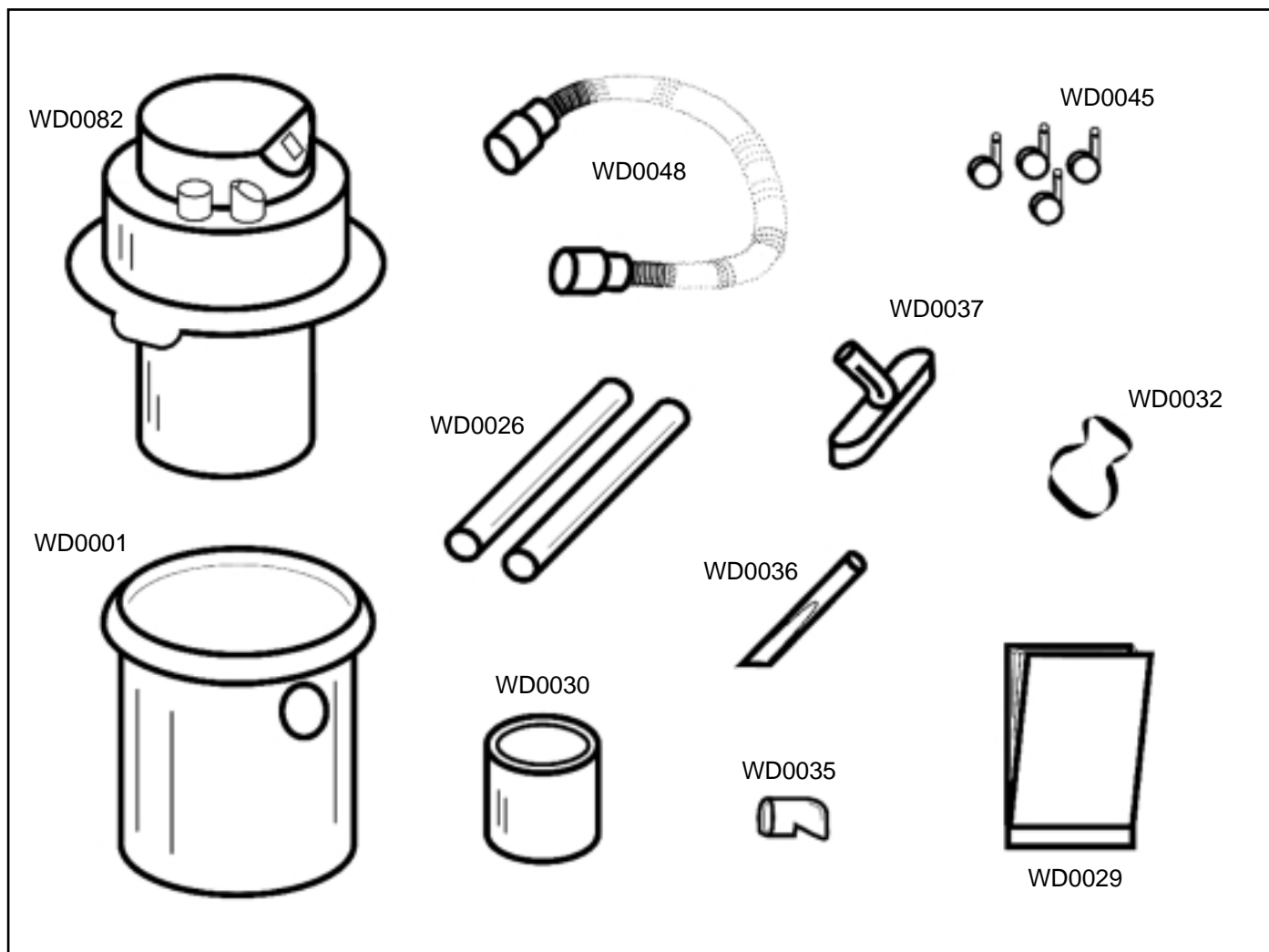

UNPACKING AND SETTING UP

- 1) Remove all packing materials and accessories and lift unit out of the box.
- 2) Release the two tank clips and lift the motor housing off from the recovery tank.
- 3) Remove all components from inside the tank.
- 4) Turn the tank upside down and insert the 4 castors. These should be pushed in hard until they stop. Once installed these remain in place permanently.
- 5) Push the Hose Inlet into the hole in the side of the Recovery Tank. The Hose Inlet must be pushed in from the outside of the Recovery Tank ensuring that the lug on the side of the Hose Inlet is lined up with the slot in the hole in the Recovery Tank. Grasp the Hose Inlet from inside the Recovery Tank and pull with an up and down motion to engage. Make sure that the clips on the top and bottom of the Hose Inlet are fixed into place inside the Recovery Tank. Once installed the Hose Inlet can remain in place permanently.

FILTER INSTALLATION

WARNING

DISCONNECT POWER SUPPLY BEFORE OPENING

CAUTION

NEVER OPERATE THIS CLEANER WITHOUT THE CORRECT FILTER FITTED

Failure to do this will invalidate the guarantee. A clean filter is essential for this cleaner to operate efficiently. If the filter becomes clogged or damaged or fails to operate you must fit an Earlex replacement. Details are supplied with the cleaner. Dry Filter Part No WD0029, Foam Filter Part No WD0030.

FILTER SYSTEM

The cleaner is supplied with 2 filters, one is made of foam and the other of paper. It is **extremely important** that you use these correctly.

DRY PICK UP

The foam filter requires to be fitted. To install this, slide the foam filter down over the float cage until it touches the top - see illustration. Treat the filter with care as you install it. The foam filter must be dry before fitting the paper filter.

Once the foam filter is installed, slide the paper bag filter over the top of the foam filter. Use the rubber band to secure the paper filter in position, making sure this fully covers the foam filter, and up to the shoulder of the moulding. A clogged filter can lead to overheating of the vacuum cleaner, periodically lightly brush down accumulated dirt build up on the paper surface with a soft brush.

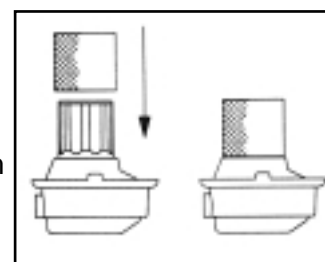

WET PICK UP

For wet pick up you only require the foam filter.

DO NOT USE THE PAPER FILTER FOR WET PICK UP. You will need to gently clean the foam filter from time to time. This should be gently washed through in warm soapy water until all traces of dirt have been removed. Then rinse through with cold water and allow to dry.

NOTE - It is essential that the foam filter is thoroughly dried before installing paper filter.

Notes

You will need to periodically replace the paper filter bag. See the leaflet on consumables.

A heavy duty combined wet and dry cartridge filter is available as an optional extra. This can be permanently fitted and saves having to change filters for different uses.

The cleaner does not collect dry matter into the paper bag filter. This is collected in the main recovery tank. The paper bag is a filter to stop the dust from entering the motor.

NEVER OPERATE THIS CLEANER WITHOUT THE CORRECT FILTERS IN PLACE.

ASSEMBLING THE HOSE

The hose has a swivel connector fitted to one end and an extension tube connector to the other. When using the vacuum facility fit the swivel connector into the inlet in the side of the recovery tank (see illustration).

Fit one of the extension tubes into the other end of the hose, making sure you slide this on as far as possible. If required the second extension tube can now be added and either the floor head or the crevice tool fitted into the end. The cleaner can be used without either of these tools if required.

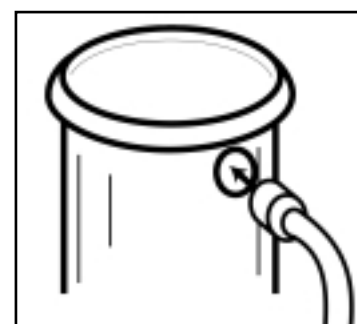

OPERATION

- 1) Ensure that the motor housing has been clipped onto the base in the correct position, with the air outlet opposite the vacuum inlet hose. Failure to observe this will allow the filter to foul the internal inlet pipe.
- 2) Unwind the mains lead fully and connect to the mains or extension lead.
- 3) Switch unit on.
- 4) Operate as required.
Beware of discharged air from the outlet on the motor housing.

FLOAT SHUT OFF

The cleaner is protected by an automatic shut-off float valve when it becomes full of liquid. This will become apparent to you as the motor will start to make a high pitched noise. If this happens:

- 1) Switch the unit off.
 - 2) Disconnect from the mains.
 - 3) Lift the hose up to drain any excess liquid back into the container.
 - 4) Empty the contents of the tank.
 - 5) Try to keep the hose raised whilst emptying out the liquid, this can help eliminate any spills.
- WARNING - BE CAREFUL WHEN EMPTYING THE TANK - IT MAY BE HEAVIER THAN YOU THINK.**

Important

The float valve is a safety device, do not attempt to remove this or modify it, it is there for your safety.

Should the cleaner overturn during use, switch the unit off immediately, return to the upright position and wait until the float valve has repositioned itself.

If collecting soapy water you will need to regularly check whether the unit requires emptying as the lather can bypass the float system and there can be a discharge of foam! Should this occur switch off the unit, wash out any foam in the filter and tip away any water around the outlet on the motor housing, before restarting.

EMPTYING TANK

WARNING - TAKE CARE, THE TANK MAY BE HEAVIER THAN YOU THINK.

- 1) Switch off the unit and unplug from the socket.
- 2) Unclip the motor housing from the recovery tank.
- 3) Empty tank of all contents - making sure that you are protected against any sharp objects. Beware of excess weight.
- 4) Clean filters (change if necessary).
- 5) Check and clean any blockages within the unit.
- 6) Replace motor housing, plug in and continue as before.

BLOWER FUNCTION

- 1) The CombiVac™ can be used as a powerful blower by inserting the hose into the outlet on the motor housing.
- 2) Always ensure that the hose, tank and accessories have been cleaned of any debris before operating the blower function.
- 3) You should always protect your eyes with safety goggles when using this function and ensure that no one else is in close proximity.
- 4) The paper bag filter is not required when using the blower.
- 5) Uses include: blowing leaves into piles, blowing out dust from difficult to get to areas, faster drying of paint.

Note - Always switch the unit off before changing between vacuum and blower functions.

STORAGE

- 1) Clean out the container and wipe the surface of the unit over with a damp cloth.
- 2) Wrap the mains lead around the upper moulding as shown in illustration and clip plug to lead.
- 3) Locate the 2 extension tubes onto the taller posts on the cleaner top with the nozzle tool and floor head on the lower angled posts.

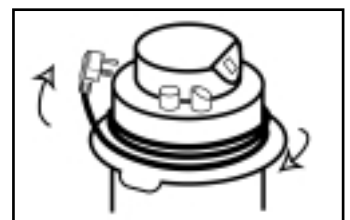

TROUBLE SHOOTING

IF A PROBLEM OCCURS ALWAYS SWITCH THE UNIT OFF IMMEDIATELY

Motor does not operate.	Check unit is plugged in and switched on. Check fuse in plug - replace only with a fuse of the same rating - 13amps. If using extension lead check the fuse in this lead.
Motor operates but cleaner fails to pick up.	Check if the cleaner needs emptying. Check and clear any blockages within the system. Check that both foam and paper filters are clean and not damaged.
Motor makes high pitched noise.	Check if cleaner needs emptying and the float valve has operated.
Dust/grit blowing from outlet.	Check filter is correctly fitted, if heavy duty filter is used check that it is fully pushed into position.

Maintenance

After wet pick up empty, rinse and dry the recovery tank, hose and accessories. If vacuuming/collecting sticky spills, clean the tank and accessories with warm, soapy water.

Periodically replace the paper filter. Wash dirt from the foam filter using soapy water. This will improve it's performance. Thoroughly dry before installing paper filter.

Do not oil the motor. It is lubricated for life.

There are no serviceable parts inside the cleaner apart from the filters.

AFTER SALES SERVICE

A range of accessories together with all spare parts are available from our service department who will furnish details for you.

IF YOU REQUIRE FURTHER ASSISTANCE THEN PLEASE CONTACT OUR HELPLINE ON

Tel: 01483 454666 Fax: 01483 454548 email:enquiries@earlex.co.uk

Opening Hours: Monday-Thursday 08.30-18.00 Friday 08.30-17.00

GUARANTEE

This product is guaranteed for a period of two (2) years against faulty materials and workmanship. The guarantee specifically excludes the use for hire or rental purposes.

Whilst every possible care is taken by Earlex to ensure that our products leave the factory in good working order, Earlex cannot under any circumstances accept liability for problems or damage caused by their subsequent use. Any unit that has been modified in any way or used on incorrect voltage will not be covered by guarantee. Consumables such as filters are not covered by guarantee.

This guarantee does not affect your statutory rights.

In the event of a fault occurring please contact our helpline before returning the unit to our Service Department at the address below together with a copy of your purchase receipt. All repairs will be dealt with speedily.

EC Declaration of Conformity

We declare that the unit: WD1000 conforms to: 73/23/EEC, EN60335-1 & 2-2-1995 & 89/336/EEC, EN55014, EN55104



Tim Hopper Technical Director

ACCESSORIES AND SPARE PARTS

A range of spare parts are available for the CombiVac™. To order please contact our helpline on 01483 454666. Opening Hours: **Monday-Thursday** 08.30-18.00 **Friday** 08.30-17.00

WDACC2 - Deluxe Floor Head with hard floor, brush and squeegee attachments. Wider head for greater coverage, suitable for carpets and faster pickup of debris and spills.

WDACC10 - Pack of three spare foam filters.

WDACC11 - Pack of three spare paper filters.

WDACC12 - Power Tool Adapter.

WDACC13 - Combined Wet & Dry Filter no need for foam filter or paper filter and no need to change between filters for dry or wet pickup.

WDACC14 - Wide Bore Tool Kit for larger debris such as rubble and leaves.

WDACC15 - Mini Cleaning Set - ideal for cleaning/blowing computers, video recorders, air vents in cars.

WDACC16 - Sink Deblocker - clears blockages from sinks, baths and showers.

MAINS CONNECTION

This unit is a Class II appliance which means it is double insulated for your protection, no earthing wire is necessary.

If the supply cord is damaged, it must be replaced by a special assembly available from Earlex Ltd or our appointed agents.

The replacement supply cord is Part No. WD0033.

Your unit has been supplied with a mains lead with a fitted plug. This is identified by the fuse holder in the base of the plug. Please read the following safety instructions before use.

1. If the fitted plug is cut off from the mains lead then the plug must be disposed of safely.
NEVER under any circumstances insert such a plug into a 13amp socket.
2. **NEVER** under any circumstances use the appliance or mains lead without the fuse cover fitted.
This is the little cover fixed into the base of the plug to hold the fuse in place.
3. If you lose the fuse cover then please contact any electrical dealer for a replacement or ring our helpline.
4. A replacement fuse must be rated at 13amp. These must be manufactured and approved to BS 1362.
5. **IF IN ANY DOUBT CONTACT AN ELECTRICIAN.**

If you need to fit a plug to the mains lead, this should be fitted in accordance with the wiring instructions below, and will need to be used with a 13amp fuse. If in doubt consult an electrician.

If you are using an extension lead it must be rated at a minimum of 6amps and fully unwound. Do not operate with a lead rated at less than 6amps as this will cause premature failure of the motor which is not covered by the guarantee.

As the colours of the wires in the mains lead of the application may not correspond with the coloured markings identifying the terminals in your plug, proceed as follows:

The wire which is coloured blue must be connected to the terminal which is marked with the letter N or coloured black.

The wire which is coloured brown must be connected to the terminal which is marked with the letter L or coloured red.

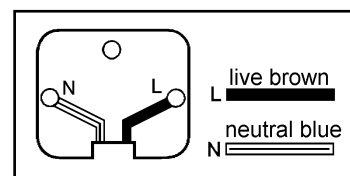

OTHER PRODUCTS FROM EARLEX

Earlex also manufacture a wide range of steam wallpaper strippers and other decorative power tools to help in your DIY efforts.

STEAM WALLPAPER STRIPPERS

Designed to remove all types of wallpaper, multi-layered painted papers and Artex®.

SS100 Super Steamer - 2300W 4.5 ltr steam wallpaper stripper.

SS50 Warrior - 2000W 4.5 ltr steam wallpaper stripper.

A range of steam cleaning accessories is also available to be used in conjunction with the steam wallpaper strippers. The accessories can be used to clean and rejuvenate carpets, floor tiles, unblock sinks or waste outlets, clean work surfaces, defrost fridges and freezers, clean windows and tiles, remove soiling from upholstery and curtains.

Alternatively the **Combi-Steam** combines the versatility of the steam wallpaper stripper with a selected range of accessories providing you with a complete steam cleaning kit and wallpaper stripper.

SC165 - 1500W 4.5 ltr steam cleaning kit, including carpet cleaner, window/tile cleaner, jet nozzle cleaner, upholstery cleaner/ small steam plate, large wallpaper stripping plate.

PR9 Autofeed® Cordless Painting System - Portable battery operated paint rolling system. It has a 3 litre paint reservoir and 23cm (9") roller and automatically feeds paint to the roller head.

Easy to use the PR9 provides enough capacity to apply one coat to a 3.6m x 2.7m (12' x 9') room without having to refill.

PRA1 1.4m Extension Pole - Used in conjunction with the PR9 the PRA1 allows you to paint ceilings and high areas without the use of step ladders or having to move furniture.

SG45 Super Sprayer 45 - 45W Electric Airless Spray Gun, ideal for spraying wood preservatives, water & solvent based paints, enamels, varnishes and wood stains.

SG75 Super Sprayer 75 - 85W Electric Airless Spray Gun. The motor size and larger additional nozzle (0.8mm) allows thicker viscosity liquids such as emulsions, latex, lacquers and impregnating agents to be sprayed. Includes a flexible extension nozzle that is ideal for spraying overhead and at different angles. Supplied with 2 nozzle sizes and a spares kit.

SG85 Super Sprayer 85 - 85W Electric Airless Spray Gun. The SG85 is a heavy duty spray gun designed for the semi-professional/tradesman. It has a tungsten carbide piston and a die-cast aluminium head, which allows the product to deal with abrasive materials such as exterior wall paints (non-grit), latex, pottery glazes and similar materials that may be sprayed. Includes a flexible extension nozzle that is ideal for spraying overhead and at different angles, and a suction tube/cup attachment that clips onto the paint can, so that there is no need to keep refilling the paint container. Supplied with 2 nozzle sizes and a spares kit.

HG1600K - Heat Gun Kit. The Earlex Heat Gun Kit offers a 1600 Watt heat gun in a strong carry case and includes a range of useful accessories. With two heat settings the heat gun can be set at 400°C or 590°C. It is provided with a selection of four nozzles, three shavehooks and a scraper to suit different tasks and it all stores away conveniently in the carry case.



Earlex Ltd., Moorfield Road, Slyfield Industrial Estate, Guildford, Surrey. GU1 1RU.

Tel: +44 (0) 1483 454666. Fax: +44 (0) 1483 454548.

email: enquiries@earlex.co.uk