

Instruction on mounting and use

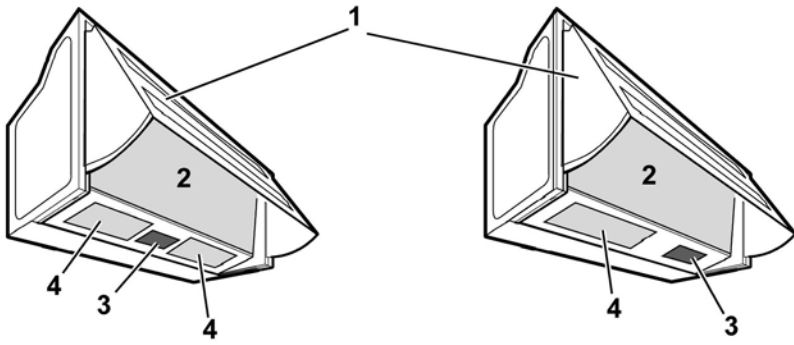

Fig. 1

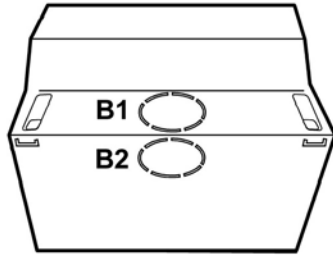

Fig. 2

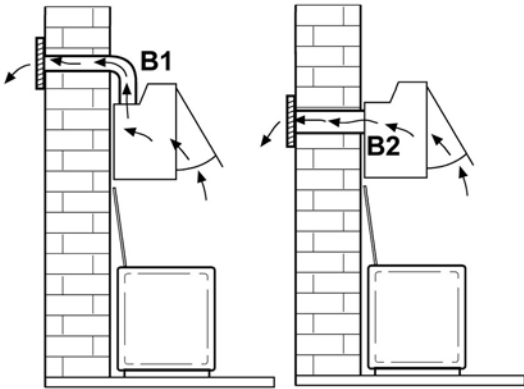

Fig. 2.1

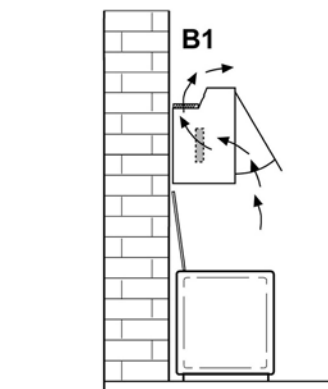

Fig. 2.2

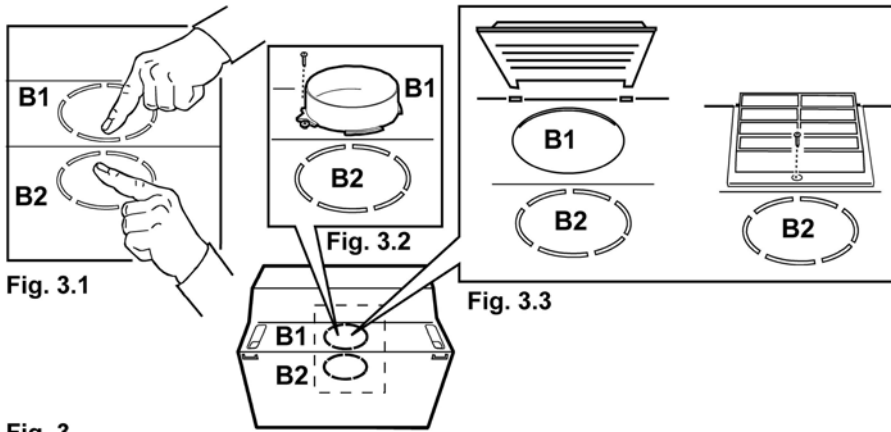

Fig. 3

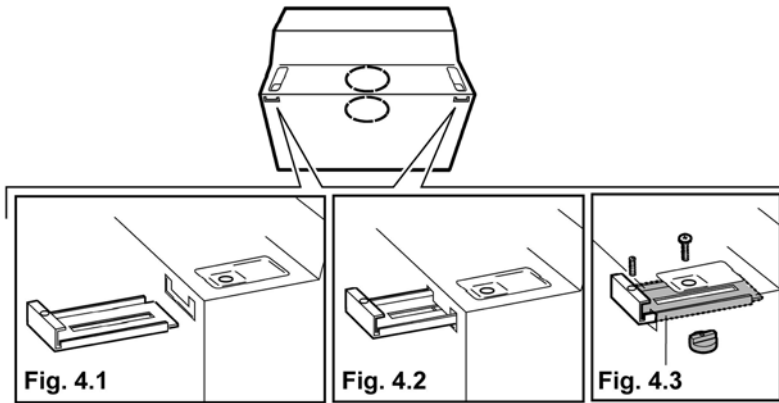
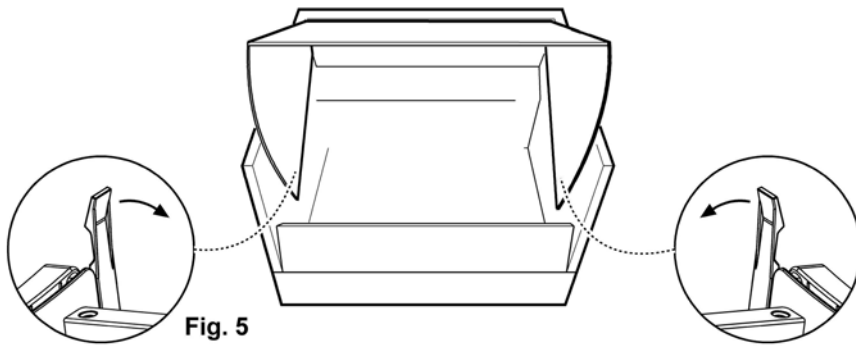

Fig. 4



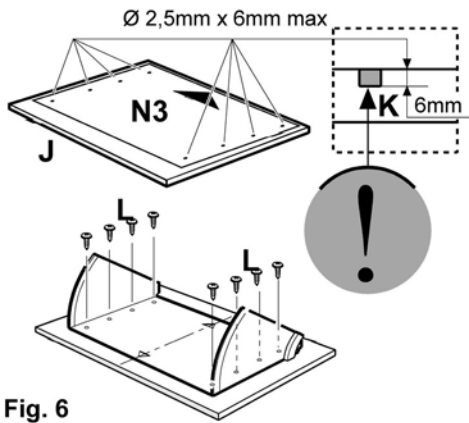

Fig. 6

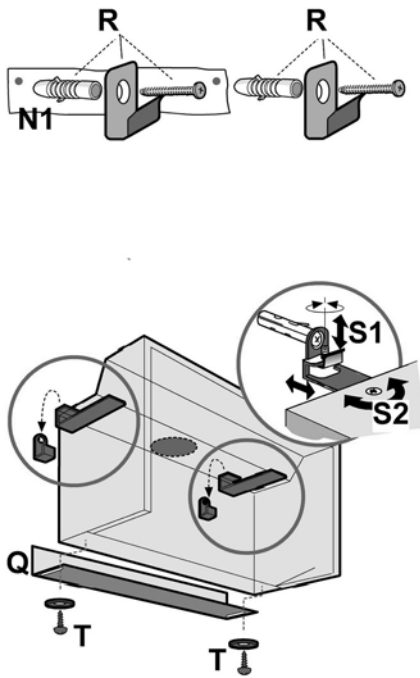
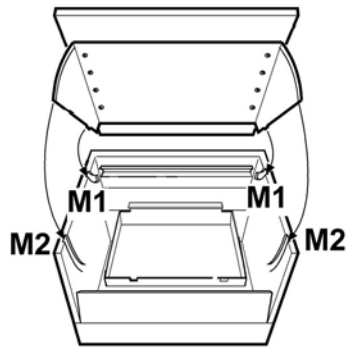

Fig. 7

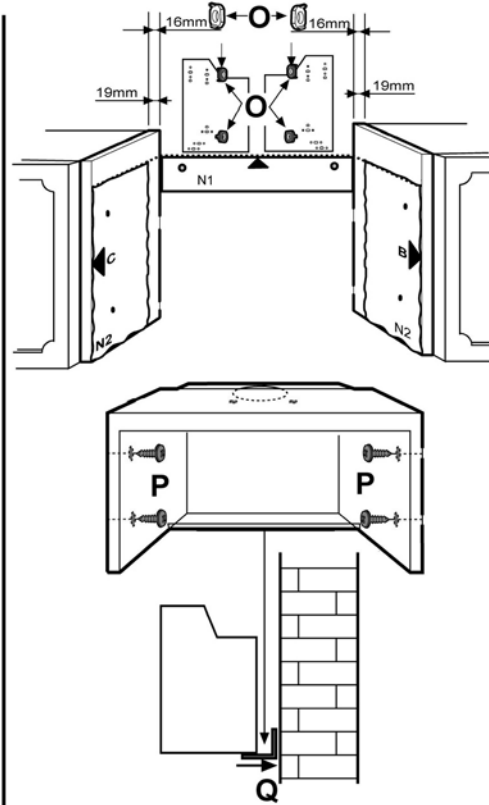

Fig. 8

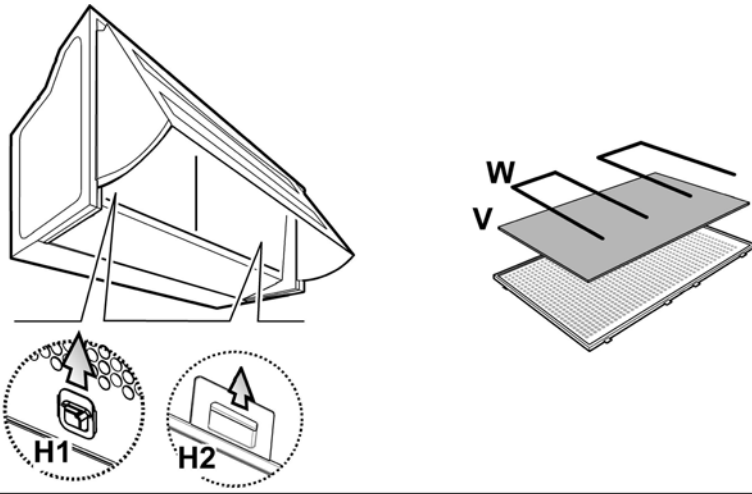

Fig. 9

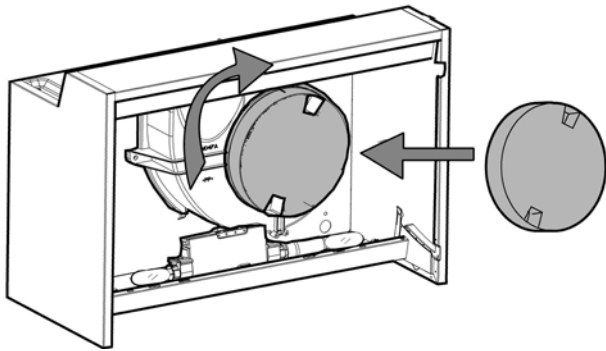

Fig. 10

Instruction on mounting and use

Consult the designs in the front pages referenced in the text by alphabet letters. **Closely follow the instructions set out in this manual.** All responsibility, for any eventual inconveniences, damages or fires caused by not complying with the instructions in this manual, is declined.

Suction Cooker hood Description - Fig. 1- various models

1. Vapour collector
2. Suction grill
3. Controls
4. Light point

Use

The hood is designed to be utilized either for suction version at external evacuation or filtering version at internal recirculation.

Note: the elements marked with the symbol “(*)” are optional accessories supplied only with some models or elements to purchase, not supplied.

Ducting version

The hood is equipped with a top air outlet **B1** and with a back air outlet **B2** for discharge of fumes to the outside (exhaust pipe and pipe fixing clamps not provided). **Fig. 2.1**

Filtering version

In the case where it is not possible to discharge the cooking fumes and steam outside, the hood can be used in the **filtering version**, mounting 1 or 2 active carbon filters (*).

The fumes and steam are recycled into the kitchen. **Fig. 2.2**

The models with no suction motor only operate in ducting mode, and must be connected to an external suction device (not supplied).

Installation

The minimum distance between the supporting surface for the cooking vessels on the hob and the lowest part of the range hood must be not less than 50cm from electric cookers and 65cm from gas or mixed cookers. If the instructions for installation for the gas hob specify a greater distance, this must be adhered to.

Electrical connection

The electrical tension must correspond to the tension noted on the label placed inside the cooker hood. Connect the electrical plug, where provided, to the an easily accessible outlet in conformity with local standards in force. Where an electrical plug is not provided (*for direct connection to electrical network*) place a standards

approved bipolar switch with an aperture distance of not less than 3mm (*accessible*) from the contacts.

Attention: substituting the supply cable must be carried out by the authorised technical assistance service.

Mounting

Expansion wall plugs are provided to secure the hood to most types of walls/ceilings. However, a qualified technician must verify suitability of the materials in accordance with the type of wall/ceiling. The wall/ceiling must be strong enough to take the weight of the hood. **Do not tile, grout or silicone this appliance to the wall. Surface mounting only.**

Before beginning installation:

- Remove the fats filter/s or the suction grill/s (depending on the model in possession –see also the relative paragraph). This/these is/are to be mounted once installation is completed.
- Remove the active carbon (*) filter/s if supplied (see also relative paragraph). This/these is/are to be mounted only if you want to use the hood in the filtering version.
- Check (for transport reasons) that there is no other supplied material inside the hood (e.g. packets with screws (*), guarantees (*), etc.), eventually removing them and keeping them.
- In addition check whether near the installation area of the hood (in the area accessible also with the hood mounted) an electric socket is available and it is possible to connect a fumes discharge device to the outside (only suction version).
- **Choose the discharge outlet to use:**
Only filtering version: use ONLY the upper **B1 outlet (Fig. 2 - Fig. 2.2)**. Check that this, once installation is completed, is not obstructed and that there is sufficient space so that the purified fumes and steam can return easily into the kitchen.
Press with decision (Fig. 3.1) to take away the pre-fractured part (**B1** o **B2**) that closes the discharge outlet and remove it.
Install the connection ring on the open discharge outlet (**Fig. 3.2** bayonet embedded) or the deflector (*). (**Fig. 3.3**).

Check that the lateral wall units between which to install the hood are sufficiently robust for installing the hood.

Otherwise mount the hooking brackets on the wall (*) to use as additional supports:

- a. Insert each bracket from the rear inside the hood through the apposite slots (**Fig. 4.1—Fig. 4.2**).
- b. Fix the brackets with the screws and threaded bushes (**Fig. 4.3**).
Screw the headless screws halfway. They will serve to adjust the position of the hood at the moment of installation.

Note: the position of the brackets can be adjusted during installation, suitably loosening and retightening the screws that fix them to the hood. (Fig. 7 - S1-S2).

Installing the aesthetic panel (*)

- Extract the steam collector (freeing it from the blocking hooks - Fig. 5).
- Put perforation diagram N3 on the REAR of aesthetic panel J (the arrow on the diagram turned upward towards the UPPER EDGE of the aesthetic panel). Fig. 6
- Make BLIND HOLES K as indicated. Fig. 6
- Put the steam collector over the aesthetic panel and fix it with 8 screws L. Fig. 6
- Remount the door on the hood, first on upper guides M1, then on the lower M2. Fig. 6
- Close completely and re-open the door to check its correct sliding on the guides.

Installation

- Use perforation diagram N2 (*). Position the diagram on the front edges of the wall unit (right wall unit, B side) – (left wall unit, C side) WITHOUT CONSIDERING THE THICKNESS OF THE DOORS, and make the holes as indicated. Fig. 8
- If necessary, fix the hood to the wall, putting template N1 (*) on the wall so its upper edge coincides with the upper edge of template N2. Fig. 7-8
- Make the holes as indicated. Fix 2 hooks (*) R to the wall with screws and dowels. Fig. 7
- In case the thickness of the lateral wall units is 16mm, put, with embedded fixing, the O (*) spacers at the sides of the hood in correspondence with the holes used for the passage of the fixing screws to the lateral wall units. Fig. 8.
- Hang the hood onto the hooks (*) and adjust the position of the hood with headless screws S1 and adjusting the position of the hooking brackets with screws S2. Fig. 7
- Fix the hood to the lateral wall units with 4 screws P. Fig. 8
- Mount the lower corner Q (*) to the hood with two screws and plastic washers T. They will serve to cover possible spaces between the rear of the hood and the wall. Fig. 7

Operation

Use the high suction speed in cases of concentrated kitchen vapours. It is recommended that the cooker hood suction is switched on for 5 minutes prior to cooking and to leave in operation during cooking and for another 15 minutes approximately after terminating cooking.

Use the keys or buttons envisaged for the control of the lights and the power of the available suction.

Only in some models: switching on and off the fan that adjusts the suction power and, in some cases, switching

the lights on and off, is controlled by opening and closing the steam collector.

Maintenance

Prior to any maintenance operation ensure that the cooker hood is disconnected from the power supply.

Cleaning

The cooker hood should be cleaned regularly internally and externally. Clean using the cloth dampened with neutral liquid detergent. Do not use abrasive products.

DO NOT USE ALCOHOL!

Warning: Failure to carry out the basic standards of the cleaning of the cooker hood and replacement of the filters may cause fire risks.

Therefore we recommend observing these instructions.

Grease filter

Traps cooking grease particles.

If situated inside the support grill, it may be one of the following types:

Paper filter must be replaced once a month or if colouring appears on upper side, in such cases the colouring is evident through the grill openings.

Sponge filter should be washed with hot soapy water once a month and replaced every 5 to 6 washes.

Metallic filter must be cleaned once a month, with non abrasive detergents, by hand or in dishwasher on low temperature and short cycle.

When washed in a dishwasher, the grease filter may discolour slightly, but this does not affect its filtering capacity.

To access fats filter V, open the suction grill with hooks H1 or H2 (depending on the model in possession) and free it from the W stops. Fig. 9

Some models are provided with anti-grease filter incorporated in the suction grill, these should be removed from the housing by pulling the handles H2 (Fig. 9) upwards and sliding out, wash these filters as with metallic filters.

Charcoal filter (filter version only)

It absorbs unpleasant odours caused by cooking.

The saturation of the activated charcoal occurs after more or less prolonged use, depending on the type of cooking and the regularity of cleaning of the grease filter.

In any case it is necessary to replace the cartridge at least every four months.

Cover the grill that protects the suction motor with the carbon filter so that the slots on the filter correspond to the pins on the sides of the motor protection grill.

Turn the carbon filter clockwise to block them (bayonet fixing). Fig. 10

Proceed in reverse for mounting.

Note: 2 filters are needed in the models with 2 motors. The system of montage and dismantling is identical.

Replacing lamps

Disconnect the hood from the electricity.

Warning! Prior to touching the light bulbs ensure they are cooled down.

Remove the suction grill to access the lamp area.

Remove the damaged lightbulb and replace with an oval incandescent lightbulb max. 40W E14.

If the lights do not work, make sure that the lamps are fitted properly into their housings before you call for technical assistance.

Caution

Never use the hood without the grill mounted!

This appliance is designed to be operated by adults. Children should not be allowed to tamper with the controls or play with the appliance .

The premises must have sufficient ventilation when the kitchen hood is used at the same time as other apparatuses that use gas and other fuels.

The sucked air must not be conveyed in a conduit used for discharging fumes produced by apparatuses fuelled by gas or other fuels.

Cooking food on the flame under the hood is severely prohibited.

The use of open flame damages the filters and can cause a fire; it must therefore be avoided in any case.

Frying must be carried out under control in order to prevent overheated oil catching fire.

Keep strictly to the regulations envisaged by the competent local authority as far as the technical and

safety measures to adopt for discharging fumes are concerned.

The hood is to be cleaned frequently both internally and externally.

Failure to observe the regulations about cleaning the hood and substituting and cleaning the filters can lead to the risk of fire.

Any responsibility is declined for possible inconveniences, damage or fire caused to the apparatus deriving from failure to observe the instructions shown in this manual.

This appliance is marked according to the European directive 2002/96/EC on Waste Electrical and Electronic Equipment (WEEE). By ensuring this product is disposed of correctly, you will help prevent potential negative consequences for the environment and human health, which could otherwise be caused by inappropriate waste handling of this product.



The symbol  on the product, or on the documents accompanying the product, indicates that this appliance may not be treated as household waste. Instead it shall be handed over to the applicable collection point for the recycling of electrical and electronic equipment. Disposal must be carried out in accordance with local environmental regulations for waste disposal.

For more detailed information about treatment, recovery and recycling of this product, please contact your local city office, your household waste disposal service or the shop where you purchased the product.