

760

Concealed operating
specification
for
ornate gate
designs



Swing Gate Systems



Simply the world's best welcome. And that's a FAAC[®].

760

Concealed operating specification

760 - Invisible for Style

Why spoil the look of a set of ornate or antique gates? Installed underground the 760 system is the ideal compliment to even the most intricate gate styles.

760 - Maximum Security and Safety

Our exclusive hydraulic lock systems combine exceptional anti-intrusion security whilst ensuring the maximum anti-crushing safety, with simple manual override facilities in any emergency. The combined pump and drive unit is also equipped with hydraulic slowdown at the end of the opening or closing cycle.

760 - High Power and Quiet Efficiency

The 760 range is designed for gates up to 800kg, with hydraulic systems that offer super quiet operation with the added benefits of low electricity consumption. Enhanced with total water and corrosion proofing the 760 system is reliable under all atmospheric conditions, and at extreme temperatures from -20°C to +55°C.

FAAC - Simply the world's best welcome

World leaders for over 30 years, FAAC offer total reassurance of the highest quality gate operating systems backed with a national network of qualified installers. Each of our systems is designed to meet the on-going demands of usage with the highest level of reliability and the minimum maintenance support.

INSTALLATION LAYOUT

- A. 760 hydraulic operator
- B. 450MPS or 460P control board
- C. Access control device
- D. Radio receiver
- E. FAAC LAMP or MINILAMP
- F. Photocells: Flush mounting FOTOSWITCH, external PHOTOBAM/SAFEBEAM
- G. Power cable junction box



FAAC[®]

Simply the world's best welcome. And that's a FAAC.

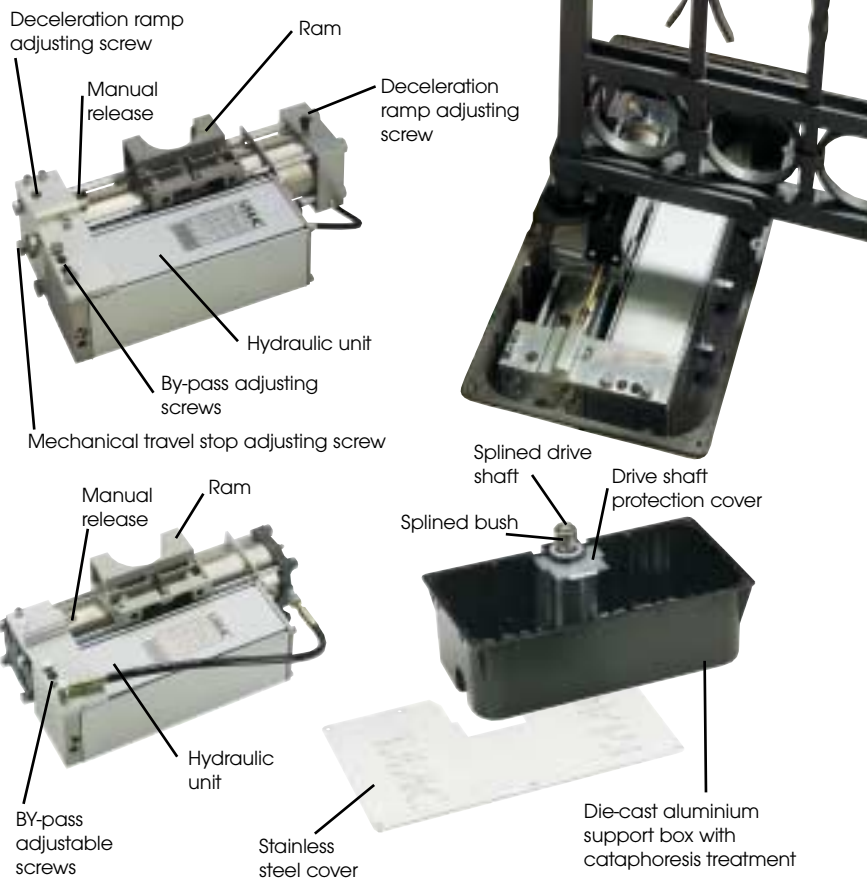

CONTROL BOARDS



450 MPS Technical Specifications

Power supply
230 V ~ (+6% - 10%) 50 Hz
Absorbed power: 10 W
Max. motor load: 800 W
Max. accessories load: 0.5 A
Max. electric lock load: 12 VA
Temperature range: -20°C - +55°C
Fuses
Motors power supply/Accessories power supply/Logic power supply
Operations logics
Automatic/Semi-automatic/Safety/Dead-man button/Step-by-step semi-automatic



460 P Technical Specifications

Programmable control board using FAAC TOTUM programmer, featuring slowdown, cycle counter and diagnostics.
Power supply
230 V ~ (+6% - 10%) 50 Hz
Absorbed power: 35 W
Max. motor load: 800 W
Max. accessories load: 0.5 A
Accessories
MEL 1 Single electric lock control module
MEL 2 Double electric lock control module
ME I Input expansion module
Gatecoder: Tracking device providing anti-crushing facility.
Temperature range: -20°C - +55°C
Fuses
Motors power supply/Accessories power supply/Logic power supply.
Operations logics
Automatic/Semi-automatic/Safety/Dead-man button/Step-by-step semi-automatic.

TECHNICAL SPECIFICATION

Power supply	230 V ~ (+6% - 10%) - 50 Hz
Absorbed power	220W
Current drawn	1A
Motor speed	1400 rpm
Pump delivery	0.75 - 1-1.5 l/min
Gate weight	0 to 800 kg
Duty cycle	90 cycles/hour
Operating temp. range	-20°C + 70°C
Motor winding thermal cutout	-120°C
Oil Type	FAAC oil XD220

FAAC (UK) Ltd. Old Brick Kiln, Ramsdell, Tadley, Hampshire RG26 5PR.
Telephone: 01256 851515 Facsimile: 01256 851525 E-mail: sales@faac.co.uk
Website: www.faac.co.uk