

# D600 - D1000

For spring, counterbalanced up-and-over doors and sectional doors for residential (D600) and light commercial use (D1000)



## Characteristics:

- Patented fast and tool-less head-rail mounting
- Backup battery can be fitted inside the head
- OMNIDEC
- Double isolation (no earth wiring required)
- Easy installation and programming
- Impact forces complying EN 12453-12445 (photocells are not required)

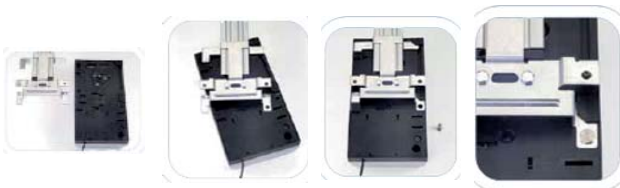

Installation of the automated system on the rail WITHOUT ANY TOOLS with rotation coupling



## Versatility

The D600 and D1000 operators are electromechanical devices using 24 Vdc motors, that can be used in sectional, spring balanced and, with the proper adaptor, in counter-weighted garage doors.

## Quick and easy to install

The nylon base makes the operator lighter and with better handling compared to metal. The material is nylon 6.6, 30% glass-charged. FAAC has developed a patented head-rail connection. The operator can be mounted on the rail support without installation tools, a simple rotation to engage 4 supports of the plate and a pin to prevent unfastening. Installation time has been reduced by 40% on previous models.

## Maximum safety

*The electronic anti-crushing device adjusts itself automatically at Set Up. the operator keeps the tripping threshold constantly at minimum level, and adapts at all times to the differences in force required to move the door The device stops the door movement as it stops and reverses it at closing.*

## Electronic speed control

*to protect the door against mechanical stress as the movement begins, an electronic control gradually increases the speed of the operator (Soft Start). Deceleration, both at opening end phase and closing (Soft Stop), prevents the door reaching the mechanical stops in a damaging, noisy way.*

## Anti-break-in non-reversing facility

*Break-in protection is guaranteed by the non-reversing gearmotor, which thus does avoids installation for electrical locks or bolts. If a power cut occurs, a patented "bi-stable device", activated from the inside, facilitates manual operation and prevents spontaneous, unwanted, restoring of the automated system. By using appropriate accessories, you can release the device from the outside either with a customised key or by using the door handle.*

POWER CABLING (230V)

**A{** 1 cable 2 x 1.5+T

NB: cable diameters in mm<sup>2</sup>

Sales Orderline: 01256 318100

Sales Faxline: 01256 318101