

GB

Evo Home & Garden Kit

Instructions

– Please retain these instructions for future reference

Pack contents:

- 50m* Plug-in Chime
- 200m* Portable Chime
- Bell push with CR2032 Lithium coin cell battery
- Adhesive pad, 2 x screws (ø3x20mm) 2 x wall plugs (ø5x25mm) for mounting the bell push

You will require:

- 3 x LR6 (AA) alkaline batteries for the Portable Door Chime
Only long-life alkaline batteries must be used
- A small crosshead and flathead screwdriver, a ø5 masonry drill

Installation

***Please note:** The stated range of this product is measured in open field conditions. Walls, ceilings and the positioning the bell push or door chime on or near metal structures or reinforced PVC doors or doorframes will reduce the transmission range.

1. Open the bell push

To open the front cover carefully insert a flat bladed screw driver, into the slot and twist gently (A). When refitting the front cover to ensure the weather proofing is maintained, always mount the bell push in the upright position and replace the cover securely. Fig. 1

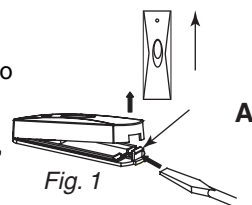

Fig. 1

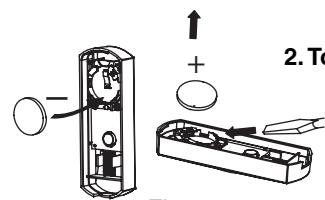

Fig. 2

2. To fit or replace the battery

Open the front cover and insert the CR 2032 Lithium coin cell battery into the cover as shown in Fig. 2.

3. Mount the bell push

Ensure the wall surface is clean and dry. Mount using either the double sided sticky pad on a smooth surface, or the screws and wall plugs provided, See Fig. 3. Do not mount the push on or near (< 30cm) large metal objects, as it will block signals from the push.

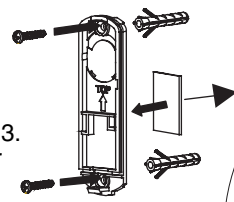

Fig. 3

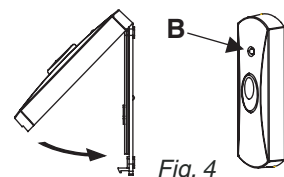

Fig. 4

4. Test the bell push
When the bell push button is pressed, the confidence light (B) in Fig. 4, will illuminate to reassure the caller that the bell push is working.

The light will flash 5 times when the battery needs replacing.

200m* Door chime

5. Fit the Door chime batteries

Remove battery compartment cover and insert three LR6 (AA) alkaline batteries as shown in Fig. 5.

The first time a chime unit is powered up, the sounds available are demonstrated.

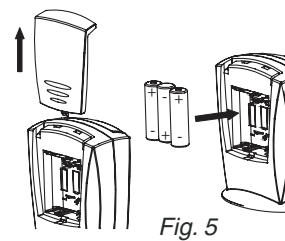

Fig. 5

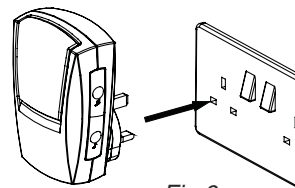

Fig 6

50m* Plug-in Door chime

Plug the chime into any 220-240V BS 1363 socket, as shown in Fig. 6. installed in a clean dry environment, situated within transmission range of the bell push.

6. Automatic Programming of bell pushes

First, place the chime close to the door push (within 8m/ 25ft) to program the chime and check that it is working. Press the door push until the chime responds with a tune. You can leave this tune or change the tune by using button A (see Fig. 5, sound selection).

7. Programming a second push

Within 5 minutes of pressing the first push, press the second push until the chime sounds, then use button B to change the tune if required. If more than 5 minutes has elapsed since the first push was programmed, press and hold both buttons A and B until the chime sounds, this takes approx 5 seconds. The chime is now cleared and can be programmed to one or two door pushes. All EVO and Décor Chimes and Bell Pushes use programming to ensure no interaction from other neighbouring systems.

Declaration

Novar ED&S hereby declares that this wirefree product is in compliance with the essential requirements and other relevant provisions of the Radio and Telecommunications Terminal Equipment (R & TTE) directive, 1999/5/EC

8. Sound Selection

A = Main push sound selection
B = Second push sound selection

Chime tune options are as follows:

200m Chime Sound Variety:

1. Big Ben 2 Note (Default Tune for 1st Push)
2. Mini Bell 4 Note w/ Echo (Default Tune for 2nd Push)
3. Clarinet
4. Altosax

50m Plug-in Chime Sound Variety:

1. Tone Bar 2 Note (Default Tune for 1st Push)
2. Bass clarinet (Default Tune for 2nd Push)



Fig. 7

9. Replacing Batteries

First remove decorative cover and replace with three LR6 (AA) alkaline batteries. (Fig. 5) When replacing batteries the chime is still programmed and can be used straight away.

Trouble Shooting

Chime not Sounding

Batteries may not be inserted correctly

Check all batteries have been inserted correctly

Chime may be positioned out of range of the bell push

Move your chime closer to the bell push

Note: During the programming cycle the transmission range may be reduced.

The chime will resume optimum range after 5 minutes

A metallic object may be blocking the signal from bell push position

Experiment with the location of the chime to see if you can move it in a more suitable place

The battery in the bell push may need replacing

Press the bell push. If the confidence light (B) flashes 5 times after being pushed, replace the battery

Note: In cold conditions, poor location or environment, operating at maximum range it is advisable to replace the battery more frequently before the indicator light flashes (i.e every 12 - 18 months) to maintain optimum performance

Your bell push and chime haven't been programmed

Do the automatic programming of your chime and bell push

Friedland guarantees this product for 3 years from date of purchase. Proof of purchase is required, this does not affect your statutory rights. If you require further information about our products, call the Friedland helpline on 01268 563066.

Friedland, The Arnold Centre, Paycocke Road, Basildon, Essex, SS14 3EA, England www.friedland.co.uk

