

DT8012F4 / DT8012F5 DUAL TEC® Motion Sensor – Installation Instructions

QUICK LINKS

[Mounting Location Guidelines](#)

[Open the Sensor](#)

[Mount the Sensor](#)

[Sensor Components and Settings](#)

[Wire the Sensor](#)

[Walk Test the Sensor](#)

[Detection Patterns](#)

[Relay Operation](#)

[Troubleshooting](#)

[Sensor Specifications](#)

[Accessories](#)

[Approval Listings](#)

1 SELECT THE MOUNTING LOCATION

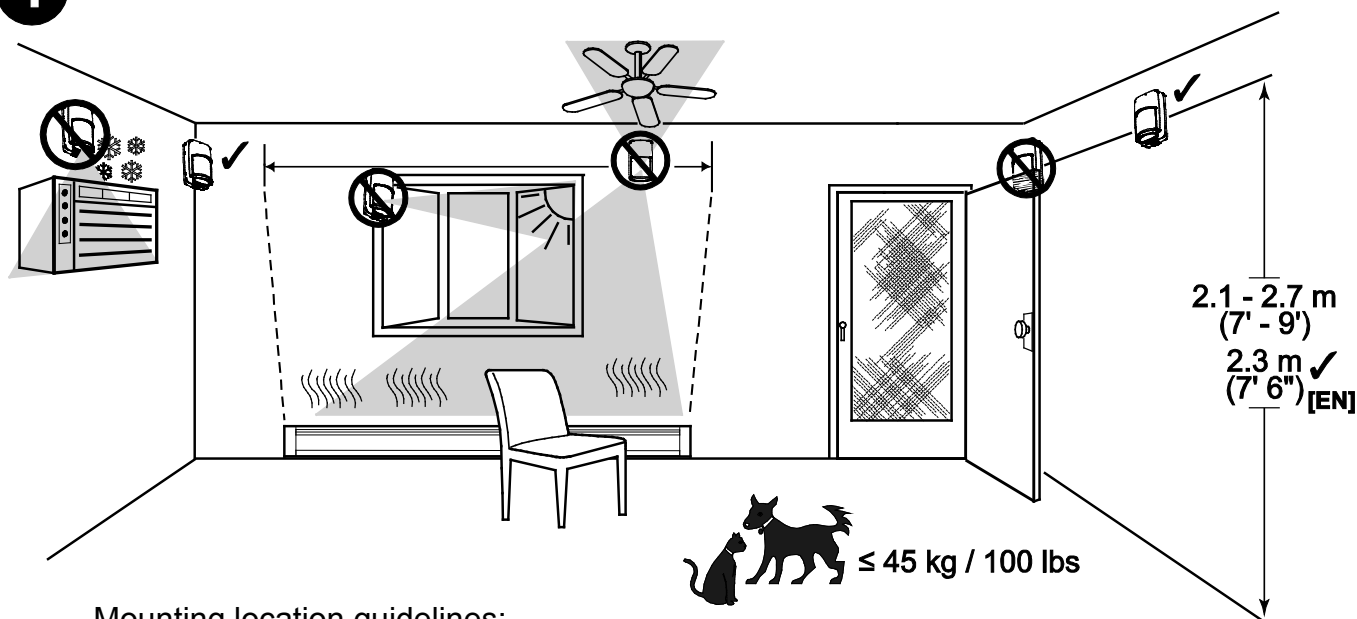

Mounting location guidelines:

- The optimal range is obtained at a mounting height of 2.3 m (7' 6").
- Allow a clear line-of-sight to all areas to protect.
- Do not directly face windows.
- Avoid close proximity to moving machinery, fluorescent lights and heating/cooling sources.
- For use in applications with pets up to 45 kilograms (100 pounds).

[EN] = approved installation.



2 OPEN THE SENSOR

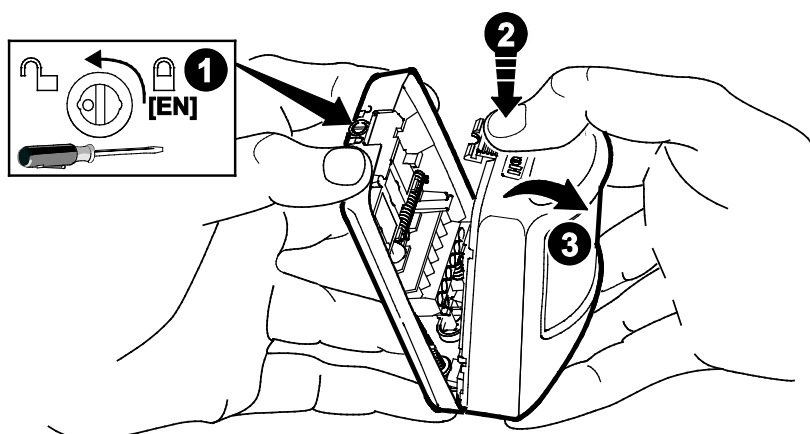

1. Turn the arrow to point to the Unlock symbol.
2. Press firmly on housing latch.
3. Gently separate the front and rear housing.



3 MOUNT THE SENSOR

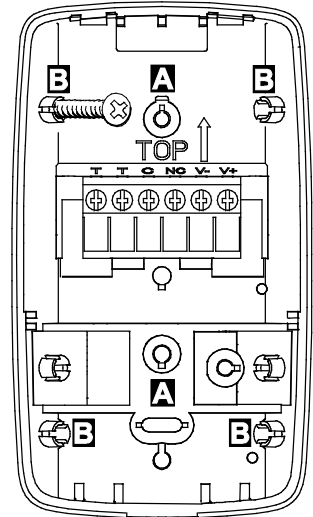
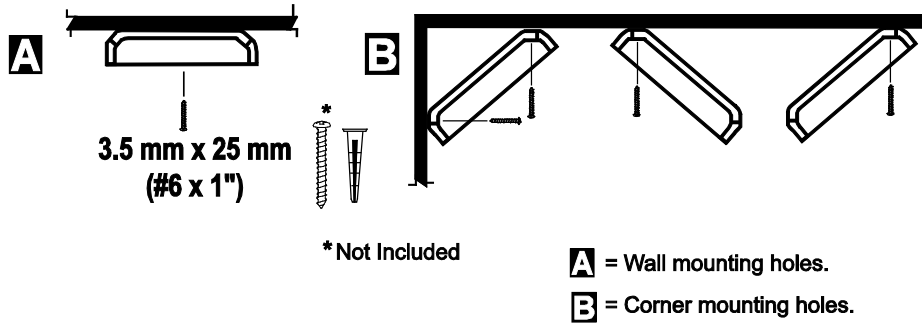

4 SENSOR COMPONENTS AND SETTINGS

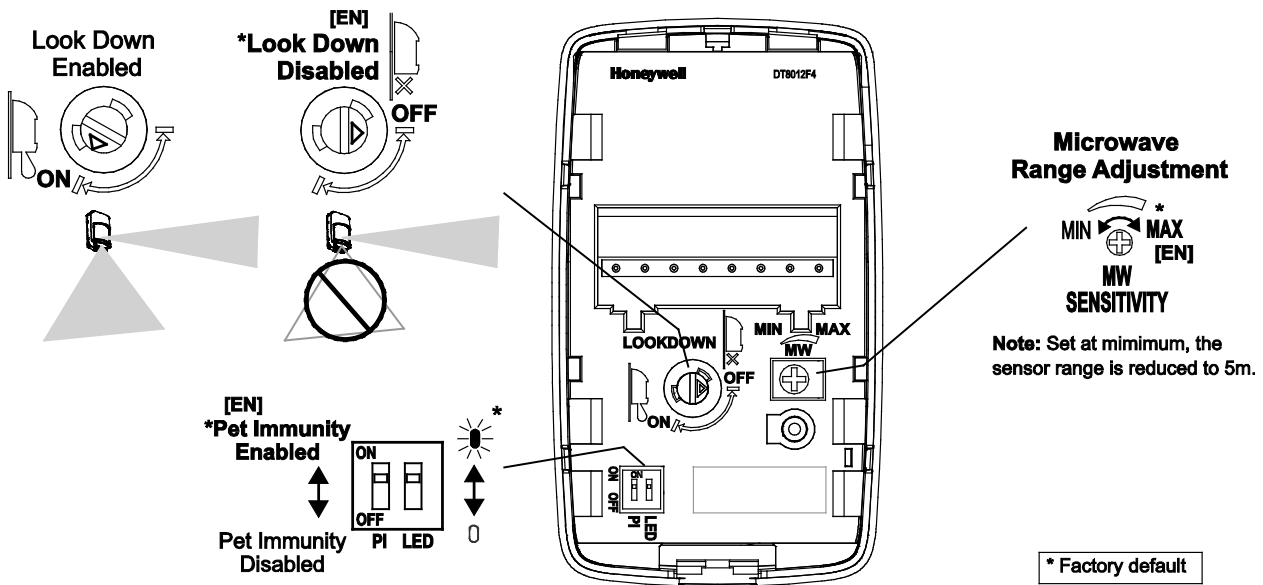

5 WIRE THE SENSOR

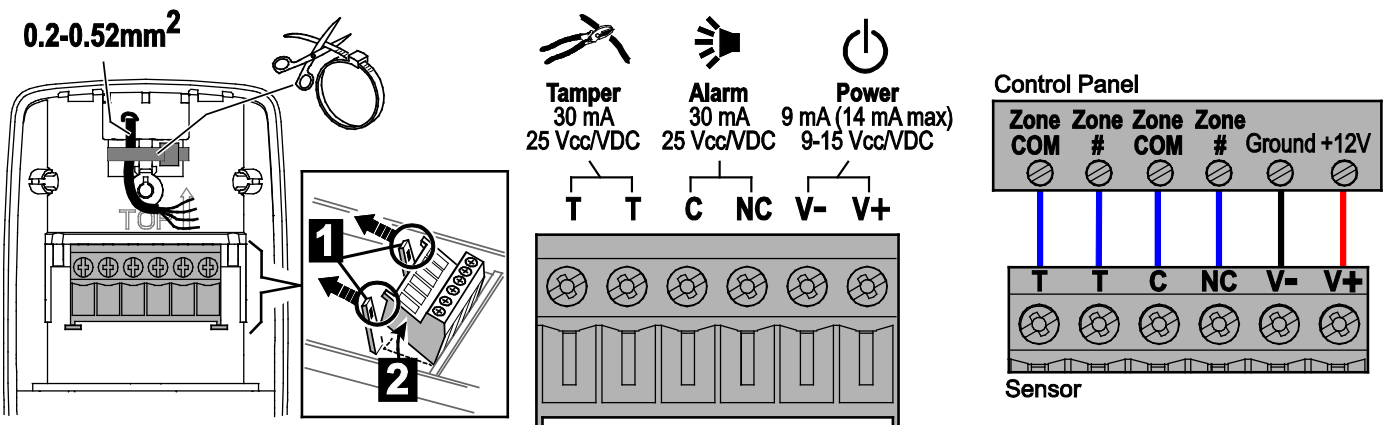

6

WALK TEST THE SENSOR AND ADJUST AS NEEDED.

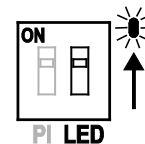
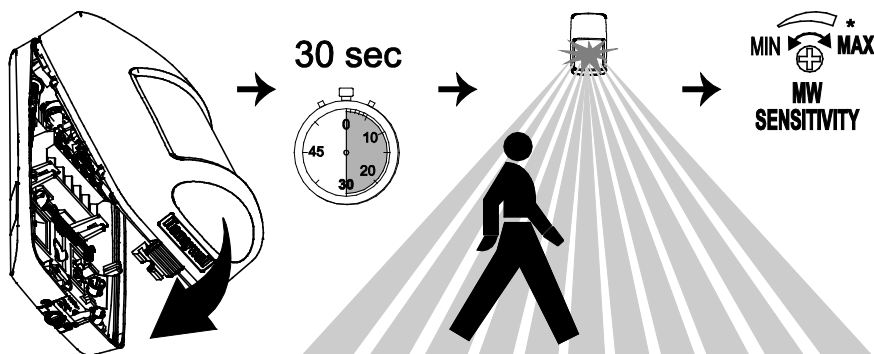

LED	Power Up	Walk Test	Normal	Trouble
Red	Slow Blink	ON Alarm	ON Alarm	Fast Blink
Yellow	OFF	ON Microwave	ON Microwave	OFF
Green	OFF	ON PIR	ON PIR	OFF

1. Close the sensor and apply power to the sensor. Initialization is complete when the LED stops flashing slowly (about 30 seconds).
2. Walk through the detection area and observe the LED.
3. Adjust the microwave range as necessary to meet installation requirements.



Walk test mode is active for 10 minutes, then automatically exits test mode, disables the LED and enters normal operation mode. For an additional 10 minute walk test, enable walk test mode again with the flashlight feature:

Note: During power up and walk test modes the LED is active regardless of the LED Enable/Disable DIP switch setting.

Flashlight Feature:

1. Use a flashlight with a bright light beam, and stand within 1.2 m (4') of the sensor.
2. Swing the light beam past the sensor lens 3-5 times, holding the beam on the lens for 0.5 second each pass.

The flashlight feature is only available for the first 24 hours after the first power up.

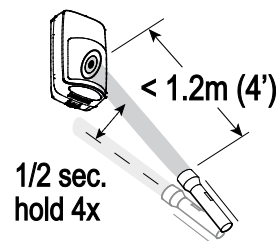

7

DETECTION PATTERNS

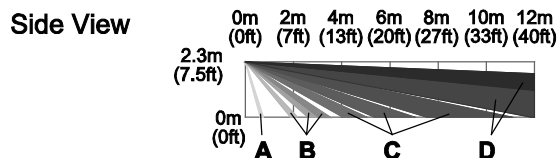
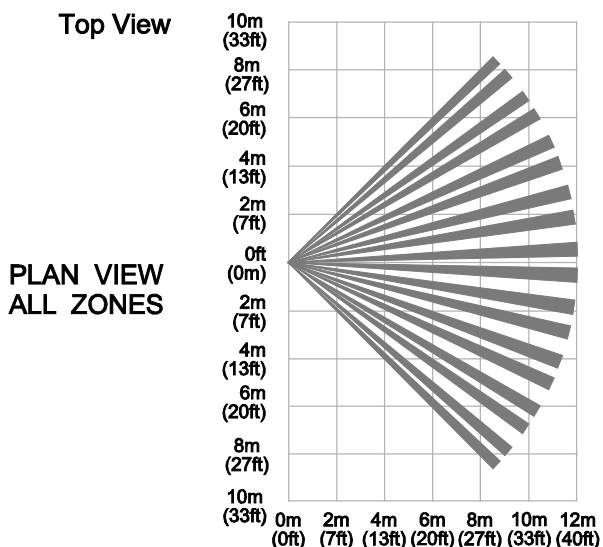

Zones

A	2 Look-down
B	18 Lower
C	46 Intermediate
D	36 Long



RELAY OPERATION

	SENSOR STATUS		
	Normal	Intrusion	Trouble ¹
Alarm Relay	Closed	Open	Open

¹ For information on Trouble conditions, see the [Troubleshooting](#) section.

TROUBLESHOOTING



	NORMAL	TROUBLE*
		Self-Test Failure ¹
Alarm Relay	Closed	Open
Red LED	Off	Flashing

*TROUBLE CONDITIONS:

¹ Self-Test Failure conditions:

- Microwave supervision failure: The sensor is operating in PIR mode only.
- PIR self-test failure: The sensor is disabled.
- Temperature compensation failure: The temperature compensation is disabled.

Depending on the Trouble condition, take the following corrective actions:

- Verify the power supply is sufficient (at least 9V at the sensor).
- Cycle power to the sensor.
- [Walk test](#) the sensor.

If the Trouble condition does not clear, replace the sensor.



SPECIFICATIONS

Range: 12 m x 17 m

Power: 9.0 - 15 VDC; 9 mA typical, 14 mA maximum, 12 VDC;
AC Ripple: 3 V peak-to-peak at nominal 12 VDC

Alarm Relay: Energized Form A; 30 mA, 25 VDC, 22 Ohms resistance maximum. Alarm Relay Duration: 3 seconds

Tamper: Cover; (NC with cover installed) Form A; 30 mA, 25 VDC; Magnetic field

Microwave Frequencies: DT8012F4 – 10.525 GHz
DT8012F5 – 10.587 GHz

RFI Immunity: 20V/m 10-1000MHz, 15V/m 1000-2700MHz

PIR White Light Immunity: 10,000 Lux typical

Fluorescent light filter: 50 Hz / 60 Hz.

Operating Temperature: -10° to 55° C / 14° to 131° F

Relative Humidity: 5 to 95%; non-condensing

Temperature Compensation: Advanced Dual Slope

Dimensions: 9.8 cm H x 5.7 cm W x 4.35 cm D /
4.57" H x 2.76" W x 1.69" D

Weight: 96 g / 3.38 oz (net weight)

ACCESSORIES*

SMB-10 (P/N 0-000-110-01)	Swivel Mount Bracket
SMB-10C (P/N 0-000-111-01)	Swivel Mount Ceiling Bracket
SMB-10T (P/N 0-000-155-01)	Swivel Mount Bracket w/Tamper

* Accessories are not covered by certifications.



APPROVAL LISTINGS



EN50131-2-4:2008, Security Grade 2,
Environmental Class II.
Suitable for connection to an EN 60950 Class II
Limited Power Source.

Note: In EN 50131-2-4 compliant installations, mount the sensor at 2.3m, disable lock down, enable pet immunity, set the microwave sensitivity to maximum and lock the sensor housing with the cover lock (see "[EN]" where noted in Steps 1-4).

IMPORTANT: The sensor should be tested at least once each year.



NF&A2P 2 boucliers (référentiel NF324-H58)
et conforme aux normes EN50131-2-4 et
RTC50131-2-4; IP30 IK04
DT8012F4 – N° de certificat: 2821420019
DT8012F5 – N° de certificat: 2821420019
Organisme de certification:
CNPP Cert.: www.cnpp.com et
AFNOR Cert.: www.marque-nf.com

Honeywell Security Group - BP1219
1198 avenue du docteur Maurice Donat
Sophia Antipolis
06254 Mougins Cedex.
TEL: +33.4.92.94.29.50
FAX: +33.4.92.94.29.60



DT8012F4
INCERT B-893-0014

DT8012F5
PD6662:2010

For any additional information, please refer to our Website:
<http://www.honeywell.com/security/emea/hscdownload>

Or contact:

Honeywell Security Group
Newhouse Industrial Estate
Motherwell
Lanarkshire ML1 5SB
United Kingdom

Tel: +44(0)1698 738200
Email: UK64Sales@Honeywell.com



Please contact your local authorised Honeywell representative for product warranty information