

hyco

Non-concussive Tap

TAPNC

Instruction Manual

Version 2.1 April 2015

PLEASE READ THESE INSTRUCTIONS BEFORE COMMENCING INSTALLATION. UPON COMPLETION OF INSTALLATION ENSURE THE INSTRUCTIONS ARE LEFT WITH THE USER/MAINTAINER OF THE PRODUCT.

Non-concussive Tap

TAPNC

I. INTRODUCTION

Thank you for purchasing model TAPNC Non-concussive tap.

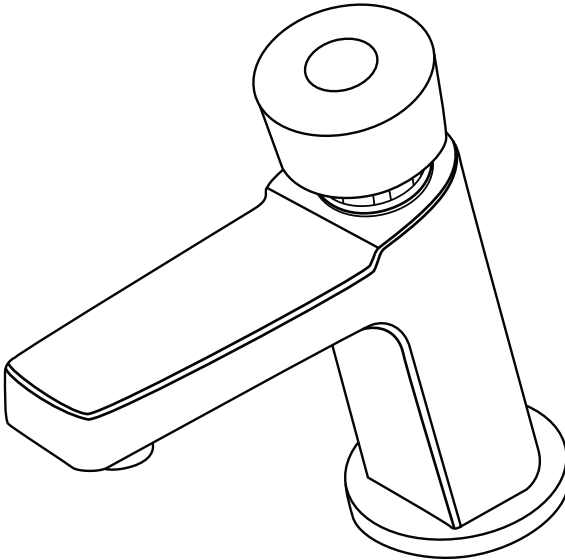

2. IMPORTANT SAFETY POINTS

Please read these instructions thoroughly and retain for future use.



ALL PRODUCTS MANUFACTURED AND SUPPLIED ARE SAFE, PROVIDED THEY ARE INSTALLED CORRECTLY, USED CORRECTLY AND RECEIVE REGULAR MAINTENANCE IN ACCORDANCE WITH THOSE INSTRUCTIONS.



THESE FITTINGS NEED TO BE INSTALLED IN ACCORDANCE WITH THE WATER SUPPLY REGULATIONS

Before starting any installation, please consider the following:



PRIOR TO DRILLING INTO WALLS, CHECK THAT THERE ARE NO HIDDEN ELECTRICAL WIRES, CABLES, OR WATER SUPPLY PIPES. THIS CAN BE CHECKED WITH THE AID OF AN ELECTRONIC DETECTOR.

If power tools are used, do not forget to:



WEAR EYE PROTECTION.



UNPLUG EQUIPMENT AFTER USE.

3. INSTALLATION

Prior to installation:

Should the supply pressure be above 3 bar, a pressure reducing valve must be fitted.

All supply pipe work should be thoroughly flushed before connecting to the taps, this is to remove any debris in the pipe work.



TAPS SHOULD ALSO BE INSTALLED WITHOUT THE USE OF ANY SEALANTS (WATERBORNE DEBRIS MAY DAMAGE THE INTERNAL PARTS). DAMAGE CAUSED BY WATERBORNE DEBRIS WILL INVALIDATE THE GUARANTEE.

If the fitting is installed at low pressure (tank fed), then the minimum distance from the highest installed position of the outlet to the underside of the cold water tank should be at least 2 meters to ensure adequate performance.

Use with Instantaneous water heaters

The tap is supplied with a 2.5litres/min spray head attachment but for use with other instantaneous water heaters an alternative tap spray nozzle may be more suitable (options are supplied).

Turn on the mains water supply. Remove the fitted tap spray nozzle and flush through by opening the tap. Select the required tap spray nozzle using the table below and fit into the tap.

Tap spray nozzle	Max flowrate (litres/min)	Best Suited to water heater	Colour code identification
IN-TSN-2.0	2.0	4.4kW Rho	White/Black
IN-TSN-2.5 (fitted as standard)	2.5	6.0kW Rho	White/Green
IN-TSN-3.0	3.0	9.6kW Aquila	White/Lilac

- ① Identify that all components are present prior to installation.
- ② Assemble and fix the tap as shown below

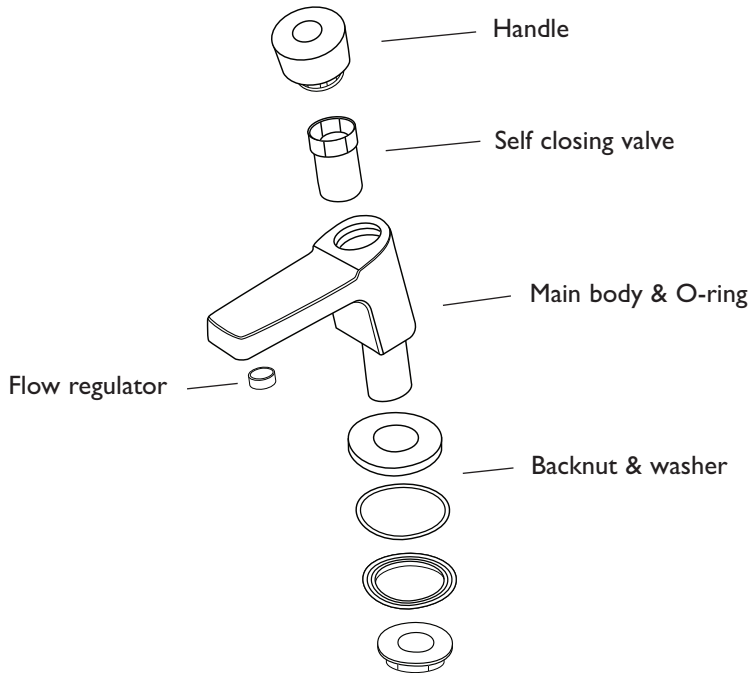

- ③ Connect the water supply to the tap.
- ④ Turn on the water supplies and operate the tap several times to flush the system.
- ⑤ Check all joints and connections for leaks.

4. SPECIFICATION

Operating pressure range: Min 0.2 bar, Max 3.0 bar

Flow Rate: 2l/min

A range of flow rates can be achieved by replacing the flow regulator in the outlet.

Designed to comply with BS EN 816 Sanitary Tapware Automatic Shut Off Valves and to be used within systems designed to BS 6700.

BS 6700 recommends the temperature of stored water should never exceed 65°C .

A stored water temperature of 60°C is considered sufficient to meet all nominal requirements and will minimise the build-up of lime scale in hard water areas.



IT IS ESSENTIAL THAT HOT WATER IS SUPPLIED AT A SAFE TEMPERATURE. FOR HANDWASHING PURPOSES A TEMPERATURE OF NO MORE THAN 42°C IS RECOMMENDED. THIS CAN BE ACHIEVED VIA A SUITABLE THERMOSTATIC MIXING VALVE OR OTHER TEMPERATURE CONTROLLED HOT WATER SOURCE.

5. DIMENSIONS

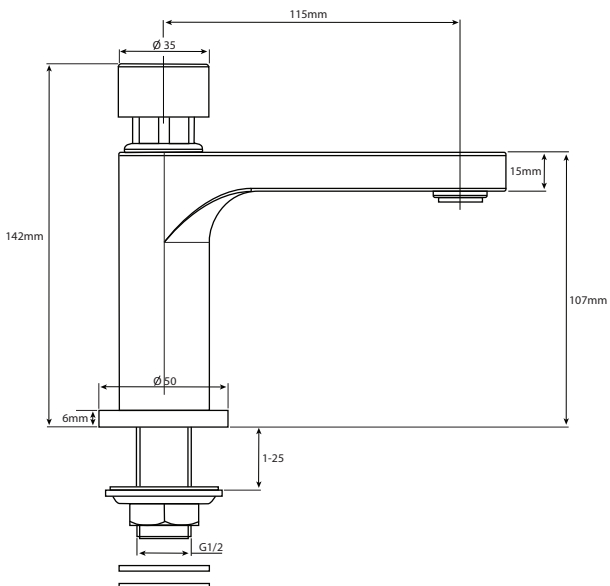

6. CLEANING & MAINTENANCE

Your fitting comes with a high quality finish and should be treated with care to preserve the visible surfaces. All finishes will wear if not cleaned correctly.

The only safe way to clean your product is to wipe with a soft damp cloth.

All bathroom cleaning products will damage the surface of your fitting (even non-scratch cleaners).



NEVER USE ABRASIVE DETERGENTS OR DISINFECTANTS. AVOID THOSE CONTAINING ALCOHOL, HYDROCHLORIC OR PHOSPHORIC ACID.

We advise that your fitting is regularly serviced, particularly in hard water areas.

Traditional type valves - if the fitting leaks from the spindle:

1. Remove fitting handle (if necessary).
2. Tighten the gland nut on top of the valve.

All valve types - If the fitting begins to drip:

1. Turn off the water supplies.
2. Remove fitting handle and valve.
3. Carefully clean the valve seating and rubber washer.
4. Replace the valve and then turn on the water supplies.
5. If the problem persists, contact our helpline quoting the product code overleaf.

7. GUARANTEE AND SERVICE POLICY

This product is guaranteed against faulty materials and manufacture for a period of one year from the date of purchase. Hyco will in its sole discretion replace, repair or refund any faulty unit. Defects arising from incorrect installation are excluded. Consequential costs such as labour charges or damage to fittings and surroundings are expressly excluded.



Hyco Manufacturing Ltd
Normandy Court, Express Way
Castleford, WF10 5NR

Sales: 01924 225 200
Fax: 01924 225 210
Switchboard: 01924 225 215

Email: sales@hyco.co.uk
www.hyco.co.uk

■ WATER HEATING

■ SPACE HEATING

■ HAND DRYERS