

JC180009

ToughLED™ Pro

ToughLED™ Pro 1200mm 4ft Single 18W IP66 4000K WOP

Features & Benefits

- High efficiency up to 145 LpcW, IP66, IK10
- 90° Lock-in-place side clip design, keeps clips clear during installation
- Detachable 4 pin terminal block with multiple positions adjacent to all cable entry points
- Inbuilt loop-in/loop-out cable restraints to ensure that cables do not clash when closing the fixture
- Plug & play emergency & microwave sensor modules with optional remote control
- Ultra-wide surface mount bracket rail to enable flexibility to locate joists
- Wide body for retrofitting BESA conduit box mounting, with rear, side and end conduit entry points
- Unique rear IP66 gasket, sealing cable entry from within the fixture for surface mounting applications
- 4ft, 5ft, 6ft single and twin light outputs in both opal and prismatic diffuser options
- Microwave step dimmable, DALI and 1-10V dimmable options available
- 5-year extended warranty on fixture and batteries, which uses LifePO4 batteries for improved performance and life



General Information

Mounting	Surface or Suspended
Trade Name	ToughLED™ Pro
Environment	Suitable for exterior and interior applications
Suitable For Zones	Zone 1
Product Group	LED - Surface
Color Finish	Grey
Product Shape	Rectangular
Product Range	ToughLED™ Pro
IK Rating	IK10
Overall Dimensions	1270 x 96 x 81.3
Length (mm)	1270
Width (mm)	96
Height (mm)	81.3
Product Weight(kg)	1.45

Light Source	LED
Recommended Product Location	Wall or Ceiling Mount or suspended, suitable for a wide variety of applications. Including Warehouses/storage facilities. Car parks and manufacturing.
Method Of Fix	Mounting Brackets, Suspension chains or conduit mounting
Distance From Lighted Object	0.3m
IP Rating	IP66
Origin of manufacturer	Made in China
Warranty	2 years standard warranty extends to 5 years when registered within the first year of purchase (See Website for terms and conditions)
Driver Manufacturer	JCC
LED Manufacturer/Type	BMTC/2835

Electrical

Voltage Rating	220-240
Primary Running Current(Amp)	0.2
Inrush current(Amps)	4
Operating Frequency Hz	50/60Hz
Secondary running current(mA)	350
Constant Current or Constant Voltage	CC
Luminaire Circuit Wattage	18
Class	I
Output Voltage Max/Range (VDC)	66VDC max
Total Harmonic Distortion (THD)%	<20
EMC Compliant (EN55015)	Yes
Power Factor Correction	0.9
Input Electrical Connections	Live, Earth, Neutral
Dimmable	No

Thermals

Thermal Cut Out	Yes
Operating Temperature Range °C	-20 to +50

Performance Data

LED Life (Hours)	54000
------------------	--------------

Hours life stated is an indication of expected L70 chip and light output calculations when operating in optimum conditions. Product warranty period supports the full product during the term given. The L70 hours expectancy is not correlated with the full product warranty term, nor is it a representation of lumen depreciation during the warranty period.

Energy Rating	This product contains a light source of energy efficiency class D
Actual Lumen Output	2400
Lumens Per Circuit Watt	133
Standard Deviation Colour Matching - SDCM	<5
Color Rendering Index	80-89

CRI: Ra	80
Correlated Color Temperature	4000K
Beam Angle °	120
LOR (Light Output Ratio) %	100
Photometry Available	Yes: available on request.

Construction

Primary Material	Polycarbonate
Outer Diffuser	Polycarbonate
Driver Housing	Polycarbonate

Packaging

Product carton overall dimensions(cm)	127.5 x 10 x 8.5
Product Packaged Weight(kg)	1.66
Quantity Per Outer Carton	9
Outer carton(L)- cm	129
Outer carton(W)- cm	31.5
Outer carton(H)- cm	27
Outer carton Net weight- kg	14.9
Outer carton Gross weight- kg	15.70
Product Bar Code EAN-13 Number	5052544110238
Outer carton Bar Code ITF-14 Number	15052544110235

Standards & Approvals

Manufactured In Accordance To	BS EN 60598:2015, 2-1
CE Marked	Yes
UKCA Marked	Yes
Date code/Purchase order No.	Yes
WEEE Symbol	Yes
Certificate Of Conformity	Available on request
Accredited Members	LIA, ISO9001-2015, ISO14001-2025

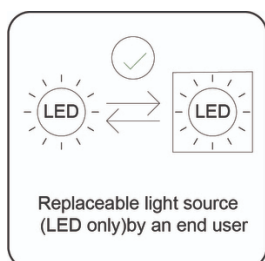
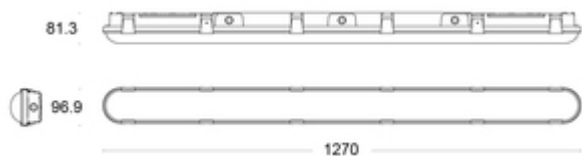

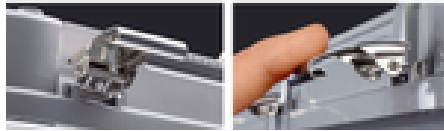
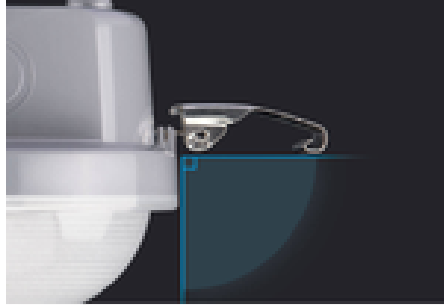



JCC Lighting LTD, Lux Park, Chichester Business Park, City Fields Way, Tangmere, Chichester, West Sussex, PO20 2FT.
Sales: 01243 838999 (8am to 5pm Monday to Friday) Fax: 01243 838998 | sales@jcc.co.uk | www.jcc.co.uk
Company Registration Number: 03044848 | VAT Number: 918544112

This document is uncontrolled if printed, all information is subject to change

Version 225 [17/04/2023]