

## Table of Contents

---

<b>Carbon Monoxide Overview</b>	Page 2
<b>Quick Set Up</b>	Page 3
<b>Installation Instructions</b>	Pages 4-6
Installation Location	
Mounting	
Where to Install	
Where NOT to Install	
<b>Features and Operations</b>	Pages 7-8
Red Alarm Indicator	
Green Operating Indicator	
Test/Reset Button	
<b>Battery Installation/Replacement</b>	Pages 9-10
<b>What To Do If The Alarm Sounds</b>	Page 11-12
Alarm Instructions/Emergency Response	
<b>Alarm/Danger Levels</b>	Pages 13-14
<b>Caring For Your Kidde Battery Powered CO Alarm</b>	Pages 15-16
<b>Frequently Asked Questions</b>	Page 17
<b>Product Specifications</b>	Pages 18-19
<b>Warranty</b>	Pages 19-21

*Thank you for the purchase of your new Kidde carbon monoxide alarm. If you have any questions about the operation or setup of your CO alarm, feel free to call us on 0800 917 0722*

# Carbon Monoxide Overview

---

Your new Kidde carbon monoxide (CO) alarm is a sophisticated instrument that has been carefully designed and tested to assure accurate detection of CO build up in a residential environment. **Your alarm is for use specifically in the home.**

Carbon monoxide cannot be seen, smelled or tasted and can be fatal. The build up of CO in the blood is called the carboxyhaemoglobin level and interferes with the body's ability to supply itself with oxygen. Depending on the concentration, carbon monoxide can kill in minutes.

The most common sources of carbon monoxide are malfunctioning gas appliances used for heating and cooking, vehicles running in an attached garage, blocked chimneys or flues, portable fuel burning heaters, fireplaces, fuel powered tools and operating a grill in an enclosed space. Any fuel that burns can produce carbon monoxide.

Indications of carbon monoxide poisoning include symptoms similar to the flu, but with no fever. Other symptoms include dizziness, fatigue, weakness, headache, nausea, vomiting, sleepiness and confusion. Everyone is susceptible to the danger of CO, but experts agree that unborn babies, small children, pregnant women, old age pensioners and people with heart or respiratory problems are at the highest risk for serious injury or death or anyone that spends large amounts of time at home. Each year a qualified Corgi (gas) or Hetas (solid fuel) engineer should inspect and clean your heating system, vents, chimney, and flues.

Your new Kidde CO alarm has a five year warranty. Please take a few minutes to thoroughly read the user's guide and familiarise yourself and your family with its operation. Your Kidde CO alarm was designed to detect carbon monoxide gas from ANY source of combustion. **IT IS NOT DESIGNED TO DETECT SMOKE, FIRE OR ANY OTHER GASES.** If you have any questions please call us on 01753 685148.

This manual and the products described are copyrighted, with all rights reserved. Under these copyright laws, no part of this manual may be copied for use without the written consent of Kidde Safety. If you require further information, contact our Consumer Hotline, or write to us at:

**Kidde Safety Europe Ltd**

**Mathisen Way, Colnbrook, Slough, Berkshire SL3 0HB**

**Email: [kiddesafetyinfo@kiddesafety.co.uk](mailto:kiddesafetyinfo@kiddesafety.co.uk)**

**[www.kiddesafetyeurope.co.uk](http://www.kiddesafetyeurope.co.uk)**

## Quick Set Up

---

Remove the three enclosed AA batteries and install them into the battery well. Carefully place the red battery warning flags into the battery well. Observe the battery polarity markings at the bottom of the battery well.

When the batteries are first installed, the unit will beep once and the red alarm light will flash. After approximately 20-30 seconds the green light will flash indicating that the unit is operational. Replace battery cover.

Your Kidde CO alarm is now operational.

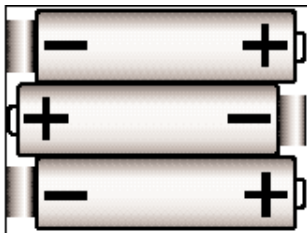

### IMPORTANT

A small screwdriver or similar tool may be required when opening the battery compartment cover. This should be levered from the lip at the bottom of the cover.

The cover is designed this way to discourage the removal of batteries, or tampering, by young children.

# Installation Instructions

---

## Installation Location

When choosing your installation locations, make sure you can hear the alarm from all sleeping areas. If you install only one carbon monoxide alarm in your home, install the alarm near bedrooms, not in the cellar or boiler room.

## Recommended Location

### Upper Levels of Home

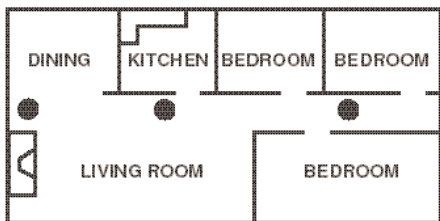

### Cellar Levels of Home

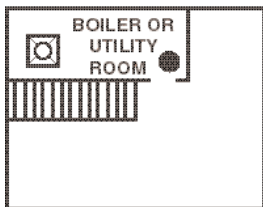

- If you have only one alarm, place it near sleeping areas.
- Position near fuel burning appliances, near fireplaces, boilers or hot water heater.

# Installation Instructions

---

## Mounting

Your CO alarm is designed for mounting onto the inside wall.

You should fix the back plate provided to the wall first, using the screws and rawl plugs.

When the plate is attached locate the the slots on the back of the alarm with the keys on the back plate, sliding downwards and into position until the tab clips onto the top of the alarm (see figure 1).

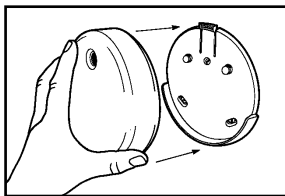

Figure 1

To remove, press the tab against the wall and lift the alarm out of the mounting plate.

Install your CO alarm 1.5 metres from the floor.

NOTE: Your 9CO5 CO alarm is not designed for portability.

## Where To Install Your Kidde CO Alarm

The following suggestions are intended to help you with the placement and installation of your Kidde CO alarm.

- Place out of the reach of children. Under no circumstance should children be allowed to handle the CO alarm.
- Install in a bedroom or hallway located close to the sleeping area. Take special care to verify the alarm can be heard in sleeping areas.
- It is recommended that a CO alarm be installed on each level of a multilevel home.
- Locate at least 2 metres away from all fuel burning appliances.
- Placing at eye level allows for optimum monitoring of the red and green indicator lights, or, as a guide, 1.5 metres from the floor.

## Installation Instructions (cont.)

---

- Ensure that all vents of the unit are unobstructed.
- Do not install in dead air spaces such as peaks of vaulted ceilings, or gabled roofs.
- Do not install in turbulent air from ceiling fans.  
Do not place near fresh air vents or close to doors and windows that open to the outside.
- Keep the CO alarm away from excessively dusty, dirty, or greasy areas such as kitchens, garages and boiler or utility rooms. Dust, grease and household chemicals can affect the sensor.
- Keep out of damp and humid areas such as the bathroom. Avoid spraying aerosols near the CO alarm.
- Do not install in areas where the temperature is below 40°F (4.4°C) or hotter than 100°F (37.8°C).
- Do not place behind curtains or furniture. CO must be able to reach the sensor for the unit to accurately detect carbon monoxide. NEVER place the CO alarm flat on a table top or similar surface.
- Be aware that certain conditions can result in transient CO situations, such as:
  - 1) Excessive spillage or reverse venting of fuel burning appliances caused by outdoor ambient conditions, such as:
    - i) Wind direction and/or velocity, including high gusts of wind. Heavy air in the vent pipes (cold/humid air with extended periods between cycles).
    - ii) negative pressure differential resulting from the use of exhaust fans.
    - iii) Simultaneous operation of several fuel burning appliances competing for limited internal air.
    - iv) Vent pipe connections vibrating loose from clothes dryers, boilers or water heaters.
    - v) Obstructions in or unconventional vent pipe designs which can amplify the above situations.
  - 2) Extended operation of unvented fuel burning devices (cooker, oven, fireplace, etc.).
  - 3) Temperature inversions which can trap exhaust near the ground.
  - 4) Car idling in open or closed garage, or near home.

## Features and Operation

---

Your new Kidde battery powered CO alarm utilises sophisticated electronic components to protect you and your family from the dangers of CO. Unique features include red and green diagnostic lights, battery status, and sensor health. Familiarise yourself with these features:

### Red Alarm Indicator Light

If a dangerous level of carbon monoxide is detected by your Kidde alarm, the red alarm LED will light continuously and a loud (85decibel) alarm will sound. See figure 2.

***See page 13-14 for an understanding of which CO levels are dangerous.***



Figure 2

### Green Operate Indicator Light

The green light flashing every 30 seconds indicates the unit is functioning properly (see figure 3).

The green light will flash before a CO reading is taken and when any button is pressed.

If the unit chirps once every 30 seconds, observe the unit for the following:

A chirp every 30 seconds, with a green LED flash followed by a red LED flash, indicates the batteries are low. Follow the battery installation/replacement instructions on page 9 and 10.

A chirp every 30 seconds, with a red flash and no green LED flash indicates a unit error. If the unit does not respond, call Kidde on 0800 917 0722.

## Features and Operation (cont.)

---

### Test/Reset Button

The test/reset button is used to test the unit's electronics and to reset the unit during alarm (see figure 3).



Figure 3

- **Test the unit** - To test, press and release the test/reset button, you should hear one short beep - followed by 5 seconds of silence – followed by a continuous alarm with a corresponding red LED flash. Familiarise yourself and family members with the alarm pattern.

***Test the unit weekly! If at any time your unit does not perform as described replace it immediately.***

***Note: After the test/reset button is pressed, the alarm sounds and the red alarm light flashes. This does not indicate that carbon monoxide is present.***

Due to the loudness of the alarm we suggest you place your fingers over the sounder opening when testing your Kidde CO Alarm.

- **Reset the unit** - If the alarm is sounding, pressing the test/reset button will terminate the alarm. If the CO condition that caused the alert in the first place continues, the alarm will reactivate. Reactivation times depend on the amount of CO that caused the CO alarm to initially alarm and the amount of CO present after resetting the alarm (see page 11, Alarm Instructions/Emergency Response).

**WARNING:** Tampering with your 9CO5 CO alarm, may cause malfunction. Please follow manufacturers instructions at all times.



## Battery Installation/Replacement

---

Since batteries are not installed in the unit at the factory, you will need to install them. Your Kidde unit will continue to remind you to change the batteries for up to seven days after low batteries are detected.

***WARNING: Your Kidde CO alarm will not be operational and will not monitor for CO levels without the installation of three charged AA batteries.***

Your Kidde CO alarm monitors for battery failure such as bad or corroded connections, sudden battery failure and other causes. **If the alarm senses any form of battery failure, the unit will start chirping an audible alarm every 30 seconds, the green and red alarm light will flash.**

The battery error warning will continue until new batteries are placed in the unit, or until the remaining batteries become completely exhausted.

Three AA batteries have been included with your purchase. When replacing the batteries, we recommend use of the following for a minimum of one year normal operation:

- Duracell MN1500
- Camelion Mignon LR6-AM3-1.5
- Energizer E91
- Rayovac 815

These batteries can be purchased at your local retailer.

NOTE:

Ensure that you observe the polarities required during installation. Incorrect battery insertion will make your CO alarm inoperable.

# Battery Installation/Replacement (cont.)

---

## Battery Installation/Replacement Instructions

To install or replace the batteries in your Kidde unit please perform the following steps:

1. Gently lift open the battery cover to expose the battery compartment.  
Note: You will require a small screwdriver or similar tool for this procedure.

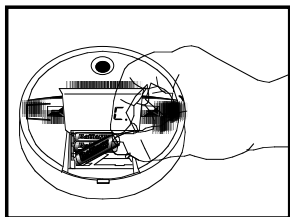

Figure 4

2. Remove the old batteries and properly dispose of them as recommended by the manufacturer (see figure 4).
3. **Reinstall the new batteries, being careful to seat the red battery warning flags in the recess of the battery well.** Also, note the polarity illustration in the bottom of the battery compartment (see figure 5).
4. The unit will chirp and the green light will flash.
5. Gently close the battery cover. **The battery cover of your CO alarm will NOT close if all three AA batteries are not installed.**

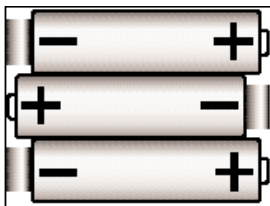

Figure 5

## What To Do If The Alarm Sounds

---



**WARNING:** Actuation of your CO Alarm indicates the presence of Carbon Monoxide (CO) which can KILL YOU.

When the CO alarm senses a dangerous level of CO, the unit will emit a loud alarm pattern.



**WARNING!** -Actuation of this device indicates the presence of dangerous levels of carbon monoxide! Carbon monoxide can be fatal! If the alarm sounds:

- 1) Operate the test/reset button;
- 2) Call **British Gas** PHONE NUMBER  
**0800 111 999**
- 3) Immediately move to fresh air outdoors or by an open door/window. Do a head count to check that all persons are accounted for. Do not re-enter the premises nor move away from the open door/window until British Gas has arrived, the premises have been aired out, and your alarm remains in its normal condition.

## What To Do If The Alarm Sounds (cont.)

---

- 4) After following steps 1-3, if your alarm reactivates within a 24 hour period, repeat steps 1-3 and call a qualified Corgi or Hetas approved solid fuel engineer to examine and/or turn off your gas/oil fired appliances, such as space heater, boiler, water heater, cooker, oven, clothes dryer, or other sources of combustion, such as paraffin burning stove or heater or gas log fireplace. If your car is idling in an attached garage turn off the engine.

PHONE NUMBER

## Alarm/Danger Levels

---

**Caution: This CO alarm will only indicate the presence of CO at the sensor. CO may be present in other areas.**

**Common Mild Exposure Symptoms:**

Slight headache, nausea, vomiting, fatigue (“flu-like” symptoms).

**Common Medium Exposure Symptoms:**

Throbbing headache, drowsiness, confusion, fast heart rate.

**Common Extreme Exposure Symptoms:**

Convulsions, unconsciousness, heart and lung failure. It can cause brain damage and death. Many cases of reported CARBON MONOXIDE POISONING indicate that while victims are aware they are not well, they become so disoriented they are unable to save themselves by either exiting the building or calling for assistance. Also young children and household pets may be the first affected.

Familiarisation with the effects of each level is important. The symptoms described in the chart above are related to carbon monoxide poisoning and should be discussed with ALL members of the household.

***Exposure to high levels of carbon monoxide can be fatal or cause permanent damage and disabilities.***

If you experience any symptoms of carbon monoxide poisoning, consult your doctor immediately! CO poisoning can be determined by a simple blood test called a carboxyhaemoglobin test. Severe cases may require treatment in a hyperbaric chamber. Remember, young children and household pets may be the first effected.

***If you have additional questions please call  
Kidde on 0800 917 0722.***

## Alarm/Danger Levels (cont.)

---

Concentration of CO in Air (ppm = parts per million)	Approximate Inhalation Time and Symptoms Developed
50 ppm	The maximum allowable concentration for continuous exposure for healthy adults in any 8-hour period, according to HSE*.
200 ppm	Slight headache, fatigue, dizziness, nausea after 2-3 hours.
400 ppm	Frontal headaches within 1-2 hours, life threatening after 3 hours.
800 ppm	Dizziness, nausea and convulsions within 45 minutes. Unconsciousness within 2 hours. Death within 2-3 hours.
1,600 ppm	Headache, dizziness and nausea within 20 minutes. Death within 1 hour.
3,200 ppm	Headache, dizziness and nausea within 5-10 minutes. Death within 25-30 minutes.
6,400 ppm	Headache, dizziness and nausea within 1-2 minutes. Death within 10-15 minutes.
12,800 ppm	Death within 1-3 minutes.

\* Health and Safety Executive

The chart above relates to healthy adults. Levels differ for those at high risk. Individuals with medical problems may consider using detection devices which provide audible and visual signals for carbon monoxide concentrations under 30 ppm.

**This CO alarm meets the requirements of BS 7860.  
Standard alarm times are as follows:**

At 45 PPM - The unit must not alarm before 60 minutes.

At 150 PPM - The unit must alarm within 10-30 minutes.

At 350 PPM - The unit must alarm within 6 minutes.

**WARNING:** This product is intended for use in ordinary indoor locations of family living units. It is not designed to measure compliance with Occupational Safety and the Health & Safety Executive (HSE).

## Caring for your Kidde Battery Powered CO Alarm

---

To keep your CO alarm in good working order, please follow these simple steps:

- Verify unit alarm, lights and battery operation by pushing the test button once a week.
- Vacuum the CO alarm cover with a soft brush attachment once a month to remove accumulated dust.
- Instruct children never to play with the CO alarm. Warn children of the dangers of carbon monoxide poisoning.
- Never use detergents or other solvents to clean the CO alarm.
- Avoid spraying air fresheners, hairspray, paint or other aerosols near the CO alarm.
- **Do not paint the CO alarm.** Paint will seal the vents and interfere with the sensors ability to detect CO.
- Do not place near a nappy bucket.

## Caring for your Kidde Battery Powered CO Alarm (cont.)

---

Move the CO alarm and place in another location prior to performing any of the following:

- Staining or stripping wood floors or furniture
- Painting
- Wall papering
- Using adhesives

Storing the unit in a plastic bag during the above projects will protect the sensor from permanent damage.

**WARNING: As soon as possible, place the CO alarm back in its proper location to assure continuous protection from carbon monoxide poisoning.**

When household cleaning supplies or similar contaminants are used, the area should be well ventilated.

**The following substances can affect the sensor and may cause false readings:**

Methane, propane, iso-butane, iso-propanol, ethylene, benzene, toluene, ethyl acetate, hydrogen sulphide, sulphur dioxides, alcohol based products, paints, thinner, solvents, adhesives, hairsprays, aftershaves, perfumes and some cleaning agents.



## Frequently Asked Questions

---

**Q.** *How many CO alarms do I need in my house?  
How many square metres will one CO alarm cover?*

**A.** We recommend you place CO alarms near the sleeping area(s). If you have a multi-level home, you should place a CO alarm on each level of the home. A good rule of thumb for the number and placement of CO alarms for your particular home is to place CO alarms near smoke alarms that have been installed to meet current building code requirements.

Generally, one CO alarm can be adequate for 111.48 to 139.35 square metres of living space. The most important determination for the number of CO alarms needed is whether an alarm can be heard in all sleeping areas.

**Q.** *Do I have to press the test button to get a CO reading?*

**A.** No. Your Kidde CO alarm continuously monitors the air for carbon monoxide. If it detects a dangerous level of CO it will alarm automatically. To test the internal components and circuitry of your CO alarm, press the test/reset button.

# Product Specifications

---

<b>Power:</b>	Three AA batteries (supplied)
<b>Sensor:</b>	Electrochemical carbon monoxide sensor
<b>Humidity:</b>	5-95% Non condensing
<b>Temperature:</b>	Operating range 40°F (4.4°C) to 100°F (37.8°C)
<b>Mounting:</b>	Accessories supplied for wall mounting
<b>Alarm:</b>	85+ dB at 3m @ 3.4 ± 0.5 KHz pulsing alarm
<b>LED Operation:</b>	<ul style="list-style-type: none"><li>• Flashing green LED every 30 seconds indicates proper operation</li><li>• Red LED with loud 85db alarm indicates presence of CO</li></ul>
<b>Battery Replacement:</b>	Red and green LED flashes, and the unit chirps every 30 seconds. Replace the three AA batteries with one of the following brands. <ul style="list-style-type: none"><li>• Duracell MN1500</li><li>• Energizer E91</li><li>• Rayovac 815</li></ul>
<b>Unit Malfunction:</b>	Red light flashes, and the unit chirps every 30 seconds indicates a unit error. Refer to page 7.
<b>Test/Reset Button:</b>	Test button verifies proper unit

## Product Specifications (cont.)

---

operation.

**Size & Weight:** 140mm diameter x 35.5mm depth  
0.3Kg with batteries

**Warranty:** Five-year warranty from date of purchase against defects in material and workmanship on CO Alarm unit.

**Battery Life:** When in alarm mode, this device will continue to alarm for 405 hours before the batteries require replacement.

## Warranty

.....WARRANTY COVERAGE: THE MANUFACTURER WARRANTS TO THE ORIGINAL CONSUMER PURCHASER, THAT THIS PRODUCT WILL BE FREE OF DEFECTS IN MATERIAL AND WORKMANSHIP FOR A PERIOD OF FIVE (5) YEARS FROM DATE OF PURCHASE. THE MANUFACTURER'S LIABILITY HEREUNDER IS LIMITED TO REPLACEMENT OF THE PRODUCT. REPAIR OF THE PRODUCT OR REPLACEMENT OF THE PRODUCT WITH REPAIRED PRODUCT AT THE DISCRETION OF THE MANUFACTURE. THIS WARRANTY IS VOID IF THE PRODUCT HAS BEEN DAMAGED BY ACCIDENT, UNREASONABLE USE, NEGLIGENCE, TAMPERING OR OTHER CAUSES NOT ARISING FROM DEFECTS IN MATERIAL OR WORKMANSHIP. THIS WARRANTY EXTENDS TO THE ORIGINAL CONSUMER PURCHASER OF THE PRODUCT ONLY.

Warranty Disclaimers: Any implied warranties arising out of this sale, including but not limited to the implied warranties of description, merchantability and fitness for a particular purpose, are limited in duration to the above warranty period. In no event shall the Manufacturer be liable for loss of use of this product or for any indirect, special, incidental or consequential damages, or costs, or expenses incurred by the consumer or any other user of this product, whether due to a breach of contract, negligence, strict liability in tort or otherwise. The Manufacturer shall have no liability for any personal injury, property damage or any special, incidental, contingent or consequential damage of any kind resulting from gas leakage, fire or explosion.

This warranty does not affect your statutory rights.

Warranty Performance: During the above warranty period, your product will be replaced with a comparable product if the defective product is returned, postage prepaid, to Kidde Safety Europe Ltd, Mathisen Way, Colnbrook, Slough SL3 0HB. Telephone 01753 685148, together with proof of purchase date. Please include a note describing the problem when you return the unit. The replacement product will be in warranty for the remainder of the original warranty period or for six months, whichever is longer. Other than the cost of postage, no charge will be made for replacement of the defective product.

Important: Do not remove back cover. Back cover removal will void warranty.

Your Carbon Monoxide Alarm is not a substitute for property, disability, life or other insurance of any kind. Appropriate insurance coverage is your responsibility. Consult your insurance agent.

Kidde makes no warranty, express or implied, written or oral, including that of merchantability or fitness for any particular purpose, with respect to the battery.

**For Warranty Service:**

In many cases the quickest way to exchange your CO alarm is to return it to the original place of purchase. If you have questions, call the Kidde customer service department at on 0800 917 0722.

**WARNING:**

Apparatus conforming to this standard may not protect people who are at special risk from carbon monoxide exposure by reason of age. Pregnancy or medical condition. If in doubt consult your medical practitioner.

**WARNING:** A carbon monoxide alarm is not a substitute for a smoke alarm or a combustible gas alarm.

**Inleiding koolmonoxide . . . . . Pagina 23**

***For questions concerning your Carbon Monoxide Alarm,  
please call Kidde Safety Europe Limited on  
01753 685148 or fax 01753 685096***

***Please have the following information ready when calling:***

CO Alarm Model Number (Located on the back of alarm):
CO Alarm Assembly Number (Located on back of alarm):
Date of Manufacture (Located on back of alarm):
Date of Purchase:
Where Purchased:

This owners manual should be read, in full and retained  
for the life of the product.  
It should also be passed on to any subsequent owner.