

## INSTALLATION & MAINTENANCE MANUAL VFRxxxx



**230V**  
50Hz



**IP**  
65

**IP**  
20



**ML**  
ACCESSORIES LTD



**CE**



08

# GENERAL INSTRUCTIONS

These instructions should be read carefully and retained after installation by the end-user for future reference and maintenance.

These instructions should be used to aid the installation of the following products:

VFRDGICxx / VFRSGICxx / VFRSHGICxx

## SAFETY

- This product must be installed in accordance with the latest edition of the IEE Wiring Regulations (BS7671) and current Building Regulations. If in any doubt, consult a qualified electrician
- Please isolate mains prior to installation or maintenance
- Please note the IP (Ingress Protection) rating of this fitting when deciding the location for installation
- If used under insulation, the insulation should be laid unbroken over the fitting (not packed around it). Only mineral wool style insulation may be used
- This product is Class I and must be earthed
- The VFRDGICxx and VFRSGICxx series is IP20 rated and, the VFRSHGICxx series is IP65 rated

## INSTALLATION

- Provide power to the required point of installation
- Cut a suitable hole in the mounting surface as per the cut-out details (see Fig. 1) ensuring not to infringe with any joists, gas/water pipes or electrical cables

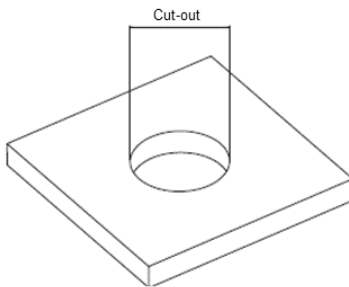

Fig. 1

Part code	Cut-out
VFRDGICxx	72mm
VFRSGICxx	84mm
VFRSHGICxx	70mm

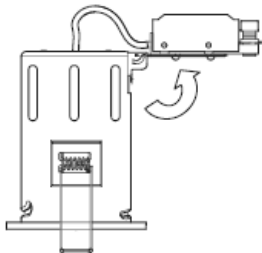

Fig. 2

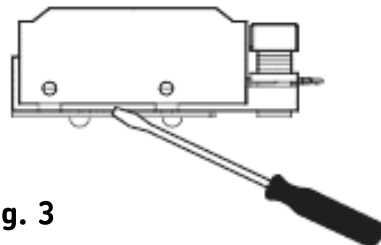
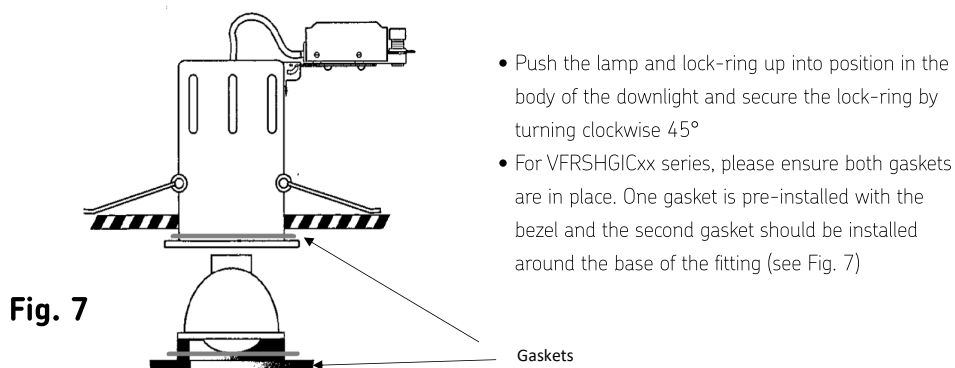
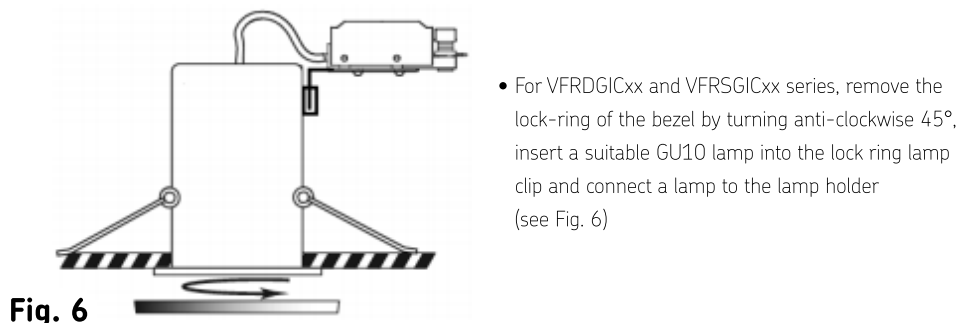
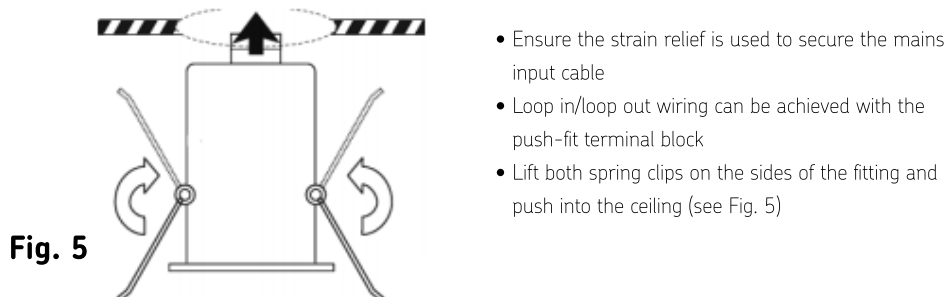
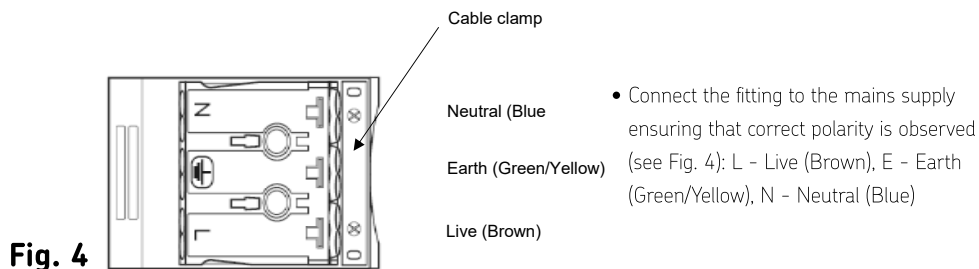

Fig. 3

- Fold-out the terminal bracket until it locks into position (see Fig. 2)
- Remove the terminal access cover with the aid of a slotted screwdriver (see Fig. 3)



- Remove the bezel by turning anti-clockwise 90°, insert a suitable GU10 lamp into the clip (please note, the bezel is designed for the lamp to sit on top and not inside)
- Secure the lamp into the GU10 lamp holder
- Push the bezel and lamp into position with the fitting and secure bezel by turning 90° clockwise
- Switch on and check for correct operation

## GENERAL

This product should be recycled in the correct manner when it reaches the end of its life. Check local authorities for where facilities exist.

Clean with a soft dry cloth only, do not use aggressive cleaning products or solvents which may damage the product.

This product is dimmable dependent on lamp type.

## WARRANTY

This product has a warranty of 1 year from date of purchase. Failure to install this product in accordance with the current edition of the IEE Wiring Regulations (BS7671), improper use, or removal of the batch code will invalidate the warranty. If this product should fail within its warranty period it should be returned to the place of purchase for a free of charge replacement. ML Accessories does not accept responsibility for any installation costs associated with the replacement product. Your statutory rights are not affected. ML Accessories reserve the right to alter product specification without prior notice.