

INSTALLATION & MAINTENANCE MANUAL

CPLxx

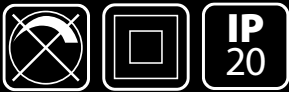

ML
ACCESSORIES LTD

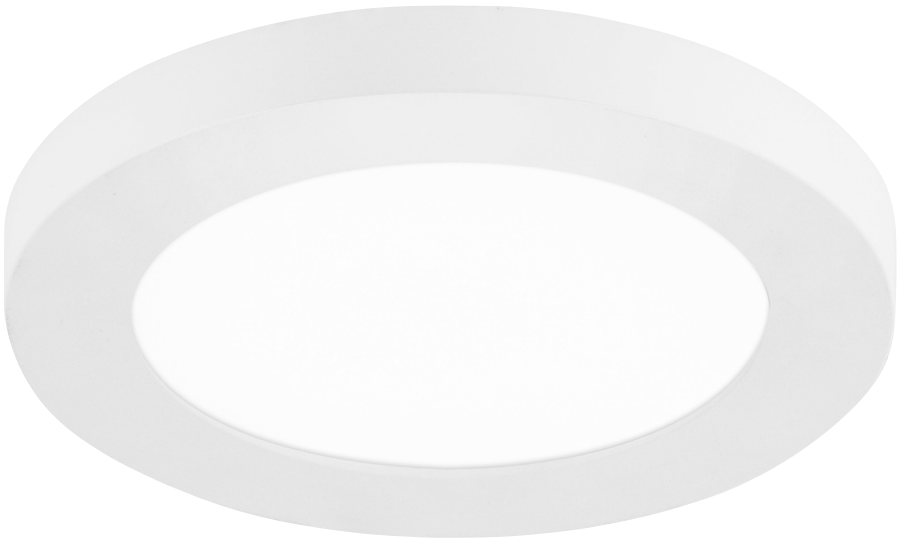

CE



127

GENERAL INSTRUCTIONS

These instructions should be read carefully and retained after installation by the end user for future reference and maintenance.

These instructions should be used to aid installation of the following products:

CPL6CT / CPL12CT / CPL18CT / CPL24CT

SAFETY

- This product must be installed in accordance with the latest edition of the IEE Wiring Regulations (BS7671) and current Building Regulations. If in any doubt, consult a qualified electrician
- Please isolate mains prior to installation or maintenance
- Check the total load on the circuit (including when this luminaire is fitted) does not exceed the rating of the circuit cable, fuse or circuit breaker
- Please note the IP (Ingress Protection) rating of this luminaire when deciding the location for installation
- This product is Class II double insulated
- This product series is IP20 rated

INSTALLATION

Note - If this luminaire is being used in conjunction with an external PIR or sensor, please confirm with the manufacturer of the sensors that they are compatible with LED luminaires

Surface mounting

Note - When surface mounting, the installer must ensure that the bracket is secured and, if needed, other fixings should be used depending on the installation conditions.

- Provide power to the required point of installation
- Remove the bracket from the luminaire by pulling simultaneously at both ends - do not pull from the centre of the bracket
- Fix the bracket to the ceiling using the screws and plugs provided
- Connect the luminaire to the mains supply ensuring that correct polarity is observed: Live (brown) and Neutral (blue). An appropriate junction box should be used (not supplied). It may be necessary to make a hole in the ceiling in order to recess the junction box
- Select the required colour temperature via the switch on the rear of the fitting (see Colour Temperature Adjustment)
- Push the luminaire directly onto the bracket (see Fig. 1)

- Switch on and check for correct operation

Fig. 1



Recessed installation

Note – The clips on these luminaires are designed for recessed installation in ceilings with a thickness between 4mm - 15mm. The design of the clips will safely work on thicker materials, however, confirmation and testing should be carried out prior to installation.

- Provide power to the required point of installation
- Remove the bracket from the luminaire by pulling simultaneously at both ends - do not pull from the centre of the bracket
- This luminaire can be mounted beneath a cut-out of the following dimensions:

Product code	Cut-out dimensions (mm)
CPL6CT	55 - 100
CPL12CT	55 - 125
CPL18CT	55 - 175
CPL24CT	55 - 250

- If cutting a hole in the ceiling, please ensure not to infringe with any joists, gas/water pipes or electrical cables
- Insert the springs into the bracket and slide to the required position according to the size of the cut-out (see Fig. 2)

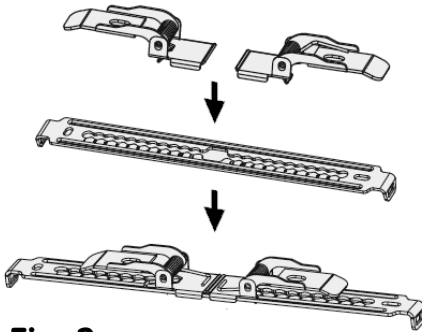

Fig. 2

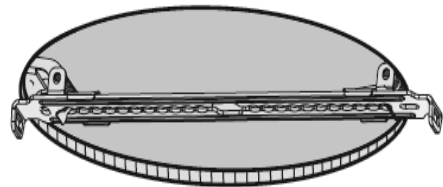

Fig. 3

- Lift both springs and fit into the ceiling (see Fig. 3)
- Connect the luminaire to the mains supply ensuring that correct polarity is observed: Live (brown) and Neutral (blue). An appropriate junction box should be used (not supplied)
- Select the required colour temperature via the switch on the rear of the fitting (see Colour Temperature Adjustment)
- Push the luminaire directly onto the bracket (see Fig. 4)

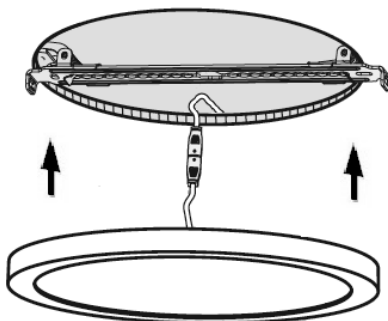

Fig. 4

- Switch on and check for correct operation
- A range of magnetic bezels are available for this luminaire range, please note these bezels are not vandal-proof.

Colour Temperature Adjustment

The colour temperature may be set by means of a switch on the rear of the luminaire. The options are: WW (warm white), CW (cool white), DL (daylight) and SWITCH

The SWITCH option allows the colour temperature to be controlled from an external wall switch. Switch the luminaire off and on again repeatedly until the desired colour temperature is achieved. - then switch off and leave off for at least 5 seconds to save the setting

WARNING

This luminaire must be disconnected from the circuit if subjected to any high voltage or insulation resistance testing. Irreparable damage will occur if this instruction is not followed

GENERAL

The LED lamps fitted in this product are non-replaceable. The product should be recycled in the correct manner when it reaches the end of its life. Check local authorities for where facilities exist

Clean with a soft dry cloth only, do not use aggressive cleaning products or solvents which may damage the product

This product is non-dimmable

WARRANTY

This product has a warranty of 3 years from date of purchase. Failure to install this product in accordance with the current edition of the IEE Wiring Regulations (BS7671), improper use, or removal of the batch code will invalidate the warranty. If this product should fail within its warranty period it should be returned to the place of purchase for a free of charge replacement. ML Accessories does not accept responsibility for any installation costs associated with the replacement product. Your statutory rights are not affected. ML Accessories reserve the right to alter product specification without prior notice.