

LTB018BP - Mini LED Oval Bulkhead IP65 9/12/18W CCT with PIR Sensor- Black

CCT
3000K/4000K
6500K

POWER
SELECTABLE
9W/12W/18W

AC
220V
240V

Hz
50/60

1.100
1.500
2.100
LUMEN

IP65
RATED

CRI
>80

PC
Body &
Diffuser

IK08



115°

-15° +40°

RoHS
COMPLIANT





UK
CA

Please read these instructions and retain them for future reference.

Important information:

It is recommended that this fitting is installed by a qualified electrician ensuring the installation complies with current IEE wiring regulations & local building control.

- This product is designed for connection to a 220-240V mains supply.
- Only mount on level and stable surfaces.
- Ensure sufficient ventilation of the product.
- This product is not suitable for dimming.
- We cannot accept responsibility for any claims arising from a poor installation.
- Always switch off mains supply before installation.
- The light fitting is Class II and does not require an earth connection.

CCT & Power Changeable:

 Switch off the mains supply before changing power or CCT

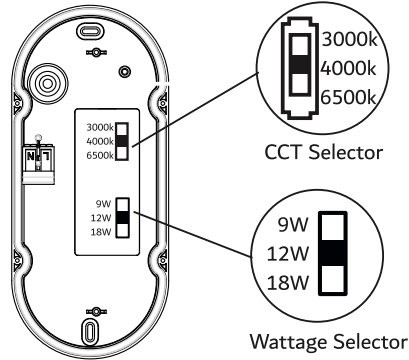

TECHNICAL SPECIFICATIONS:

- Input Voltage: 220-240V/AC
- Multi Power: 9W / 12W / 18W
- CCT Changeable (switch): 3000K/4000K/6500K
- Efficacy: >120lm/W
- Light Output: 1100lm/1500lm/2100lm
- CRI > 80
- Beam Angle: 115°
- IP Rating: IP65
- Protection Class: Class II
- Housing: PC Base & Diffuser
- Operating Temp.: -15°C to +40°C
- IK Rating: IK08
- Built-in PIR Sensor
- Warranty: 5 years

Dimensions:

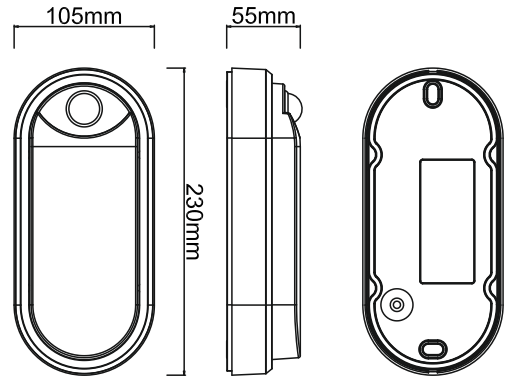

Installation Instructions:

1. Switch OFF the mains supply. Remove the trim of the fitting.
2. Using a screwdriver remove the cover of the fitting.
3. Identify the location and direction of any hidden supply cables or service pipes before drilling fixing holes. Use the two designated points from the fixture as spacing between the holes. Ensure the fitting is level and the wall is capable of holding the weight of the product.
4. Connect the luminaire to the mains supply using the piano terminal block inside the luminaire.
5. Fix the luminaire into the suitable position. Use the round rubber rings around the screws from inside of the luminaire to make it waterproof.
6. Clip the trim back onto the fitting and turn on mains supply ON to test it.

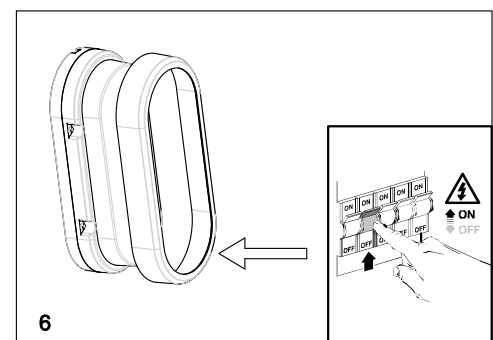
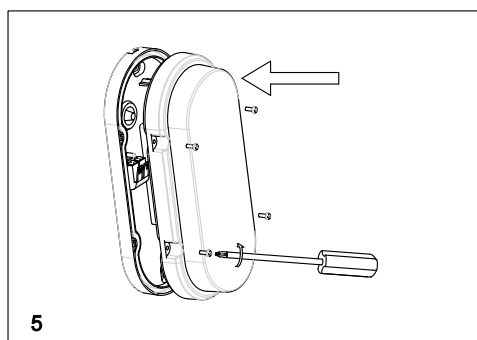
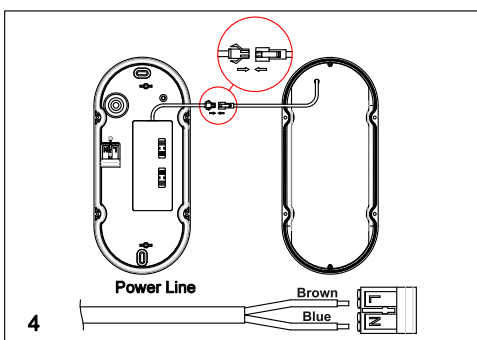
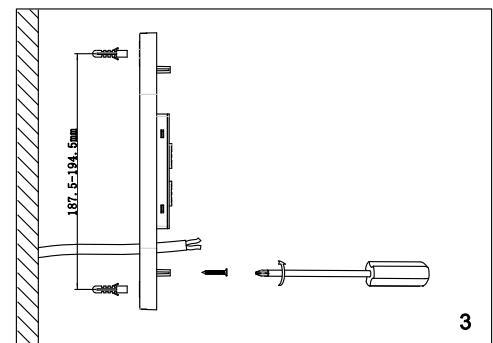
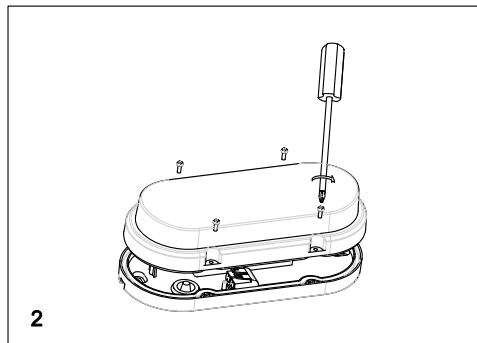
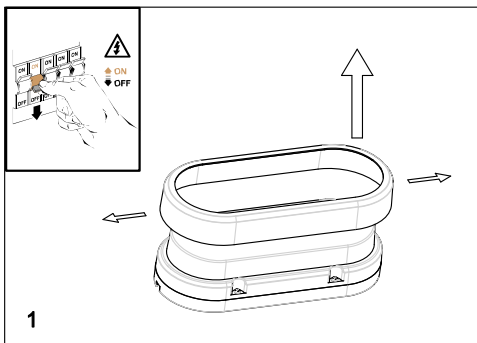

PIR SENSOR Features	
Detection Range	Max 4M
Detection Angle	120°
Time Adjustment	Hold time 5s/90s/5mins/10mins Stand-by period 0s/10s/15min/+∞
Ambient Light	Disabled or 25Lux
Max mounting height	3M

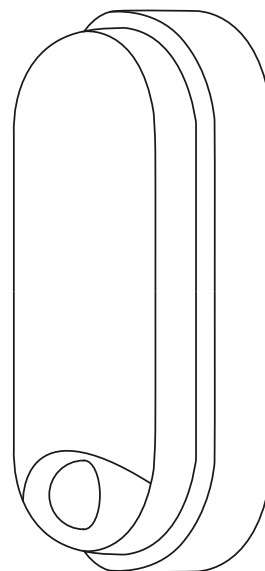

PIR Settings

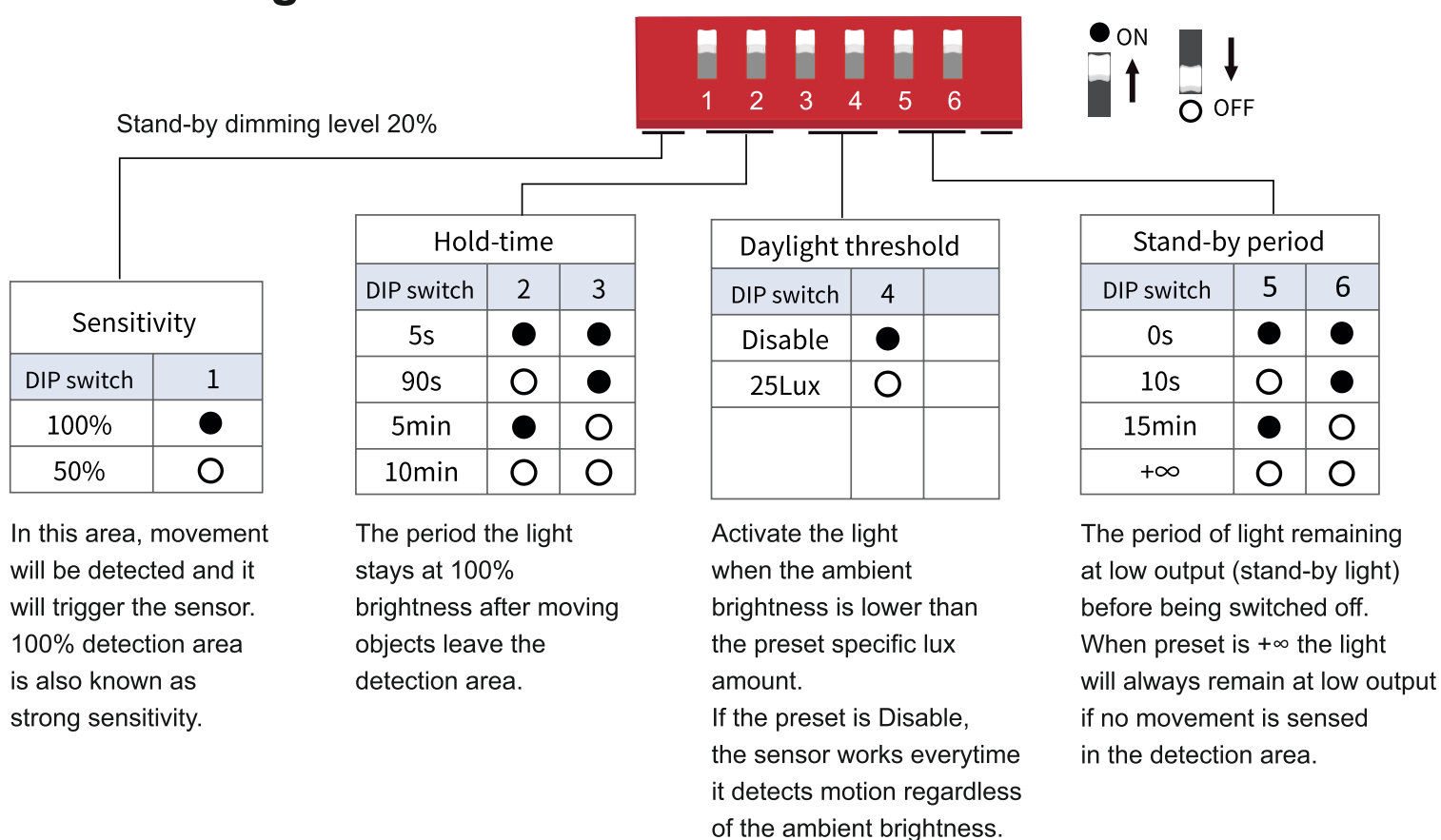

Factory Settings:

1 - on, 2 - off, 3 - on, 4 - on, 5 - on, 6 - on

