



LTDL3NML

3W LED Non Maintained Emergency Downlight

The LTDL3NML emergency downlight is designed mainly for commercial, retail, and open areas applications. It has a low profile design and it is a non-maintained yet high output LED (emergency downlight). Ideal for use in corridors, stairwells and other places that require a smart, discrete emergency unit.

Features & Benefits:

- Ceiling Recessed Mounting
- Matt Silver & White Trims Included
- Compact Design
- Pre-wired for Easy Installation
- Long-Life Lithium LiFePO4 Battery

Wiring Diagram:

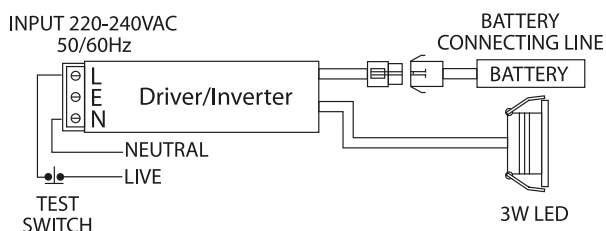

Dimensions(mm):

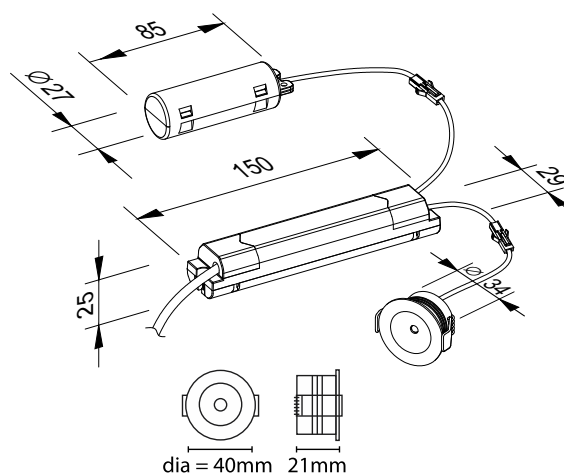

Technical Specifications:

Input Voltage:	220-240 V/AC	Protection Class:	Class II
Power:	3W	Housing:	Aluminium Head & PC Body
Light Output:	120lm	Trim:	White & Matt Silver Included
Mode:	Non-Maintained	Mounting:	Ceiling Recessed
Discharge Duration:	>3 Hours	Cut-out:	Ø34mm
CCT:	5500K	Battery Type:	LiFePO4 3.2V 1500mAh
CRI:	>85	Protection:	Over Charge & Discharge
IP Rating:	IP20	Warranty:	3 years

