

LTH10RGBW - RGBW Colour Changing Harness

IP65  220-240V

Please read these instructions before commencing installation & retain them for future reference.

Important information

- These products are designed for connection to a 220-240V mains supply.
- Any broken or damaged parts should be replaced as soon as possible.
- We will not accept responsibility for any claims arising from a poor installation.

To reduce risk of fire, electric shock or injury to persons, please strictly adhere to the instructions below:

- Keep combustible material away from lamps. Do not allow lamps or sockets to come into contact with walls, ceiling, fabrics and other materials. Lamps should hang freely in downwards direction.
- Make sure the linking socket is covered or closed.
- If cable is damaged do not use & replace as soon as possible.
- Replace lamps with RGBW lamps only.





SPECIFICATIONS:

- Voltage range: 220-240 V/AC
- Frequency: 50/60 Hz
- Output Voltage: DC 12V
- Ingress Protection: IP65
- Single RGBW Lamp Power: 0.5W
- 20 RGBW Lamps included
- Lamp cap: Three-core lamp cap
- Control Mode: Touch Button and Remote Control
- 3 metres lead-in to the first lampholder
- 50 cm spacing between lampholders
- 20 lampholders / 10 metres
- Cable Type: 3 core VW-1 Cable
- Link up to 3 harnesses together

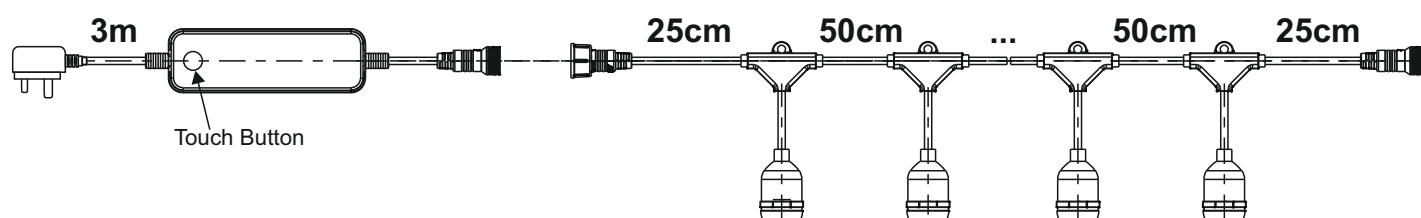
REMOTE CONTROL SPECIFICATIONS:

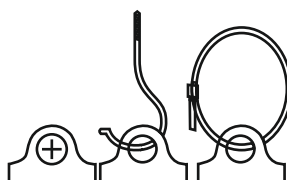
- Control Distance: up to 8m
- Remote Control Mode: RF
- Remote Control Frequency: 433MHz
- Number of Keys: 24 keys
- Modes: 4 modes adjustable
- Brightness and speed adjustments
- Battery Type: CR2025

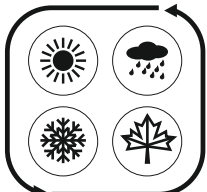

<p>FLEXIBLE MOUNTING OPTIONS Mount on a flat surface or hang from above. Mounting hardware not included.</p> 	<p>CONNECT MULTIPLE STRINGS Link up to 3 harnesses together.</p> 	<p>20 RGBW LAMPS</p> 
<p>WEATHERPROOF. IP65 RATED</p> 	<ul style="list-style-type: none"> • RGBW Harnesses for outdoor use • 10m and 20 lamps (included) • 3m lead-in to the first lampholder • Replace lamps with RGBW lamps only 	<p>20 LAMP HOLDERS</p> 

Installation Instructions:

- Install each lamp into the lamp holders by rotating them clockwise. Make sure the lamp is installed tight into the lamp holder.
- Rotate the lamp anti-clockwise if you want to replace it.
- Plug the controller cable to the festoon using the weatherproof connection

⚠ Please be aware that the 2 arrows on the plugs must line up! (Fig. 1)

Fig. 1 Arrows on connector plugs

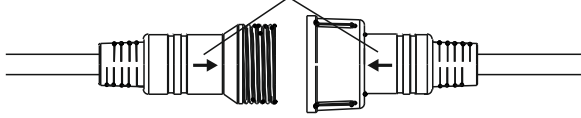

- You can link up to 3 harnesses using the IP65 connectors at each end.
- Plug the harness in to 220-240V socket and turn the light on to test the lights.
- Use the remote control provided to control the light (see below remote control functions)
- All buttons on the remote control have a memory function; after setting the harness will remember the last mode it was set.

Pair Code Function:

In order to prevent a remote control from controlling two or more products, the pair code function can be used:

- Turn the power ON and then press the TOUCH button on the harness controller for 5 seconds.
- The lamps will flash red to indicate the harness is in pairing mode.
- Press the Red button (R) on the remote control and the light will stop flashing.
- The remote control is now paired successfully with the harness controller.

Remote Control Functions

Remote Control Setup:

- Pull plastic protection from battery compartment to activate remote control (see Fig.2).
- The harness is controlled by the RF remote control. Please ensure the remote control aims at the controller when changing colours or modes.
- If the RF remote control becomes insensitive after a period of time or the control distance becomes much shorter please replace the battery (see Fig.3).

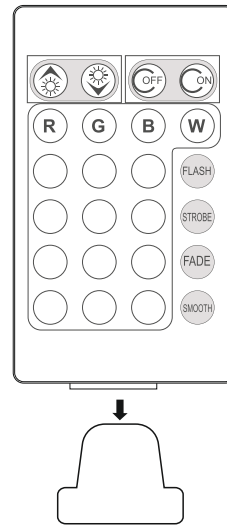

Fig.2

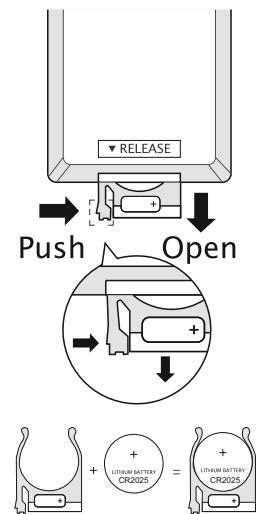
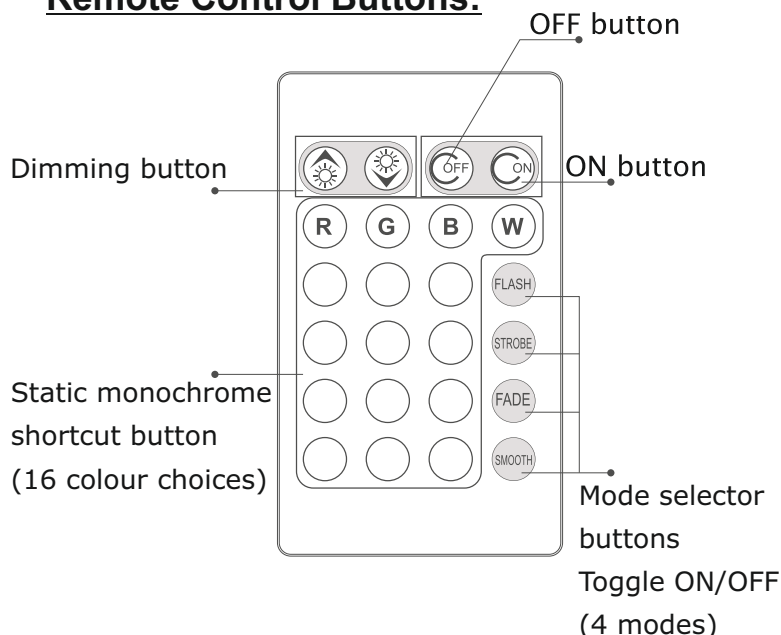

Fig.3

Remote Control Buttons:



ON/OFF Button - Switch the unit on or off.

Dimming - When in static monochrome mode (R, G, B and W) use it to adjust the brightness of the light.

Static Monochrome - Use the buttons to directly select the desired colour (16 choices)

FLASH - Automatic change of colours (fast)

STROBE - Automatic jumping change of colours (slow)

FADE - Fast automatic change of colours with blending effect

SMOOTH - Slow automatic change of colours with blending effect