

## XLH10RGBW - RGBW Colour Changing Harness

IP65 Ⓢ 100-240V

Please read these instructions before commencing installation & retain them for future reference.

### Important information

- These products are designed for connection to a 100-240V mains supply.
- Any broken or damaged parts should be replaced as soon as possible.
- We will not accept responsibility for any claims arising from a poor installation.

To reduce risk of fire, electric shock or injury to persons, please strictly adhere to the instructions below:

- Keep combustible material away from lamps. Do not allow lamps or sockets to come into contact with walls, ceiling, fabrics and other materials. Lamps should hang freely in downwards direction.
- Make sure the linking socket is covered or closed.
- If cable is damaged do not use & replace as soon as possible.
- Replace lamps with RGBW lamps only.





### SPECIFICATIONS:

- Voltage range: 100-240 V/AC
- Frequency: 50/60 Hz
- Output Voltage: DC 12V
- Ingress Protection: IP65
- Single RGBW Lamp Power: 0.5W
- 20 RGBW Lamps included
- Lamp cap: Special 2-Pin Cap
- Control Mode: Button and Remote Control
- 3 metres lead-in to the first lampholder
- 50 cm spacing between lampholders
- 20 lampholders / 10 metres
- Cable Type: 3 core Cable
- Link up to 3 harnesses together

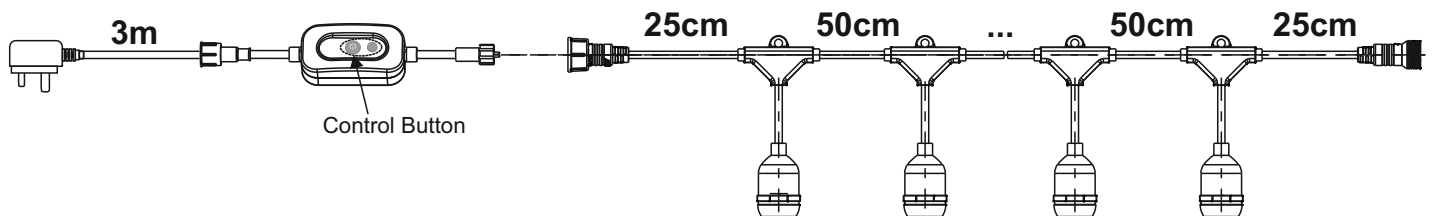
### REMOTE CONTROL SPECIFICATIONS:

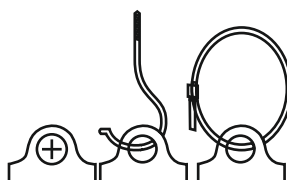
- Control Distance: up to 6m
- Remote Control Mode: RF
- Remote Control Frequency: 433MHz
- Number of Keys: 20 keys
- Modes: 6 modes adjustable
- Brightness and speed adjustments
- Battery Type: CR2025

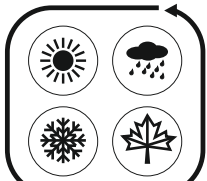

<p><b>FLEXIBLE MOUNTING OPTIONS</b> Mount on a flat surface or hang from above. Mounting hardware not included.</p> 	<p><b>CONNECT MULTIPLE STRINGS</b> Link up to 3 harnesses together.</p> 	
<p><b>WEATHERPROOF. IP65 RATED</b></p> 	<ul style="list-style-type: none"> <li>• RGBW Harnesses for outdoor use</li> <li>• 10m and 20 lamps (included)</li> <li>• 3m lead-in to the first lampholder</li> <li>• Replace lamps with RGBW lamps only</li> </ul>	

## Installation Instructions:

- Install each lamp into the lamp holders

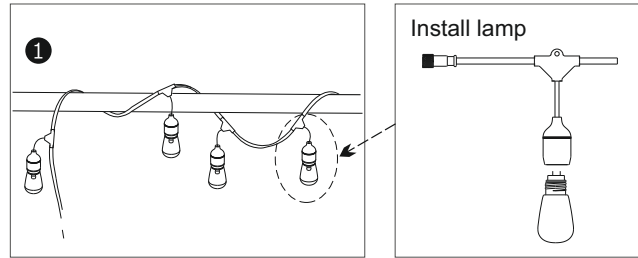

- Insert the lamp in the lamp holder making sure that the guide on the base of the lamp is aligned with the slot on the lamp holder. Then screw the lamp clockwise firmly.
- Replacing the lamp - Unscrew the lamp by rotating it anti-clockwise then pull it out from the lamp holder. Follow the instructions above to install the new lamp.
- Plug the controller cable to the festoon and then to the AC plug using the weatherproof connections.

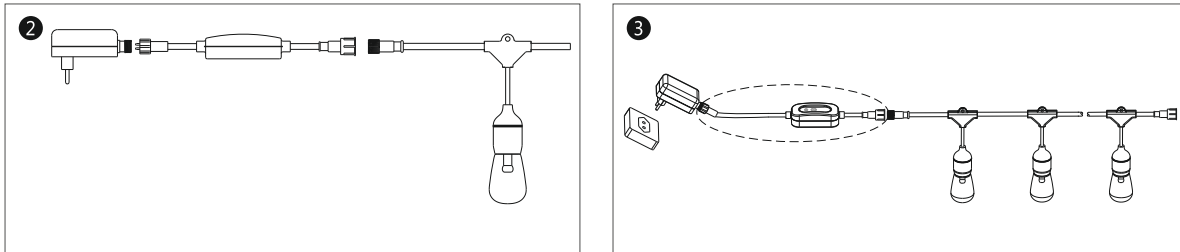

- You can link up to 3 harnesses using the IP65 connectors at each end.
- Plug the harness in to 100-240V socket and turn the light on to test the lights.
- Use the remote control provided to control the light (see below remote control functions)
- All buttons on the remote control have a memory function; after setting the harness will remember the last mode it was set.
- The button on the controller works the same way as the remote, cycling through the colours and the modes.

## Remote Control Functions

### Remote Control Setup:

- Pull plastic protection from battery compartment to activate remote control (see Fig.2).
- The harness is controlled by the RF remote control. Please ensure the remote control aims at the controller when changing colours or modes.
- If the RF remote control becomes insensitive after a period of time or the control distance becomes much shorter please replace the battery (see Fig.3).

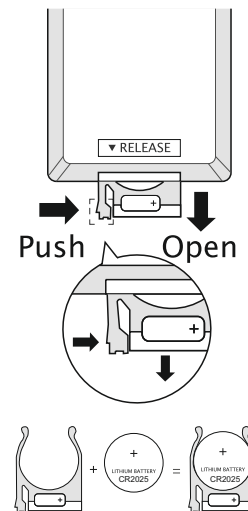
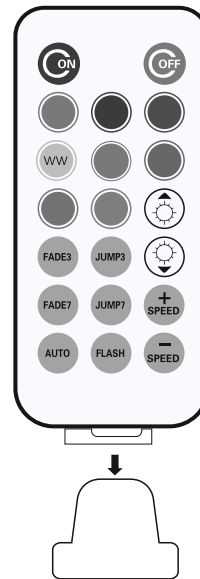

### Remote Control Buttons:

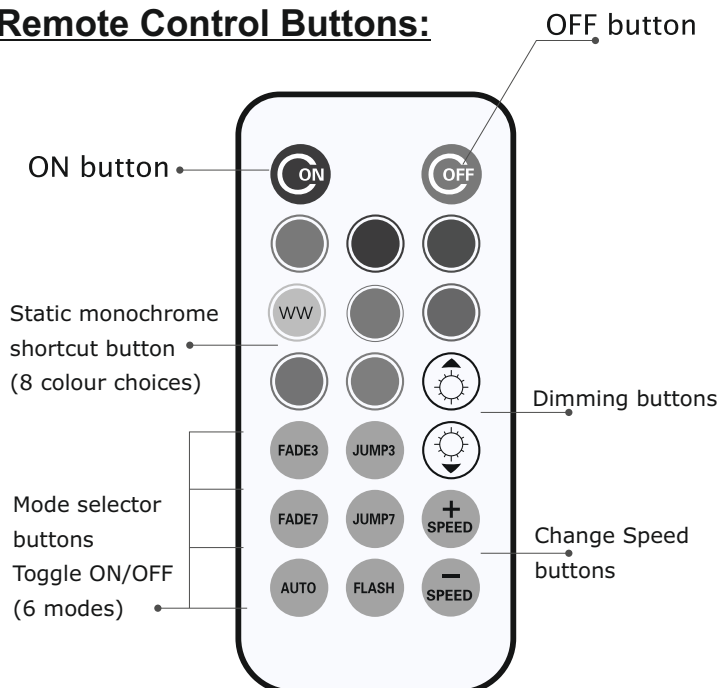

- ON/OFF Button** - Switch the unit on or off.
- Dimming** - Adjusts the brightness of the light when in static monochrome mode
- Static Monochrome** - Use the buttons to directly select the desired colour (8 choices)
- Change Speed** - Increase or Decrease mode speed
- FADE 3/7** - Fast automatic change of colours with blending effect (3 colours / 7 colours)
- FLASH** - Automatic change of colours (fast)
- JUMP 3/7** - Automatic jumping change of colours (3 colours / 7 colours)
- AUTO** - Slow automatic change of colours with blending effect