

## LTFL235 - 20/30/50W LED Floodlight Power Selectable & CCT Changeable

IP65    220-240V

**Please read these instructions before commencing installation & retain them for future reference.**

### Important information

It is recommended that floodlights are installed by a qualified electrician ensuring the installation complies to current IEE wiring regulations & local building control.



- These products are designed for connection to a 220-240V mains supply.
- Any broken or damaged parts should be replaced as soon as possible.
- We will not accept responsibility for any claims arising from a poor installation.

### SPECIFICATIONS:

- **Voltage range:** 220-240 V/AC
- **Frequency:** 50/60 Hz
- **Power Selectable:** 20W / 30W / 50W
- **Lumen Output:** 2000lm/3000lm/5000lm  $\pm$  5%
- **CCT Changeable:** 3000K/4000K/6000K
- **CRI**>80
- **Protection against electric shock:** Class I. Requires earth connection.
- **Ingress Protection:** IP65
- **Slide-in bracket and additional round bracket for easy installation**
- **Material:** Die cast Aluminium body with tempered glass diffuser
- **Ambient temperature range:** -20°C to +40°C

### INSTALLATION INSTRUCTIONS:

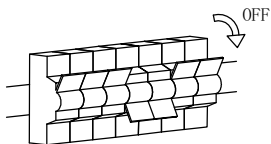
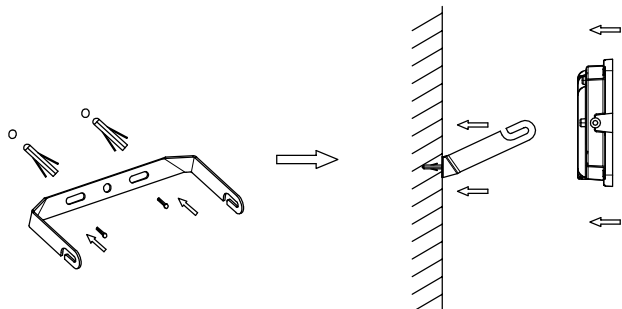
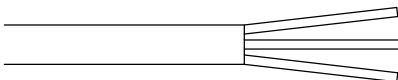
 Always switch off mains supply before servicing.

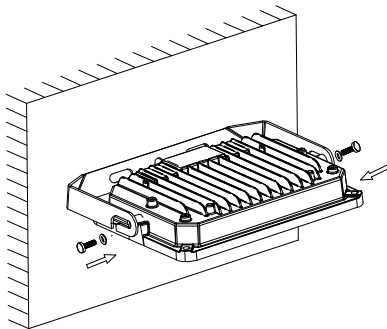
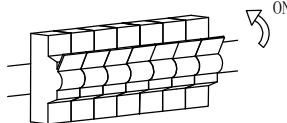
<p>1.</p>  <p>Turn off mains power.</p>	<p>2.</p>  <p>Mark the holes position and mount the bracket on the wall. Slide the floodlight into position.</p>	
<p>3.</p>  <p>Live (L) - Brown Neutral (N) - Blue Earth (E)-  Yellow/Green Input 220-240V/AC, 50/60HZ</p> <p>Terminate loose ends of wire to an appropriate IP Rated junction box or similar, ensuring polarities are observed.</p>	<p>4.</p>  <p>Use the screws provided to fix the floodlight into the bracket.</p>	<p>5.</p>  <p>Turn on mains power and test the floodlight.</p>

## Installing the Additional Bracket:

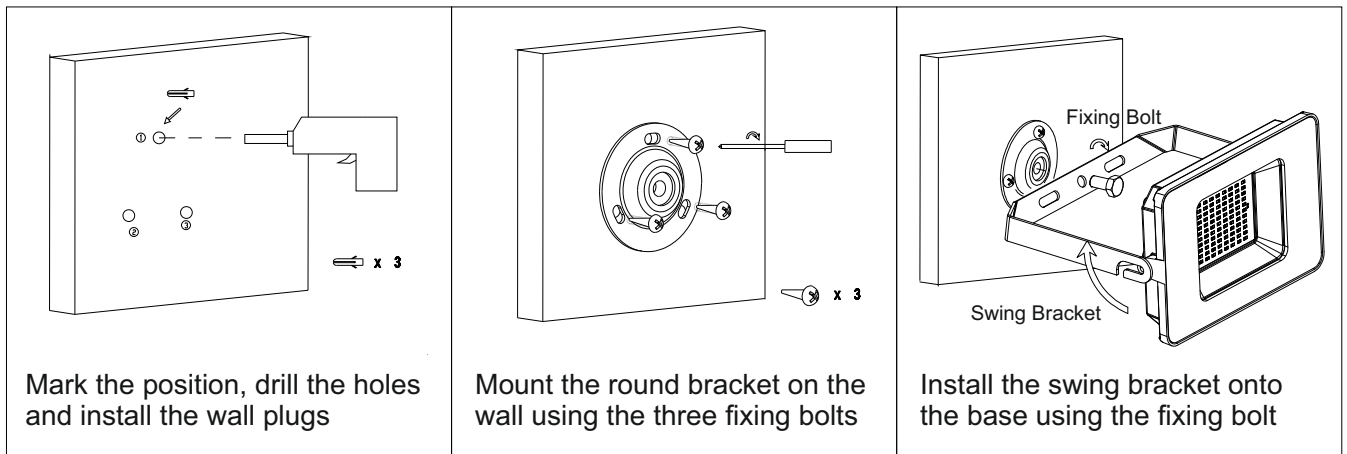

**WARNING:** Ensure all items and screws are secure and fitted correctly.

- This floodlight is not dimmable.
- Floodlights should not be connected in series.

## Changing Power Setting and Colour Temperature:

Use the toggle switches at the bottom of the floodlight to change the power and colour temperature:

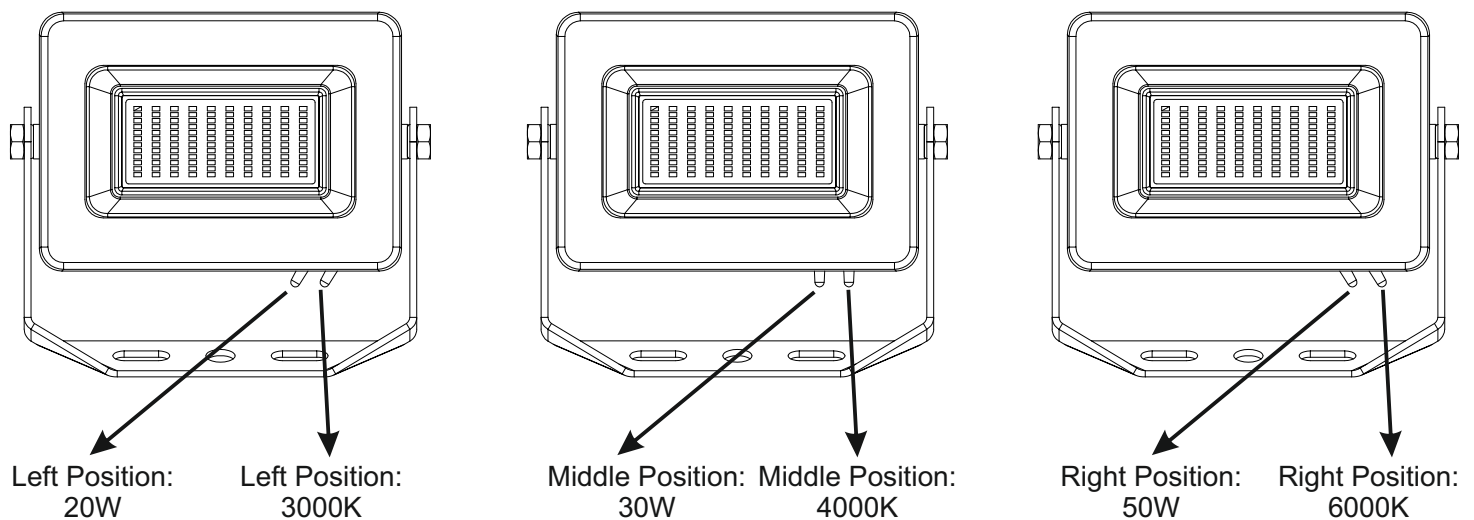

## DIMENSIONS(mm):

