

LTT524H - 5ft T8 LED Compatible Tube for fittings with Starters

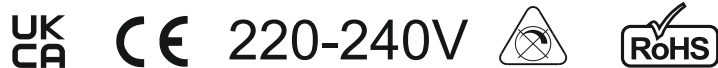

Please read these instructions before use and retain them for future reference.





Important information

It is recommended that the fittings are installed by a qualified electrician ensuring the installation complies to current IEE wiring regulations & local building control.

- These products are designed for connection to a 220-240V mains supply.
- We cannot accept responsibility for any claims arising from a poor installation.

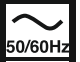
Important User Advice

- Always switch off mains supply before installation.
- The fitting is suitable for indoor use only.
- The T8 LED Tube package contains the LED tube and the LED starter
- The T8 LED Tube is used for replacing 58W T8 fluorescent tubes
- Working temperature: -20°C ~ +45°C
- The T8 LED Tube is compatible with fittings with starters; there's no modifications to be made to the fitting
- This tube is designed for general lighting service (excluding for example explosive atmospheres)

| | | | |
|--|--|--|---|
|  | Lamp is suitable for use in luminaires with magnetic ballasts. |  | Lamp should be used in dry conditions or in a luminaire that provides protection. |
|  | Lamp is not suitable for use in emergency luminaires designed for double-capped fluorescent lamp(s). |  | Lamp is not dimmable. |

Operating instructions for light replacement (for use with Magnetic Ballast)

- Schematic steps of removing the fluorescent lamp and inserting the LED tube designed to retrofit the linear fluorescent lamp

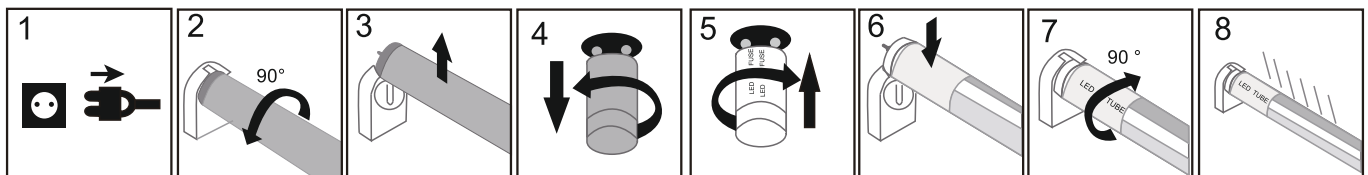

1. Switch off mains supply
2. and 3. Remove the fluorescent lamp
4. Remove the starter
5. Insert the LED replacement starter into the starter holder
6. Insert the LED tube into the lampholder
7. Secure position by turning the tube by 90°
8. Switch on electricity to test the lamp

Wiring diagrams:

1. Tube replacement - Magnetic Ballast

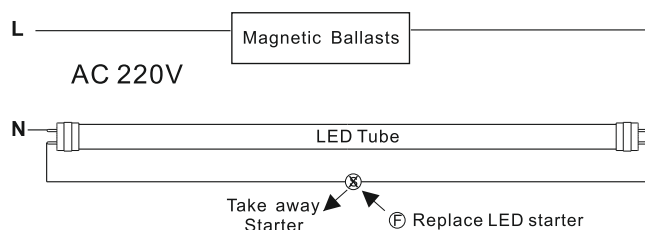

3. Tube installation - LED tube fittings

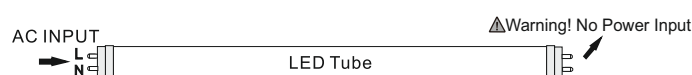

2. Tube replacement - Electronic Ballast

