

INSTALLATION & MAINTENANCE MANUAL
8300DIM

Knightsbridge®
the mark of quality



GENERAL INSTRUCTIONS:

These instructions should be read carefully and retained after installation by the end user for future reference and maintenance.

These instructions should be used to aid installation of the following product:
8300DIM

SAFETY:

- Installation of this product should only be carried out by a qualified electrician or competent person to the current Building and IEE Wiring Regulations (BS7671)
- Please isolate mains prior to installation/maintenance
- Check the total load on the circuit, including when this product is fitted, does not exceed the rating of the circuit cable, fuse or circuit breaker
- Please note the IP (Ingress of Protection) rating of this product when deciding the location for installation
- This product is Class I and requires an earth
- This product is IP20 rated
- This product is dimmable (with a dimmable lamp/luminaire)
- For use with Filament lamps only
- Min 50W – Max 250W

INSTALLATION:

- Provide power to the point of installation, suitable IP rated junction boxes should be used where required
- Mark the location of the fixing holes and drill the holes ensuring not to infringe with any joists, gas or water pipes or electrical cables

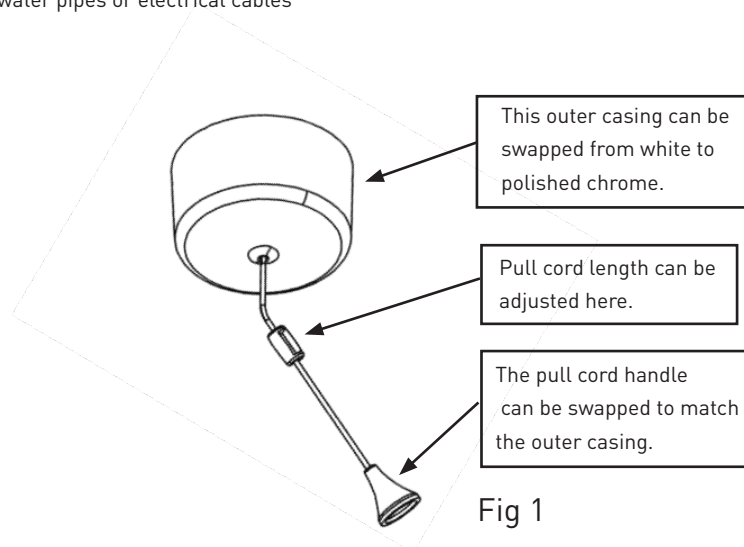

- Unscrew the top cover to gain access to the connections
- Feed the cable via the entry point on the base of the pull switch
- Connect the permanent Live (brown), Earth (yellow/green) and Switched Live to the terminals (see Fig 2)

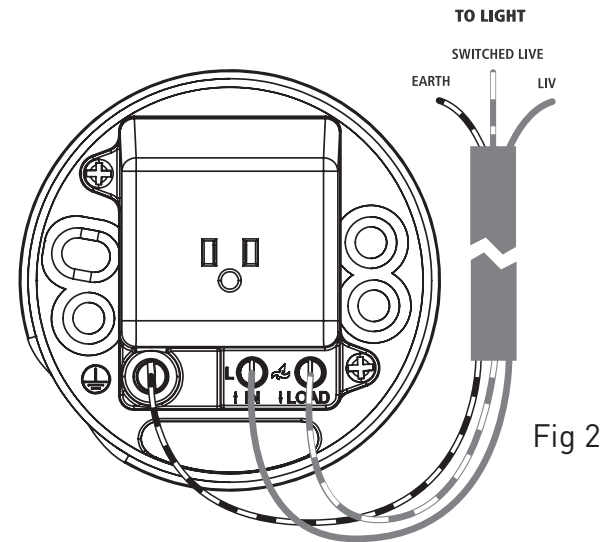

- Screw outer casing to the base
- Adjust the cord to the desired length (see Fig 1)
- Switch on power supply and check for correct operation
- Dimming is achieved by pulling the cord and releasing when the desired light level is achieved

WARNING:

This product is not LED compatible

GENERAL:

Clean with a soft dry cloth only, do not use aggressive cleaning products or solvents which may damage the fitting

WARRANTY:

This product has a warranty of 1 year from date of purchase. Failure to install this product in accordance with the current edition of the IEE Wiring Regulations, improper use, or removal of the batch codes will invalidate the warranty. If this product should fail within its warranty period it should be returned to the place of purchase for a free of charge replacement. ML Accessories does not accept responsibility for any installation costs associated with the replacement product. Your statutory rights are not affected. ML Accessories reserve the right to alter product specification without prior notice.