



# **EH1418**

## **Compressor Dehumidifier**



**10 l per day moisture removal capacity**  
**Electronic humidistat control**  
**Washable air filter**

# IMPORTANT

## Installer and Users please note:

These instructions should be read carefully and left with the user of the product for future reference.

## BEFORE USE

You must inspect the product including its cable and plug for any signs of damage. If the product is damaged, DO NOT use it, and contact your supplier immediately.

## INSTALLATION

Place the appliance on a firm, flat level surface.

If continuous drainage is to be used, unscrew and remove the bung from the drainage port (on the back of the appliance, half-way up, on the right-hand side), and connect a drainage hose to the port. Use a hose with an internal diameter of 12mm (½"). Make sure that the hose runs downwards throughout its entire length, and has no kinks. Otherwise the drainage will not work.

The bung can be stored in the bucket in case it is required at a later date. Make sure that the bucket is fitted correctly into the housing.

## OPERATION

- Plug the mains lead into a 13 Amp mains socket.
- If connecting via an extension lead, make sure that the lead is rated at 3 Amps, and that it is fully unwound.
- Place the appliance on a firm flat level surface.
- Switch the appliance on at the mains socket. Then press the power switch to start operation. The appliance will wait for 3 minutes whilst the refrigerant settles before starting to operate, this is to extend the life of the compressor.
- Using the + and – buttons, set the required humidity level on the display. The level can be set between 35% and 80% in 5% increments. The appliance will remove humidity from the air whenever the humidity level is higher than the set level.

After a delay of 5 seconds, the display changes to showing the present room humidity level.

- To select continuous operation, press the **CONT.** button. The appliance will continuously remove humidity from the air regardless of the humidity

level. Press the **CONT.** button again to stop continuous operation.

- Take particular care if selecting continuous operation when continuous drainage is being used. It will lead to a continuous reduction of humidity levels; which, if the humidity becomes too low, may lead to the cracking of delicate wooden items.
- If operating at an ambient temperature below 10 °C, the internal heat exchanger will drop below 0 °C, causing ice to form. If this happens, the appliance will automatically defrost: when this happens **F1** will be shown in the display.
- Unplug the appliance from the mains when not in use. (Do not disconnect whilst still operating, move the rotary control to the OFF position first)
- Check the appliance regularly for damage and cease using it immediately if any damage to the product, the cable or the mains plug is found.
- The appliance operates best if it is in an enclosed area. Close all doors and windows, and eliminate sources of additional humidity, such as cooking, clothes drying. Cover fish tanks.
- The most comfortable setting for the humidity level is around 50%.

## EMPTYING THE COLLECTED WATER

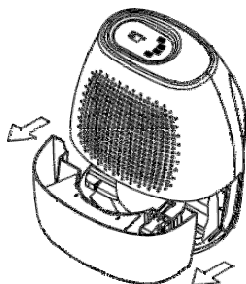

- If not using a drainage hose, empty the bucket when the "WATER FULL" indicator lights.
- Pull the bucket out a little.

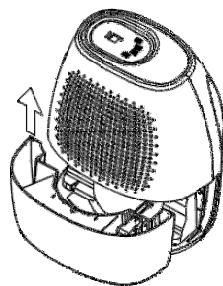

- Lift the bucket upwards.
- Empty the water down a drain.

## **STORAGE**

If the appliance is not going to be used for a long time:

1. Empty and clean the bucket.
2. Unplug from the mains
3. Clean the appliance
4. Store in its original packaging

## **PRODUCT SAFETY**

- This appliance is not intended for use by persons (including children) with reduced physical, sensory or mental capabilities, or lack of experience and knowledge, unless they have been given supervision or instruction concerning use of the appliance by a person responsible for their safety.
- Children should be supervised to ensure that they do not play with the appliance
- Place the appliance on a firm flat stable surface.
- Make sure that air intakes and exhausts are not obstructed.
- For indoor use only.
- Do not place this appliance within 400mm (16") of curtains or similar items.
- Ensure that the appliance stands upright at all times.
- Do not use this appliance in the immediate surroundings of a bath, shower or swimming pool.
- Do not place the mains lead beneath a carpet or rug.
- Do not use this appliance in locations where paint, petrol or other flammable liquids are used or stored.
- Do not insert any object into this appliance through the grilles. This may damage the heater or result in overheating or electric shock.
- Do not turn off the mains supply when the appliance is running. Always turn the rotary humidistat control to the OFF position, and wait 3 minutes before disconnecting the mains supply. This protects the compressor from damage.
- Do not leave the product unattended for long periods of time.
- Ensure that the product does not tip over whilst there is water in the bucket.

## FLUORINATED GASES

The appliance contains refrigerant gas which is subject to control under the *Fluorinated Greenhouse Gases Regulations 2009*. It is a criminal offence knowingly to allow the refrigerant gas to leak to the atmosphere. It is also a criminal offence to work on the product unless suitably qualified.

## PAT TESTING

When used in a workplace, this product must be safety-tested yearly by a qualified electrician (PAT Tested) in order to comply with the Electricity at Work Regulations.

We recommend that it is PAT tested regularly when used in a domestic environment.

## GENERAL SAFETY REQUIREMENTS

Domestic wiring must be tested periodically by a qualified electrician at least once every 10 years or at every change of occupancy.

For office and retail premises, and buildings such as village halls, the wiring must be inspected at least once every 5 years.

It is recommended that all buildings be fitted with smoke alarms (it is mandatory for new buildings).

## MAINTENANCE

- Before cleaning, turn the appliance off, and disconnect from the mains supply. The appliance may then be cleaned using a damp cloth with a drop of washing-up liquid to remove any dust or dirt from the case. Do not use stronger detergents or solvents as these may damage the surface finish.
- Clean the inside of the bucket to prevent the build-up of bacteria.
- Using a dry 1" (25mm) paint-brush, remove any dust from the grilles.
- The filter should be cleaned every fortnight (or more often if the atmosphere is particularly dusty).

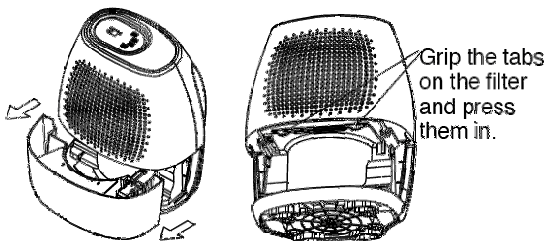

To clean the filter, first remove the bucket, the tab of the filter will then be visible behind the front grille.

Press the tabs inwards, and pull downwards firmly to remove the filter. Clean the filter with a vacuum cleaner, or wash in warm water with a drop of washing-up liquid.

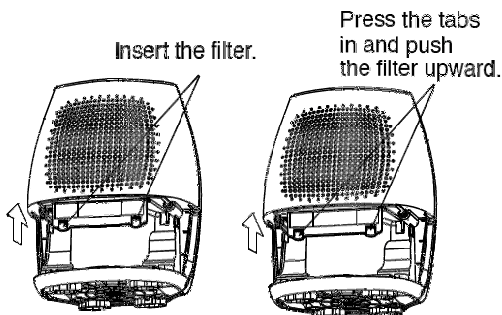
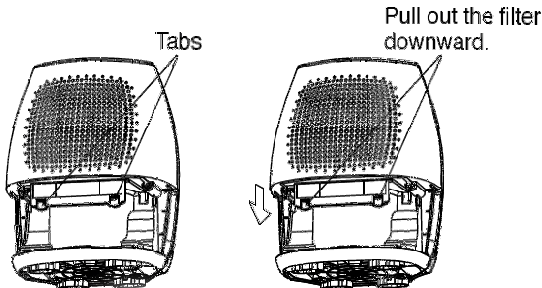

Ensure that the filter is completely dry before replacing.

• If the mains lead is damaged, it must be replaced by the manufacturer or an authorised service centre. If the mains plug needs to be replaced, proceed as follows:

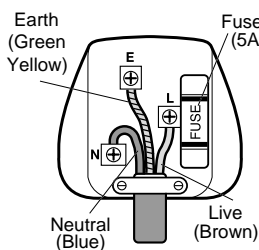

- Connect the brown wire to the terminal labelled "L".
- Connect the blue wire to the terminal labelled "N".
- Connect the green/yellow wire to the terminal labelled with the earth symbol or "E".
- Make sure that the cord-grip is positioned correctly (over the outer sheath of the cable) and it fully tightened.

• If the plug is fitted with a 13 A fuse, replace it by a 5 A fuse.

## FAULT FINDING

**Appliance does not operate when switched on:**

• There is a 3 minute delay before the compressor starts. This is to protect the compressor.

**Appliance stops operating and "FULL" indicator lights.**

• Bucket is full of water - empty the water as shown on page 6. Do not drink the water (it may be used for watering plants).

- Bucket is not replaced properly. Ensure that the bucket is correctly aligned with the housing.

**Appliance stops operating and P<sup>1</sup> is displayed.**

- This happens if the temperature is lower than 10 °C, and ice begins to form on the internal heat exchanger. The defrost cycle will last for a few minutes, and then operation will resume.

**Appliance operates intermittently.**

- The humidity in the room has reached the level set on the humidistat control.

**Very little water is extracted.**

- There is very little humidity in the air (this happens during dry sunny weather, and also during very cold weather). Condensation on windows is caused by the difference between indoor and outdoor temperatures, and is not a good indicator of the level of humidity.

**The room remains humid and little water is extracted**

- The humidity setting is too high, press the – button to reduce the required humidity level.
- The area to be dehumidified is too large

## **FAULT CODES**

F<sup>1</sup> Humidity sensor fault.

F<sup>2</sup> Temperature sensor fault.

If either of these faults is detected, stop the appliance by pressing the power button. When it has stopped, switch off at the mains socket and wait 3 minutes. Switch back on, and restart the appliance. If the fault repeats contact your dealer.

P<sup>1</sup> Appliance is defrosting: This happens if the temperature is lower than 10 °C, and ice begins to form on the internal heat exchanger. The defrost cycle will last for a few minutes, and then operation will resume.

P<sup>2</sup> Bucket fault. Either the bucket is full, or it is misaligned. Empty the bucket and make sure it is correctly positioned in the appliance.

## **OPERATING COSTS**

At time of going to press, the average cost of electricity is £0.11 per unit (kilowatt-hour). The amount you are being charged will be shown on your electricity bill.

At this cost, the appliance will cost £0.03 per hour to run on the "continuous" setting. If the humidistat is used, the operating costs will be lower.

## TECHNICAL SPECIFICATION

Dimensions:	350x452x275 mm
Weight:	10.5 kg
Power supply:	230 V ~ 50 Hz
Power consumption:	240 W
Operating current:	1.4 A
Refrigerant:	R134a (1,1,1,2-Tetrafluoroethane)
Refrigerant load:	90 g
Discharge pressure:	1.7 MPa
Suction pressure:	0.7 MPa
Sealing:	hermetically sealed
Airflow:	150 m <sup>3</sup> /h
Moisture removal:	10 litres/day
Tank capacity:	1.5 litres
Sound level:	45 dB(A)
Coverage area:	15 m <sup>2</sup>

## DISPOSAL AND RECYCLING

You must not dispose of this appliance with domestic household waste, because it contains refrigerant gas which is subject to control under the *Fluorinated Greenhouse Gases Regulations 2009*.

Most local authorities have specific collection system for appliances and disposal is free of charge to the end-user.

When replacing an existing appliance with a similar new appliance your retailer may take the old appliance for disposal.

## SERVICE WARRANTY

Prem-i-Air guarantees the product free from defects in materials and workmanship for a period of twelve months.

Should this appliance be operated under conditions other than those recommended, at voltages other than the voltage indicated on the appliance, or any attempts made to service or modify the appliance, then the warranty will be rendered void.

The product you buy may sometimes differ slightly from illustrations. This warranty is in addition to, and does not affect, your statutory rights.

If you have any problems with this product, please call our Help Desk on (0845) 459 4816.

Prem-i-Air Appliances Ltd.,  
Lancots Lane, Sutton,  
St. Helens, Merseyside.  
WA9 3EX

**website:** [www.prem-i-air.com](http://www.prem-i-air.com)