



**EH5430**  
Pedestal Fan Multi Oscillating



**User Manual**

Please Retain for Future Reference

This file is available to view and download as a PDF at [www.electrovision.co.uk](http://www.electrovision.co.uk). Sight impaired customers can use a free PDF Reader (such as [adobe.com/reader](http://adobe.com/reader)) to zoom in and increase the text size for improved readability.

# INTENDED USE

For use as a domestic cooling fan

# INSTRUCTIONS

This manual forms part of the product and should be kept with the unit at all times. Should the unit be sold or moved on then the manual must be included.

# PRODUCT SAFETY

Please read these instructions carefully before use.

This product and its mains lead must be checked before use for any signs of damage. If any is detected then do not use and contact your supplier.

- This appliance can be used by children aged from 8 years and above and persons with reduced physical, sensory or mental capabilities or lack of experience and knowledge if they have been given supervision or instruction concerning use of the appliance in a safe way and understand the hazards involved.
- Children shall not play with the appliance.
- For indoor use only.
- Do not use in bathrooms, swimming pools, shower rooms or other such locations
- Do not place the mains lead beneath a carpet or rug.
- Do not use this appliance in locations where paint, petrol or other flammable liquids are used or stored.
- Please ensure the appliance is switched off and unplugged when not in use.
- Do not use the appliance for other than its intended use.
- Do not insert any object into the appliance through the grilles. This may damage the product or result in overheating or electric shock.
- Periodically check this product and its mains lead for any signs of damage. If any damage is detected stop using it immediately and consult your supplier.
- Only use this product on a flat, stable surface.
- Do not leave this product unattended when in use.
- There are no user serviceable parts in this product
- Do not move or knock this product while in use.
- Do not obstruct the air intakes or exhaust vents
- This product must only be used in an upright position.
- Do Not Cover
- Do not use in areas with high concentrations of dust or fibre particles.
- Ensure the fan is fully assembled correctly before connecting it to the power supply or switching it on.
- Keep hair, loose clothing, curtains, and other fabrics away from the fan during use.
- This product is **designed for a 230V AC, 50Hz power supply**. Connecting to an incorrect power supply can cause electrical shock or fire.
- Maintain a **minimum clearance of 30cm (12 inches)** around all sides for adequate airflow.
- This is an **electrically powered device**. Do not immerse in water or allow water to enter the unit.
- Never pull the fan by the power cord or use the cord to carry the appliance.
- Avoid placing the unit near **heat sources** such as radiators, ovens, or direct sunlight.

## PARTS LIST

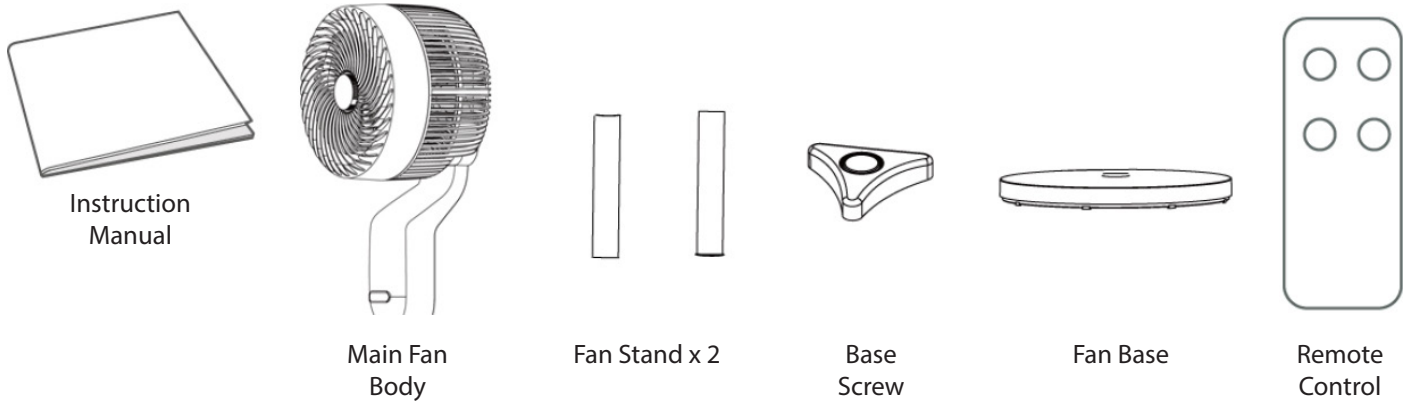

## ASSEMBLY INSTRUCTIONS

Remove all parts from the packaging and check they are all present against the parts list above

1. Connect the 2 fan stand parts together and tighten the thumbwheel on the side (see fig. 1)
2. Remove the base screw from the end of the stand (see fig. 1)
3. Insert the completed fan stand into the base (see fig. 2)
4. Turn the stand and base over and secure using the base screw that was removed in step 2 (see fig. 3)
5. Turn the stand and base back the correct way and attach the main fan body to the stand by screwing it into the stand tube (see fig.4)

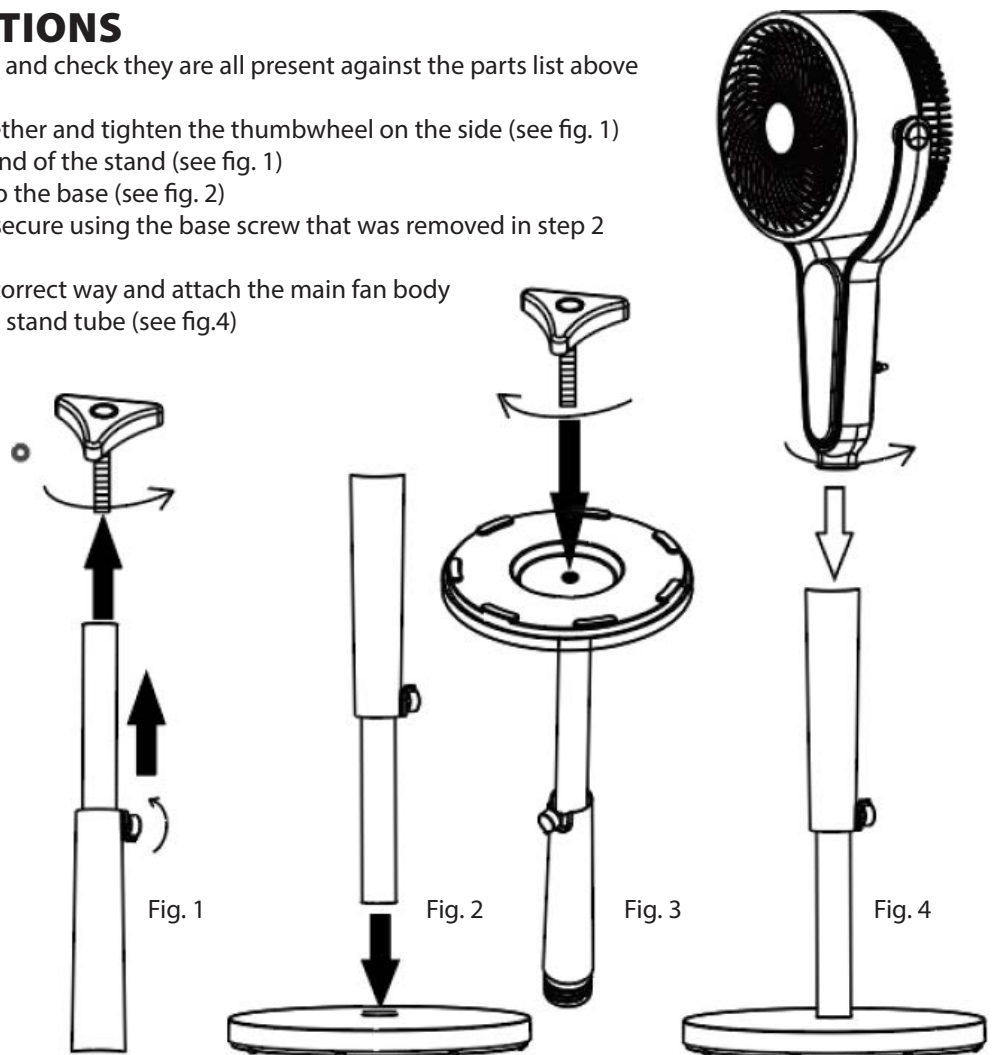

## AROMA FUNCTION

To add essential oils to the fan;

1. Remove the cap from the centre of the fan by rotating anti-clockwise.
2. Remove the circular foam pad
3. Add a few drops of your chosen essential oil
4. Replace the circular foam pad
5. Replace the cap to the centre of the fan and turn clockwise to secure

Essential oils can be added to the aroma diffuser on the front of the fan to fill the room with aroma while the fan is blowing.

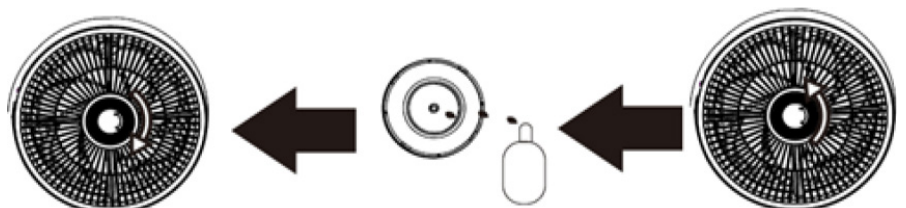

## REMOTE CONTROL

1. Remove the battery cover from the rear of the remote by twisting the cover anti-clockwise, using a flathead screwdriver or a coin
2. Remove the plastic tab from the battery compartment
3. Insert CR2025 button cell battery, observing the polarity
4. Replace the battery cover to the rear of the remote by turning clockwise

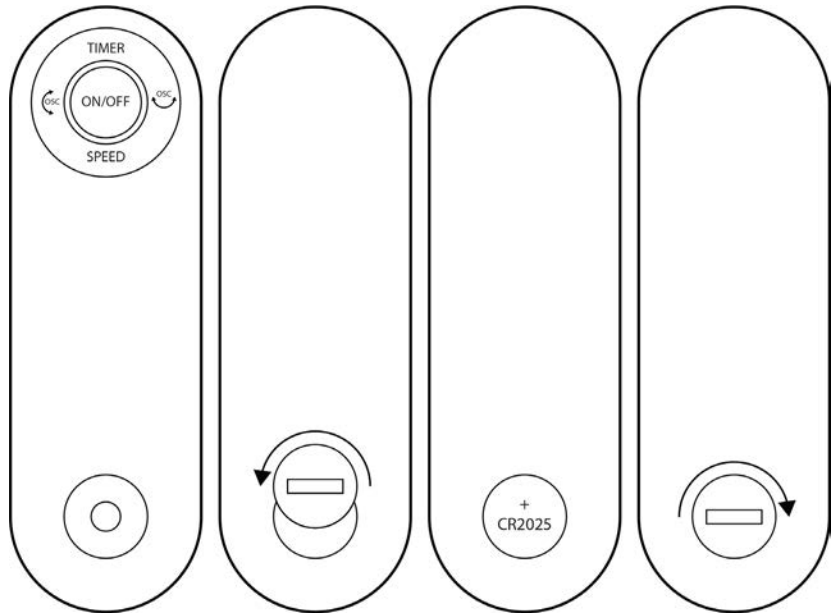

## CONTROLS/OPERATION

### ON/OFF

When you turn the fan on the fan will beep and turn on. When you turn the fan off all buttons will flash once and the fan will enter standby mode

### OSCILLATION

Pressing the oscillation button once will cause the fan to oscillate left to right. Holding the button for 3 seconds will cause the fan to swing upwards and downwards

### SPEED

The default speed when the fan is switched on is 'F1'. The speed increases with each press of this button, up to the highest speed 'F8'. Pressing the button again will set the fan back to speed 'F1'

### TIMER

Each press increases the fan's sleep timer by one hour, up to 12 hours. The display will show '0H', '1H', '2H'...etc.

### DISPLAY SCREEN

When the fan is switched on the display screen will show '\_\_\_'. The screen will automatically turn off after 3 minutes of no operation and will awaken when any button is touched

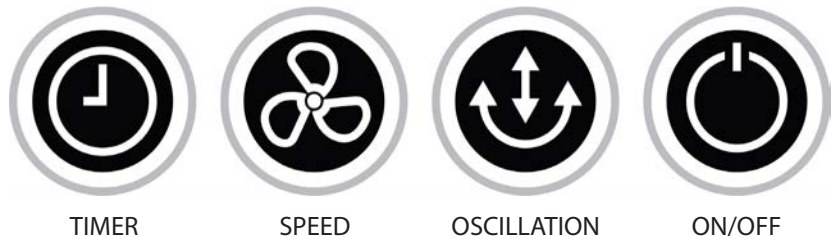

## MAINTENANCE AND CLEANING

- There are no user serviceable parts in this product. Any maintained must be carried out by a qualified and approved supplier.
- The item must be switched off and discounted from the mains before cleaning
- Clean on with a slightly damp cloth.
- Dust and debris can be removed using a soft bristle brush

## TECHNICAL SPECIFICATION

Voltage	230Vac @ 50Hz
Motor	50W
Cord Length	1.5m
Remote Control	Requires 1 x CR2025 (Supplied)
Db Level	65
Speeds	8

## SERVICE WARRANTY

Prem-I-Air guarantees the product free from defects in materials and workmanship for a period of twelve months. Should this appliance be operated under conditions other than those recommended, at voltages other than the voltage indicated on the appliance, or any attempts made to service or modify the appliance, then the warranty will be rendered void.

The product you buy may sometimes differ slightly from illustrations. This warranty is in addition to, and does not affect, your statutory rights. Our guarantee is administered by our retailers. If your product arrives damaged, you must contact the retailer from whom you bought it. The retailer's contact details will be on the invoice that arrived with the product, or on the e-mail you received when you placed the order. Do not contact Prem-I-Air Appliances Limited, only your retailer can arrange a replacement. If your product fails within the guarantee period, firstly read the "fault finding" section of this manual, because temperature and weather conditions can affect the performance of certain products. If the product needs to be repaired or replaced, you must contact the retailer from whom you bought it. The retailer's contact details will be on the invoice that arrived with the product, or on the e-mail you received when you placed the order. If you have just received your product and require technical help in using it, please call our Help Desk on 0845 459 4816

If you have any other technical queries about the product, please call our Help Desk on 0845 459 4816



**Name:** Prem-i-Air Appliances Ltd.  
**Address:** Lancots Lane, Sutton Oak, St. Helens, WA9 3EX  
**Tel:** 01744 745 030 | **E-mail:** sales@prem-i-air.co.uk



**Name:** Aidapt B.V.  
**Address:** Algolweg 22, Amersfoort, 3821BH, NL  
**Tel:** +31 0332779210 | **E-mail:** nederland@aidapt.eu

