

**Product Description**  
6 Channel WiFi Controller has a total of 4 wet and 2 dry contact outputs, one way ring-in/ring-out ground connection, and access to the Quinetic APP, which can be used to realize on/off control through the app as well as the wireless Quinetic switch. With scene function, through the relevant settings, it can trigger the scene by using the wireless Quinetic switch.

Warranty: 3 Years

**Product Specifications**

Output Channel	Interface Type	Max Current
L1	Wet Contact	16A
L2	Wet Contact	16A
L3	Wet Contact	10A
L4	Wet Contact	10A
L5	Dry Contact	10A
L6	Dry Contact	10A

**ConfigPro Compatible**

Operating Voltage: AC 100V-240V 50/60Hz  
Max. Load: 16A\*2 & 10A\*4  
Output Channel: 4 channel wet contact, 2 channel dry contact  
Power Supply Method: Neutral & Live Line  
Working Frequency: RF 433MHz & WiFi 2.4GHz  
Control Distance: 50m (Outdoor) / 30m (Indoor)  
Standby Power: <0.0W  
Storage Capacity: Up to 10 wireless Quinetic switches per channel  
Product Size: L136mm\*W90mm\*H48.5mm  
Wiring Method: Push in Terminal  
Receiving Sensitivity: -110dBm  
Operating Temperature: 20°C→+55°C  
\*Distance comes from Quinetic laboratory test results. The actual distance in practical use might vary due to environmental difference.

**Quinetic APP Download:**  
The free Quinetic App is required to operate your WiFi controller. Ensure your iOS / Android device is connected to the internet using a Wi-Fi network.

**Method 1:**  
1. Open the App store/Google Play on your phone.  
2. Search for "Quinetic" in the App store or Google Play.  
3. Download the Quinetic App to your phone.

**Method 2:**  
Download the app using the QR code below:

**Device Pairing with the APP:**  
The initial setup must be performed using your 2.4GHz Wi-Fi network (5GHz WiFi is not supported). Bluetooth must be enabled on the phone. Both the phone and the controller must connect to your network.  
1. After downloading the APP follow the prompts to register the account.  
2. After power on, the controller will enter the network state by default (the "Function Button" indicator light will enter the fast-flash state)  
3. If the light flashes differently or if you want to reset the controller follow the steps: long press the "Function Button" on the controller (as shown in the picture next page) and the indicator will go from slow-flash to still. Release the "Function Button" and the indicator light will go out. Wait for a few seconds, and the indicator light will enter the fast-flash state (i.e., enter network configuring state).

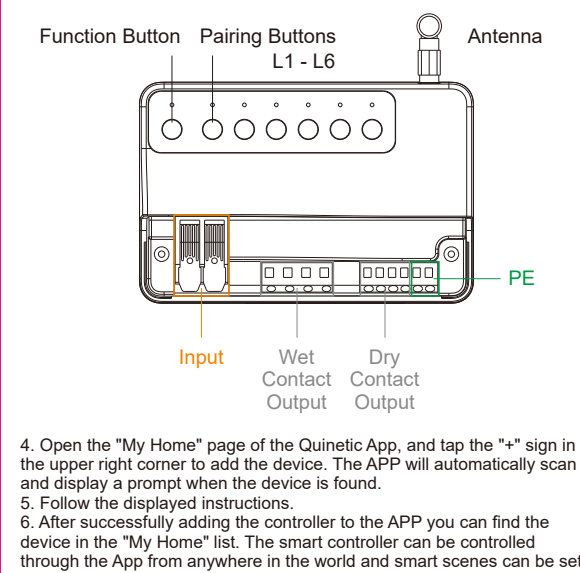

**Use Amazon Alexa/Google Home to control your 6 Channel Receiving Controller**  
Note: We would recommend naming the devices in your Quinetic App something that is easy for Alexa or Google Home to understand.

In order to integrate the Quinetic app with Amazon Alexa or Google Home you need:  
1) Amazon Alexa APP or Google Home APP  
2) Amazon Alexa or Google Home account (users need to register their own account)  
3) Echo, Echo Dot, Tap or other Amazon voice-operated devices  
4) Google Home, Google Home Mini or other Google voice-operated devices

**Enable Quinetic skill/ for voice control**  
To control Quinetic devices using third-party voice assistants like Alexa or Google Home, follow these steps:  
1. Open the Quinetic App.  
2. From the home screen, navigate to the "Me" section.  
3. Select "Third Party Services".  
4. Choose the voice assistant you want to use.  
5. Follow the on-screen instructions to enable the "Quinetic" skill.

Once set up, you can use voice commands to control your Wi-Fi devices:  
"Alexa/Ok Google, turn on/off [kitchen light]"  
"Alexa/Ok Google, turn on/off [heater]"

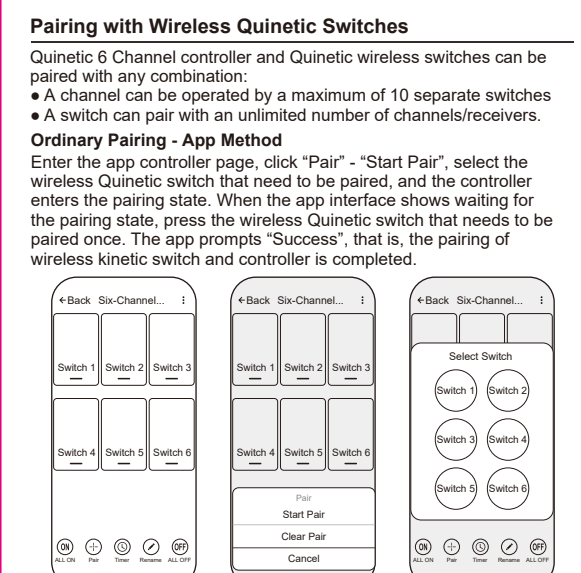

**Ordinary Pairing - Physical Button Method**  
Long press the "Pairing Button" corresponding to the channel that needs to be paired for about 3 seconds, release the "Pairing Button" when the indicator light slow-flash, at this time, press the wireless Quinetic switch that needs to be paired once, the indicator light will go out, i.e., the pairing is successful.

**Directional Pairing**  
In order to conform to the user's habit of using traditional switches and to make sure the synchronization of the status of multiple controllers in one-control-multiple mode, the directional pairing method is defined, which only supports Multi-button push button switches.

**Directional Pairing - App Method**  
Enter the app controller page, click "Pair" - "Start Pair", select the wireless Quinetic switch that needs to be paired, and the controller enters the pairing state. When the app interface shows waiting for the pairing state, press the wireless Quinetic switch that needs to be paired 4 times within 1 second. The app prompts "Success" and the directional pairing of wireless Quinetic switch and controller is completed.

**Directional Pairing - Physical Button Method**  
Connect the input of the controller to the power supply, long press the "Pairing Button" corresponding to the channel that needs to be paired for about 3 seconds, release the "Pairing Button" when the indicator light slow-flash, at this time, press the wireless Quinetic switch that needs to be paired 4 times within 1 second, the indicator light will go out, i.e., the pairing is successful.  
Note: after successful pairing, the left and right buttons of a push button switch as a group (or the upper and lower buttons as a group). Press the left button (or the lower button) to turn off, and press the right button (or the upper button) to turn on.

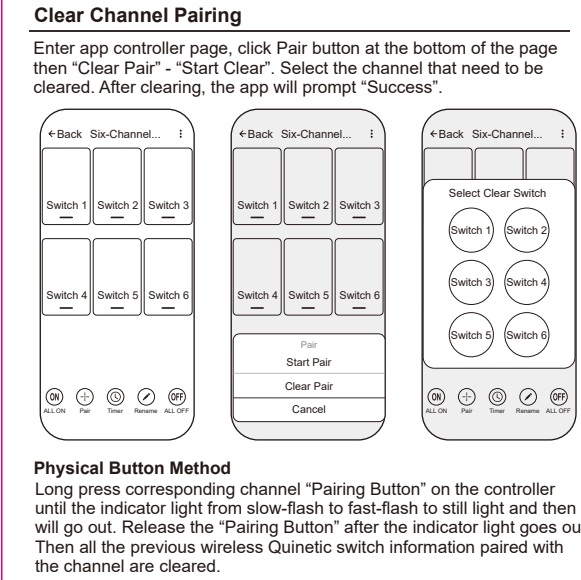

**• Clear Network App Method**  
In app home page, long press the device icon, at this time, the minus sign of all the devices will appear in the upper left corner. Click on the minus sign of the device to remove the device.

**Physical Button Method**  
Long press the controller "Function Button" until the indicator light from slow-flash to still. Release the "Function Button" after the indicator light is still, at this time the device will be removed from the APP. If need to re-add the device, just follow the steps of the device pairing with the APP. Clearing the Network operation does not clear the wireless Quinetic switch pairing information.

**• Bridging Mode**  
In order to increase distance of control and the ability to penetrate obstacles, a second controller can be used into "Bridging Mode". It is recommended to use in a one-to-multi-control mode in a long distance between the switch and the controller.  
1. First pair the wireless Quinetic switch with the controller to be controlled (that is out of range) and with the L1 channel of the 6 channel controller to be used for bridging (the signal of the wireless Quinetic switches paired with channels L2 - L6 will not be relayed).  
Note: For multiple gang switches directional pairing is recommended.  
2. As shown in the figure on the next page, select the controller 1 closest to the switch and turn on its Bridging function.  
3. Press the "Pairing Button" L1 on controller until the indicator light flashes from slowly to fast and then release the button.  
Wait for a few seconds, the "Function Button" indicator light flashes once every 2 seconds, which means Bridging Mode is on.

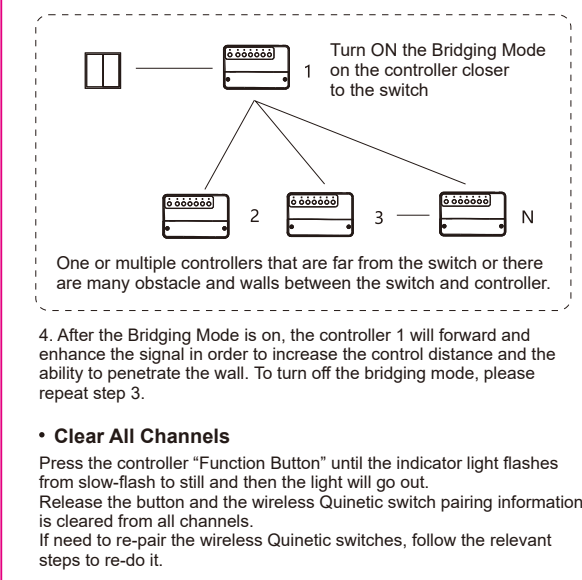

**• Scene Function**  
The controller's scene function allows a wireless Quinetic switch to trigger predefined scenes, enabling control of Tuya "SmartLife" devices. For example, a wireless Quinetic switch can be used to activate a Home Mode scene, in which the curtains open, the lights turn on, and the air conditioner is activated.

**Function Button and Indicator Light**  
**Function: Network Configuring / Clearing Network**  
Button: Function Button (Blue)  
Operation: Press the function button until the indicator light goes from slow-flash to still. Release the button then the indicator light will enter fast-flash state.  
**Function: Clear All Channels**  
Button: Function Button (Blue)  
Operation: Press the function button until the indicator light goes from slow-flash to still and then the light will go out. Release the button then the pairing from all channels will be cleared.  
**Function: Pairing**  
Button: Pairing Button (Red, 1/channel)  
Operation: Press the pairing button for 3 seconds until the indicator light starts to slow-flash. Release the button and start pairing.  
**Function: Clear Pairing**  
Button: Pairing Button (Red, 1/channel)  
Operation: Press the pairing button until the indicator light goes from slow-flash to fast-flash to still and it goes out.

**Function: Bridging Mode / Cancelling Bridging Mode**  
Button: Pairing Button (Red, any channel)  
Operation: Press the "Pairing Button" L1 on controller until the indicator light goes from slow-flash to fast-flash and release the button. The Function Button (Blue) indicator light starts to flash once every 2 seconds or it turns off in case of cancelling the Bridging Mode.

**Precautions:**  
1. The wiring must be done in accordance with the method of installation illustrated.  
2. Please note the maximum load of each individual channel. Exceeding this maximum will result in damaging the controller.  
3. The controller has a non-replaceable internal fuse.  
4. Do not short-circuit, it will cause permanent damage to the controller.  
5. Damage caused by incorrect installation and operation are not covered under warranty.  
6. The controller will remain "OFF" after a power cut, saving energy, reducing fire risk and protecting your appliances. The power-on state of the receiver can be changed through the APP and/or ConfigPro tool.

**Troubleshooting:**  
1. If pairing does not work first check if the indicator is lit. Re-pair in case the pairing is lost after power failure.  
2. If the receiver does not respond check the LED indicator. If this does not light check the power supply.  
3. The receiver is offline in APP: Router connections might reach the upper limit. Some routers allow a maximum of 15 devices. In this case please upgrade the router and/or close any devices which are not needed.

