

CONTENTS

FEATURES.....	1
OUTDOOR UNIT.....	1
INDOOR UNIT.....	1
INSTALLATION.....	2
OPERATING INSTRUCTIONS.....	4
ACCESSORIES.....	4
WARNING.....	4

Version 1.1



2.4GHz WIRELESS DUAL-WAY DIGITAL DOORPHONE

350.001UK



USER MANUAL

This wireless door phone system allows you to talk to your visitors before opening the door. No wires required between the door bell and the phone, making this system very easy to install. Good for security and helpful for the elderly or less mobile.

Features

- * Works within 150m range
- * Adjustable ringer volume
- * Weatherproof outdoor unit (IP44 rated)
- * Supplied complete with adaptor, fixing screws, wall plugs and mounting brackets

Outdoor unit

- Working temperature: -10°C~50°C
- Dimension: 112 (W) X162(H)X68(D)mm

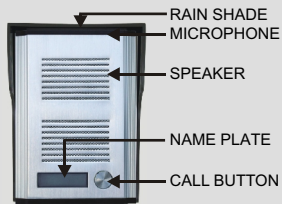

Indoor unit

- **Working temperature:** -10°C~50°C
- **Data of switch power:**
Input: AC100-240V~50/60Hz
output: DC12V/0.5A or DC12V/1.1A

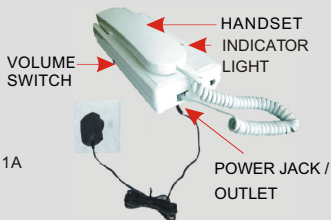

Installation

A. Outdoor unit

- ① Fasten the rain shade on the wall 1.4~1.7m above the ground.
- ② Remove the screws on the bottom of outdoor unit. Take down the decorating bar and open the panel.

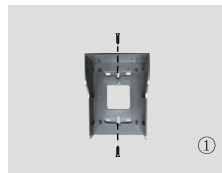

- ③ Insert 4x AA batteries.
- ④ Take down the name plate and then write down family name or room number .

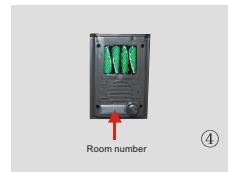

- ⑤ Fasten the outdoor unit on the rain shade with screws.
- ⑥ Cover the panel.

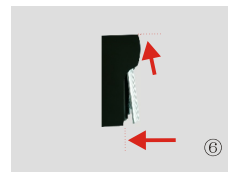

- ⑦ Install the decorating bar and then fasten the screws on the bottom of the unit.

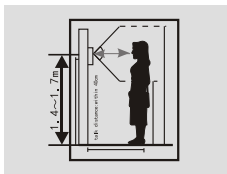

B. Indoor unit

- ① Fasten the bracket of indoor unit on the wall.
② Open the battery cover.



- ③ Insert 4x AA batteries and then replace the cover.
④ Hang the indoor unit on the bracket.



- ⑤ Plug the power supply into a mains socket.
⑥ Insert the power jack into the socket on the indoor unit.



Operating instructions

- When the CALL button is pressed on the outdoor unit the chime will sound on the indoor unit and the indicator light will come on. You are then able to speak with your visitor for a maximum of one minute.
- After hanging up on your visitor another chime will be heard and the indicator light will blink every 3 seconds.

Accessories

- One indoor unit
- One outdoor unit
- One rain shade
- One power supply
- One fixing bracket
- One user manual
- Fixing screws

Warning

- Do not fix the indoor unit near the wireless telephone.
- Do not fix the indoor unit in a place with high temperature or high humidity.
- Use a soft cloth to clean the units, corrosive and volatile liquids must not be used
- Keep the units away from direct sunlight and damp environments where possible
- Do not drop the units or subject them to any forceful blows.
- Do not take the units apart without professional advice.
- When the power indicator flickers on the units please replace the batteries immediately



Errors and omissions excepted.
Copyright? 2017. AVSL Group Ltd

350.001UK User Manual