



DOOR VIDEO COMMUNICATOR

Model: DCC3 Single Channel Black & White
DCC4 Twin Channel Black & White



DCC3/4



DCC3



DCC4



INSTALLATION & OPERATING INSTRUCTIONS

1. Introduction

The DCC3/DCC4 Door Entry System enhances entry security by enabling the user to recognise the visitor by audible and visual means before opening the door.

The external intercom incorporates LED lighting to illuminate the visitor for the camera. This type of lighting has an indefinite life.

An electric door catch (not supplied) is available as an optional extra for the DCC3/DCC4 to make the door opening automatic.

The external and internal intercoms are connected by a two core cable. With the cable supplied the distance between these units is limited to 15m. By using 13/0.2 bell flex cable this distance can be increased to a maximum of 70m

2. Product Overview

If operation with an electric door catch is required then part DCLR is a fail (power off) secure catch available from Timeguard. An additional two core cable run (using 13/0.2 bell flex) will be required between internal intercom and door catch.

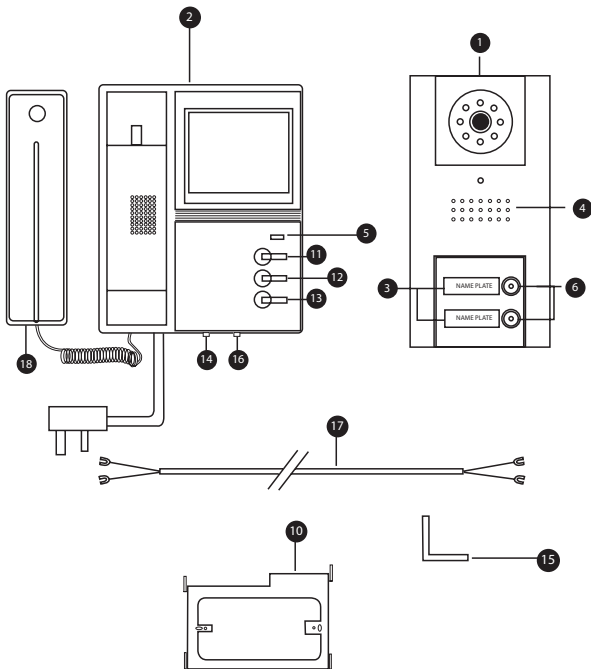
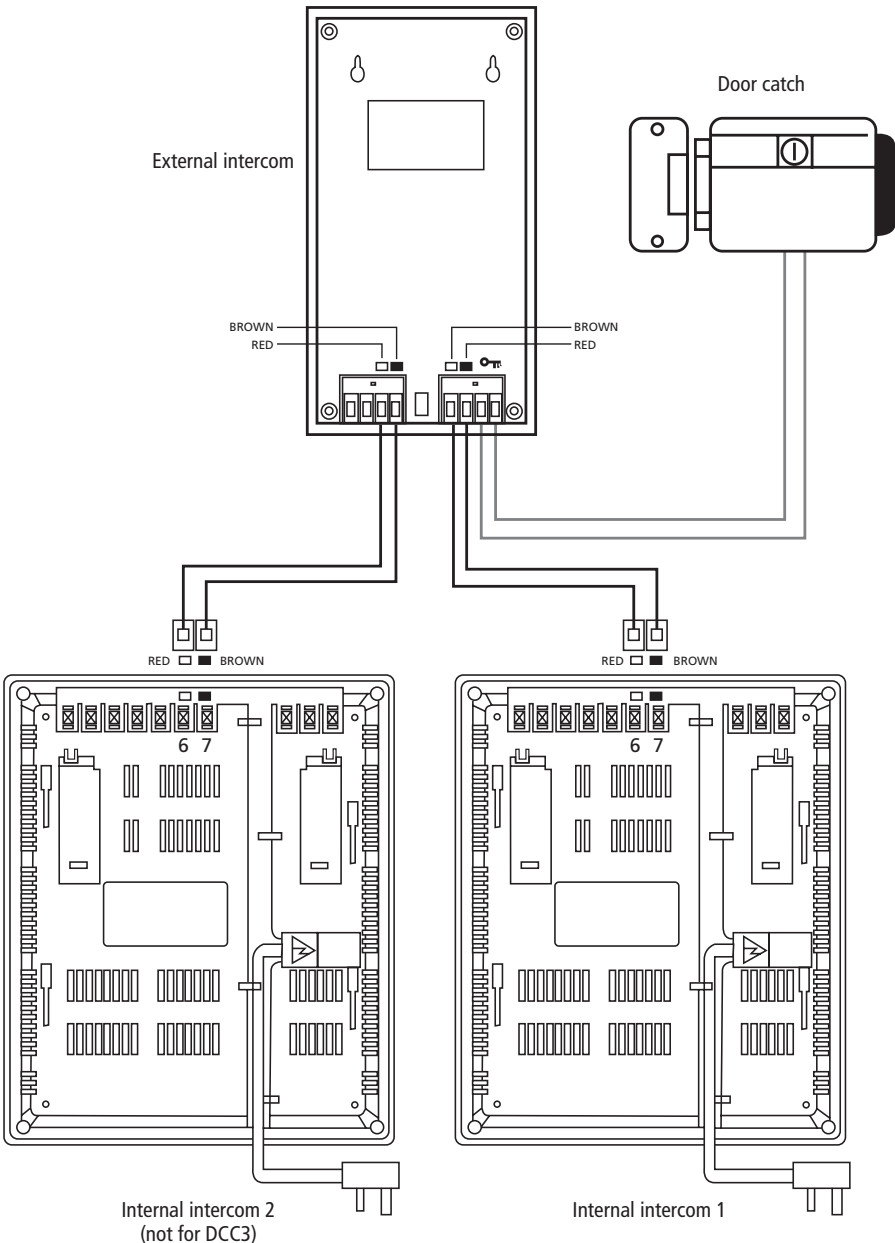

Fig 1 - Component Parts

1. External intercom.
2. Internal intercom.
3. Name plate.
4. Loudspeaker.
5. Mains on indicator.
6. Call button.
7. Keyhole fixing.
8. Screw terminals.
9. Slot for angle bracket (15).
10. Wall mounting plate.
11. Monitor on button.
12. Monitor off button.
13. Door open button.
14. Brightness - three position switch.
15. Angle bracket.
16. Volume adjust - three position switch.
17. Connecting cable.
18. Internal intercom handset

Fig 2 - Wiring diagram (DCC4 shown)



3. Selecting intercom sites and cabling

3.1 Intercom sites

The internal intercom should be located at a convenient position for all potential users at the height indicated in fig 3a and at a maximum distance of 70m from the external intercom. If all the users are significantly above or below average height then a different mounting height may be considered appropriate.

The external intercom should be sited in an area away from driving rain and surface water, out of direct sunlight as far as possible and protected by the minimum of an open porch in a position readily accessible to potential entrants. It should be mounted at the height indicated in fig 3b.

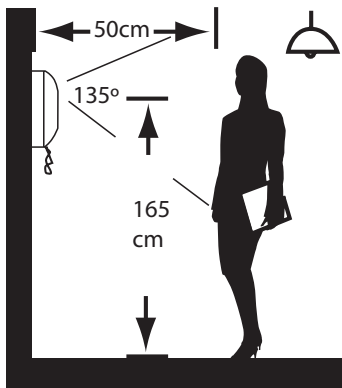

Fig 3a
Internal intercom
mounting height

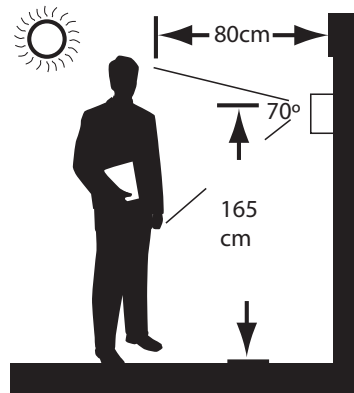

Fig 3b
External intercom mounting
height and coverage

3.2 Cabling

Connection between the internal and external intercoms is by 2 core cable.

A 15m length is supplied (2 for DCC4). A separation of intercoms up to 70m is possible. Two core 13/0.2 bell flex is suitable. The cable run should be kept at least 100mm away from any mains cable to avoid interference.

A second relatively short 2 core cable (13/0.2 bell flex) will be required between the external intercom and the door catch (if needed).

A further 2 core cable (13/0.2 bell flex) will be required to extend (if necessary) the cable between the external intercom and the second internal intercom for the DCC4. Existing bell runs can be made use of.

4. Fixing Intercoms

4.1 External intercom

Important: To give the best possible waterproofing and appearance we recommend taking the wiring through the exterior wall directly over the wiring terminals of the If the surface to be fixed to is not even (e.g. pebbledash or brickwork with raised pointing) we recommend the use of at least 10mm (3/8") thick marine ply as a mounting plate between the wall and the intercom to give a flat surface for its 3 point fixing.

Use the template provided to mark the positions of the three fixing holes. Drill and, if necessary, plug these holes for No. 8 roundhead screws.

Drive the top two No. 8 roundhead screws in leaving 3mm of the shank exposed (see fig 4).

Fig 4

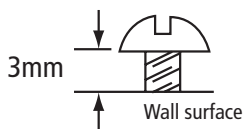
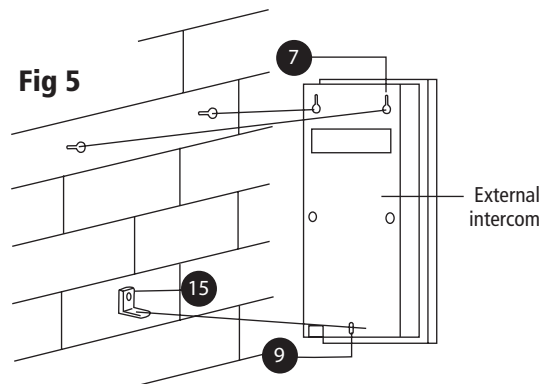

Fig 5



The third screw is used to secure the angle bracket (15) to the wall (see fig 5).

Pass the cable(s) through the wall hole and terminate the cable from the internal intercom ensuring that the brown and red wires are connected to the terminals of the same colour on the external intercom (particularly important if an extension cable is used).

If a DCC4 is being installed then a second cable will be required to connect to the additional internal intercom maintaining polarity as before.

If a door catch is to be used connect an additional two core cable to the terminals on the external intercom marked door opener (not polarity conscious).

Offer up the external intercom to the fixing points feeding the cable(s) back through the wall as necessary. Locate the larger part of the keyhole fixings on the heads of the two fixing screws (see fig 5) and, keeping the rear of the case clear of the angle bracket (15), push the external intercom downwards to locate the screws on the narrower part of the keyhole fixing.

Push the lower part of the external intercom towards the wall taking care to locate the angle bracket (15) in the slot (9). Insert the screw supplied through the countersunk hole in the lower edge of the external intercom and screw home.

If the fixing surface is uneven it may be necessary to increase the exposed shank of one or both of the top fixing screws to get a satisfactory fit.

4.2 Internal intercom

Choose a position which can be reached easily by all potential users. If one person usually in one location will be the main user it may be considered appropriate to locate the internal intercom within reach of that person.

Mark out two holes suitable for No. 8 roundhead screws using the wall mounting plate as a template (ensure this is the correct way up by referring to fig 6).

Drill and plug the holes if necessary. Offer the wall fixing plate up to the wall and drive the fixing screws home, ensuring the plate is not distorted by mounting on an uneven surface.

Connect the two core lead from the external intercom according to fig 2. Arrange this cable and the mains lead in the cable channel at the back of the internal intercom. Finally locate the internal intercom mounting slots on the wall fixing plate mounting hooks, and slide intercom downwards into position.

Fig 6 - mounting internal intercom

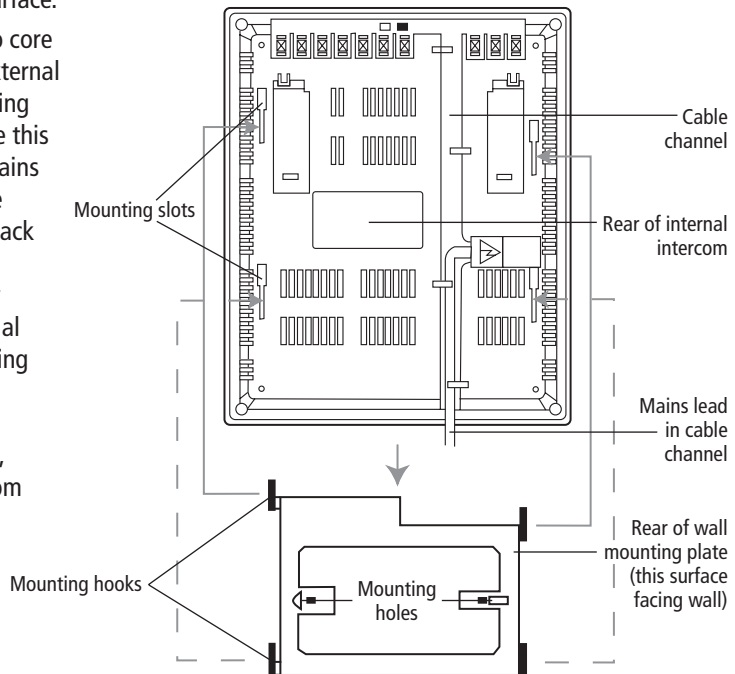

4.3 Name Plates

Remove the transparent cover(s) using a small flat bladed screwdriver as shown in fig 7.

Lever out the plastic name plate(s) and mark as appropriate with a fibre tipped pen marked permanent.

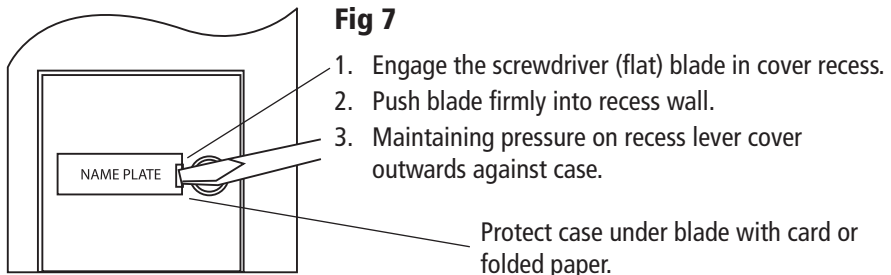

5. Commissioning/Use

Press the call button (6) at the external intercom – a buzz will be heard locally and the camera will activate for 1 minute. A ring tone will be heard at the internal intercom for two to three rings and the display will show the visitor. Once the handset is lifted two way communication is possible via the microphone and speaker at the external intercom. To end the conversation and turn off the camera and display replace the handset on hook. Finally, if a door catch is fitted, the door open button (13) should be pressed and, the door can be opened. It is not necessary for the handset to be lifted to use the door open facility. The monitor on button (11) when pressed will give a minute of camera and display active at any time. This can be brought to an end earlier by pressing the video off button. If necessary the audio volume and video brightness can be adjusted using the controls 16 and 14 respectively (fig 1).

6. Do's and Dont's

1. Never use the product if it shows any signs of damage.
2. In case of damage to the product unplug the mains plug from the 13A socket to avoid any possibility of electric shock and have the damage examined by a competent person.
3. When laying cabling ensure that no cables (particularly mains cables) are damaged.
4. The mains supply to the internal intercom should be within the range 90 – 235V AC 50/60Hz.
5. The installation should only be carried out by a competent person.
6. The internal intercom should be kept out of reach of children and unauthorised persons.
7. Keep low voltage cabling at least 100mm away from any mains cabling.
8. Ensure that all electrical connections are made and wires are arranged according to the instructions.
9. Do not cover the louvres on the internal intercom.

7. Troubleshooting

No Audio or Video

Check cable between internal and external intercoms is connected correctly.

Check that there are no breaks or damage to the interconnecting two core cable.

Check that the mains supply is plugged in and switched on.

Door catch not working (if fitted)

Check cable between external intercom and door catch for breaks or damage.

Check that terminations are correctly made at each end of the above cable.

Check that the mains supply is plugged in and switched on.

8. Cleaning

Unplug mains supply before cleaning product.

Clean internal and external intercoms with a damp cloth only – no cleaning agents. Remove dust deposits from the louvres on the internal intercom with a soft brush or vacuum cleaner.

9. Specifications

Mains supply:	90 – 235V AC 50/60Hz
Power consumption:	Operating 4.5W Standby 1W
Operating ambient temp range:	-10°C to +50°C (external intercom) +35°C max (internal intercom)
Ringtone volume:	80dBA at 0.3m maximum (adjustable by 3 position switch)
Door catch:	Max 12V DC 1A

3 Year Guarantee

In the unlikely event of this product becoming faulty due to defective material or manufacture within 3 years of the date of purchase, please return it to your supplier in the first year with proof of purchase and it will be replaced free of charge. For years 2 and 3 or any difficulty in the first year telephone the helpline on **020 8450 0515**.



Recycling

When service life is over please consult your local authority regarding method of disposal.



HELPLINE

020-8450-0515



For a product brochure please contact:

Timeguard Ltd.

Victory Park, 400 Edgware Road,
London NW2 6ND

020-8452-1112

or email csc@timeguard.com

67-058-236