

Please keep these instructions carefully

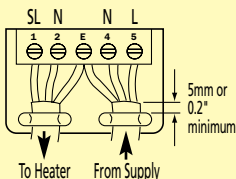

24 HOUR IMMERSION HEATER TIME CONTROLLER

- Economical to use
- Simple to install
- Easy to programme
- 30 minute minimum switching interval which can be increased in 15 minute steps
- Total control of your hot water
- Compact, robust design

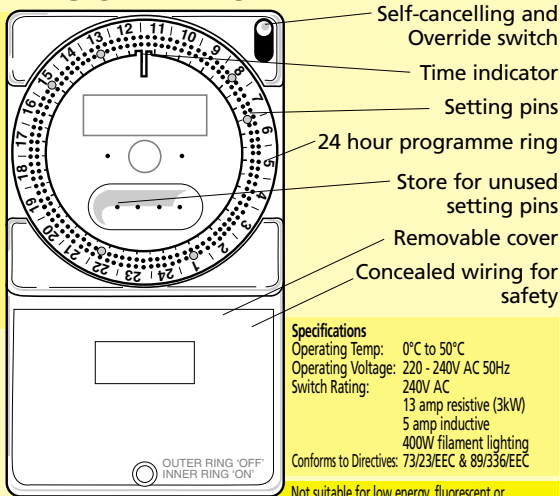

Not suitable for low energy, fluorescent or discharge lighting (eg SON & Metal Halide).

FITTING INSTRUCTIONS

1. Choose any suitable flat surface between switched supply and immersion heater to fit the TS900.
2. Remove cover by undoing screw on front cover bottom.
3. Place timeswitch in required position (it must be mounted vertically with the time indicator at the top) and mark wall at the centre of the top side.
4. Measure down from this mark 5mm/0.2" and make a second mark. At this second mark drill a hole and plug, if necessary, to take a No 6 wood screw.
5. Screw in wood screw until head is 2.5mm proud (see diagram).
6. Place 'Keyhole' in back of timeswitch over screw head and slide downwards. Now mark wall through large recessed hole near bottom of unit. Remove Timeswitch, at this third mark drill and plug as before.
7. Replace Timeswitch over screw head. Fit second wood screw into recessed hole and tighten into wall.
8. You are now ready to wire up.

WIRING INSTRUCTIONS

1. SWITCH OFF AT MAINS.
2. Cut cable to suit Timeswitch position and bare ends of cable, connecting to Timeswitch as shown above.
3. From immersion heater fit live connection (brown) into terminal 1. From immersion heater fit neutral connection (blue) into terminal 2. From both cables fit both earth connections (green yellow) into terminal E. From switch/supply fit neutral connection (blue) into terminal 4. From switch /supply fit live connection (brown) into terminal 5. Ensure all screws are tightened.
4. Fit two cable clamps using 4 self-tapping screws and tighten to grip outer insulation of both cables.
5. Replace cover, tighten screw.
6. Switch on mains and programme Timeswitch to your own requirements.

OPERATING INSTRUCTIONS.

1. Remove the setting pins and insert them at the times you wish the switch to operate. ON = Inner Circle OFF = Outer Circle. The shortest period is half-an-hour. Unused setting pins are stored in the front of the unit.
 2. Turn the programme ring clockwise, one complete turn, to check the programme. Set the programme ring to the correct time of day at the time indicator.
 3. It is possible to manually override the programmed time by operating the override switch in the right hand corner. 1 = ON. 0 = OFF.
- Notes:
- a. The override switch cannot be used within 15 minutes of a switching time.
 - b. Remember to reset the time following power failure.

This product must not be used on a load greater than 3kW resistive.

Warning: Continuity of earthing must be maintained. If you have any doubt about your ability to install this Timeswitch correctly consult a competent electrician. The IEE Wiring Regulations require that a means for disconnection from the supply having a contact separation of at least 3mm in all poles must be incorporated in the fixed wiring. Your consumer unit normally complies. All conductors should be 1.5mm² min.

THREE YEAR



GUARANTEE

For further information contact:
Timeguard Ltd., Victory Park, 400
Edgware Road, London NW2 6ND
Or visit our website www.timeguard.com

Helpline **020 8450 0515**

Call now for a free range brochure on
020 8452 1112

Model TS900
Designed & Manufactured in the U.K.
67-500-94 (ISS 2)

