

# CONTRA-FOIL™ contra-rotating cased axial flow fans (aluminium impellers)



Range of cylindrical cased axial fans fitted with aluminium impellers and manufactured from high grade rolled galvanised steel and protected against **corrosion by cataforesis primer and black polyester paint finish.**

Fitted with **2 contra-rotating complementary impellers** manufactured from die-cast aluminium.

All models are supplied with pre-wired wiring junction box located on the outside of the fan casing for easy wiring access.

Available with single or three phase 4 poles motors.

## Motors

All the motors are **IP65**, Class F insulation (1), equipped with **thermal protection.**

Single phase motor Speed controllable up to 560mm\*

(\*560mm must be three wire controlled and must not exceed 55° ambient temperature) Three phase motors suitable for inverter control.

Electrical supplies:

Single phase 230V-50Hz. (Capacitor located inside the wiring terminal box).

Three phase 400V-50Hz

(1)Working temperatures from -40°C up to 70°C.

### Contra-rotating: High pressure



**Contra-rotating system** with two complementary impellers **allowing the duplication of the pressure** with the same air volume

### Corrosion resistance



Rolled steel casings and motor support **protected by cataforesis primer and black polyester paint finish.** Stainless steel screws

### Terminal box



Wiring **terminal box** with cable gland PG-11

### Impeller dynamically balanced



**Impellers are dynamically balanced**, according to ISO 1940 standard, giving vibration free operation

■ **Technical characteristics**

Before installation check that the product electrical characteristics listed on the data plate label (Voltage, power, frequency etc) match those of the intended electrical supply.

Code	Model	Diameter Ø (mm)	Speed (r.p.m.)	Maximum Power (kW)	Max. Current (A)	Maximum Air Volume (m³/h)	Weight (Kg)	Speed Controller
------	-------	-----------------------	-------------------	--------------------------	---------------------	---------------------------------	----------------	---------------------

**ContraFoil Contra-Rotating Cased axial flow fans (Aluminium impellers)**

**Single phase**

230V

5605384600	TCBBx2/4-450	450	1370	1.24	5.40	6900	42	REB-6
5605385300	TCBBx2/4-500	500	1150	1.40	6.20	8000	50	REB-8
5605751300	TCBBx2/4-500E	500	1375	1.90	8.70	9500	54	REB-10
5605760400	TCBBx2/4-560L	560	1425	2.75	12.30	11800	66	REB-12
5605386100	TCBBx2/4-560	560	1340	3.25	15.50	14300	66	REB-16
5605387900	TCBBx2/4-630	630	1280	3.90	19.00	18200	80	

**Three phase**

400V

5605380400	TCBTx2/4-450	450	1400	1.25	3.40	6900	42	RMT-5
5605381200	TCBTx2/4-500	500	1340	1.75	3.60	9400	50	RMT-5
5605382000	TCBTx2/4-560	560	1360	3.12	5.80	14300	66	RMT-8
5605383800	TCBTx2/4-630	630	1370	4.20	8.00	18200	80	RMT-12

■ **Dimensions (mm)**

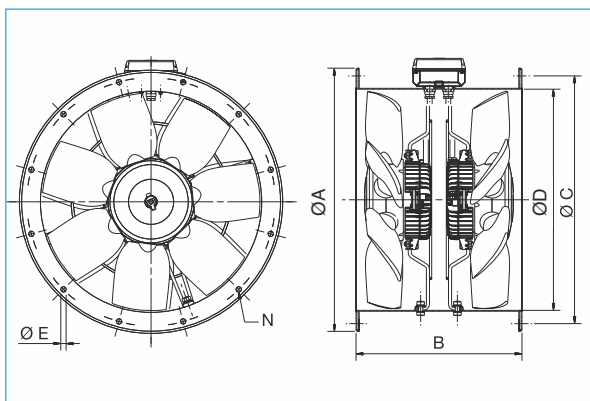

Model	Ø A	B	Ø C	Ø D	Ø E	Number of holes N
450	537	375	500	450	12	8
500	595	375	560	500	12	12
500E	595	520	560	500	12	12
560/560L	655	520	620	560	12	12
630	725	520	690	630	12	12

■ **Performance curves**

- Q = Air volume in, m³/hr and m³/s.
- Pe = Static pressure in mmWG and Pa.
- Dry air at 20°C and 760 mmHg.
- Air flow data in accordance with the following standards: UNE 100-212-89, BS 848, Part 1; AMCA 210-85 and ASHRAE 51-1985.

