

Service

(D)

STEINEL-Schnell-Service
Dieselstraße 80-84
33442 Herzbrock-Clarholz
Tel.: +49/52 45/4 48-1 88
www.steinell.de
e-mail: info@steinell.de

(A)

I. MÜLLER
Peter-Paul-Str. 15
A-2201 Gerasdorf bei Wien
Tel.: +43/22 46/21 46
Fax: +43/22 46/2 54 66
e-mail: info@imueller.at

(CH)

PUJAG AG
Oberebenestrasse 51
CH-5620 Bremgarten
Tel.: +41/56/6 48 88 88
Fax: +41/56/6 48 88 50
e-mail: info@pujag.ch

(GB)

STEINEL U.K. LTD.
37, Manasty Road
Orton Southgate
GB-Peterborough PE2 6UP
Tel.: +44/17 33/2 38-2 65
Fax: +44/17 33/2 38-2 70
e-mail: steinell@steinelluk.com

(IRL)

SOCKET TOOL COMPANY
8, Queen Street
IRL-Dublin 7
Tel.: +3 53/1/8 72 54 33
Fax: +3 53/1/8 72 51 95
e-mail: sockettool@eircom.net

(F)

DUVAUCHEL S. A.
86/108 Avenue Louis Roche
F-92230 Gennevilliers Cedex
Tel.: +33/1 41 47 20 40
Fax: +33/1 47 99 44 09

(NL)

HEGEMA PRESENT B.V.
Christiaan Huygensstraat 4
NL-3291 CN Strijen
Tel.: +31/78/6 74 44 44
Fax: +31/78/6 74 31 13
e-mail: info@hegema-present.nl

(B)

PRESENT Handel s.p.r.l.
Toekomstlaan 6
Industriezone Wolfstee
B-2200 Herentals
Tel.: +32/14/25 74 74
Fax: +32/14/25 74 75
e-mail: info@present.be

(L)

A. R. Tech.
70, Millewee
Boite Postale 1044
L-1010 Luxembourg
Tel.: +3 52/49/33 33
Fax: +3 52/40/26 34
e-mail: com@artech.lu

(I)

THOELKE DISTRIBUZIONE
S.N.C.
Via Adamello 2/4
I-22070 Locate Varesino
(Como)
Tel.: +39/3 31/83 69 11
Fax: +39/3 31/83 69 13
thoelke.distribuzione@thoelke.it

(E)

SAET-94 S.L.
Polig. Industrial Cova Solera
O/Aleras, 5
E-08191 Rubi (Barcelona)
Tel.: +34/93/5 88-67 25
Fax: +34/93/5 88-68 46
e-mail: saet94@retemail.es

(P)

F. Fonseca, S.A.
Estrada de Taboeira,
87/89-Esgueira,
Apartado 3003
3801-997 AVEIRO
Tel.: +3 51/2 34/30 39 00
Fax: +3 51/2 34/30 39 10
e-mail: ffonseca@ffonseca.com

(S)

KARL H STRÖM AB
Verktgsvägen 4
S-553 02 JÖNKÖPING
Tel.: +46/36/31 42 40
Fax: +46/36/31 42 49
www.khs.se
e-mail: kontakt@karlstrom.se

(DK)

BROMMANN
Ellegaardvej 18
DK-6400 Sønderborg
Tel.: +45/74 42 88 62
Fax: +45/74 42 88 62
e-mail: brommann@brommann.dk

(FIN)

Hedengren Yhtiöt
Oy Hedtec Ab.
Mankimiehentie 4
FIN-02780 Espoo
Tel.: +3 58/9/68 28 81
Fax: +3 58/9/67 49 18
www.hedtec.fi
e-mail: hedtec@hedtec.fi

(N)

STAUBO ELEKTRO-
MASKIN A.S.
Bjørnerudveien 12c
1266 Oslo
Tel.: +47/23 75 35 00
Fax: +47/22 75 35 01
e-mail: post@staubo.no

(CZ)

ELNAS s.r.o.
Oblekovice 394
CZ-67181 Znojmo
Tel.: +4 20/5 15/22 01 26
Fax: +4 20/5 15/26 15 25
e-mail: info@elnas.cz
www.elnas.cz

(PL)

LANGE LUKASZUK Sp.j.
Byków 25a
PL-55-095 Mirków
Tel.: +48/71/3 98 08 00
Fax: +48/71/3 98 08 02
e-mail: info@langelukaszuk.pl

(LT)

KVARCAS 17-4
A. Mickevičiaus
LT-3000 Kaunas
Tel.: +3 70/37/32 88 23
Fax: +3 70/37/32 88 22
e-mail: kvarcas@kaunas.omnitel.net

(EST)

FORTRONIC Plc.
Tähe str. 108
EST-50113 Tartu
Tel.: +3 72/7/47 52 08
Fax: +3 72/7/36 72 29
e-mail: fortron@online.ee

(SLO)

LOG Zabnica D.O.O.
Podjetje Za Trgovino
SLO-4209 Zabnica
Tel.: +3 86/42/31 20 00
Fax: +3 86/42/31 23 31
e-mail: info@log.si

(GR)

PANOS Lingonis + Sons O. E.
8, Aristofanous
GR-10554 Athens
Tel.: +30/2 10/3 21 20 21
Fax: +30/2 10/3 21 86 30
e-mail: lygonis@otenet.gr

(TR)

EGE SENSÖRLÜ
AYDINLATMA İTH. İHR.
TIC. VE PAZ. Ltd. STI.
Gersan Sanayi Sitesi 659
Sokak No. 510
TR-06370 Bati Sitesi (Ankara)
Tel.: +90/3 12/2 57 12 33
Fax: +90/3 12/2 55 60 41
ege.aydinlatma@superonline.com

STEINEL®

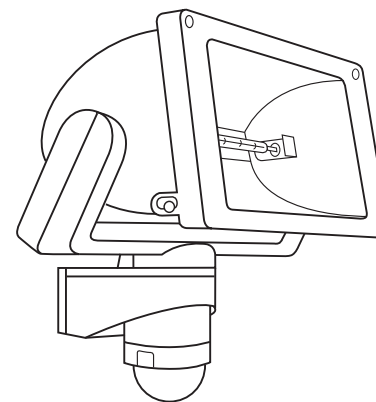

Halogen **DUO**

- (D)** Bedienungsanleitung
- (GB)** Operating instructions
- (F)** Mode d'emploi
- (NL)** Gebruiksaanwijzing
- (I)** Istruzioni per l'uso
- (E)** Instrucciones de montaje
- (S)** Bruksanvisning
- (DK)** Brugsanvisning
- (FIN)** Käyttöohje
- (N)** Bruksanvisning

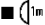

STEINEL®

GB Safety Notifications

- Before undertaking any work on the unit disconnect the mains supply!
- The supply lead to be connected must not be live during assembly. Therefore, first switch off the power and check that the circuit is dead by using a voltage tester.
- The installation of these units involves connecting them to the mains supply. The work must therefore be carried out in a professional manner in accordance with the regulations involving installation and connection of electrical appliances specific to each country (IEE Wiring Regulations). If in doubt contact a qualified electrician.
- Do not mount the unit on surfaces that are normally easily inflammable.
- The halogen fixture must not be aligned to face the wall on which it is mounted.
- The halogen fixture must be in a horizontal position ($\pm 15^\circ$).
-  The spotlights must be mounted in such a way that in all possible setting angles they are at least 1 metre from the surface at which they are directed.
- The halogen spotlights are only intended for wall mounting and not for ceiling mounting. They must not be installed less than 1 m from the ceiling.
-  In the event that the protective glass is broken, it is imperative that a new protective glass is installed before the light is operated again.
- To avoid inflammation of the skin and eyes do not expose yourself for any length of time to a HalogenSensorFixture being operated at 10% over the nominal voltage.
- The floodlight housing becomes very hot during operation. Only align the floodlight when the housing has cooled down.

GB Installation Instructions

Any movement will activate the light, the alarm and much more, all for your convenience and security. These HalogenSensor

Fixtures can be mounted quickly anywhere and are immediately ready for operation, whether they are to be used for private purposes to

illuminate your property and home or for commercial purposes to illuminate business premises.

The Principle

The HS 150, HS 300 and the microprocessor controlled HS 500 halogen fixtures are equipped with two 120° pyro sensors that detect the invisible heat radiation emitted by moving bodies (such as people or animals etc.). The

thermal radiation detected in this way is converted electronically and activates the fixture. No thermal radiation is detected through barriers such as walls or panes of glass and therefore no switching operation is triggered.

With the aid of the two pyro sensors an angle of coverage of 240° with an angle opening of 180° is achieved.

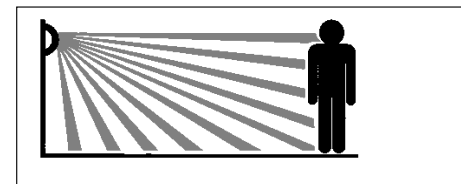
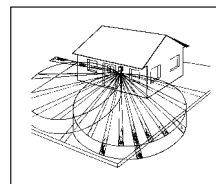

Detection zone
 HS 150 = approx. 300 m²
 HS 300 = approx. 300 m²
 HS 500 = approx. 800 m²

Reach: HS 150 = max. 12 m
 HS 300 = max. 12 m
 HS 500 = max. 20 m

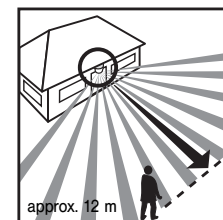
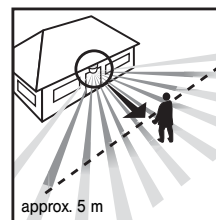

N.B: The most reliable motion detection is achieved by mounting or aligning the unit laterally to the direction of movement and ensuring that no obstacles (such as trees, walls etc.) obstruct the line of sight.

Installation

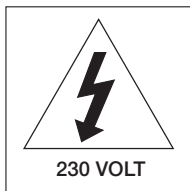
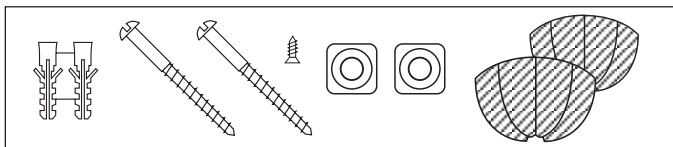

Mount the unit on a firm surface to avoid any switching errors.

Connection of supply lead
 L = phase conductor (usually black or brown)
 N = neutral conductor (usually blue)
 PE = if applicable, protective-earth conductor (green/ yellow)

N.B: If the connections are reversed, this will lead to a subsequent short-circuit either in the unit or in your fuse box, in which case the individual wires must be identified and reconnected correctly. A mains power switch can also be installed, of course, in the supply lead to switch the power ON and OFF.

Exposed wiring
 For exposed wiring, two lugs are provided at the bottom of the mounting plate **2**. Snap off one of the two lugs. Close off the mounting plate cable entry with the sealing plug. Pierce the sealing plug and push the cable through. Once the cable has been pushed through, you can screw the mounting plate into position and complete the connection.

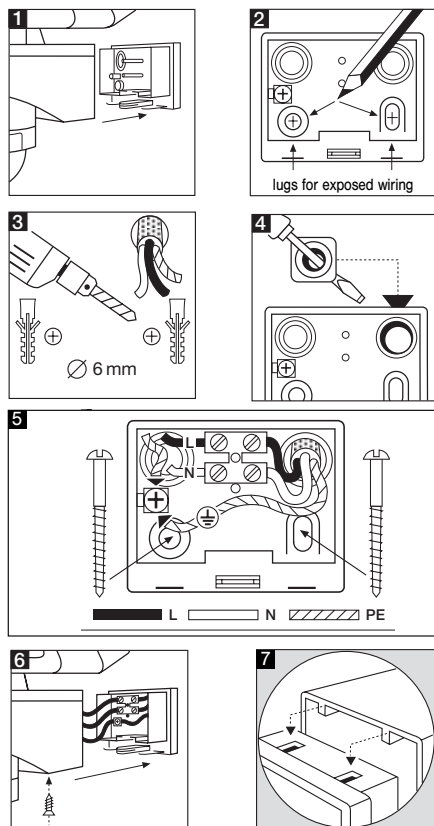

Functions

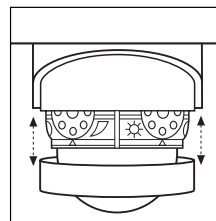

Remove attachment ring

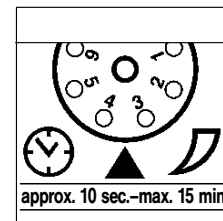

Time setting (period of illumination for the Halogen SensorFixture 10 secs. - 15 mins.)

Adjustment control set to number 1 = shortest time (approx. 10 secs.)

Adjustment control set to number 6 = longest time (approx. 15 mins.)

With every movement that takes place within the detection zone the set time is reactivated.

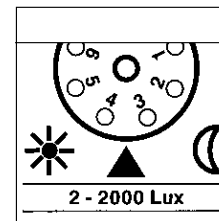

Twilight setting (Sensor response threshold 2 - 2000 lux)

Adjustment control set to number 1 = daytime operation (approx. 2000 lux)

Adjustment control set to number 6 = night time operation (approx. 2 lux).

Twilight setting / HS 500 DUO

Important:
 Due to the extensive sensor reach, undesired switching of the fixture can take place because of objects (i. e. cars) heated by sun light.

We therefore recommend setting at dusk.

Reach setting / Calibration

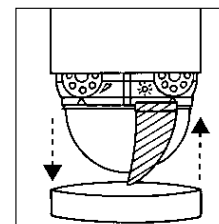
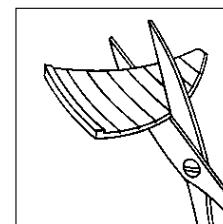
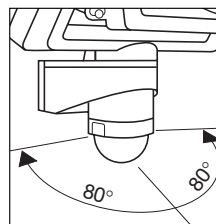

Reach setting / Examples

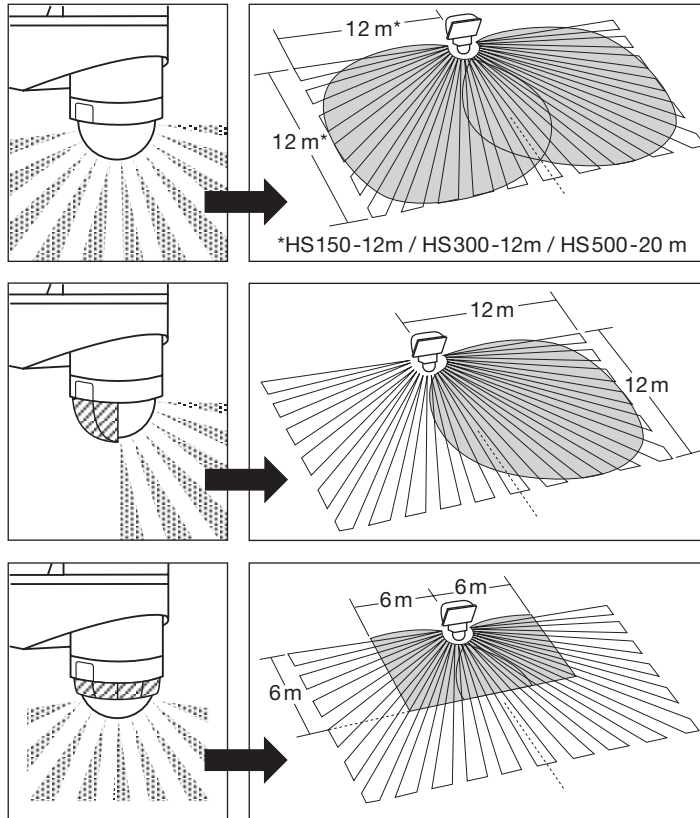

Technical Specifications

HalogenSensorFixtures	HS 150	HS 300	HS 500
Output:	max. 150 Watt	max. 300 Watt	max. 500 Watt
Assembly:	230-240 V	230-240 V	230-240 V
Detection angle:	240° with 180° angle of aperture	240° with 180° angle of aperture	240° with 180° angle of aperture
Swivelling range of sensor unit:	± 80°	± 80°	± 80°
Swivelling range of Halogen Sensor Fixture:	horizontal ± 40° vertical + 110° to - 40°	horizontal ± 40° vertical + 110° to - 40°	horizontal ± 40° vertical + 110° to - 40°
Time setting:	10 secs. - 15 mins.	10 secs. -15 mins.	10 secs. -15 mins.
Twilight setting:	2-2000 lux	2-2000 lux	2-2000 lux
Reach:	max. 12 m	max. 12 m	max. 20 m
Type of enclosure:	IP 44	IP 44	IP 44

Maintenance

HalogenSensorFixtures are suitable for activating lights and alarms. The unit is not suitable for burglar alarm systems. Weather conditions may influence the function of the HalogenSensorFixture. Strong gusts of wind,

snow, rain and hail can lead to switching errors as the unit cannot distinguish between sudden changes in temperature and heat sources. If the detector lens becomes dirty, it can be wiped with a damp cloth

(without using any cleaning agents).

Troubleshooting

Malfunction	Cause	Remedy
HalogenSensorFixture without power	<ul style="list-style-type: none"> ■ Defective fuse, not switched on, break in wiring ■ Short-circuit 	<ul style="list-style-type: none"> ■ Replace fuse, switch on power switch, check wiring with voltage tester ■ Check connections
HalogenSensorFixture will not switch on	<ul style="list-style-type: none"> ■ Light threshold set to night-time operation during daytime operation ■ Defective bulb ■ Power switch OFF ■ Defective fuse ■ Detection zone not properly targeted 	<ul style="list-style-type: none"> ■ Change setting ■ Replace bulb ■ Switch on ■ Replace fuse, check connection, if necessary ■ Recalibrate
HalogenSensorFixture will not switch off	<ul style="list-style-type: none"> ■ Continual movement in detection zone 	<ul style="list-style-type: none"> ■ Check detection zone and recalibrate or shroud if necessary
HalogenSensorFixture keeps switching ON and OFF	<ul style="list-style-type: none"> ■ Animals moving in detection zone 	<ul style="list-style-type: none"> ■ Cover up sensor, change detection zone, or shroud
HalogenSensorFixture comes on when it should not	<ul style="list-style-type: none"> ■ Wind is moving trees and shrubs in detection zone ■ Cars in the street are being detected ■ Sudden temperature change due to weather (wind, rain, snow) or air discharged from extractor fans or open windows ■ HalogenSensorFixture is moving (swaying) due to gusts of wind or heavy precipitation 	<ul style="list-style-type: none"> ■ Change detection zone or shroud ■ Alter zone, install at different location ■ Mount the HalogenSensor Fixture on a firm surface

CE Declaration of Conformity

This product conforms to low voltage directive

73/23/EEC and EMC directive 89/336/EEC.

Functional Warranty

This STEINEL product has been manufactured with great care, and its operation and safety have been tested in conformity with the current regulations. Production is also submitted to final random-sample testing.

The warranty period is 36 months, starting on the date of sale to the user. We undertake to remedy faults caused by material or manufacturing defects. This warranty undertaking shall be performed by the repair or replacement of the defective parts, at to our own choice.

This warranty does not cover damage to wear parts or damage and faults caused by incorrect operation and maintenance. Breakage due to a fall is also not covered. Further consequential damage to external items is excluded.

Claims under warranty shall only be accepted if the product, not disassembled, well packed and complete with sales slip or invoice (date of purchase and dealer's stamp) is sent to the appropriate Service Centre or handed in to the dealer within the first six months.

Repair Service:
Our customer service department will repair faults not covered by warranty or after the warranty period. Please send the product well packed to your nearest Service Centre.

36 month
FUNCTIONAL
WARRANTY