

D	STEINEL Vertrieb GmbH Dieselstraße 80-84 · 33442 Herzebrock-Clarholz Tel.: +49/5245/448-188 · Fax: +49/5245/448-197 · www.steinel.de	GR	PANOS Lingonis + Sons O. E. Aristofanous 8 Str. · GR-10554 Athens Tel.: +30/210/3212021 · Fax: +30/210/3218630 lygonis@otenet.gr
A	Steinel Austria GmbH Hirschslettner Strasse 19/A/2/2 · A-1220 Wien Tel.: +43/1/2023470 · Fax: +43/1/2020189 · info@steinel.at	PL	„L.L.“ Spółka z ograniczoną odpowiedzialnością sp.k. Byków, ul. Wroclawska 43 · PL-55-095 Mirków Tel.: +48 71 3980818 · Fax: +48 71 3980819 elektro@langelukaszuk.pl
CH	PUAGAG Oberebenestrasse 51 · CH-5620 Bremgarten Tel.: +41/56/6488888 · Fax: +41/56/6488880 · info@puag.ch	CZ	ELNAS s.r.o. Oblekovice 394 · CZ-67181 Znojmo · Tel.: +420/515/220126 Fax: +420/515/244347 · info@elnas.cz · www.elnas.cz
GB	STEINEL U.K.LTD. 25, Manasty Road · Axis Park · Orton Southgate GB-Peterborough Cambs PE2 6UP Tel.: +44/1733/366-700 · Fax: +44/1733/366-701 steinel@steinel.co.uk	TR	SAOS Teknoloji Elektrik Sanayi ve Ticaret Limited Şirketi Haliî Rifat Paşa mahallesi Yüzerhavuz Sokak PERPA Ticaret Merkezi A Blok · Kat 5 No.313 · Şişli /İSTANBUL Tel.: +90 212 220 09 20 · Fax: +90 212 220 09 21 iletisim@saosteknoloji.com.tr · www.saosteknoloji.com.tr
IRL	Socket Tool Company Ltd Unit 714 Northwest Business Park Kilshane Drive · Ballycoolin Dublin 15 Tel.: 00353 1 8809120 · Fax: 00353 1 8612061 info@sockettool.ie	H	DINOCOOPKft Radvány u. 24 · H-1118 Budapest Tel.: +36/1/3193064 · Fax: +36/1/3193066 dinocoop@dinocoop.hu
F	STEINEL FRANCE SAS ACTICENTRE - CRT 2 · Rue des Farnards - Bât. M - Lot 3 F-59818 Lesquin Cedex · Tél.: +33/3/20 30 34 00 Fax: +33/3/20 30 34 20 · info@steinelfrance.com	LT	KVARCAS Neries krantine 32 · LT-48463, Kaunas Tel.: +370/37/408030 · Fax: +370/37/408031 · info@kvarcas.lt
NL	VanSpijk B.V. Postbus 2 · 5688 HP OIRSCHOT · De Scheper 402 5688 HP OIRSCHOT · Tel. +31 499 571810 Fax. +31 499 575795 · info@vanspijk.nl · www.vanspijk.nl	EST	Fortronic AS Tõestuse tee 10 · EST-61715, Tõrvandi, Tartumaa Tel.: +372/7/475208 · Fax: +372/7/367229 info@fortronic.ee · www.fortronic.ee
B	VSABelgium Hagelberg 29 · B-2440 Geel Tel.: +32/14/256050 · Fax: +32/14/256059 info@vsabelgium.be · www.vsabelgium.be	SLO	ELEKTRO – PROJEKT PLUS D.O.O. Suha pri Predosljah 12 · SLO-4000 Kranj PE GRENC 2 · 4220 Škofja Loka Tel.: 00396-4-2521645 · GSM: 00386-40-856555 info@elektroprojektplus.si · www.priporocam.si
L	Minusines S.A. 8, rue de Hogenberg · L-1022 Luxembourg Tél. : (00 352) 49 58 58 1 · Fax : (00 352) 49 58 66/67 www.minusines.lu	SK	NECOSK, a.s. Ružová ul. 111 · SK-01901 Ilava Tel.: +421/42/4 45 67 10 · Fax: +421/42/4 45 67 11 neco@neco.sk · www.neco.sk
E	SAET-94S.L. C/ Trepadella, nº 10 · Pol. Ind. Castellbisbal Sud E-08755 Castellbisbal (Barcelona) Tel.: +34/93/772 28 49 · Fax: +34/93/772 01 80 saet94@saet94.com	RO	Steinel Distribution SRL Parc Industrial Metrom · RO · 500269 Brasov · Str. Carpatilor nr. 60 Tel.: +40(0)268 53 00 00 · Fax: +40(0)268 53 11 11 www.steinel.ro
I	STEINEL Italia S.r.l. Largo Donegani 2 · I-20121 Milano Tel.: +39/02/96457231 · Fax: +39/02/96459295 info@steinel.it · www.steinel.it	HR	Daljinsko upravljanje d.o.o. Bedriča Smetane 10 · HR-10000 Zagreb t/ 00385 1 388 66 77 · f/ 00385 1 388 02 47 daljinsko-upravljanje@net.hr · www.daljinsko-upravljanje.hr
P	Pronodis - Soluções Tecnológicas, Lda. Zona Industrial Vila Verde Sul, Rua D, nº 11 P-3770-305 Oliveira do Bairro Tel.: +351 234 484 031 · Fax: +351 234 484 033 pronodis@pronodis.pt · www.pronodis.pt	LV	Ambergs SIA Brīvības gatve 195-16 · LV-1039 Rīga Tel.: 00371 67550740 · Fax: 00371 67552850 · www.ambergs.lv
S	KARL H STROM AB Verktygsvägen 4 · S-55302 Jönköping Tel.: +46/36/31 42 40 · Fax: +46/36/31 42 49 · www.khs.se	BG	ТАШЕВ-ГАЛВИНГООД Бул. Климент Охридски № 68 · 1756 София, България Тел.: +359 2 700 45 45 4 · Факс: +359 2 439 21 12 info@tashev-galving.com · www.tashev-galving.com
DK	Roliba AS Hvidkærvej 52 · DK-5250 Odense SV Tel.: +45 6593 0357 · Fax: +45 6593 2757 · www.roliba.dk	RUS	Best - Snaib ул.1812 года, дом 12 · 121127 Москва · Россия Тел: +7 (495) 280-35-53 · info@steinel.ru · www.steinel.ru
FI	OyHedtecAb Lauttasaarentie 50 · FI-00200 Helsinki Tel.: +358/207 638 000 · Fax: +358/9/673 813 lighting@hedtec.fi · www.hedtec.fi/valaistus	CN	STEINEL China Representative Office · Shanghai Rm. 25 A, Huadu Mansion No. 836 · Zhangyang Road Shanghai 200122 Tel: +86 21 5820 4486 · Fax: +86 21 5820 4212 james.chai@steinel.cn · info@steinel.cn · www.steinel.cn
N	Vilan AS Olaf Helsetsvetvei 8 · N-0694 Oslo Tel.: +47/22725000 · post@vilan.no · www.vilan.no		

110051964 02/2017_J Technische Änderungen vorbehalten. / Subject to technical modification without notice.



STEINEL[®]
PROFESSIONAL

Information
sensiQ S

D
GB
F
NL
I
E
P
S
DK
FI
N
GR
TR
H
CZ
SK
PL
RO
SLO
HR
EST
LT
LV
RUS
BG

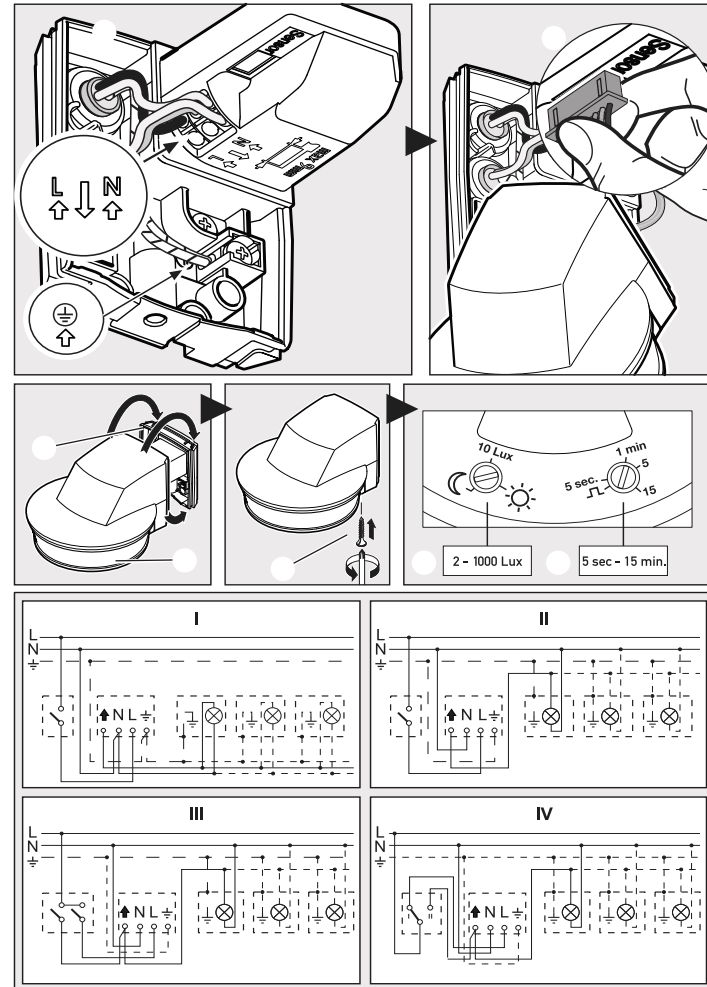
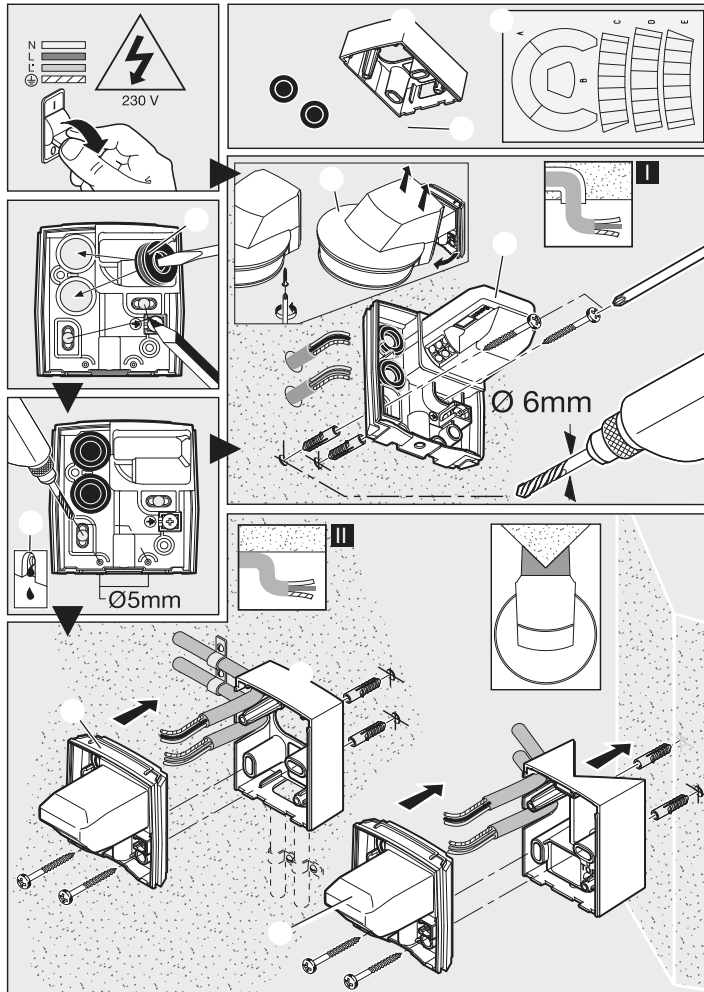

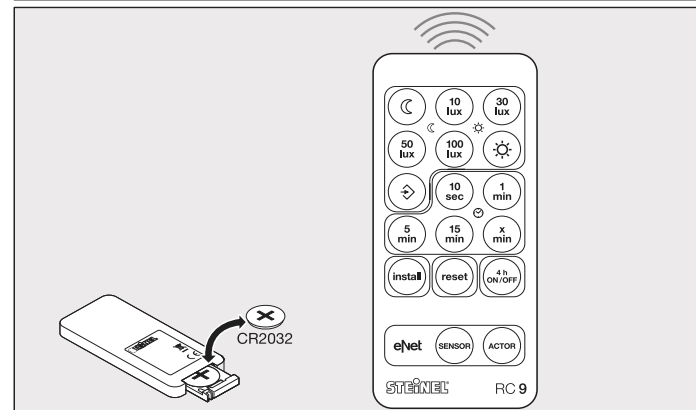
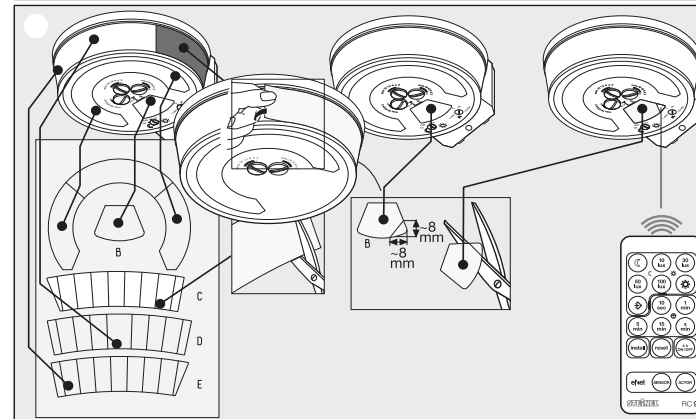
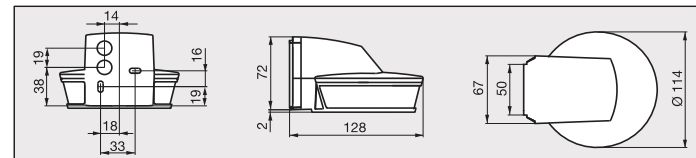
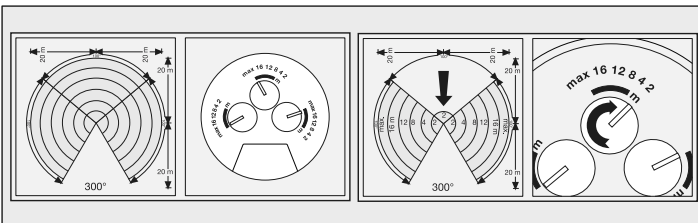
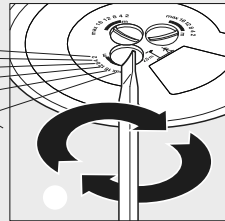
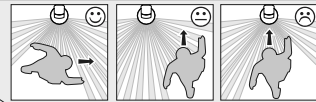
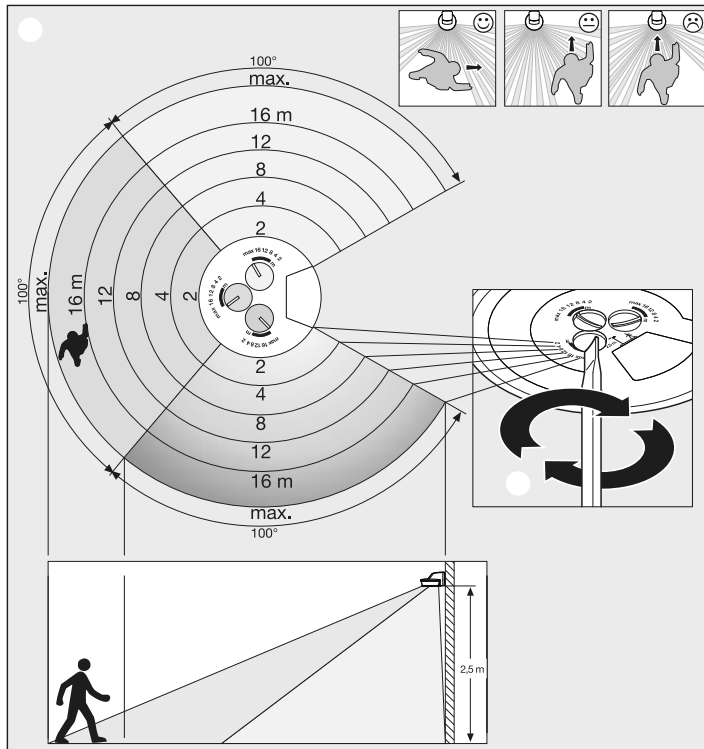

GB Installation instructions

Dear Customer,

Congratulations on purchasing your new STEINEL Infrared Sensor and thank you for the confidence you have shown in us. You have chosen a pioneering product that has been manufactured, tested and packed with the greatest care.

Please familiarise yourself with these instructions before attempting to install the sensor light because prolonged reliable and trouble-free operation will only be ensured if it is fitted properly. We hope your new Infrared Sensor will give you lasting satisfaction.

Principle

The unit is equipped with pyro sensors that detect the invisible heat emitted from moving objects (people, animals etc.). The heat thus detected is electronically converted and switches ON connected loads (e.g. a light).

No heat radiation is detected through obstacles such as walls or panes of glass for example and consequently no switching occurs.

⚠ Safety warnings

During installation, the electrical wiring you are connecting must be dead. Therefore, switch off the power first and use a voltage tester to check that the power supply is disconnected.

Installing the sensor involves work on the mains power supply. This work must therefore be carried out professionally in

accordance with applicable national wiring regulations and electrical operating conditions. (D -VDE 0100, A -ÖVE/ÖNORM E 8001-1, -SEV 1000)
Only use genuine replacement parts.
Repairs may only be carried out by specialist workshops.

Installation

The site of installation should be at least 50 cm away from another light because heat radiated from it may activate the sensor.

In order to achieve optimum detection, the sensor must be installed tangential to the walking direction.

A corner wall mount is included for mounting on outside corners.

The mains supply lead is a 3-core cable (max. conductor Ø 9 mm):

L = phase (usually black, brown or grey)

N = neutral conductor

PE = protective-earth conductor

If the rubber seal is damaged, the cable entry openings must be sealed with an M 16 or M 20 double seal cable gland.

A condensation water drainage hole is outlined in the housing. This can be opened for wall installation.

Wall mount must be renewed if any subsequent change is made to wiring run.

System components



Surface-mounting adapter
Sealing plug
Film shroud
Lens enclosure
Condensation water drainage hole
Wall mount / sensor unit
Corner wall mount

Plug-in terminals
Locking screw
Light-level setting
Time setting
Reach setting
■ Mains connection, concealed wiring
■ Mains connection, surface wiring

Connection examples

- | | | |
|-----|--|--|
| I | Light without existing neutral conductor | a) Loads, lighting of 2000 W max. (see Technical specifications) |
| II | Light fitted with a neutral conductor | b) Sensor connection terminals |
| III | Connection by means of two-circuit single-interruption switch for manual and automatic operation | c) Indoor switch
d) Indoor series switch, manual, automatic |
| IV | Connection by means of two-way switch for manual override and automatic operation | e) Indoor two-way switch, automatic operation, manual override |
- Setting I: Automatic operation
Position II: Manual operation
Light ON permanently
- Note: The system cannot be switched OFF, it is only possible to select operation at setting I or II.

Technical specifications

Dimensions (H × W × D):	74 × 114 × 128 mm
Output:	
	Incandescent lamps, max. 2000 W at 230 V *1)
	Fluorescent lamps, max. 1000 VA at 230 V (cos φ = 0.5)
	Max. starting current 800 A / 200 μs
	Electronic ballast *2): 30 × (1 × 18 W), 25 × (2 × 18 W) 25 × (1 × 36 W), 15 × (2 × 36 W) 20 × (1 × 58 W), 10 × (2 × 58 W)
Power supply:	220 – 240 V AC 50 / 60 Hz
Angle of coverage:	300° with 180° angle of aperture, as well as sneak-by guard for coverage directly below the sensor. Capability of masking out individual segments
Reach:	Adjustable in 3 directions independently of each other via control dial, (2 – 20 m, temperature-stabilised)
Sensor system:	4 sensors, 6 levels for long-distance detection and 5 for sneak-by guard, 1360 switching zones
Time setting:	5 sec – 15 min, pulse mode
Light-level setting:	2 – 1000 lux
Manual override:	selectable (4 h) / (only via remote control)
Permanently OFF:	selectable (4 h) / (only via remote control)
IP rating:	IP54 thanks to 2-component technology

*1) VDE-tested

*2) Fluorescent lamps, low-energy lamps, LED lights with electronic ballast (total capacity of all ballasts connected below the level stated).

Functions on the unit

The system can be put into operation once the mains power has been connected and the unit is closed. The sensor first goes through a calibration cycle (40 – 50 sec.) (LED flashes once a second).

Several settings can then be made directly on the sensor or by remote control (see Remote control).

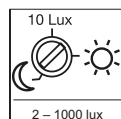

Twilight setting
(response threshold)
(Factory setting: daylight operation 1000 lux)

The sensor's response threshold can be set to between approx. 2 lux and 1000 lux.

Note:

The desired twilight value can also be saved via remote control.

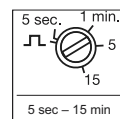

Time setting
(switch OFF delay)
(Factory setting: approx. 10 sec.)

The time you wish the connected light to stay ON for can be infinitely adjusted from approx. 5 sec to a maximum of 15 min.

Pulse mode:

Setting the control dial to "JL" switches the unit to pulse mode, i.e. the output is switched ON for approx. 2 sec. (e.g. for staircase lighting timer). Afterwards, the sensor does not react to movement for approx. 8 sec.

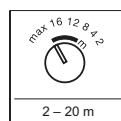

Reach setting
(Factory setting: max. reach)

Setting, control dial	Mounting height			
	1.8 m	Standard	3 m	5 m
2	2 m	2 m	3 m	4 m
4	4 m	4 m	7 m	12 m
8	8 m	7 m	12 m	>20 m
12	13 m	12 m	>20 m	>20 m
16	19 m	16 m	>20 m	- 1)
max	>20 m	>20 m	- 1)	- 1)

1) Not recommended, limited detection

Reach can be adjusted in 3 directions by 3 control dials (through 100° in each direction and independently of each another). The table shows reaches at different mounting heights for tangential walking direction. The values apply on flat terrain at a temperature of 20° C.

Film shrouds

If the independent settings of the 3 sensors are not sufficient, the detection zone can be restricted further by fitting film shrouds C, D, E (see Fig.). Film shrouds A + B under the sensor help to prevent the detection of small animals. This, of course, takes the lenses out of action and in particular results in loss of the sneak-by guard.

Note: The remote control does not work when using film shroud A (see Fig.).

Advice: Apply a solution of water and detergent to the lens before fitting the film shroud.

This way, the film does not firmly stick on immediately and gives you time to make precision adjustments. Once the cleaner is dry, the film adheres.

RC9 remote control functions

Principle

The eNet RC9 remote control makes larger lighting systems easier to install as it avoids the need to set each light/sensor prior to instal-

lation. Any number of lights/sensors can be controlled via the remote control. The eNet buttons are without any function for the sensiQ S.

Functions:

- 1** Light-level setting
The chosen response threshold can be selected at the press of a button.
- 2** Daylight operating mode (depending on ambient light level - 1000 lux)
- 3** Night mode (2 lux)
- 4** Light-level setting via the memory button / teach mode.
This button must be pressed at the level of light at which you want the sensor to respond to movement from now on. The current value is stored.
- 5** Time setting
The period of time you want the light to stay ON for after the last detected movement can be set to 10 s, 1 min, 5 min or 15 min by pressing these buttons.
- 6** Setting the light to stay ON for any chosen time. Each press of the button increments the current time setting by 1 min (max. 15 min).
- 7** Pressing this button in sensor mode switches the light ON for 4 hours (the status LED lights up permanently). Pressing this button in 4 h ON mode switches the light OFF for 4 hours (the status LED lights up permanently). The 4 h mode is terminated after the time elapses, by pressing the reset button or by pressing the 4 h button in the 4 h OFF mode.

- 8** Install mode (test mode)
Install mode has the purpose of checking for proper working order as well for testing the detection zone. Irrespective of light level, the light switches ON for 5 s in response to movement. Movement is signalled by the status LED. Install mode has priority over all other settings. Install mode ends automatically after 10 minutes. Install mode ends immediately after pressing reset.
Note: Teach mode and Install mode cannot be used at the same time.
- 9** Reset
Resets all settings to the values selected on the light manually or to the factory settings.

Troubleshooting		
Malfunction	Cause	Remedy
Sensor without power	Fuse has blown; not switched ON; break in wiring	New fuse, turn on power switch, check wiring with voltage tester
	Short circuit	Check connections
Sensor will not switch ON	Twilight setting in night-time mode during daytime operation	Adjust setting
	Bulb faulty Mains power switch OFF Fuse faulty	Change bulb Switch ON Replace fuse, check connection if necessary
Sensor will not switch OFF	Detection zone not correctly adjusted	Re-adjust
	Continued movement within the detection zone Light is in detection zone and keeps switching ON as a result of temperature change Light being operated is in the manual override mode (LED ON)	Check zone and readjust if necessary or fit shrouds Adjust detection zone or fit shrouds Deactivate manual override
Sensor keeps switching ON/OFF	Light being operated in the detection zone Animals moving in detection zone	Adjust detection zone or fit shrouds, increase distance Adjust zone, or apply shrouds
Sensor responds when it should not	Wind is moving trees and bushes in the detection zone	Change zone
	Cars in the street are detected	Change zone
	Sunlight is shining on the lens Sudden temperature changes due to weather (wind, rain, snow) or air expelled from fans, open windows	Mount sensor in a protected place or change zone Adjust detection zone or install in a different place
Change in sensor's reach	Differing ambient temperatures	Adjust reach via reach controller, if necessary applying film shrouds

Operation/Maintenance

CB

The infrared sensor can be used for switching light ON and OFF automatically. The unit is not suitable for burglar alarm systems as it is not tamperproof in the manner prescribed for such systems. Weather conditions may affect the way the motion detector works. Strong gusts of wind, snow, rain or hail may cause the light

to come ON when it is not wanted because the sensor is unable to distinguish sudden changes of temperature from sources of heat. The detector lens may be cleaned with a damp cloth if it gets dirty (do not use cleaning agents).

Accessories (optional)

Smart Remote EAN 4007841 009151
- Replaces the remote control RC9
- Control via smartphone or tablet
- Download appropriate app and connect via Bluetooth
- For identifying the sensor and reading parameters

Detailed descriptions are provided in the operating instructions for the particular remote controls.

Warranty Declaration

All rights are based on our warranty period. We guarantee that your STEINEL Professional sensor product will remain in perfect condition and proper working order for a period of 5 years. We guarantee that this product is free from material, manufacturing and design flaws. In addition, we guarantee that all electronic components and cables function in the proper manner and that all materials used and their surfaces are without defects.

For information on making claims under the terms of the warranty, please go to www.steinel-professional.de/garantie

If you have a warranty claim or would like to ask any question regarding your product, you are welcome to call us at any time on our Service Hotline 01733 366700.

Making Claims

If you wish to make a claim, please send your product complete and carriage paid with the original receipt of purchase, which must show the date of purchase and product designation, either to your retailer or directly to us at STEINEL (UK) Limited, 25 Manasty Road, Axis Park, Orton Southgate, Peterborough, PE2 6UP. For this reason, we recommend that you keep your receipt of purchase in a safe place until the warranty period expires. STEINEL shall assume no liability for the costs or risks involved in returning a product.

FUNCTIONAL
5 Year
WARRANTY