



Zip Tudor™

Over-sink or under-sink water heaters

Open outlet to single point
5.0 litre, 10.0 litre



UB 1



UB 6



UB 7

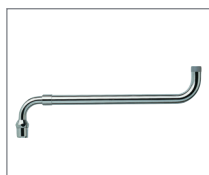

TS 1

Optional accessories

- UB1 Monobloc mixer
- UB6 Single lever basin tap
- UB7 Single lever sink tap
- TS1 Telescopic 300-600 mm spout

Features

- Adjustable temperature control
- Choice of 5 or 10 litres capacity
- Over-sink models supplied complete with spout and valve
- Under-sink models for connection to open-outlet tapware only
- Mains cable connected
- CFC - free insulation
- Impact resistant, easy clean, white plastic casing
- Manually re-settable cutout
- Neon power indicator light

01.09.06



Zip Tudor™

Over-sink or under-sink water heaters

**Open outlet to single point
5.0 litre, 10 litre**

				Dimensions (mm)			Weight (kg)	
				A	B	C	Empty	Full
Zip Tudor™	Over-basin	5.0 litre	P4/52	390	255	215	3.5	8.5
Zip Tudor™	Under-basin	5.0 litre	P4/52UB	390	255	215	3.5	8.5
Zip Tudor™	Over-basin	10.0 litre	P4/102	455	310	265	4.0	14.0
Zip Tudor™	Under-basin	10.0 litre	P4/102UB	455	310	265	4.0	14.0

- Over-sink or under-sink water heaters
- Open outlet to single point
- Swivel arm open outlet spout and on/off valve (over-sink models)
- Plumbing connections at top of heater (under-sink models)
- Full external temperature control ranging from 35°C to 80°C
- Frost protection setting to protect the heater when not in use
- Low watts density spiral heating element for rapid recovery and long life
- Manually re-settable over-temperature safety cut-out
- External neon light indicator to indicate when element is 'ON'
- Mains cable connected

Capacity

5 litres, 10 litres

Rating

2.0 kW

Heating element

Embedded rod type

Thermostat

Capillary type, adjustable 35°C to 80°C

Water tank

Approved polypropylene tested to 40 psi

Case

Impact resistant plastic

Insulation

Contoured polyurethane, CFC free

Safety feature

Manually re-settable over-temperature safety cut-out

Approvals

WRAS approved and CE endorsed

Simple to install

Supplies hot water to a single outlet

Connects directly to the cold water supply

No need for expansion vessel or relief valve

Simple to operate

Temperature controlled water whenever you want it

Externally adjustable temperature control

Neon light indicates when heating element is 'ON'

Special safety features

Open-outlet non-pressurised system

Frost protection setting protects heater when not in use

Manually re-settable over-temperature safety cut-out

Warranty

12 months

Installation

Location

All models should be wall mounted. Screws and plugs suiting most walls provided

Plumbing

Can be connected to a rising main or to a cistern with a minimum working head of 5 metres

All water connections are via 15 mm compression fittings

Over-sink models are supplied with a 300 mm open outlet spout and water control valve

Under-sink models must be installed only with a Zip-approved open-outlet tap

Over-sink and under-sink models are NOT interchangeable

Electrical

To be wired to a double pole fused spur, minimum break rating of 13 amps

Installation must comply with current IEE regulations

Caution

Variable temperature water heaters should be set only in strict compliance with regulations governing the temperature of stored and dispensed hot water

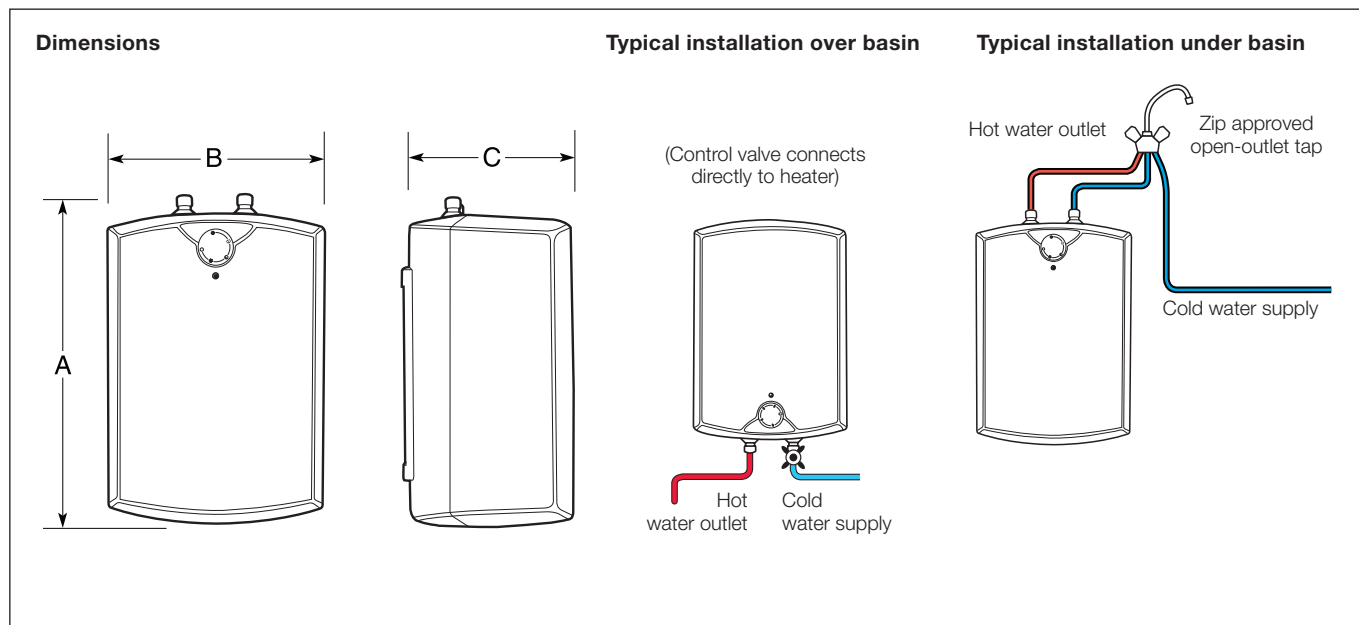

01.09.06

