

Product Code: CL16G
Conlok Malleable Conduit Box



Description

20mm Back Outlet Conlok Conduit Box

Finish

Hot Dipped Galvanised

Material

Malleable Iron

Packaging

Packed in qty 10

Additional Notes

Conforms to BS EN 61386-21:2021+A11:2021
Supplied with 12.9 Grade grub screw
1 x Allen key supplied in each inner box

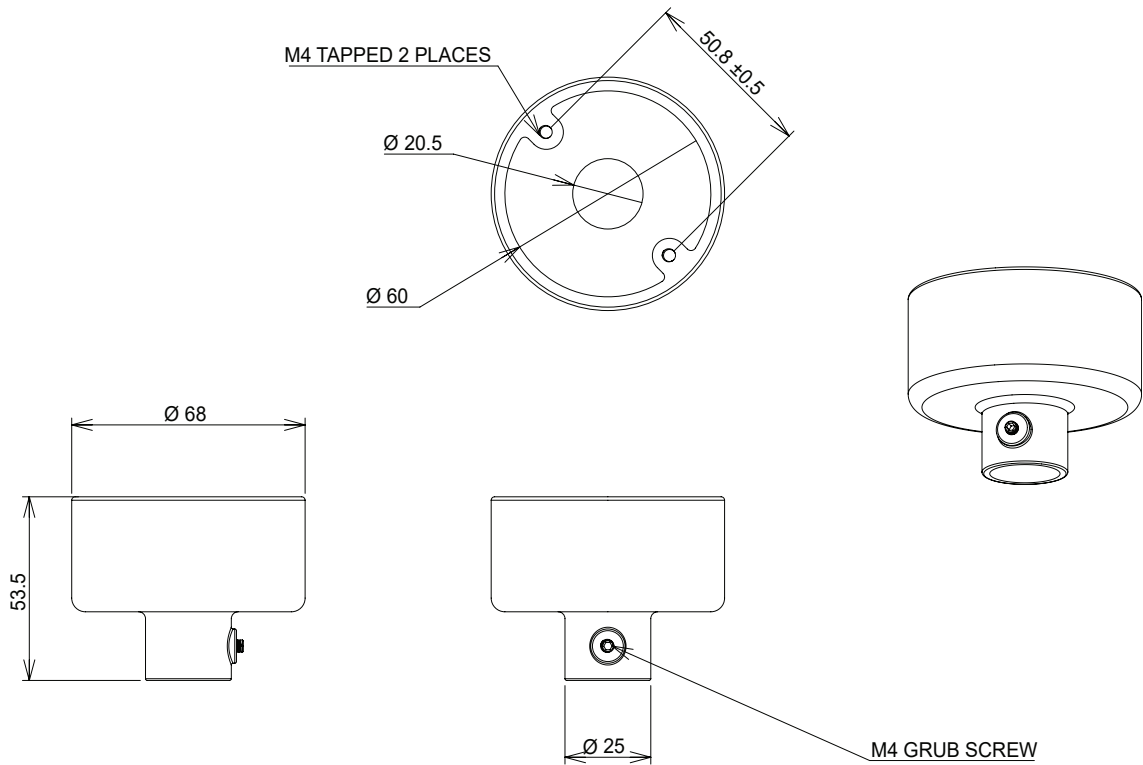

Ⓢ Values are nominal and with a general tolerance $\pm 5\%$ unless otherwise specified